

May.1.2024 Copyright 2024 HIROSE ELECTRIC CO., LTD. All Rights Reserved.
In case of consideration for using Automotive equipment / device which demand high reliability, kindly contact our sales window correspondents.

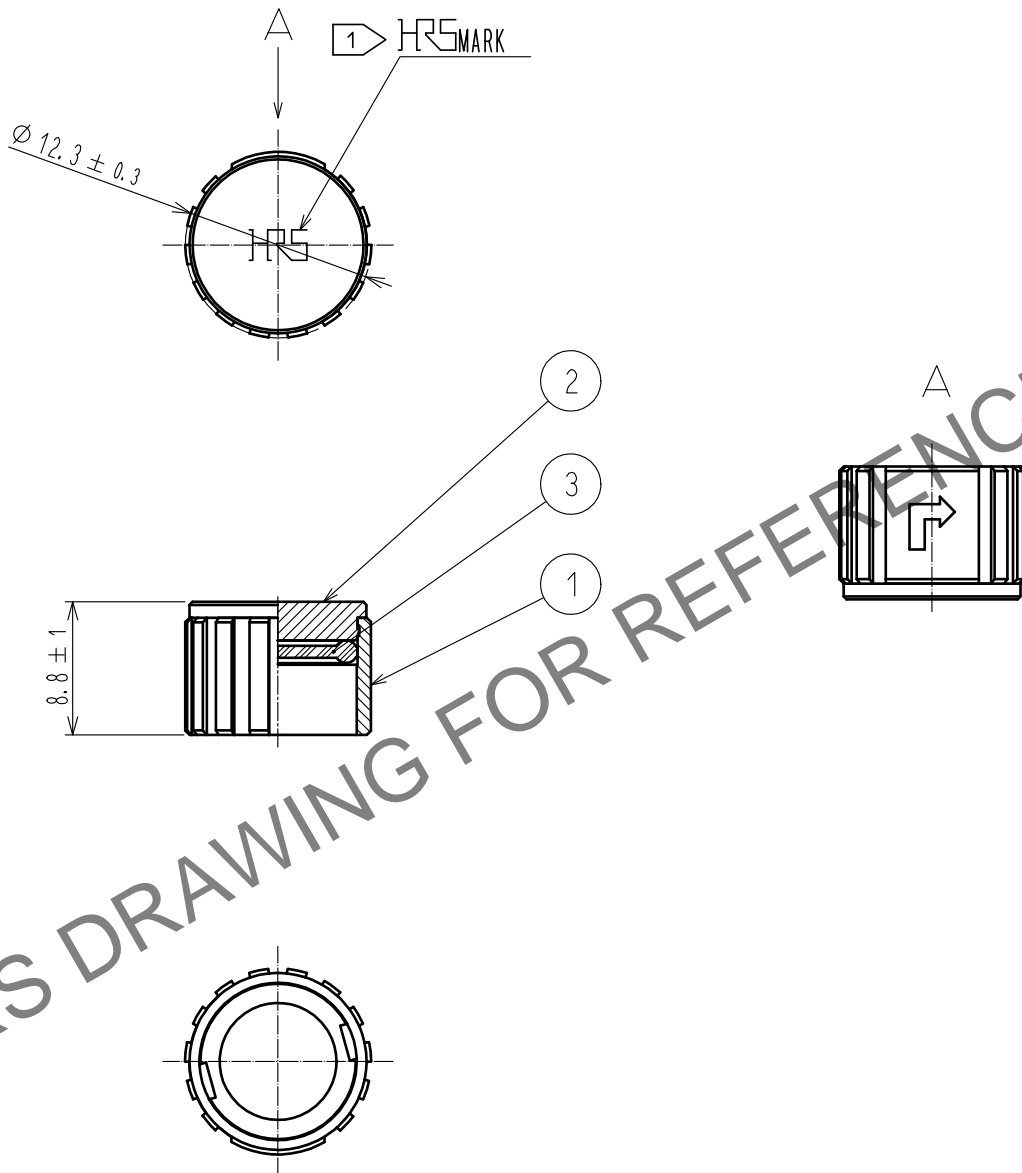

NOTES 1 ROTATION EXAMPLES OF HRS MARK ARE SHOWN.
2 THIS PRODUCT IS A CAP FOR LF07WBR※-※(※).
IT IS APPLICABLE REGARDLESS OF GIVEN ALPHABETS OR NUMBERS SHOWN AT ※.

2	BRASS	BLACK CHROME PLATING			
1	ZINC ALLOY	BLACK CHROME PLATING	3	SILICONE RUBBER	(RED)
NO.	MATERIAL	FINISH . REMARKS	NO.	MATERIAL	FINISH . REMARKS
UNITS mm		SCALE 2 : 1	COUNT 	DESCRIPTION OF REVISIONS	DESIGNED
					CHECKED
					DATE
HIROSE ELECTRIC CO., LTD.		APPROVED : TP. KOMATSU	20201008	DRAWING NO.	EDC-118048-03-00
		CHECKED : TP. KOMATSU	20201008	PART NO.	LF07WBR-C<03>
		DESIGNED : KN. IKEHARA	20201008	CODE NO.	CL136-3008-7-03
		DRAWN : TR. YAMANOE	20201007		