

Apr.1.2024 Copyright 2024 HIROSE ELECTRIC CO., LTD. All Rights Reserved.  
 In case of consideration for using Automotive equipment / device which demand high reliability, kindly contact our sales window correspondents.

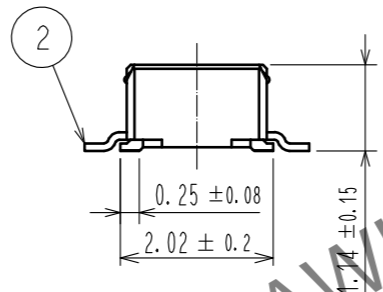

RECOMMENDED PATTERN (10:1)

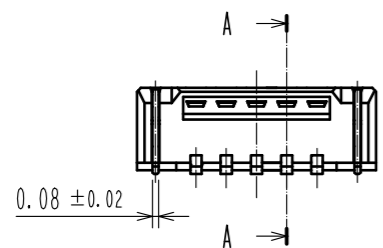
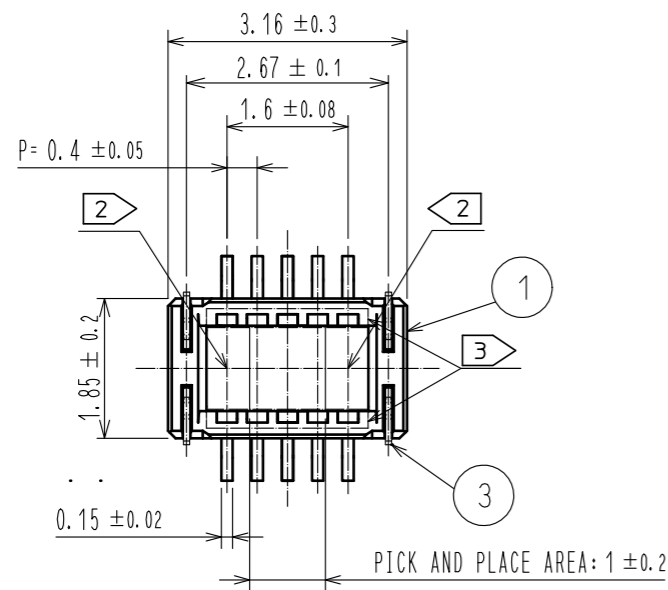
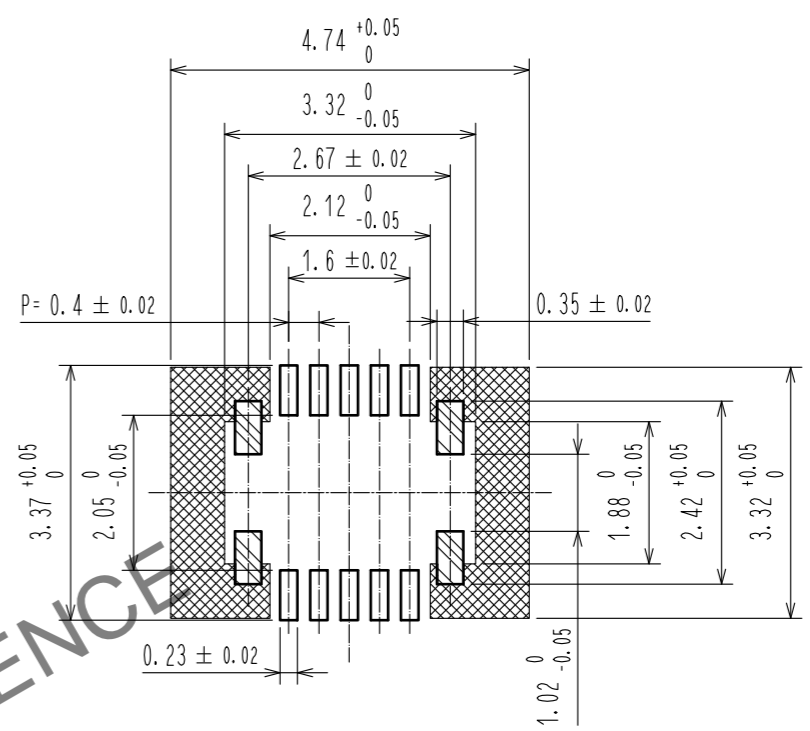

□ : SIGNAL    ▨ : GROUND    ▩ : NON-CONDUCTIVE AREA  
 RECOMMENDED METAL MASK THICKNESS: 120 μm  
 RECOMMENDED MASK OPENING RATIO: 80% FOR LEAD PAD

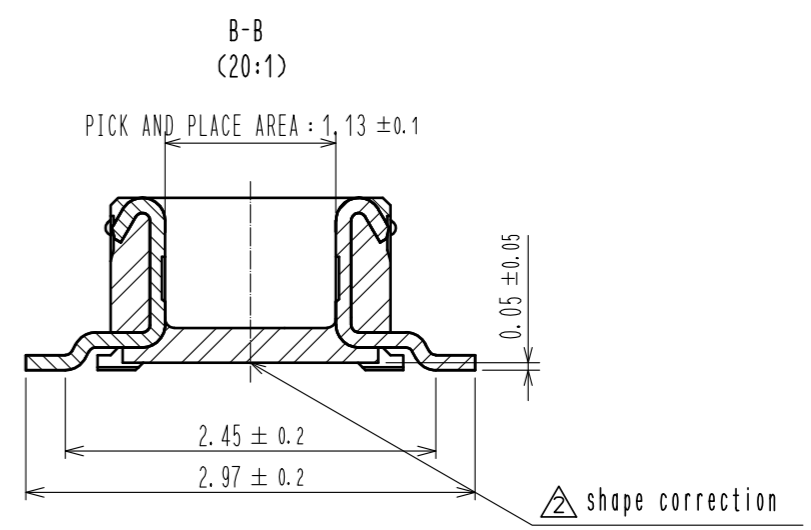

NOTES 1. ALL LEADS CO-PLANARITY SHALL BE 0.1mm MAX.  
 2 HRS MARK AND CAV No. ARE INDICATED IN APPROX POSITION SHOWN.  
 3 THERE IS A POSSIBILITY THAT THE RESIN WILL BE EXPOSED AT THIS AREA, BUT THIS WILL NOT AFFECT THE CONTACT RELIABILITY.

2	PHOSPHOR BRONZE	CONTACT AREA: Au 0.05 μm MIN SMT LEAD: Au 0.05 μm MIN UNDERPLATING: NICKEL 1 μm MIN	7	PS	CLEAR (REINFORCEMENT COLLAR)
1	LCP	BLACK, UL94V-0	6	PS	BLACK (PLASTIC REEL)
			5	POLYESTER	CLEAR (COVER TAPE)
			4	PS	CLEAR (EMBOSSED CARRIER TAPE)
			3	PHOSPHOR BRONZE	CONTACT AREA: Au 0.05 μm MIN SMT LEAD: Au 0.05 μm MIN UNDERPLATING: NICKEL 1 μm MIN
NO.	MATERIAL	FINISH . REMARKS	NO.	MATERIAL	FINISH . REMARKS
UNITS	mm	SCALE	10: 1	COUNT	1
DESCRIPTION OF REVISIONS		DESIGNED	CHECKED		DATE
DIS-H-00006416		PAN YIWEI	TS. MIYAZAKI		20201007
APPROVED : MO. ISHIDA 20150701		DRAWING NO. EDC-359672-58-01			
CHECKED : TS. MIYAZAKI 20150701		PART NO. DF40GB-10DP-0.4V(58)			
DESIGNED : SH. HOSODA 20150701		CODE NO. CL684-4225-5-58			
DRAWN : KR. AJITO 20150701		1/2			

Apr.1.2024 Copyright 2024 HIROSE ELECTRIC CO., LTD. All Rights Reserved.  
 In case of consideration for using Automotive equipment / device which demand high reliability, kindly contact our sales window correspondents.

EMBOSED CARRIER TAPE PACKAGING(5:1)

C-C (5:1)

STYLE AND DIMENSION OF REEL (FREE)

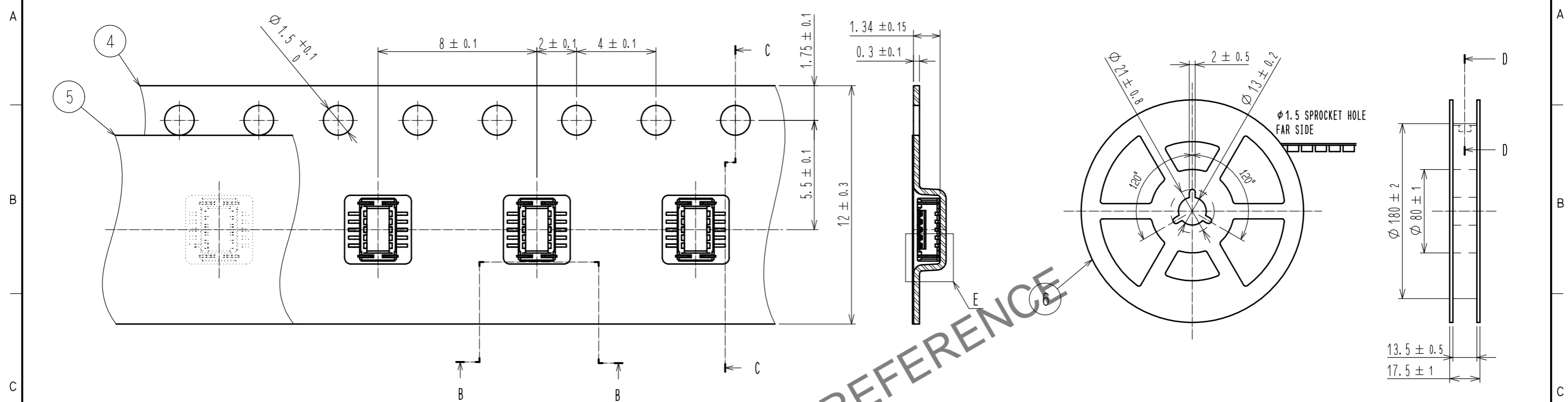

DIRECTION OF UNREELING →

B-B (5:1)

(10:1)

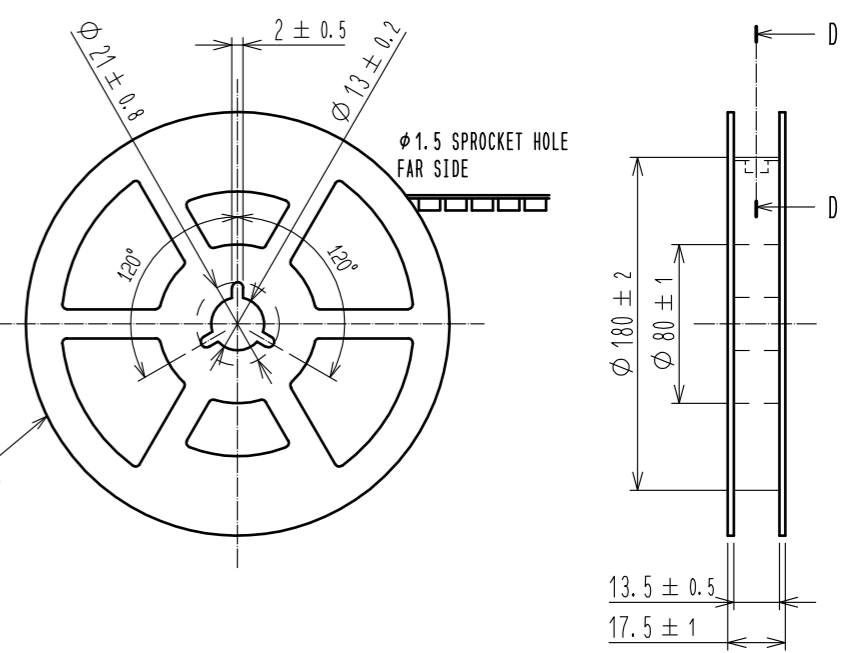

D-D (FREE)

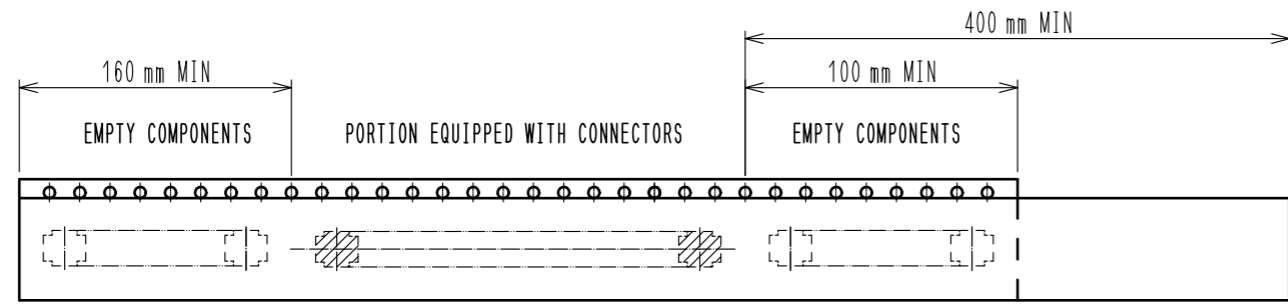
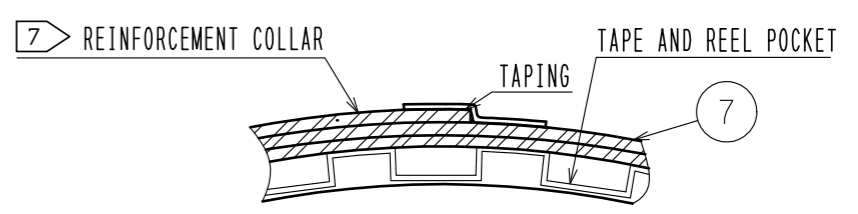

6 TAPING (FREE)

- NOTES
- 4. PER REEL 1000 CONNECTORS.
  - 5. THE DIMENSIONS IN PARENTHESES ARE FOR REFERENCE.
  - 6 REFER TO JIS C 0806, IEC 60286-3(PACKING OF COMPONENTS FOR AUTOMATIC HANDLING)
  - 7 AFTER PACKAGING, ROLL 2 METERS OF THE REINFORCEMENT COLLAR TO OUTER CIRCUMFERENCE OF TAPE AND REEL POCKET, AND TAPE DOWN AT THE END THE COLLAR.

<b>HRS</b>	DRAWING NO.	EDC-359672-58-01	
	PART NO.	DF40GB-10DP-0.4V(58)	
	CODE NO.	CL684-4225-5-58	2/2