

May.1.2024 Copyright 2024 HIROSE ELECTRIC CO., LTD. All Rights Reserved.  
In case of consideration for using Automotive equipment / device which demand high reliability, kindly contact our sales window correspondents.

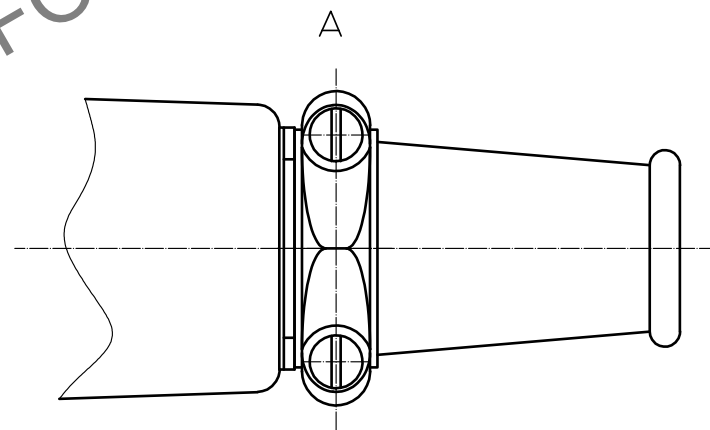
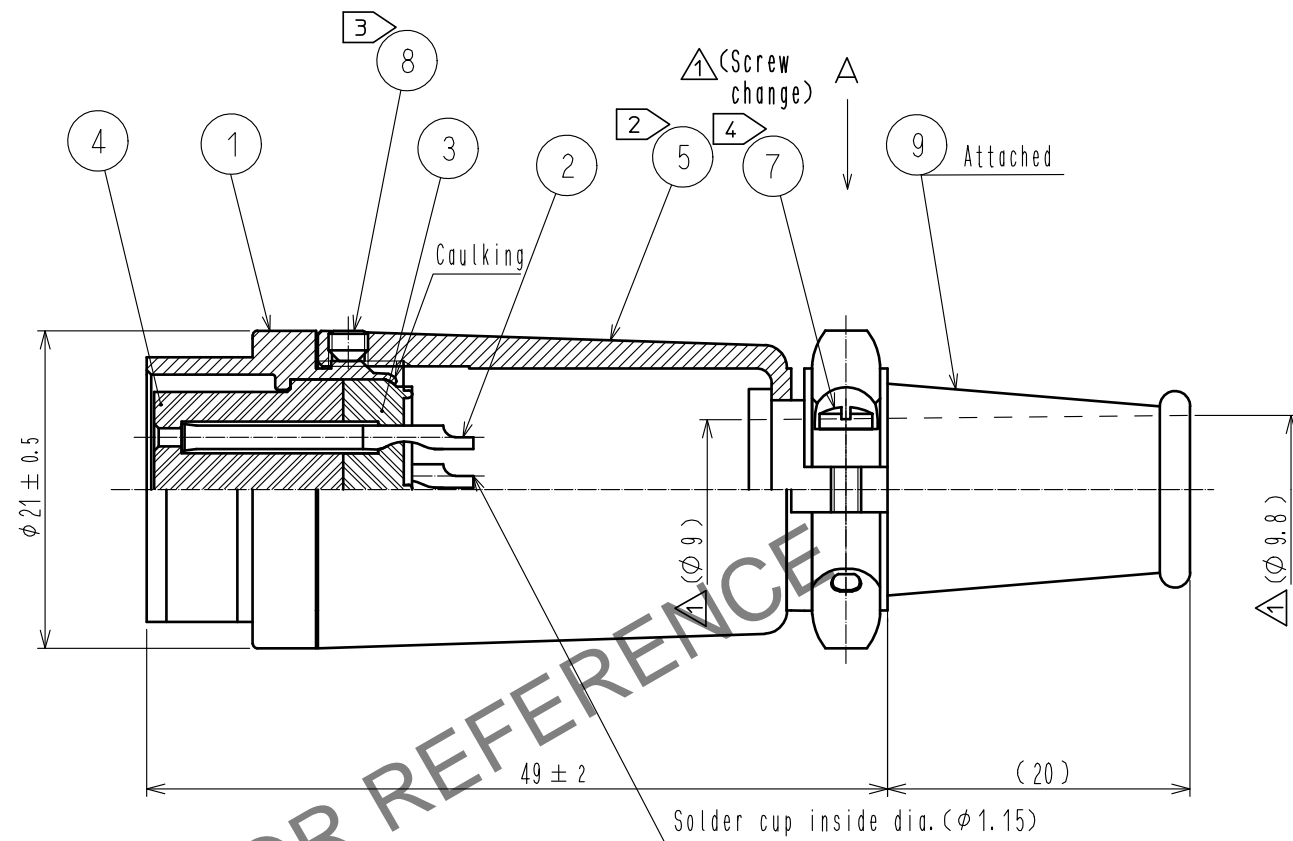
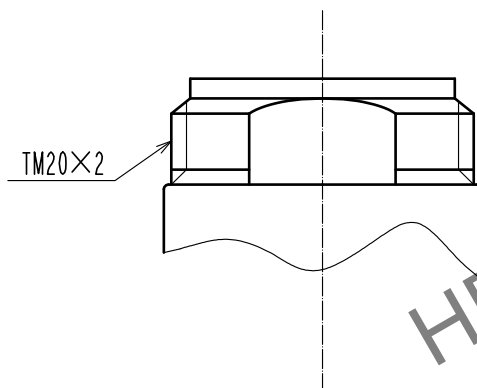
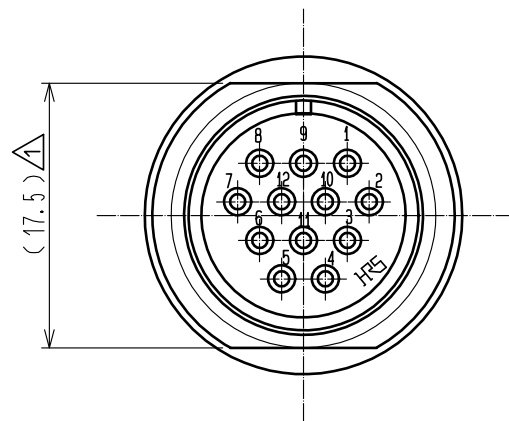

- Notes 1 Rotation example of Ref. No. ① and ⑤ are shown.
- ② The tightening torque of Ref. No. ⑤: 2 to 3 N·m.
- ③ The tightening torque of Ref. No. ⑧: 0.2 to 0.3 N·m.  
Across flats hexagon head of Ref. No. ⑧: 1.27  
Apply Loctite 243 HENKEL JAPAN or equivalent to the threaded portion of Ref. No. ⑧ in order to prevent loosening.
- ④ The tightening torque of Ref. No. ⑦: 0.12 to 0.15 N·m.  
Apply Loctite 243 HENKEL JAPAN or equivalent to the threaded portion of Ref. No. ⑦ in order to prevent loosening.
- 5 The cable pull and twisting strength and other characteristics may differ, depending on the cable structure, please confirm before the use.

4	Polyphenylene sulfide	(Black)	9	Chloroprene rubber	(Black)
3	Polyphenylene sulfide	(Black)	8	Steel	Nickel plating Hexagon socket set screw M2.6×0.45
2	Copper alloy	Silver plating 5μm min.	7	Brass	Nickel plating Soldered hex screw M2×0.4×8
1	Zinc alloy	Matte finish chrome plate	5	Aluminum alloy	Matte finish alumite (chrome)
NO.	MATERIAL	FINISH . REMARKS	NO.	MATERIAL	FINISH . REMARKS
UNITS mm		SCALE 2 : 1	COUNT 5	DESCRIPTION OF REVISIONS DIS-C-00015639	DESIGNED HT. ZENBA
		APPROVED : TP. KOMATSU	20230328	DRAWING NO. EDC-007497-81-00	DATE 20230626
		CHECKED : HY. KOBAYASHI	20230327	PART NO. RM15TJD-12S(81)	
		DESIGNED : HT. ZENBA	20230327	CODE NO. CL0109-0665-9-81	
		DRAWN : KR. SUZUKI	20230322		