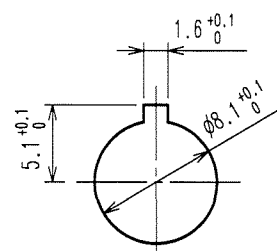

[illegible]

Technical drawing of a 6-pin connector assembly. The drawing includes a side view and a top view.

Side View Dimensions:

- Overall height: 15.6 ± 0.7
- Height of the main body: 6.3 ± 0.3
- Height of the base: 5.7 ± 0.3
- Height of the base (alternative): (0.5)
- Top diameter: $\phi 11 \pm 0.3$
- Inner diameter: $\phi 8.85 \pm 0.2$
- Thread specification: $M8 \times 0.5$

Top View Dimensions:

- Overall diameter: $(10) \text{ HEX}$
- Pin pitch: 0.9 ± 0.05
- Pin diameter: 1.8 ± 0.05
- Pin length: 1.56 ± 0.05

Callouts and Labels:

- 1: Outer shell
- 2: Seal ring
- 3: Press fitting
- 4: Attached (to shell)
- 5: Attached (to base)
- 6: DIP posts

Text:

- DIP POSTS DIA. (0.2×0.5)
- AWING FOR REFERENCE

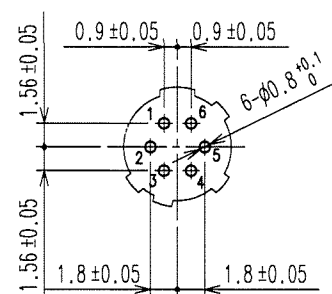

PCB LAYOUT

(INDICATES THE SIDE OF THE SURFACE
TO WHICH DIP POSTS ARE INSERTED.)

NOTE 1 THE RECOMMENDED CLAMP TORQUE OF REF. NO. ⑤ TO BE 1.5 N · m.
LOCTITE 242, HENKEL JAPAN OR EQUIVALENT IS RECOMMENDED TO
PREVENT REF. NO. ⑤ FROM LOOSENING.

CODE NO. (OLD)				
----------------	--	--	--	--

	DRAWING NO	PART NO

FORM NO. 22