

May.1.2024 Copyright 2024 HIROSE ELECTRIC CO., LTD. All Rights Reserved.  
In case of consideration for using Automotive equipment / device which demand high reliability, kindly contact our sales window correspondents.

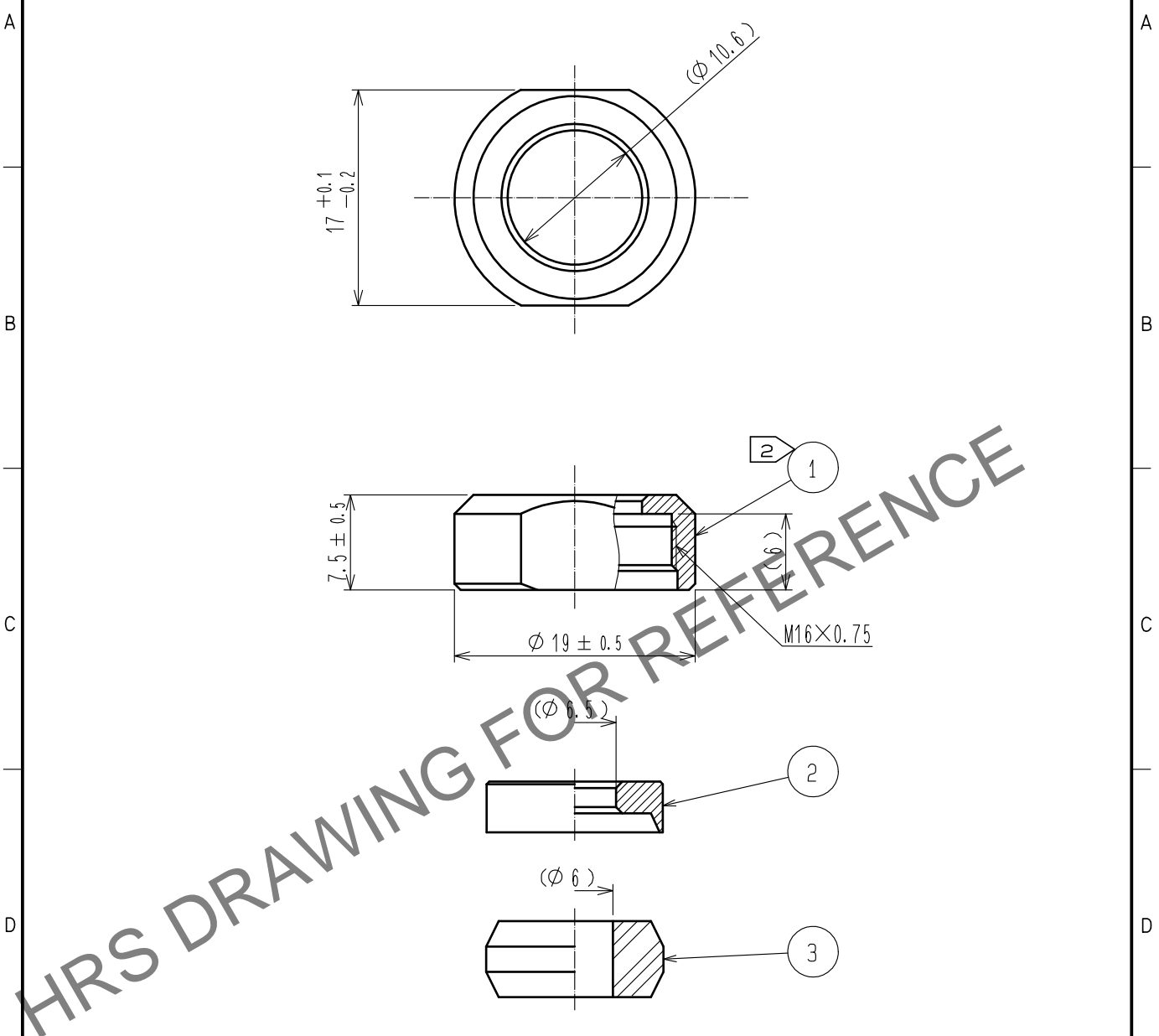

- Notes
- 1 This product is delivered disassembled.
  - 2 The recommended clamp torque of Ref.No. ① to be 2 to 2.5N・m.  
LOCTITE 263, Henkel Japan or equivalent is recommended to prevent  
Ref.No. ① from loosening.
  - 3 The cable pull and twisting strength and other characteristics may differ,  
depending on the cable structure. please before the use.

2	BRASS	NICKEL PLATING					
1	BRASS	CHROME PLATING	3	SILICONE RUBBER	(BLACK)		
NO.	MATERIAL	FINISH .	REMARKS	NO.	MATERIAL	FINISH .	REMARKS
UNITS mm		SCALE 2 : 1	COUNT 	DESCRIPTION OF REVISIONS		DESIGNED	CHECKED
HIROSE ELECTRIC CO., LTD.		APPROVED	・HY. KOBAYASHI	15. 08. 18	DRAWING NO.	EDC-110620-72-00	
		CHECKED	・HY. KOBAYASHI	15. 08. 18	PART NO.	JR13WCCA-6(72)	
		DESIGNED	・HY. KISHI	15. 08. 18	CODE NO.	CL114-2071-0-72	
		DRAWN	・HY. KISHI	15. 08. 18			