

Apr.1.2024 Copyright 2024 HIROSE ELECTRIC CO., LTD. All Rights Reserved.  
In case of consideration for using Automotive equipment / device which demand high reliability, kindly contact our sales window correspondents.

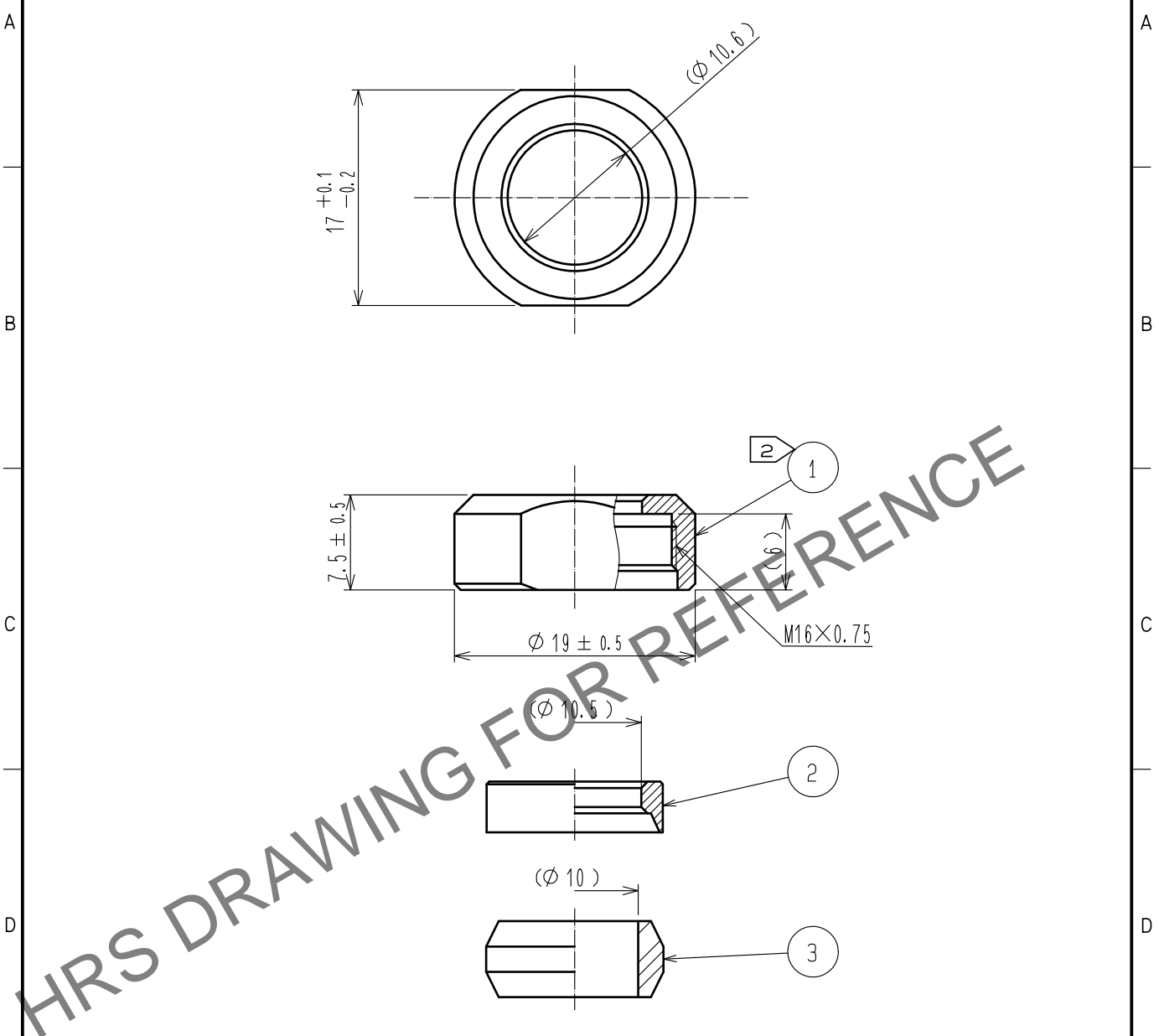

- Notes
- 1 This product is delivered disassembled.
  - 2 The recommended clamp torque of Ref.No. ① to be 2 to 2.5N・m.  
LOCTITE 263, Henkel Japan or equivalent is recommended to prevent  
Ref.No. ① from loosening.
  - 3 The cable pull and twisting strength and other characteristics may differ,  
depending on the cable structure. please before the use.

2	BRASS	NICKEL PLATING						
1	BRASS	CHROME PLATING	3	SILICONE RUBBER	(BLACK)			
NO.	MATERIAL	FINISH . REMARKS	NO.	MATERIAL	FINISH . REMARKS			
UNITS mm		SCALE 2 : 1	COUNT 	DESCRIPTION OF REVISIONS	DESIGNED	CHECKED	DATE	
HIROSE ELECTRIC CO., LTD.		APPROVED	・HY. KOBAYASHI	15.08.18	DRAWING NO.	EDC-110459-72-00		
		CHECKED	・HY. KOBAYASHI	15.08.18	PART NO.	JR13WCCA-10(72)		
		DESIGNED	・HY. KISHI	15.08.18	CODE NO.	CL114-2075-1-72		
		DRAWN	・HY. KISHI	15.08.18				1/1