

Jun.1.2024 Copyright 2024 HIROSE ELECTRIC CO., LTD. All Rights Reserved.
In case of consideration for using Automotive equipment / device which demand high reliability, kindly contact our sales window correspondents.

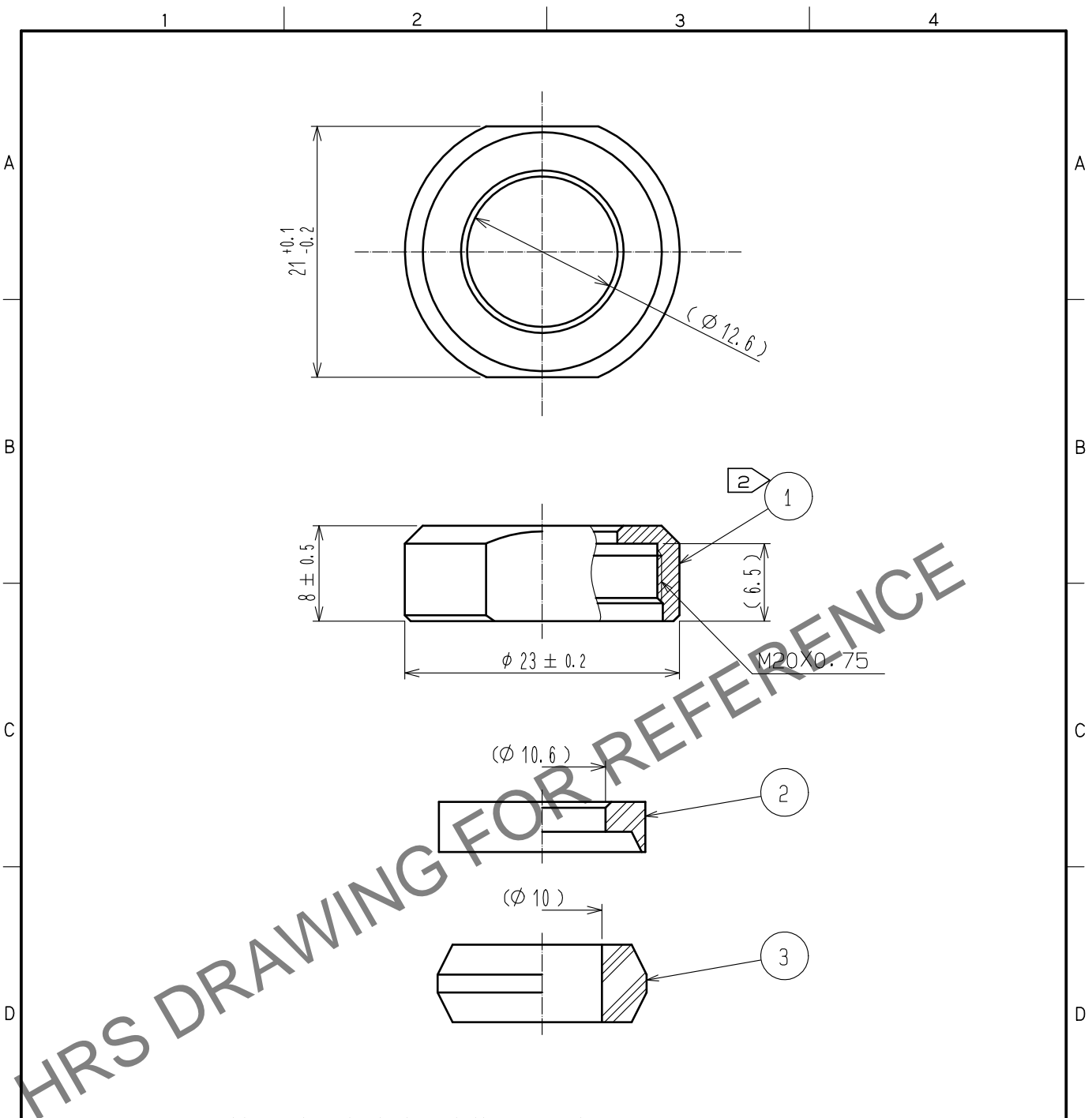

- Notes
- 1 This product is delivered disassembled.
 - 2 The recommended clamp torque of REF. No. ① to be 3 to 3.5N・m
Loctite 263, HENKEL JAPAN or equivalent is recommended
to prevent REF. No. ① from loosening.
 - 3 The cable pull and twisting strength and other characteristics
may differ, depending on the cable structure.
Please confirm before the use.

2	PPS	(Black) UL94V-0			
1	Brass	Black chrome plating	3	Acrylonitrile butadiene rubber	(Gray)
NO.	MATERIAL	FINISH . REMARKS	NO.	MATERIAL	FINISH . REMARKS
UNITS mm		SCALE 2 : 1	COUNT 	DESCRIPTION OF REVISIONS	DESIGNED
					CHECKED
					DATE
HIROSE ELECTRIC CO., LTD.		APPROVED	・HY. KOBAYASHI	15. 08. 27	DRAWING NO.
		CHECKED	・HY. KOBAYASHI	15. 08. 27	PART NO.
		DESIGNED	・HY. KISHI	15. 08. 27	CODE NO.
		DRAWN	・HY. KISHI	15. 08. 27	
EDC-110489-71-00					
JR16WCCA-10(71)					
CL114-2079-2-71					
					1/1