

Oct.1.2024 Copyright 2024 HIROSE ELECTRIC CO., LTD. All Rights Reserved.
In case of consideration for using Automotive equipment / device which demand high reliability, kindly contact our sales window correspondents.

4 Fig. 2(1:1)

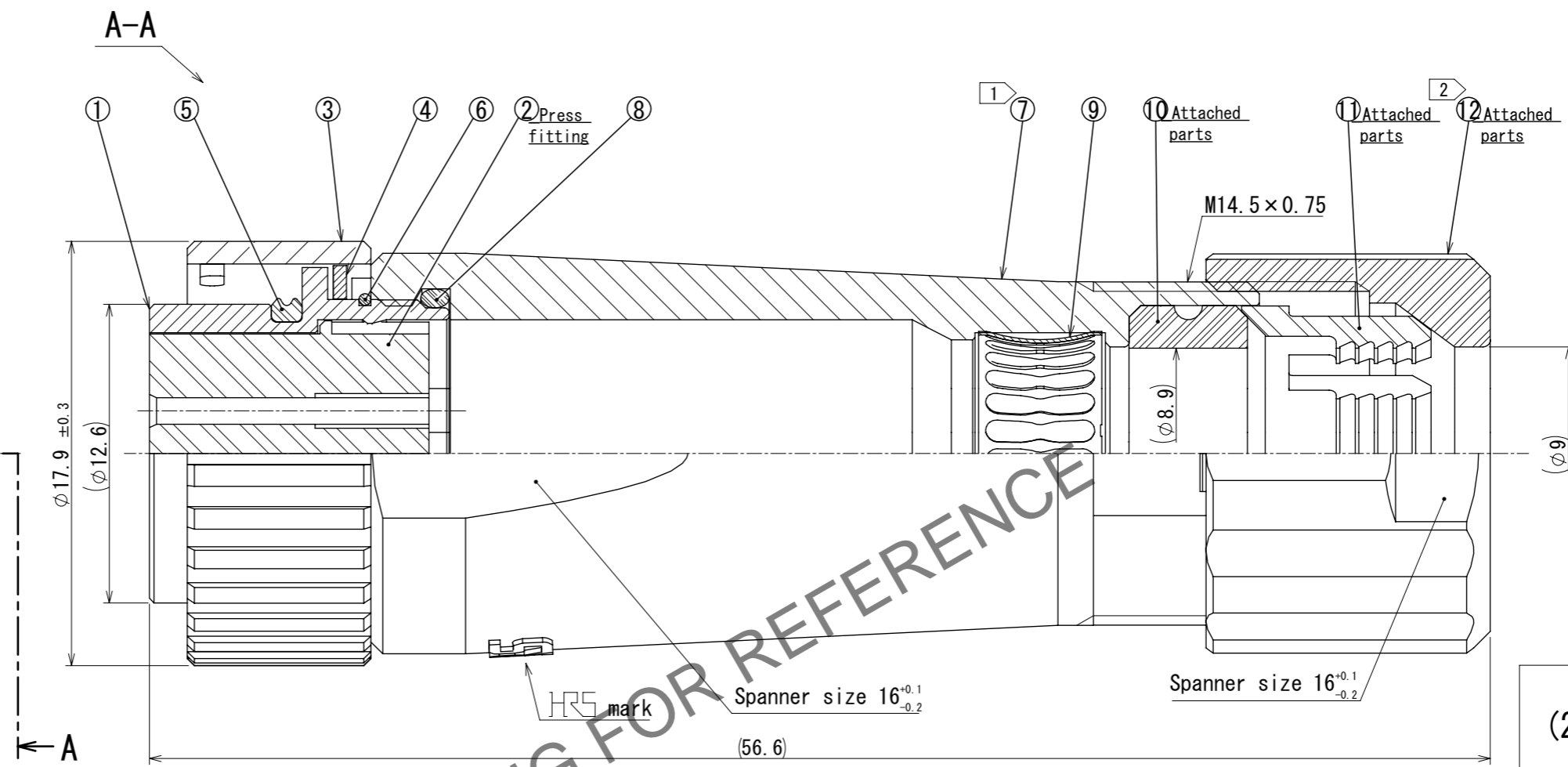
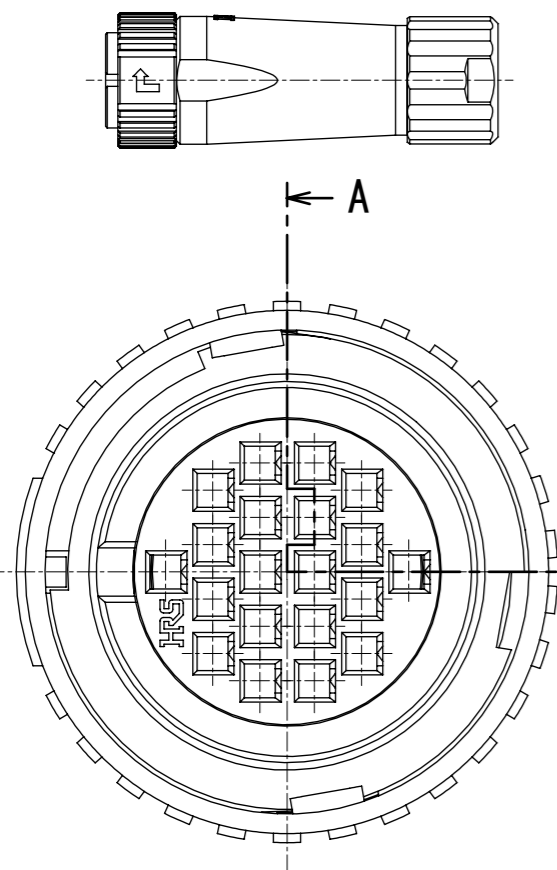
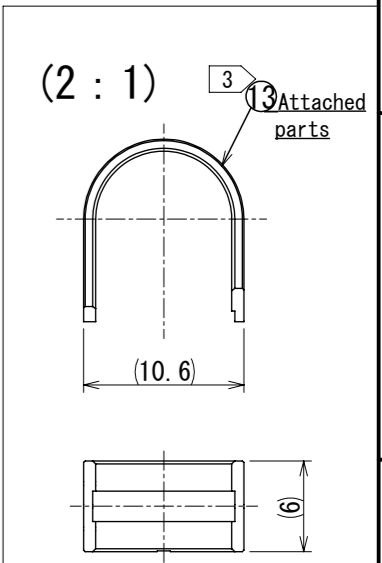
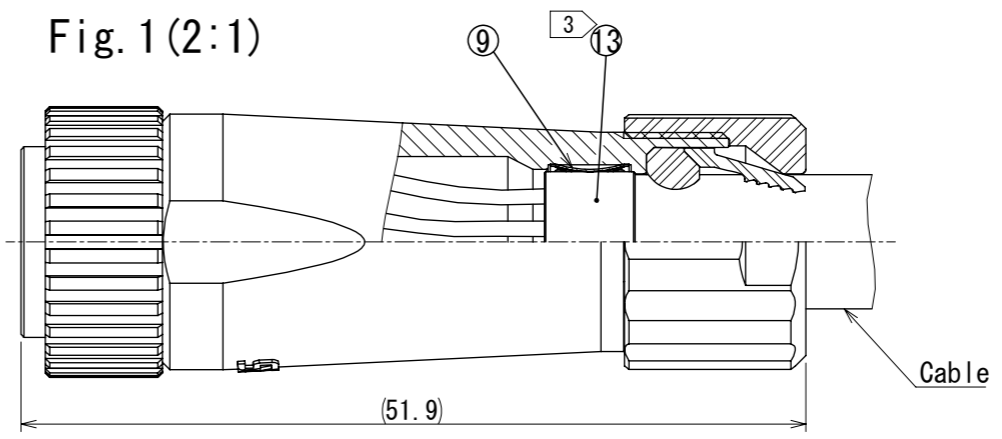

Fig. 1(2:1)



- Notes
- 1 The recommended clamp torque of Ref. No. ⑦ is 1.5 to 2 N·m. Please be sure to apply thread locker to the threaded portion of Ref. No. ①. Recommended thread locker : LOCTITE 263, HENKEL JAPAN LTD.
 - 2 The recommended clamp torque of Ref. No. ⑫ is 1 to 1.5 N·m. Please be sure to apply thread locker to the threaded portion M14.5×0.75 of Ref. No. ⑦. Recommended thread locker : LOCTITE 263, LOCK PRIMER 7649, HENKEL JAPAN LTD.
 - 3 Fasten Ref.No. ⑬ to the cable crimping tool. And make ref.No. ⑬ contact with Ref.No. ⑨(refer to Fig.1). Refer it the technical specification ETAD-C0414-00 for details. Applicable cable crimping tool:LF-TC-01(CL150-0234-6)
 - 4 Fig.2 shows the appearance after assembly.
 - 5 Applicable cable assembly fixture : LF13BP-T01 (CL150-0237-4) Cable assembly fixture is used as a receptacle stand of extract and the part number ① of an assembly.
 - 6 Rotation examples of Ref. ③, ⑦ and ⑫ to ① are shown.
 - 7 The cable retention strength, twisting strength, waterproof tightness, and other characteristics, may differ depending on the cable structure. Please confirm before use.
 - 8 Applicable crimp contact:HR12-SC-211(CL112-0407-6) Applicable cable size:26 to 30 AWG, Insulation outer diameter φ 1 MAX. Applicable extractor:HR12-SC-TP (CL150-0050-3)

7	Zinc alloy	Nickel plating					
6	Stainless steel		13	Brass	Nickel plating		
5	Chloroprene rubber	(Black)	12	Polyphenylene sulfide	(Natural, Brown) UL94V-0		
4	Stainless steel		11	Polyamide	(Natural, Milky white) UL94V-0		
3	Zinc alloy	Nickel plating	10	Chloroprene rubber	(Black)		
2	Polyphenylene sulfide	(Black) UL94V-0	9	Phosphor bronze	Nickel plating		
1	Zinc alloy	Nickel plating	8	Chloroprene rubber	(Black)		
NO.	MATERIAL	FINISH	REMARKS	NO.	MATERIAL	FINISH	REMARKS

UNITS		SCALE	4:1	COUNT	1	DESCRIPTION OF REVISIONS	DESIGNED	CHECKED	DATE
mm						DIS-C-00017013	HT. ZENBA	EJ. KUNII	2024. 03. 11
HRS HIROSE ELECTRIC CO., LTD.		APPROVED	TP. KOMATSU	2024. 01. 11	DRAWING NO.		EDC-383070-00-00		
		CHECKED	KI. NAGANUMA	2024. 01. 11	PART NO.		LF13WBP-20SC		
		DESIGNED	YJ. KOGA	2024. 01. 11	CODE NO.		CL0136-0044-0-00		
		DRAWN	KR. SUZUKI	2024. 01. 11					