

Feb.1.2025 Copyright 2025 HIROSE ELECTRIC CO., LTD. All Rights Reserved.
In case of consideration for using Automotive equipment / device which demand high reliability, kindly contact our sales window correspondents.

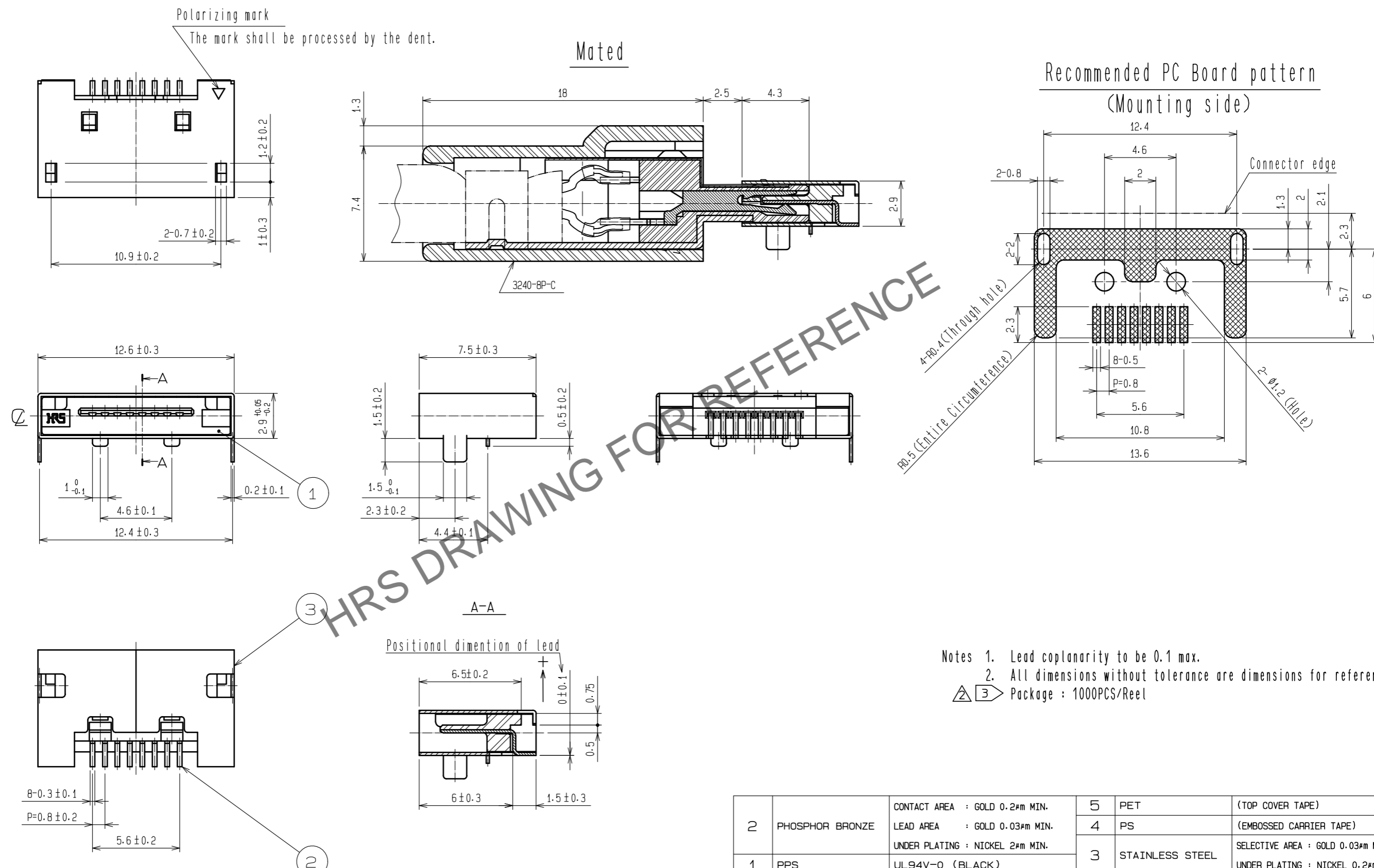

2	PHOSPHOR BRONZE	CONTACT AREA : GOLD 0.2#m MIN. LEAD AREA : GOLD 0.03#m MIN. UNDER PLATING : NICKEL 2#m MIN.	5	PET	(TOP COVER TAPE)
1	PPS	UL94V-0 (BLACK)	4	PS	(EMBOSSD CARRIER TAPE)
			3	STAINLESS STEEL	SELECTIVE AREA : GOLD 0.03#m MIN. UNDER PLATING : NICKEL 0.2#m MIN.
NO.	MATERIAL	FINISH . REMARKS	NO.	MATERIAL	FINISH . REMARKS
UNITS mm		SCALE 4 : 1	COUNT 7	DESCRIPTION OF REVISIONS DIS-E-00011412	
APPROVED : A0. SUZUKI 20060510			DESIGNED	KN. ICHIKAWA	DATE 20221102
CHECKED : NF. MIYAZAKI 20060510			DRAWING NO. EDC3-046586-03		
DESIGNED : HN. ANDO 20060510			PART NO. 3260-8S3(56)		
DRAWN : HN. ANDO 20060510			CODE NO. CL0232-0010-5-56		

Feb.1.2025 Copyright 2025 HIROSE ELECTRIC CO., LTD. All Rights Reserved.
In case of consideration for using Automotive equipment / device which demand high reliability, kindly contact our sales window correspondents.

△ ③ Style and dimension of reel (free)

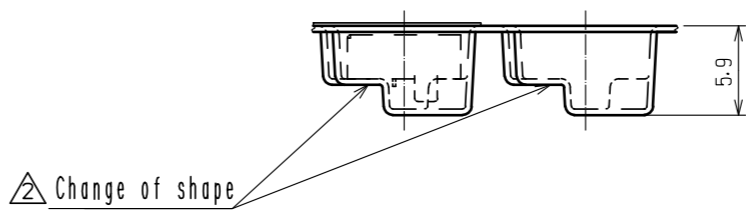
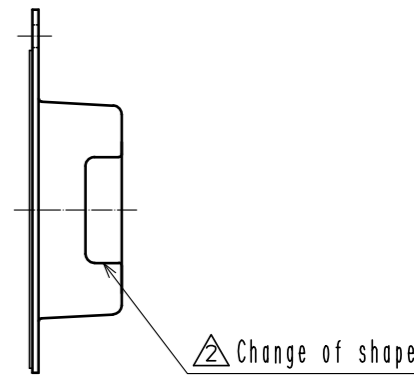
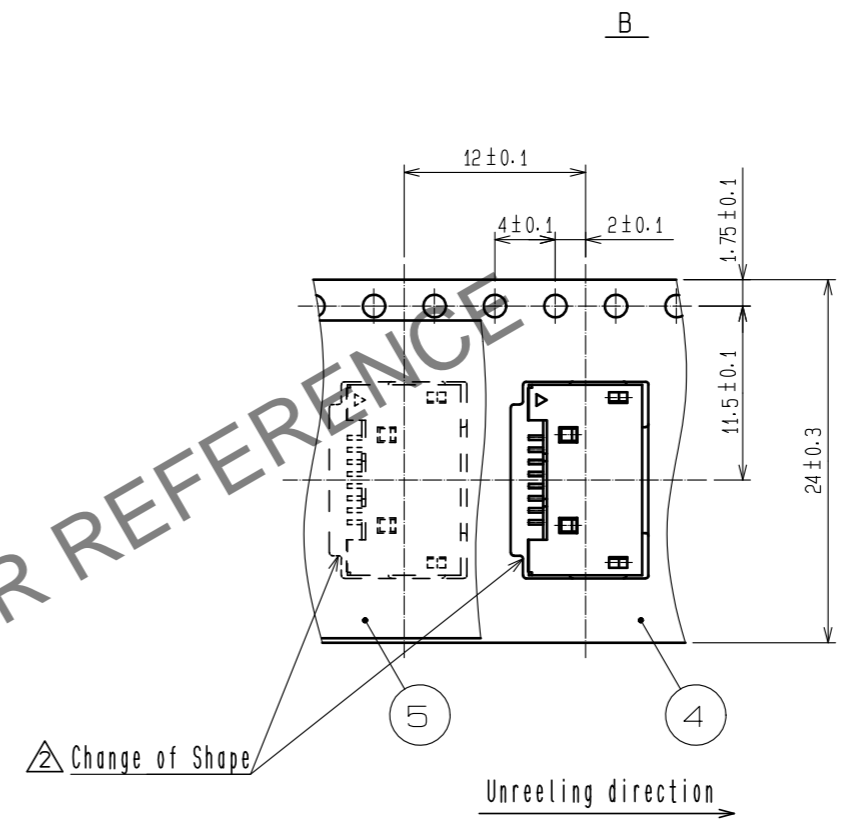
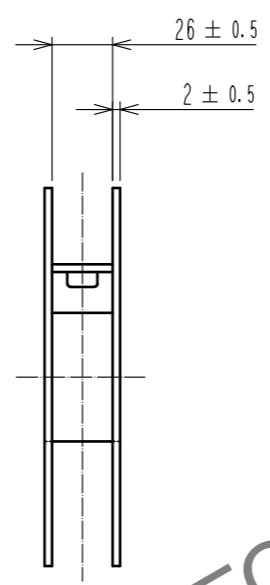
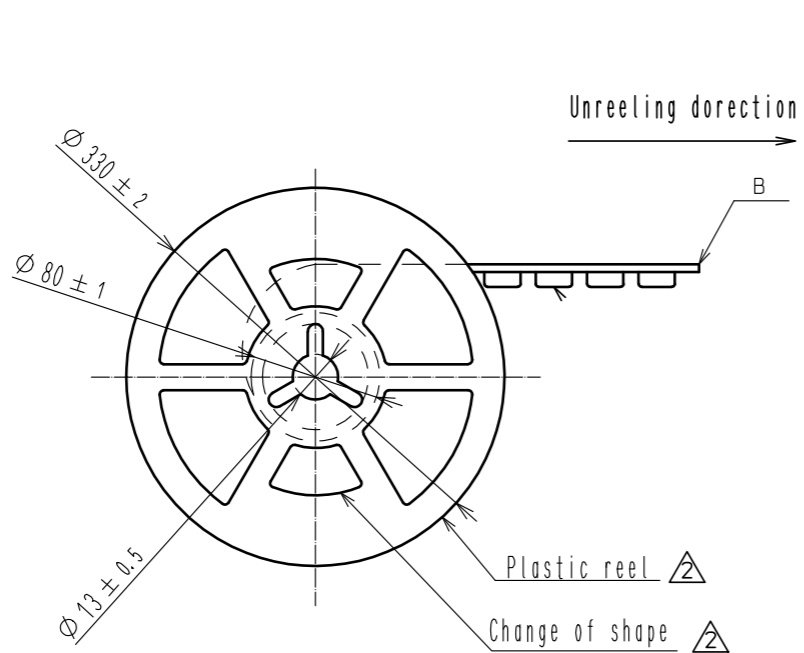

HRS DRAWING FOR REFERENCE

HRS	DRAWING NO.	EDC3-046586-03
	PART NO.	3260-8S3(56)
	CODE NO.	CL0232-0010-5-56

△ 2/2