

Apr.1.2024 Copyright 2024 HIROSE ELECTRIC CO., LTD. All Rights Reserved.  
In case of consideration for using Automotive equipment / device which demand high reliability, kindly contact our sales window correspondents.

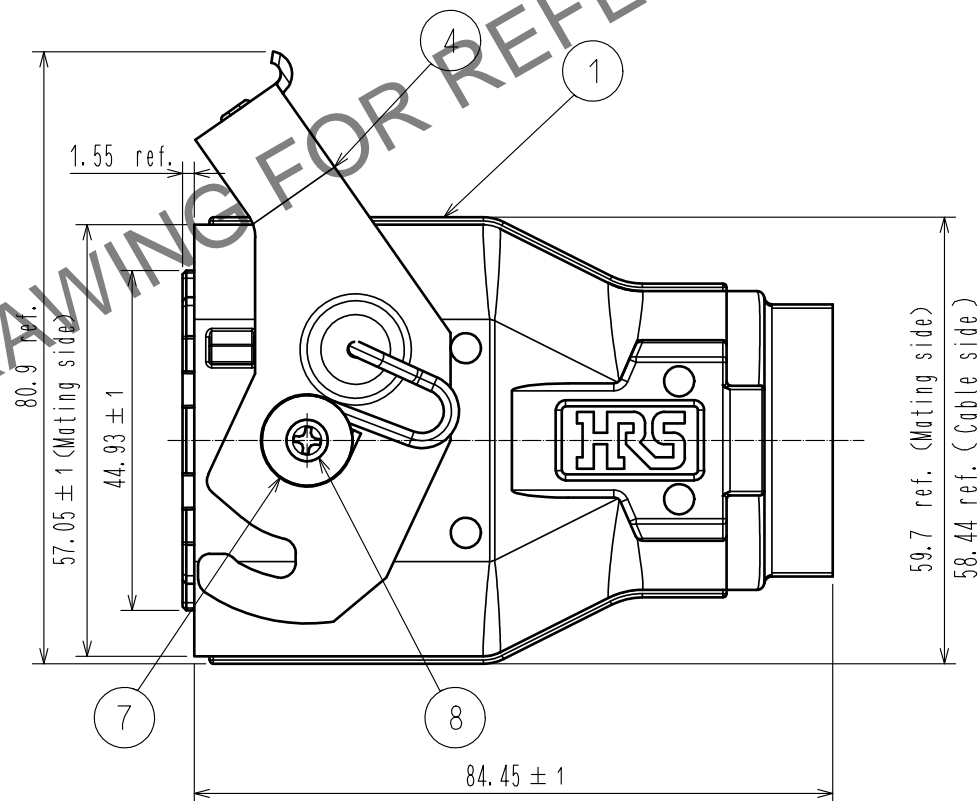

2 Screw for attach to the plug case  
(Ref No. ⑨ attachment)

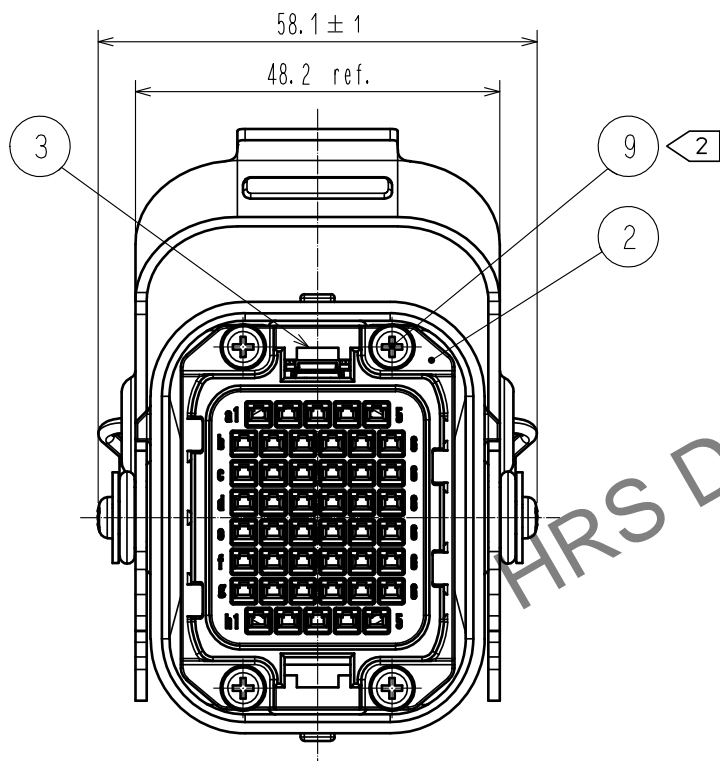
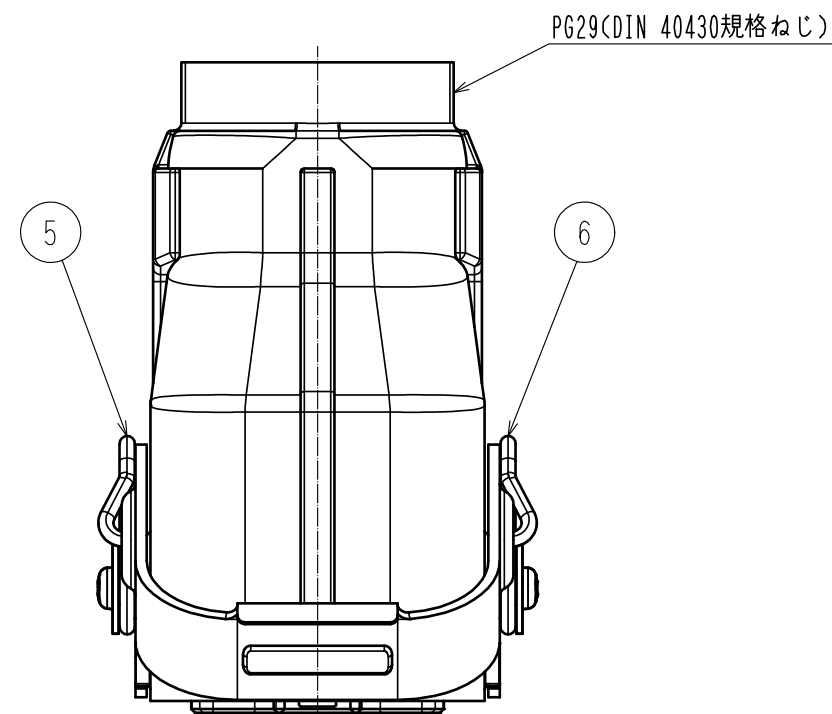
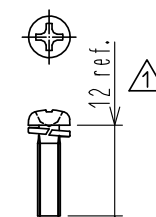

JIS B 1188 : Cross recessed pan head machine screw with  
captive washer M3×0.5×12  $\triangle$

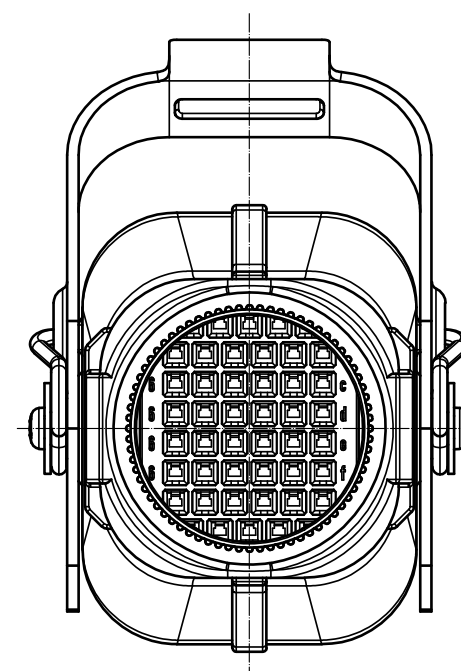

- Note
- Mating key type is 'I'.
  - The screw which attaches S housing plug case (ref No. ②, ③ assembly) and cover case (ref No. ①・④・⑤・⑥・⑦・⑧ assembly) is appended products.  
(recommended tightening torque : 0.32~0.63 N・m)
  - Use recommended screw (commercial item) to attach the crimp terminal to this product.  
(recommended screw JIS B 1188 cross recessed pan head machine screw with captive washer M3×0.5×4  
(recommended tightening torque : 0.32~0.63 N・m)
  - Refer to ETAD-E3149 for the conformity connectors with this product.
  - Refer to ETAD-E3187 for the procedure of the cable assembly.
  - This is a die casting product, molten metal flow patterns and small roughness may appear on the surface.  
However there is no problem in the product functions.
  - Sales unit : 20 pcs/box.

4	Stainless steel		9	Steel	Nickel plating
3	Stainless steel	Nickel plating	8	Steel	Nickel plating
2	PBT	UL94V-0, Black	7	Steel	Nickel plating
1	Aluminum alloy		6	Stainless steel	
			5	Stainless steel	
NO.	MATERIAL	FINISH . REMARKS	NO.	MATERIAL	FINISH . REMARKS
UNITS mm		SCALE 1 : 1	COUNT $\triangle$ 2	DESCRIPTION OF REVISIONS DIS-E-00003564	DESIGNED HY. MATSUDA
HIROSE ELECTRIC CO., LTD.		APPROVED : RI. TAKAYASU	20180709	DRAWING NO.	EDC-129677-00-00
		CHECKED : AH. KODAMA	20180709	PART NO.	PQ50WAS-1UM-46S-PC1
		DESIGNED : TY. MIURA	20180709	CODE NO.	CL0236-2120-0-00
		DRAWN : TY. MIURA	20180709		$\triangle$ 1/3

Apr.1.2024 Copyright 2024 HIROSE ELECTRIC CO., LTD. All Rights Reserved.  
In case of consideration for using Automotive equipment / device which demand high reliability, kindly contact our sales window correspondents.

Plug case  
(Ref No. ②・③ assembly)

A(2:1)

Display the circuit (mating side)

③ M3×0.5 (Through-hole)

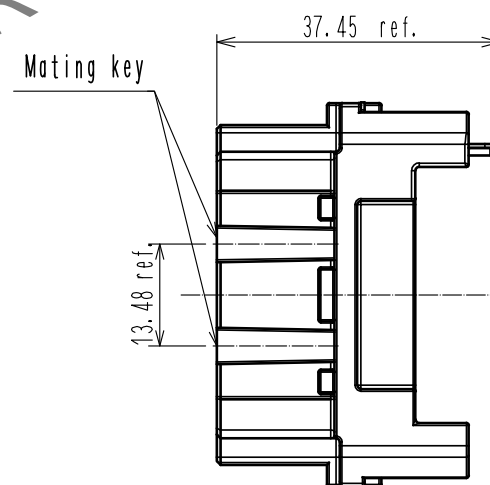
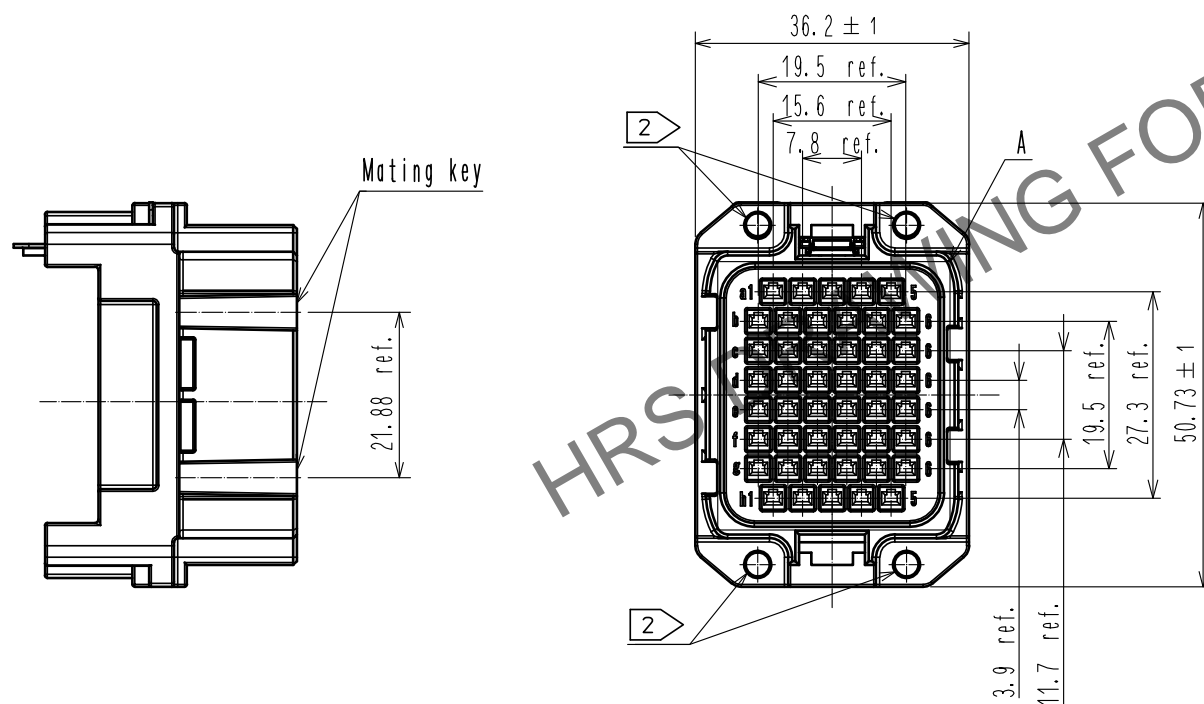
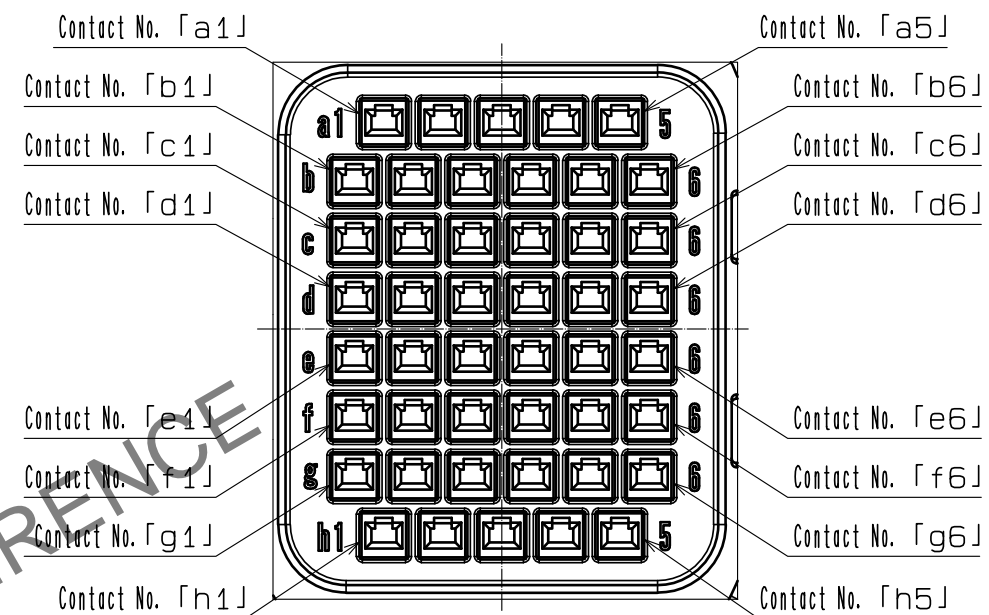

① Mating key type

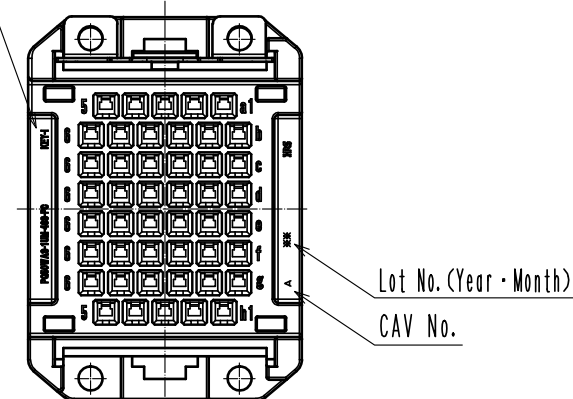

Lot No. (Year・Month)  
CAV No.

HRS

DRAWING NO.	EDC-129677-00-00
PART NO.	PQ50WAS-1UM-46S-PC1
CODE NO.	CL0236-2120-0-00

1/2/3

Apr.1.2024 Copyright 2024 HIROSE ELECTRIC CO., LTD. All Rights Reserved.  
In case of consideration for using Automotive equipment / device which demand high reliability, kindly contact our sales window correspondents.

Cover case

(Ref No. ①・④・⑤・⑥・⑦・⑧ assembly)

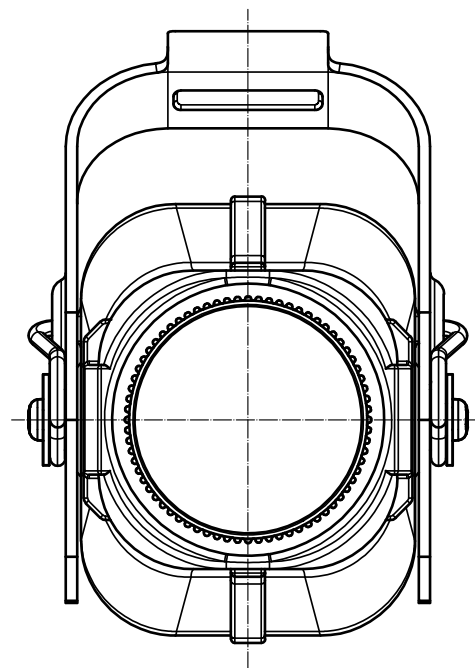
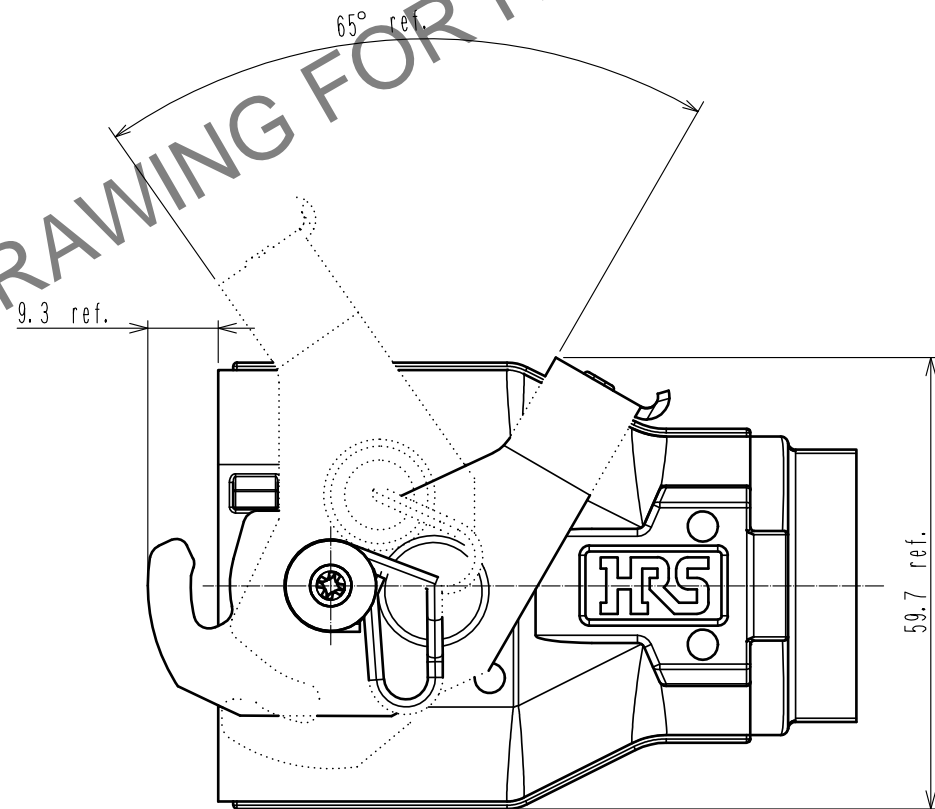
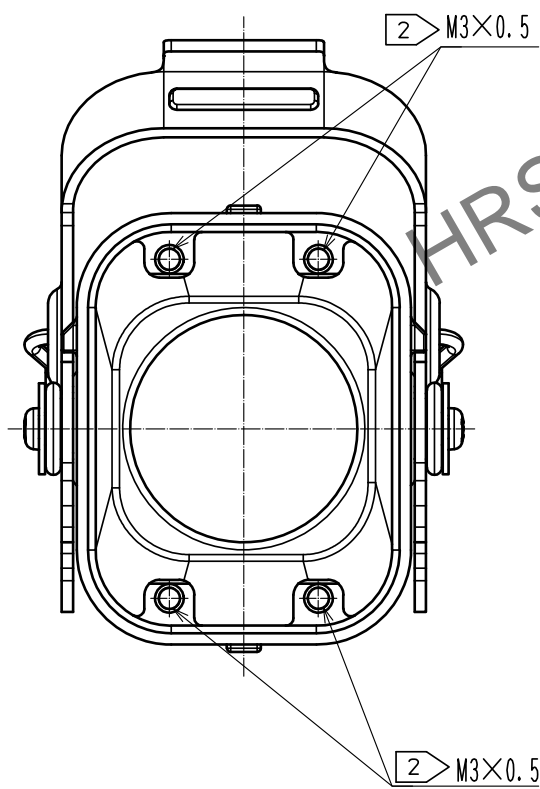
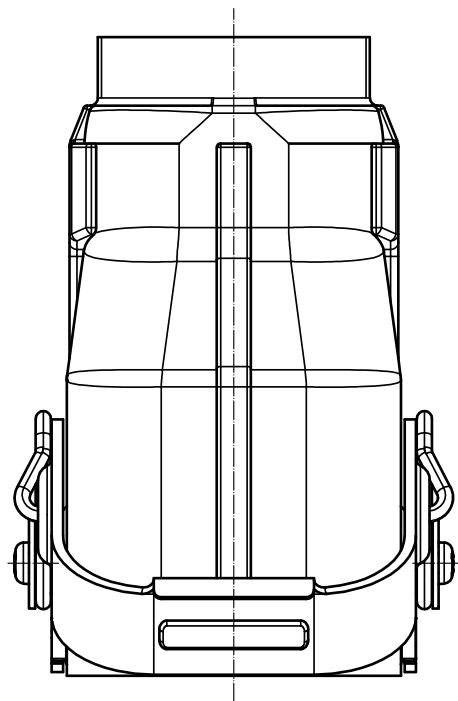

DRAWING NO.	EDC-129677-00-00
PART NO.	PQ50WAS-1UM-46S-PC1
CODE NO.	CL0236-2120-0-00

1/3