

Mar.1.2024 Copyright 2024 HIROSE ELECTRIC CO., LTD. All Rights Reserved.  
In case of consideration for using Automotive equipment / device which demand high reliability, kindly contact our sales window correspondents.

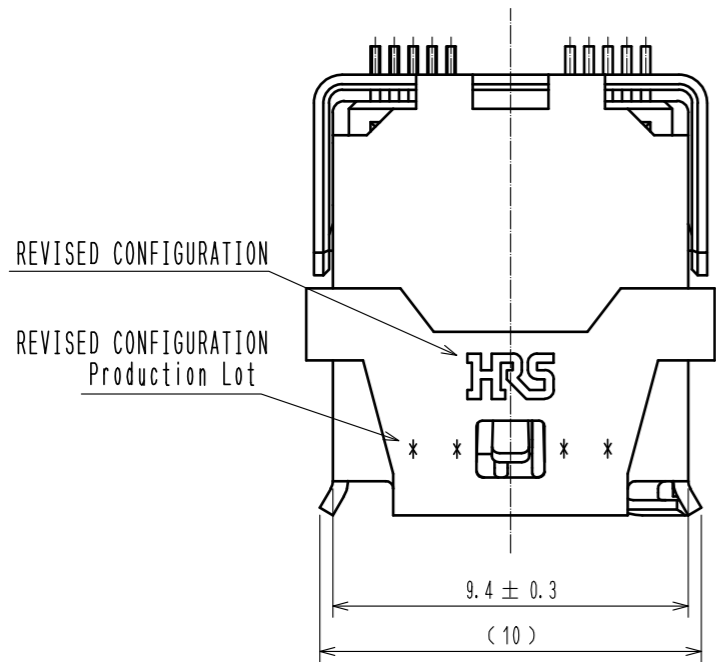

- Notes.
- ① Co-planarity is within 0.1 mm.
  - ② As for part No.5 the performance remains good even if there are rubbing wounds by the assembly process.  
And the performance remains good though there might be a difference in the plating luster between each plating lots.
  - ③ Per reel : 550 pcs.
  - ④ Refer to the mated condition diagram for the panel thickness and layout.
  - ⑤ This product is mounted by reflow soldering.  
Refer to specification sheet ELC-129410-01-00 for reflow soldering.

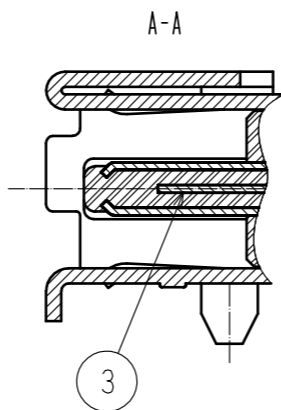
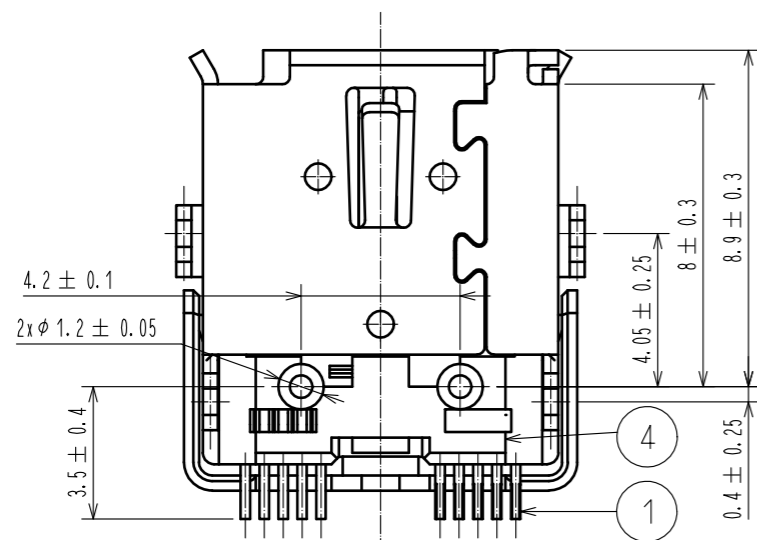
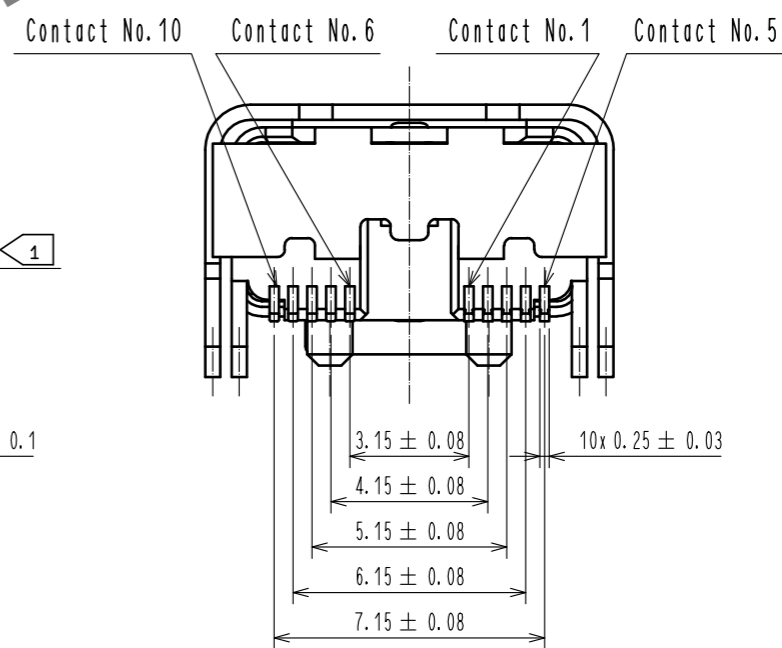
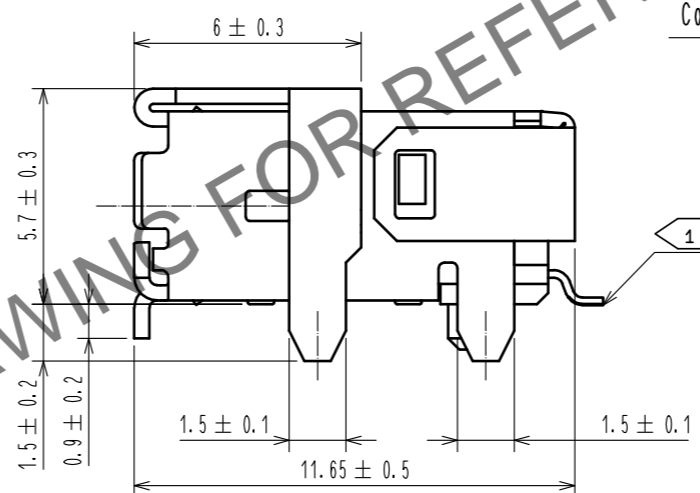
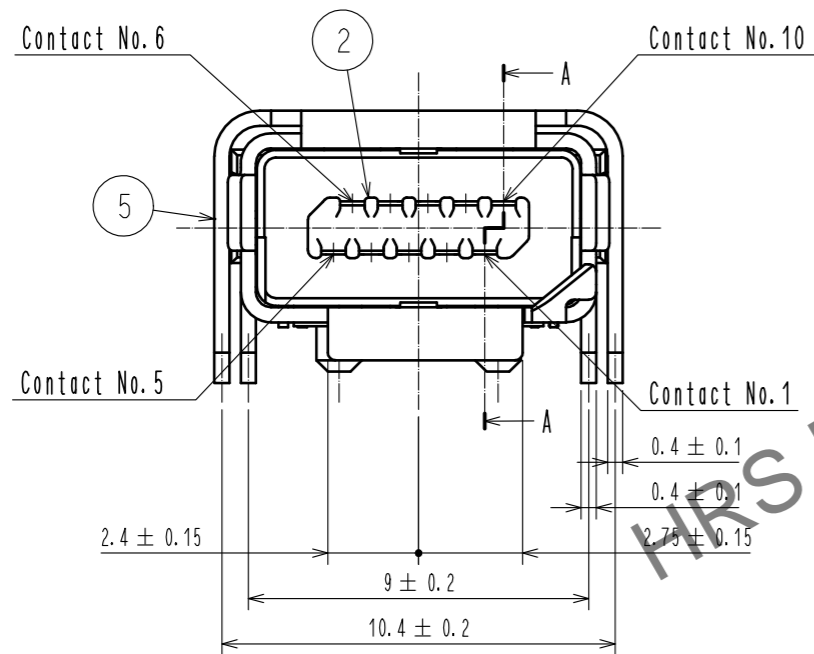

| 3                                    | Stainless Steel |  | 7                               | PE   |   |                         |                  |
|--------------------------------------|-----------------|--|---------------------------------|--|---|-------------------------|------------------|
| 2                                    | LCP             | Gray, UL94V-0  | 6                               | PS   |   |                         |                  |
| 1                                    | Copper Alloy    | Contact area : Palladium-Nickel 0.75 μm min.<br>+ Gold 0.05 μm min.<br>Wiring area : Gold 0.03 μm min.<br>Under plating : Nickel 2 μm min. | 5                               | Stainless Steel                            | Surface : Tin 1 μm min.<br>Under plating : Nickel 0.2 μm min. |                         |                  |
|                                      |                 |  | 4                               | LCP  | Gray, UL94V-0   |                         |                  |
| NO.                                  | MATERIAL        | FINISH . REMARKS   | NO.                             | MATERIAL                                   | FINISH . REMARKS  |                         |                  |
| UNITS<br>mm                          |                 | SCALE<br>5 : 1   | COUNT<br>1                      | DESCRIPTION OF REVISIONS<br>DIS-E-00003684 | DESIGNED<br>SN. TOYOSHIMA                                     | CHECKED<br>KI. KAGOTANI | DATE<br>20201215 |
| <b>HRS</b> HIROSE ELECTRIC CO., LTD. |                 | APPROVED : RI. TAKAYASU 20180913   | DRAWING NO.<br>EDC-129410-01-00 |  |   |                         |                  |
|                                      |                 | CHECKED : RI. TAKAYASU 20180913  | PART NO.<br>IX60G-A-10P(C01)    |  |   |                         |                  |
|                                      |                 | DESIGNED : TS. SAKAIZAWA 20180913  | CODE NO.<br>CL0251-0016-0-01    |  |   |                         |                  |
|                                      |                 | DRAWN : TS. SAKAIZAWA 20180913   |                                 |  |   |                         |                  |

Mar.1.2024 Copyright 2024 HIROSE ELECTRIC CO., LTD. All Rights Reserved.  
 In case of consideration for using Automotive equipment / device which demand high reliability, kindly contact our sales window correspondents.

Reference PCB Layout (Connector Mounting Side) (t = 1.6)

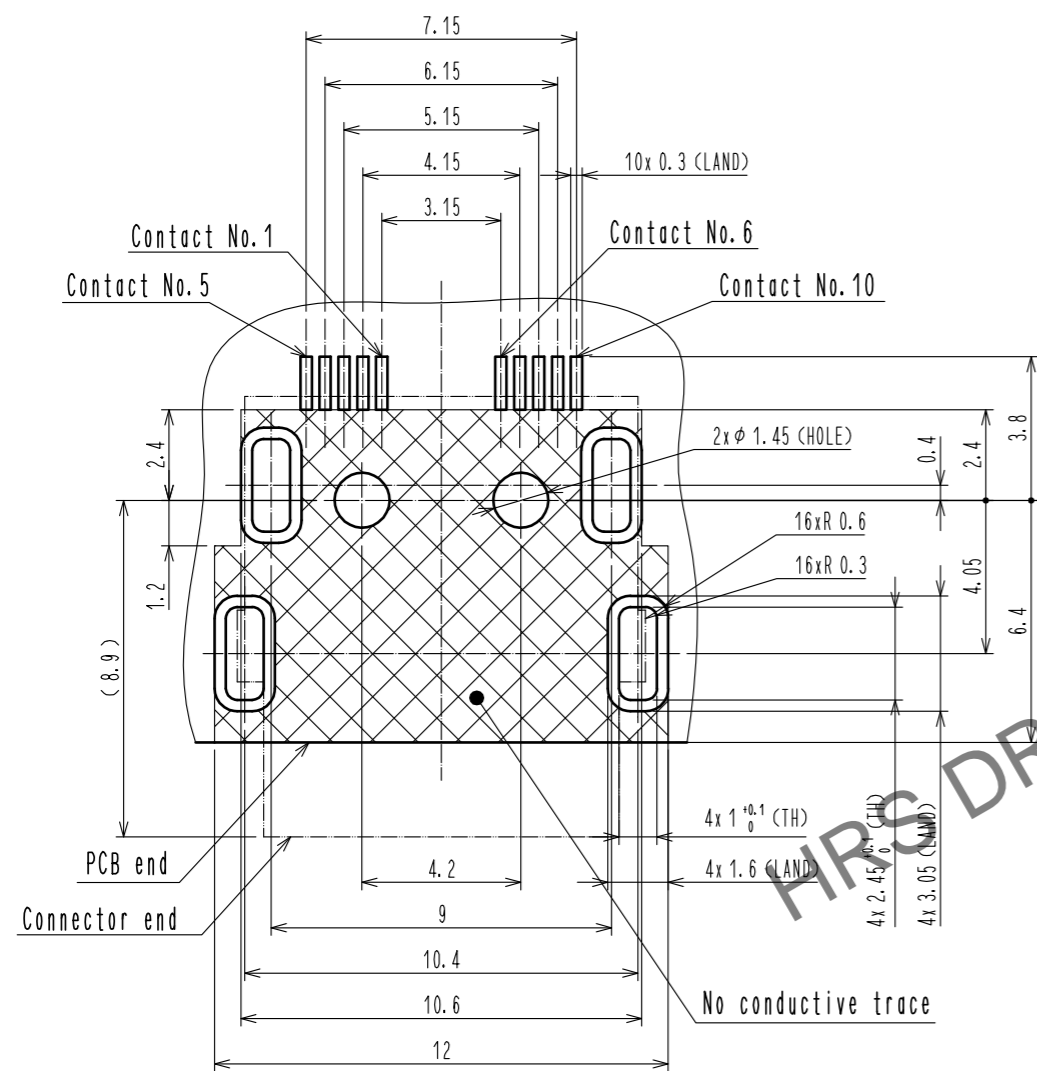

Reference Metal Mask Layout (t = 0.15)

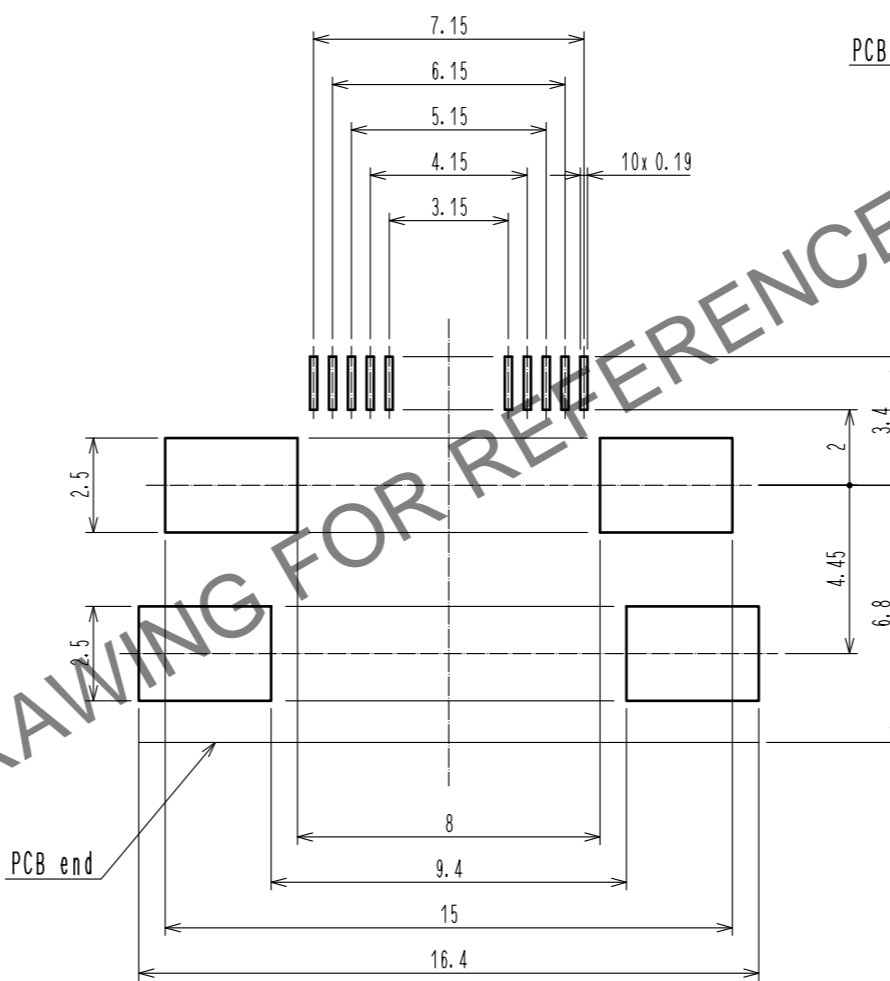

Mated Condition (Free)

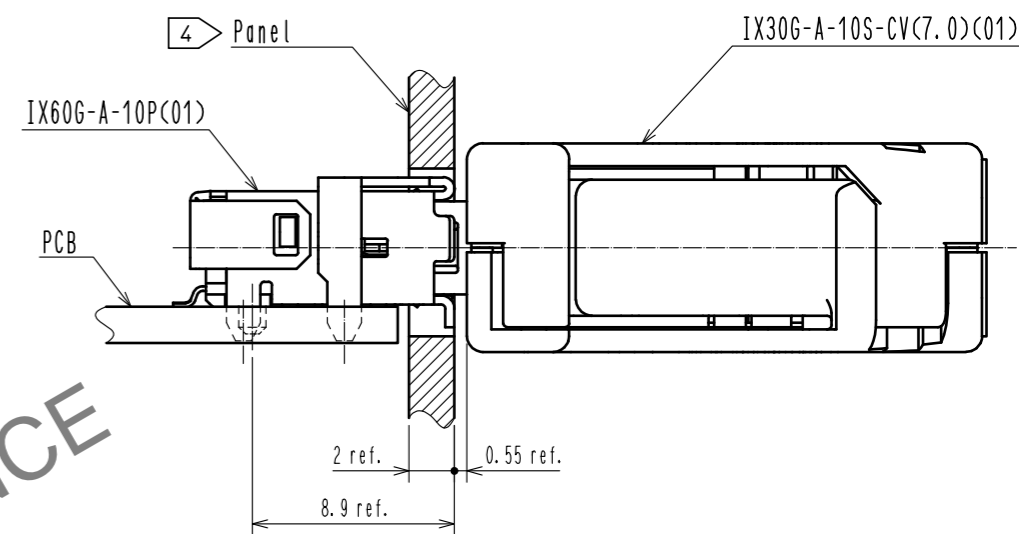

Reference Dimensions of Panel Cutout (Free)

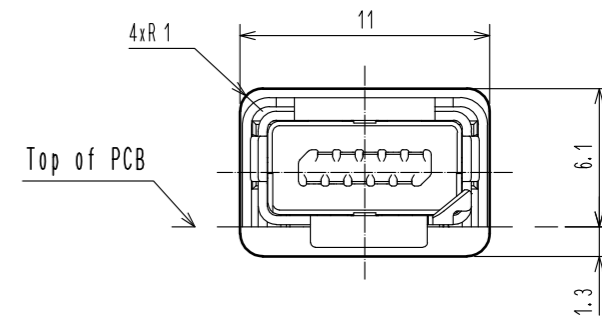

- Thickness of metal mask is 0.1 mm min.
- Metal mask dimensions of the drawings described, are reference dimensions for 0.15 mm thickness metal mask.
- Change the metal mask dimensions by thickness of the metal mask, thickness of PCB, component of solder paste and mounting conditions.
- Change the metal mask dimensions in case of mounting IX60G-+-10P in parallel.
- Change the metal mask dimensions, if there are other mounting parts or implementation pattern around the portion of mounting position of IX60G-+-10P.

(Deleted)

|            |             |                  |
|------------|-------------|------------------|
| <b>HRS</b> | DRAWING NO. | EDC-129410-01-00 |
|            | PART NO.    | IX60G-A-10P(01)  |
|            | CODE NO.    | CL0251-0016-0-01 |

Mar.1.2024 Copyright 2024 HIROSE ELECTRIC CO., LTD. All Rights Reserved.  
 In case of consideration for using Automotive equipment / device which demand high reliability, kindly contact our sales window correspondents.

③ Drawing for packing (Free)

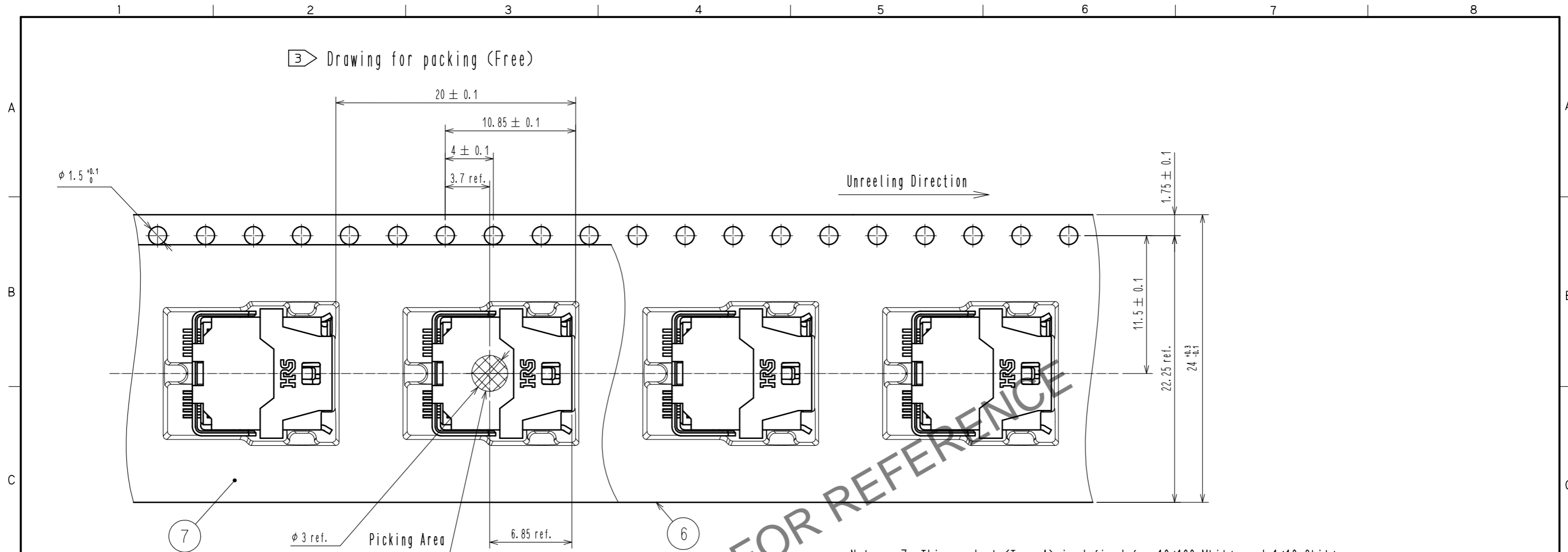

Notes. 7. This product (Type A) is defined for 10/100 Mbit/s and 1/10 Gbit/s Ethernet communication. Please use Type B for all other non Ethernet applications like signaling, serial or other industrial bus communication systems.

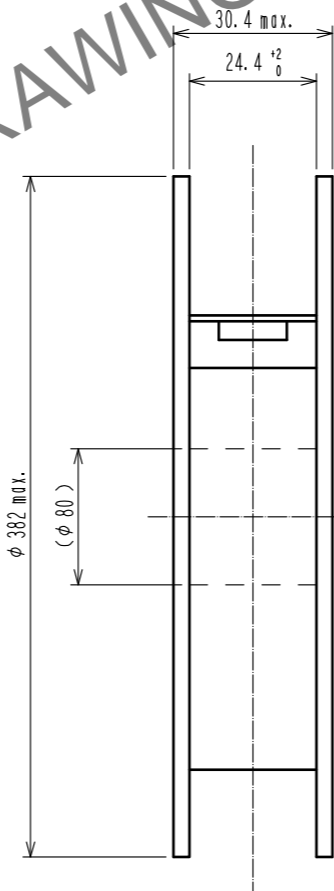
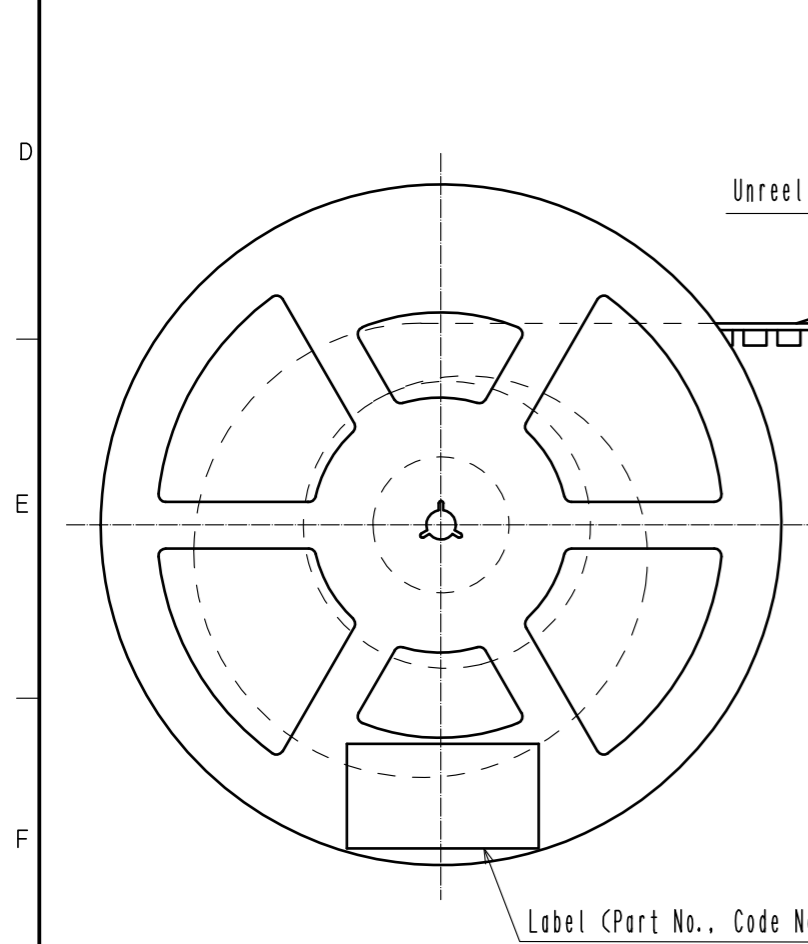

Mating Shape

Pin Assignment For 10/100 Mbit/s And 1/10 Gbit/s Ethernet

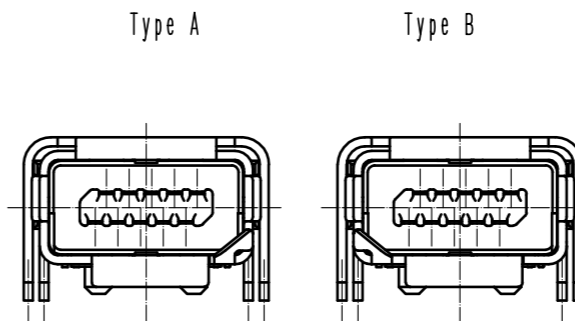

| Contact No. | Signal        |             |
|-------------|---------------|-------------|
|             | 10/100 Mbit/s | 1/10 Gbit/s |
| 1           | TX+           | BI_DA+      |
| 2           | TX-           | BI_DA-      |
| 3           | N. C          | GND         |
| 4           | N. C          | BI_DC+      |
| 5           | N. C          | BI_DC-      |
| 6           | RX+           | BI_DB+      |
| 7           | RX-           | BI_DB-      |
| 8           | N. C          | GND         |
| 9           | N. C          | BI_DD+      |
| 10          | N. C          | BI_DD-      |

|            |             |                  |
|------------|-------------|------------------|
| <b>HRS</b> | DRAWING NO. | EDC-129410-01-00 |
|            | PART NO.    | IX60G-A-10P(01)  |
|            | CODE NO.    | CL0251-0016-0-01 |
|            |             | 3/3              |