

Aug.1.2022 Copyright 2022 HIROSE ELECTRIC CO., LTD. All Rights Reserved.  
 In case of consideration for using Automotive equipment / device which demand high reliability, kindly contact our sales window correspondents.

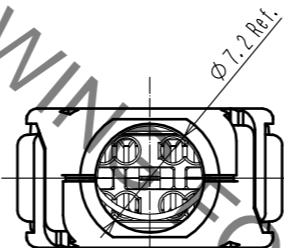
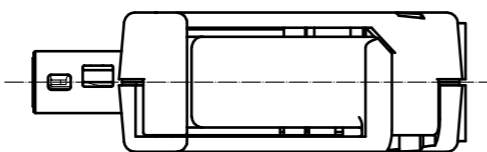
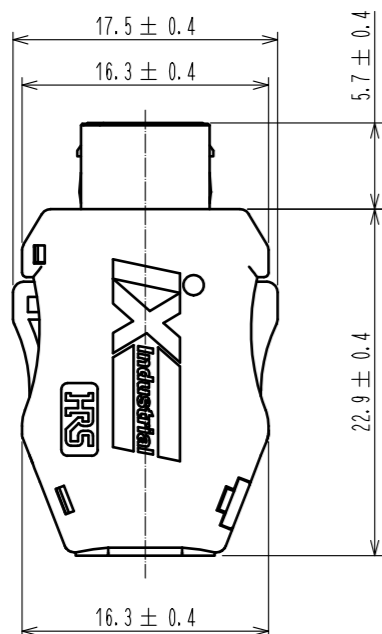
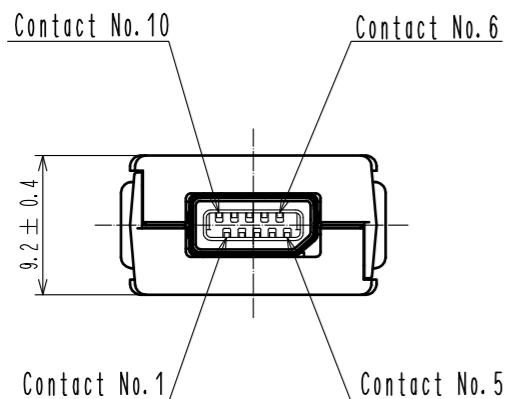
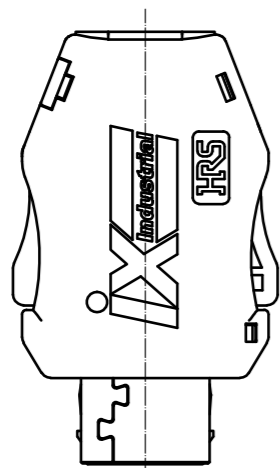

- Notes.
1. Recommended cable condition is shown below.  
 ⚠ A list of compatible cables is available on the Hirose website.  
 When using a non-recommended cable, please contact a Hirose sales representative.  
 Refer to the technical specification (ETAD-E3162) for wiring and assembly procedures.  
 Tool HT803/IXG-8/10S-63-72 is used for cable assembly of IX32G.

⚠ Recommended Cable

Items		Recommended Condition
Conductor	Size	AWG22
	Composition	7 stranded
	Material	Annealed copper wire
Insulation O. D.		φ 1.4 to 1.6mm
Braid Shield		Tin plating
Sheath O. D.		φ 6.3 to 7.2mm

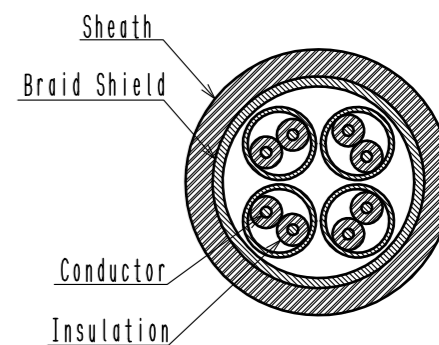

2. This product (Type B) is used for non Ethernet applications like signaling, serial or other industrial bus communication systems.  
 Please use Type A for 10/100 Mbit/s and 1/10 Gbit/s Ethernet communication.

⚠ Mating Key

Type A

Type B

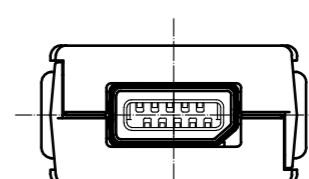
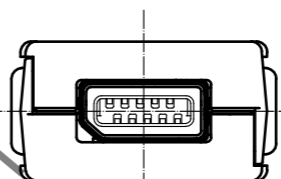

3. Excluding the plug unit, this product is packaged separately by the type of parts.  
 The shield shell is packaged prior to bending. (See next page.)

4. Cable assembly is possible up to 8pos.  
 Contact No. 3 and 8 do not have a hole to pass the cable through the IDC guide.

4	PA	Black, UL94V-0	8	PC	Dark gray, UL94V-0		
3	Stainless Steel		7	Stainless Steel	Nickel 0.2 μm min		
2	PA	Dark gray, UL94V-0	6	Stainless Steel	Nickel 1 μm min		
1	Copper Alloy	Contact area : Gold 0.2 μm min Wiring area : Gold 0.03 μm min Under plating : Nickel 2 μm min	5	PC	Clear blue, UL94V-0		
NO.	MATERIAL	FINISH . REMARKS	NO.	MATERIAL	FINISH . REMARKS		
UNITS mm		SCALE 2 : 1	COUNT 6	DESCRIPTION OF REVISIONS DIS-E-00006883	DESIGNED MT. YASUDA	CHECKED KI. KAGOTANI	DATE 20211025
<b>HRS</b> HIROSE ELECTRIC CO., LTD.		APPROVED : RI. TAKAYASU 20180730	DRAWING NO. EDC-129830-00-00				
		CHECKED : KI. NAGANUMA 20180727	PART NO. IX32G-B-8S-CV(7.0)				
		DESIGNED : JY. IGA 20180727	CODE NO. CL0251-0043-0-00				
		DRAWN : JY. IGA 20180727					

Aug.1.2022 Copyright 2022 HIROSE ELECTRIC CO., LTD. All Rights Reserved.  
 In case of consideration for using Automotive equipment / device which demand high reliability, kindly contact our sales window correspondents.

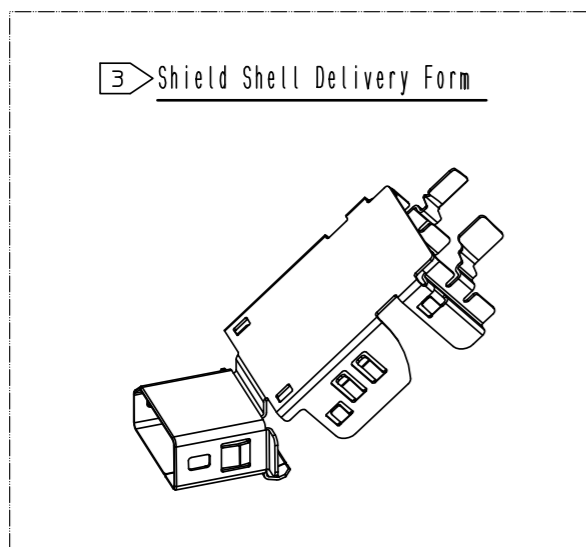

Product Structure

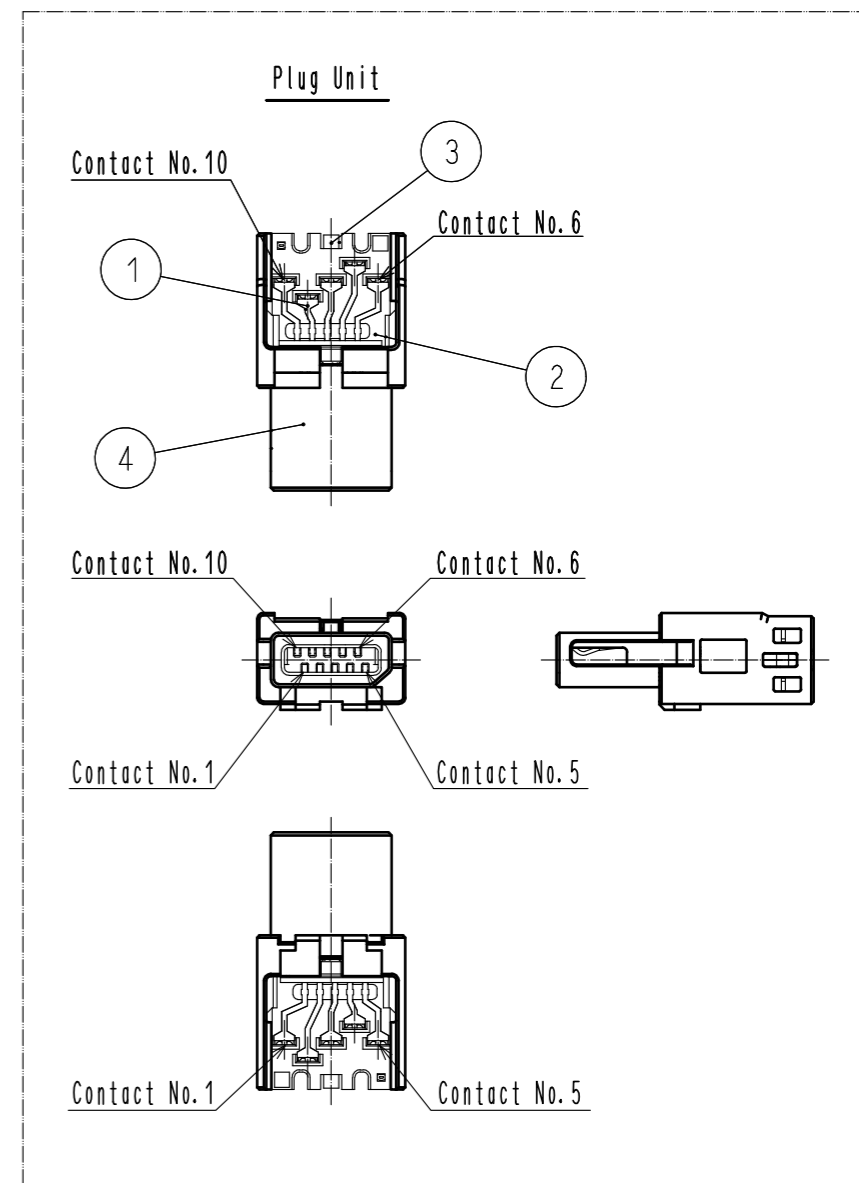
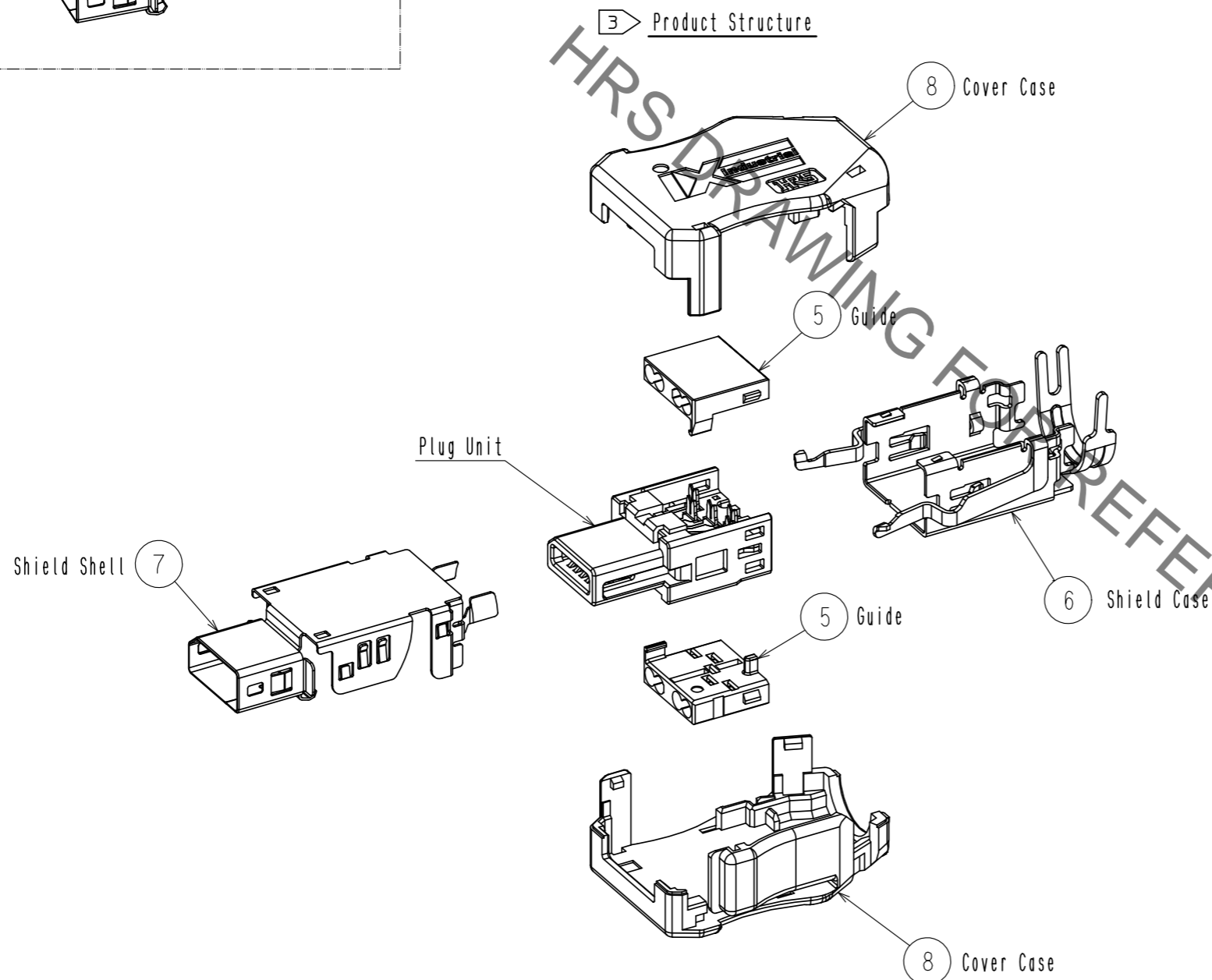

Mated Condition

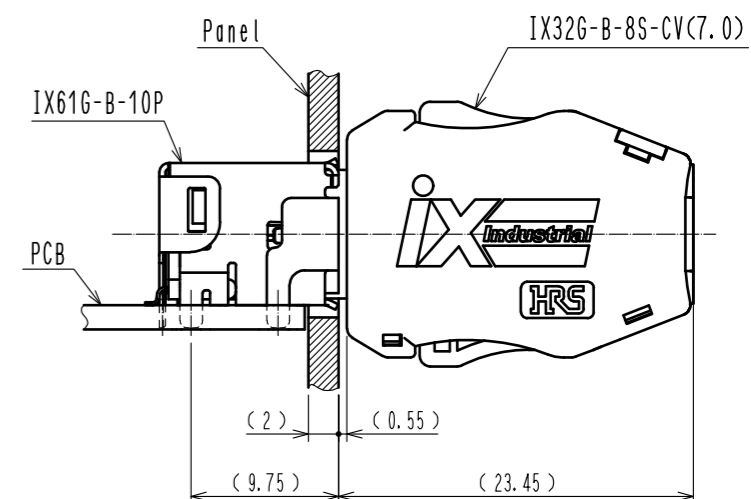

<b>HRS</b>	DRAWING NO.	EDC-129830-00-00	3/2
	PART NO.	IX32G-B-8S-CV(7.0)	
	CODE NO.	CL0251-0043-0-00	