

May.1.2024 Copyright 2024 HIROSE ELECTRIC CO., LTD. All Rights Reserved.
In case of consideration for using Automotive equipment / device which demand high reliability, kindly contact our sales window correspondents.

Contact arrangements viewed from the mating side,
mating key / applicable contact example.

1~16:Signal contact MRF20-PC-211(CL313-0745-1)
A~D :Coaxial contact PQ21A(75)-P-084(CL330-0463-5-00)

Harness drawing

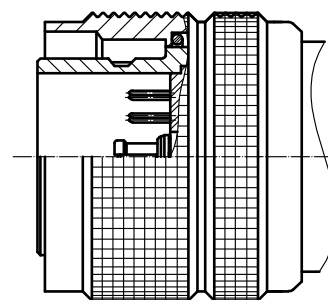
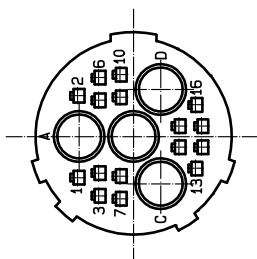

ASSEMBLY TOOL

PART⑦ CRIMPING TOOL : HR10A-TC-04(CL150-0058-5)

※SIGNAL/COAXIAL CONNECTOR'S TOOL SHOULD REFER TO EACH DRAWING.

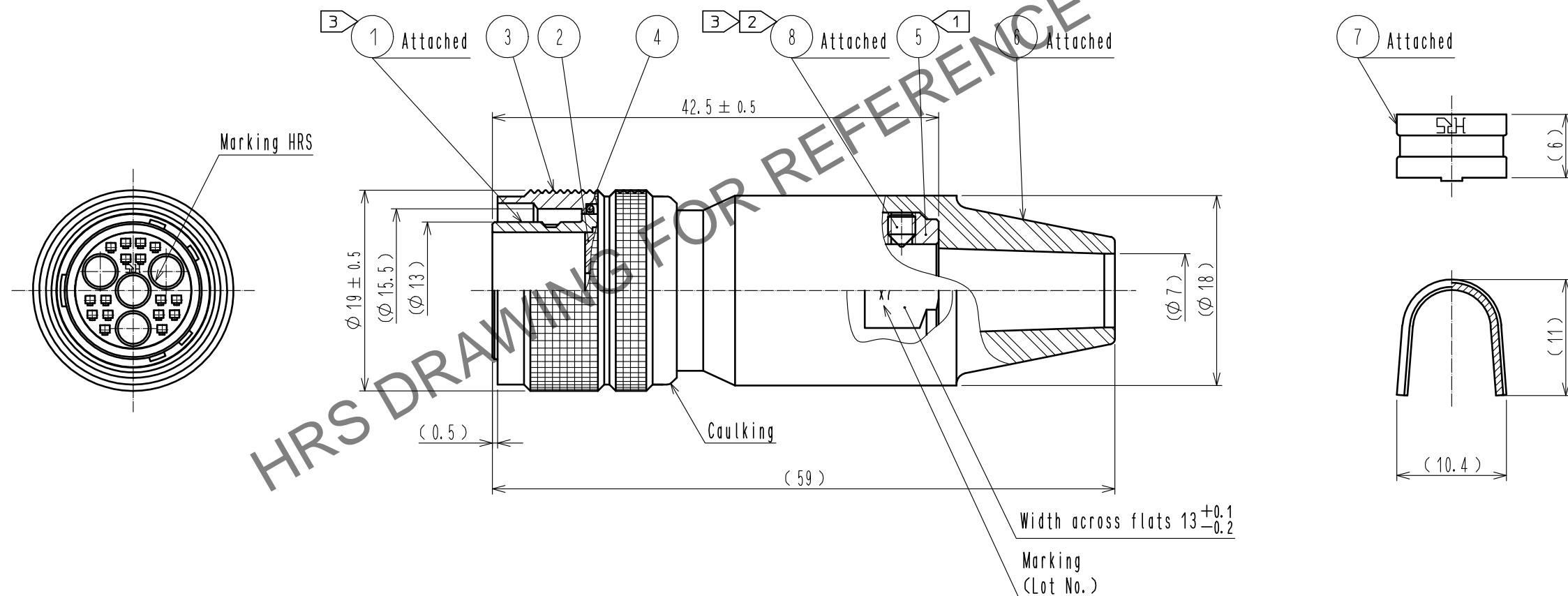

- NOTES
- ① THE RECOMMENDED CLAMP TORQUE, REF.NO. ⑤ : 2 TO 2.5N · m.
 - ② ACROSS FLATS HEXAGON HEAD OF REF.NO. ⑥ : 1.27
THE RECOMMENDED CLAMP TORQUE, REF.NO. ⑥ : 0.3 TO 0.4N · m.
REF.NO. ⑥ SHALL BE TIGHTENED WITH ITS TIPS PRESSED INTO THE DIMPLE AREA OF REF. NO. ⑦.
 - ③ LOCTITE 242 , HENKEL JAPAN OR EQUIVALENT IS RECOMMENDED TO PREVENT REF.NO. ① AND ⑥ FROM LOOSENING.
 4. ONE EXAMPLE OF THE ROTATION OF REF.NO. ⑤ TO REF.NO. ① IS SHOWN.
 5. THE CABLE STRENGTH, ROTATORY STRENGTH AND OTHER CHARACTERISTICS MAY DIFFER,
DEPENDING ON THE CABLE STRUCTURE. PLEASE CONFIRM BEFORE THE USE.

4	STEEL	NICKEL PLATING	8	STEEL	NICKEL PLATING
3	BRASS	NICKEL PLATING	7	BRASS	
2	PBT	(BLACK)	6	CHLOROPRENE RUBBER	(BLACK)
1	ZINC ALLOY	MATTE FINISH NICKEL PLATED	5	BRASS	NICKEL PLATING
NO.	MATERIAL	FINISH , REMARKS	NO.	MATERIAL	FINISH , REMARKS
UNITS mm		SCALE 2 : 1	COUNT	DESCRIPTION OF REVISIONS	DESIGNED
HRS		APPROVED : NK. NINOMIYA	20211228	DRAWING NO.	EDC-380782-00-00
HIROSE ELECTRIC CO., LTD.		CHECKED : NK. NINOMIYA	20211228	PART NO.	MRF20-13P-16PC/4RF
		DESIGNED : MT. KANEKO	20211228	CODE NO.	CL0313-0751-0-00
		DRAWN : NK. OOSHIMA	20211224		