

Part No.	Cable color
~068*1T~	GRAY
~068*2T~	BLACK

NOTE 1 We indicate the length of the harness on the last of product name, 'L' part.

2 Tolerance for [L]

Length L [mm]	Tolerance [mm]
$35 \leq L \leq 200$	± 4
$200 < L \leq 500$	± 8
$500 < L \leq 1000$	± 12
$1000 < L$	$\pm 1.5\%$

3 Connector rotation angle is within ± 45 degree from the above image.
For long length in the case of $L > 500$, the angle is optional.

4. Specifications are subject to change without notice.

【 DIMENSIONS OF CONNECTOR 】

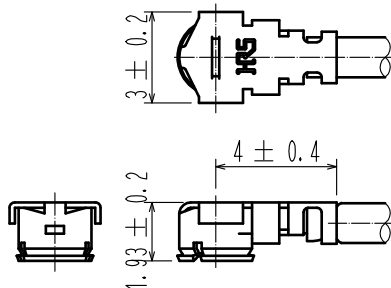

1	U.FL-LP-068HF	CL331-0566-4	2	1.13 Dia. coaxial cable
NO.	PART NO.	CODE NO.	NO.	PART NO.

HALOGEN FREE

UNITS mm	SCALE FREE	COUNT	DESCRIPTION OF REVISIONS	DESIGNED	CHECKED	DATE

HRS HIROSE
ELECTRIC
CO., LTD.

APPROVED	TS. NOBE	18.06.19
CHECKED	MT. KANEKO	18.06.19
DESIGNED	MS. MATSUMOTO	18.06.19
DRAWN	MS. MATSUMOTO	18.06.19

DRAWING NO.	
PART NO.	UFL-2HF6-068**T-AC-L
CODE NO.	