

| Part No. | Cable color |
|----------|-------------|
| ~066*1~  | GRAY        |
| ~066*2~  | BLACK       |

NOTE 1 We indicate the length of the harness on the last of product name, 'L' part.

2 Tolerance for [ L ]

| Length L [mm]        | Tolerance [mm] |
|----------------------|----------------|
| $35 \leq L \leq 200$ | $\pm 4$        |
| $200 < L \leq 500$   | $\pm 8$        |
| $500 < L \leq 1000$  | $\pm 12$       |
| $1000 < L$           | $\pm 1.5\%$    |

3 Connector rotation angle is within  $\pm 45$  degree from the above image.  
For long length in the case of  $L > 500$ , the angle is optional.

4. Specifications are subject to change without notice.

#### 【 DIMENSIONS OF CONNECTOR 】

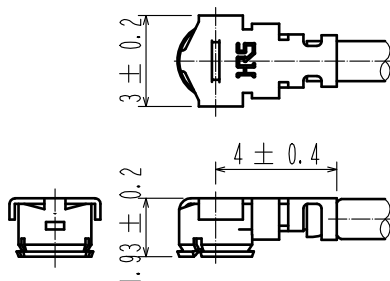

|     |               |              |     |                         |
|-----|---------------|--------------|-----|-------------------------|
| 1   | U.FL-LP-066HF | CL331-0558-6 | 2   | 1.32 Dia. coaxial cable |
| NO. | PART NO.      | CODE NO.     | NO. | PART NO.                |

HALOGEN FREE

| UNITS<br>mm                          | SCALE<br>FREE | COUNT<br>1 | DESCRIPTION OF REVISIONS<br>DIS-D-00003255 | DESIGNED<br>MS. MATSUMOTO               | CHECKED<br>MT. KANEKO | DATE<br>18. 06. 19 |
|--------------------------------------|---------------|------------|--|---|-----------------------|--------------------|
| <b>HRS</b> HIROSE ELECTRIC CO., LTD. |               |            | APPROVED : NK. NINOMIYA 16. 07. 25         | DRAWING NO.<br>U. FL-2LPHF6-066**-A-L 1 |                       |                    |
|                                      |               |            | CHECKED : MT. KANEKO 16. 07. 25            |   |                       |                    |
|                                      |               |            | DESIGNED : MS. MATSUMOTO 16. 07. 25        |   |                       |                    |
|                                      |               |            | DRAWN : MS. MATSUMOTO 16. 07. 25           |   |                       |                    |