

TO

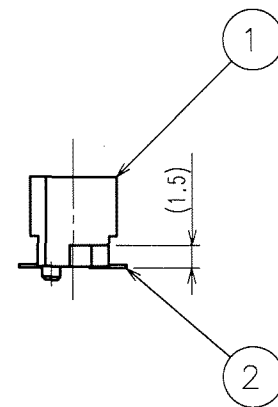

Technical drawing of a mechanical part showing a cross-section. The drawing includes the following dimensions:

- Overall width: 7.1 ± 0.3
- Width of the central section: 1.5 ± 0.2
- Overall height: 6 ± 0.25
- Dimension of the bottom flange: (0.1)

- NOTE 1 HRS MARK SHALL BE OPTIONAL.
- 2 LEAD CO-PLANARITY SHALL BE 0.1mm MAX.
 - 3 EMBOSSED CARRIER TAPE PACKAGING SHALL BE APPLIED TO THIS PRODUCT.
SEE NEXT PAGE FOR DETAILS.
 - 4 THIS PRODUCT HAS TAPE FOR VACUUM PICKUP.
SEE NEXT PAGE FOR DETAIL OF STICKING POSITION,ETC.
 - 5 FOR MODIFICATION,ETC,PREVENTIVE HOLE FOR SINK MARK MAY BE
ADDED ACCORDING TO CIRCUMSTANCES.
 - 6 THE DIMENSIONS IN PARENTHESES ARE FOR REFERENCE.

1	PPS	LIGHT BROWN (UL94V-0)	2	PHOSPHOR BRONZE	CONTACT AREA:GOLD 0.1μ m min.
					LEAD AREA:TIN-PLATING 1μ m min.
					UNDER PLATING:NICKEL 2μ m min.
NO.	MATERIAL	FINISH, REMARKS	NO.	MATERIAL	FINISH, REMARKS
CODE NO.(OLD)		DRAWN	DESIGNED	CHECKED	APPROVED
		S.KAMIGA 06.09.28	K. Nakamura 06.09.28	K. Ogawa 06.09.30	H. Okawa 06.09.30
		DRAWING NO. EDC3-084978-23		PART NO. FX6-20S-0.8SV2(93)	
SCALE 2 : 1		HRS HIROSE ELECTRIC CO., LTD		CODE NO. CL576-0121-5-93	
UNITS mm				1/2	

May.1.2024 Copyright 2024 HIROSE ELECTRIC CO., LTD. All Rights Reserved.
In case of consideration for using Automotive equipment / device which demand high reliability, kindly contact our sales window correspondents.

