

2 In case of consideration for using Automotive equipment / device which demand high reliability, kindly contact our sales window correspondents.

7

8

| COUNT | DESCRIPTION OF REVISIONS | BY | CHKD | DATE | COUNT | DESCRIPTION OF REVISIONS | BY | CHKD | DATE |
|-------|--------------------------|----|------|------|-------|--------------------------|----|------|------|
| △ | | | | | △ | | | | |
| △ | | | | | △ | | | | |
| △ | | | | | △ | | | | |

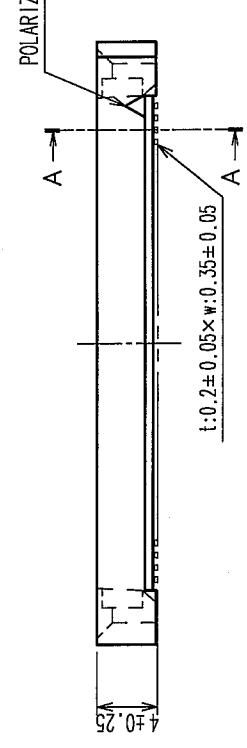
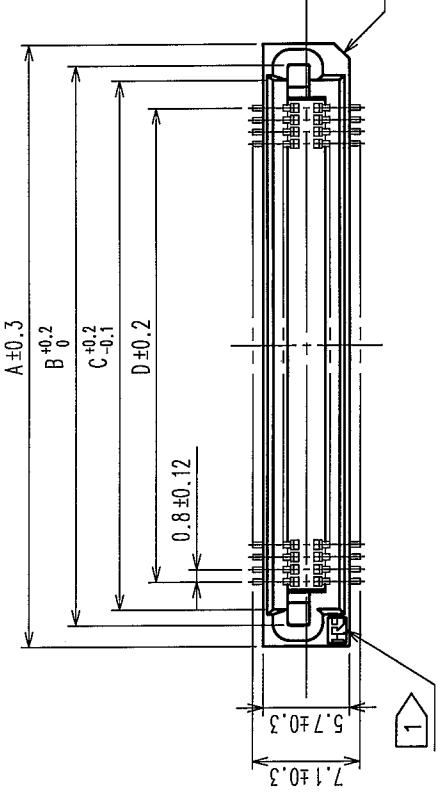

RECOMMENDED P.C.B. LAND PATTERN (MOUNT SIDE)

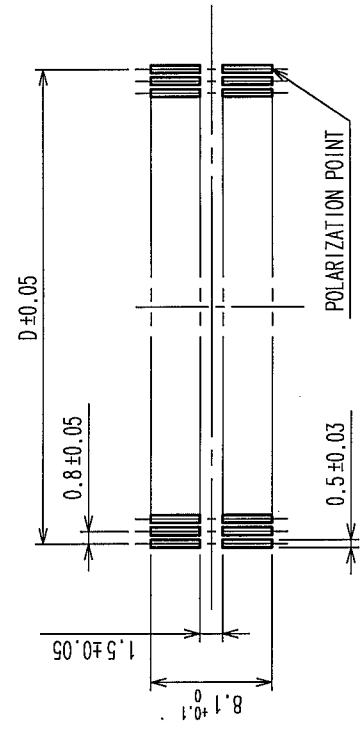

A-A (10:1)

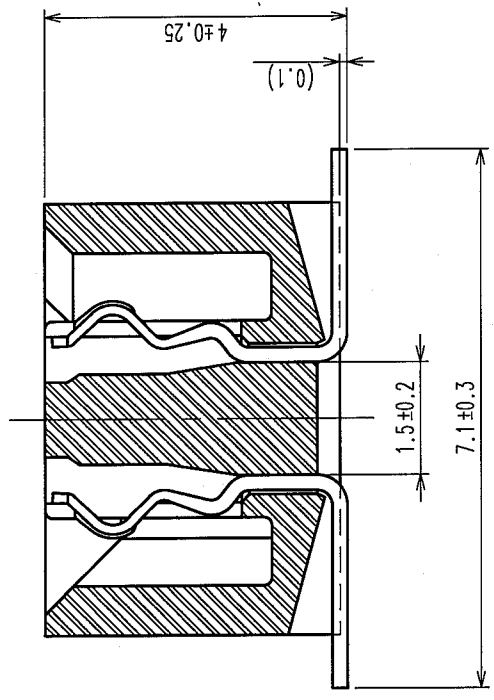

DIMENSION TABLE OF CONNECTOR AND P.C.B. LAND PATTERN

| PART No. | CODE No. | 6 | A | B | C | D |
|--------------------|-----------------|----|------|-------|------|------|
| FX6A-20S-0.8SV(93) | CL576-0301-7-93 | 20 | 15.8 | 12.95 | 10.9 | 7.2 |
| FX6A-40S-0.8SV(93) | CL576-0303-2-93 | 40 | 23.8 | 20.95 | 18.9 | 15.2 |
| FX6A-50S-0.8SV(93) | CL576-0304-5-93 | 50 | 27.8 | 24.95 | 22.9 | 19.2 |
| FX6A-60S-0.8SV(93) | CL576-0305-8-93 | 60 | 31.8 | 28.95 | 26.9 | 23.2 |
| FX6A-80S-0.8SV(93) | CL576-0307-3-93 | 80 | 39.8 | 36.95 | 34.9 | 31.2 |

NOTE
 1 HRS MARK SHALL BE OPTIONAL.
 2 LEAD CO-PLANARITY SHALL BE 0.1 MAX.
 3 EMBOSSED CARRIER TAPE PACKAGING SHALL BE APPLIED FOR THIS PRODUCT.
 4 THIS PRODUCT HAS TAPE FOR VACUUM PICKUP.
 5 SEE NEXT PAGE FOR DETAIL OF STICKING POSITION, ETC.
 6 FOR MODIFICATION, ETC, PREVENTIVE HOLE FOR SINK MARK MAY BE ADDED ACCORDING TO CIRCUMSTANCES.
 7 NUMBER OF CONTACTS.
 8 THE DIMENSIONS IN PARENTHESES ARE FOR REFERENCE.

| NO. | MATERIAL | FINISH, REMARKS | NO. | MATERIAL | FINISH, REMARKS |
|----------------|-----------------------|-----------------------|--|-----------------|-----------------|
| 1 | POLYPHENYLENE SULFIDE | LIGHT BROWN (UL94V-0) | 2 | PHOSPHOR BRONZE | |
| CODE NO. (OLD) | | | CONTACT AREA: GOLD 0.1μm min. LEAD AREA: TIN-PLATING 1μm min. UNDER PLATING: NICKLE 2μm min. | | |
| DRAWN | | | DESIGNED | | |
| T. YANAGISAWA | | | T. Noda | | |
| '05.08.04 | | | '05.08.05 | | |
| DRAWING NO. | | | PART NO. | | |
| EDC3-152949-23 | | | FX6A-S-0.8SV(93) | | |
| SCALE | | | CODE NO. | | |
| FREE | | | CL576 | | |
| UNITS | | | mm | | |

| | |
|-----|--|
| TO | |
| PCK | |

