

Apr.1.2024 Copyright 2024 HIROSE ELECTRIC CO., LTD. All Rights Reserved.  
In case of consideration for using Automotive equipment / device which demand high reliability, kindly contact our sales window correspondents.

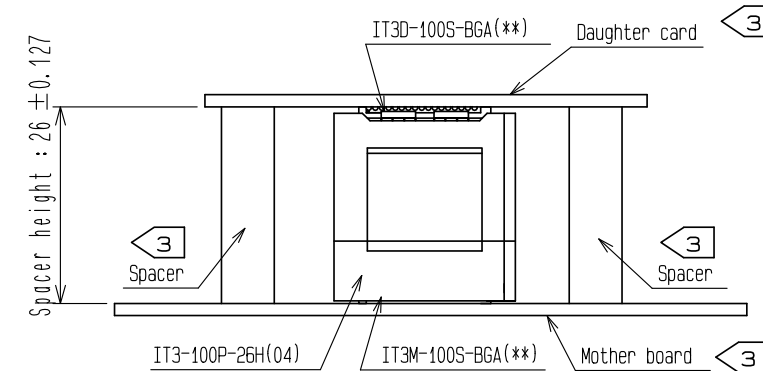
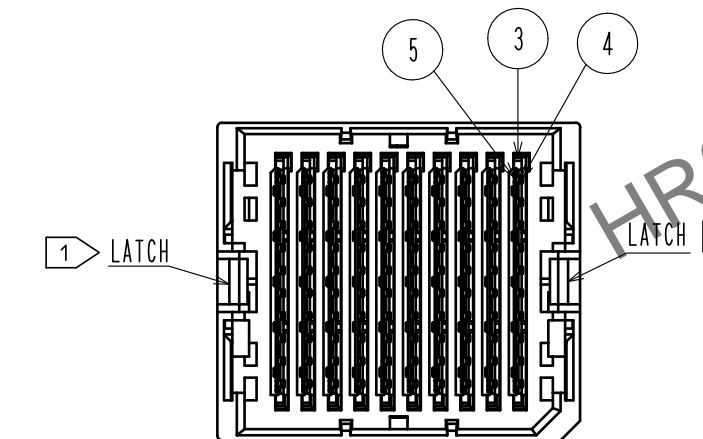
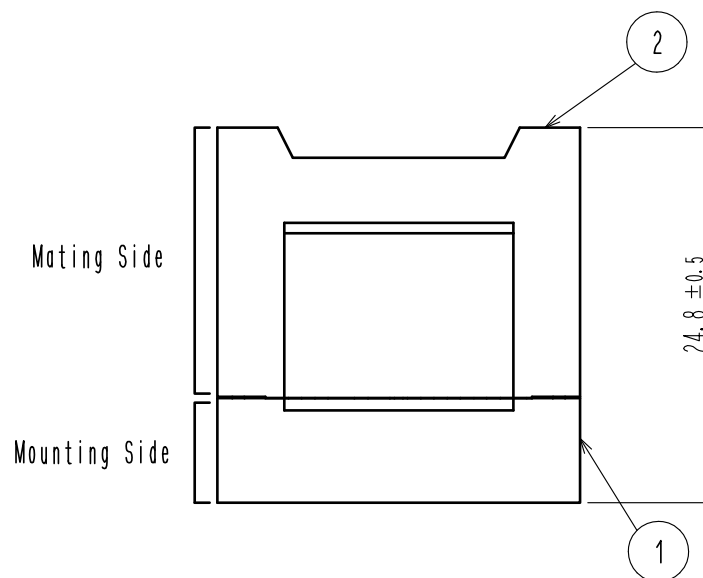
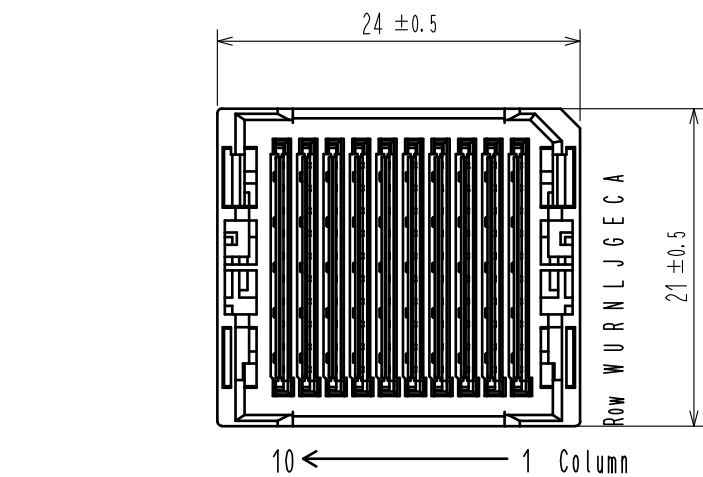
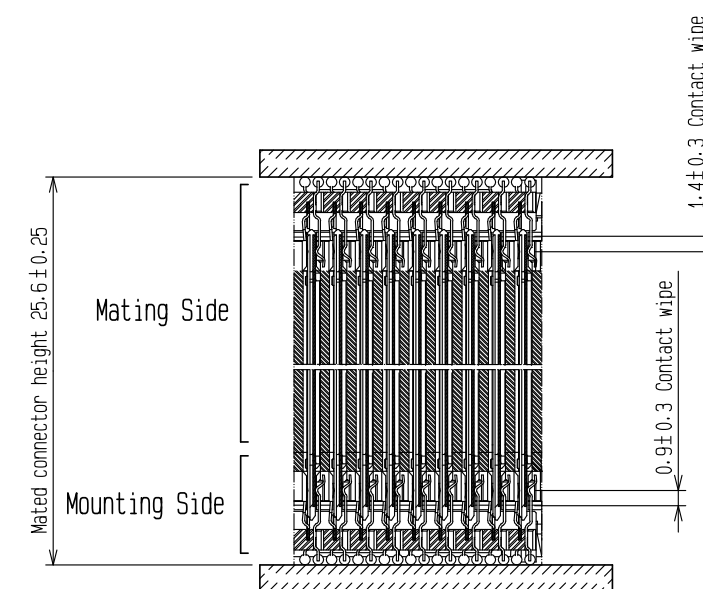

Fig. 1(FREE)



Mating Cross Section (Free)

- NOTE.
- 1 Mounting side is mated with the receptacle: IT3M-100S-BGA(\*\*) and fixed with the latch.
  - 2 Lot No. shall be marked on the indicated position.
  - 3 The indicated mother board and daughter card shall be fastened to the additional reinforcements to prevent the stress on IT3\*-100S-BGA(\*\*) solder joints.
  - 4 Please refer to HIROSE document: ETAD-F0347 'IT3 design guideline'.
  - 5 This product consists of 100 signal lines and 90 ground lines.
  - 6 50pcs of this products are packed in a soft tray.
  - 7 Standard package of 100pcs are packaged in a carton box.

3	LCP	BLACK	UL94V-0						
2	PBT	GRAY	UL94V-0	5	Copper Alloy	CONTACT AREA: NICKEL(1.5μm)+GOLD (0.76μm)			
1	PBT	BLACK	UL94V-0	4	Copper Alloy	CONTACT AREA: NICKEL(1.5μm)+GOLD (0.76μm)			
NO.	MATERIAL	FINISH . REMARKS		NO.	MATERIAL	FINISH . REMARKS			
UNITS mm		SCALE 2 : 1		COUNT	DESCRIPTION OF REVISIONS		DESIGNED	CHECKED	DATE
HIROSE ELECTRIC CO., LTD.		APPROVED : MK. EZAKI		15.08.26	DRAWING NO.		EDC-157250-04-00		
		CHECKED : MK. EZAKI		15.08.26	PART NO.		IT3-100P-26H(04)		
		DESIGNED : TF. SUGAWARA		15.08.26	CODE NO.		CL636-0165-0-04		
		DRAWN : KT. AIZAWA		15.08.26					