

Jun.1.2024 Copyright 2024 HIROSE ELECTRIC CO., LTD. All Rights Reserved.  
In case of consideration for using Automotive equipment / device which demand high reliability, kindly contact our sales window correspondents.

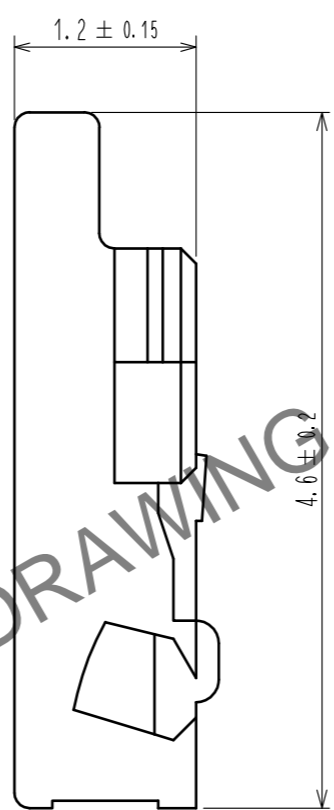

1 FIGURE OF INSERTION

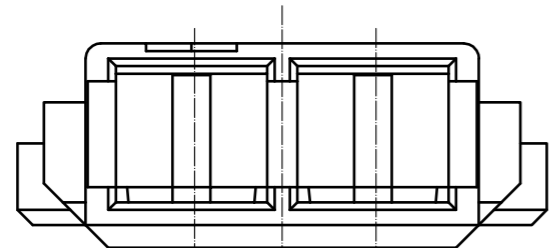
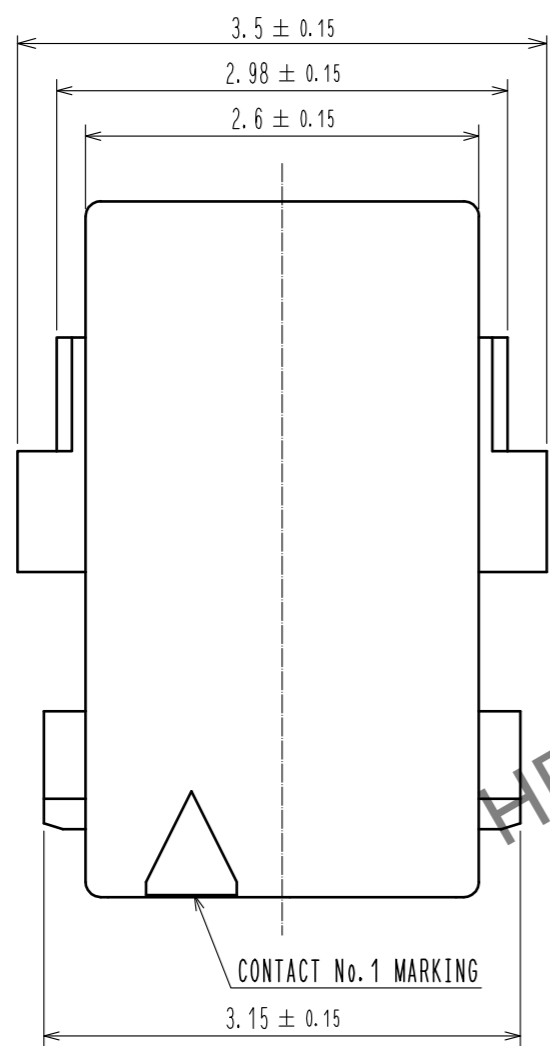
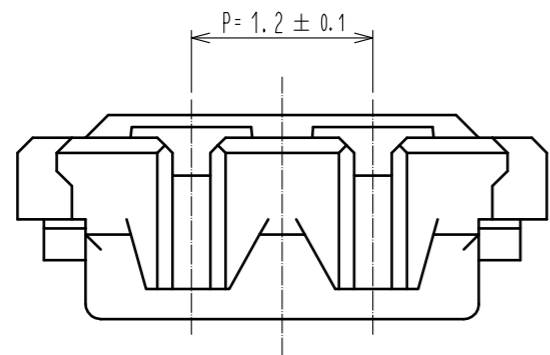
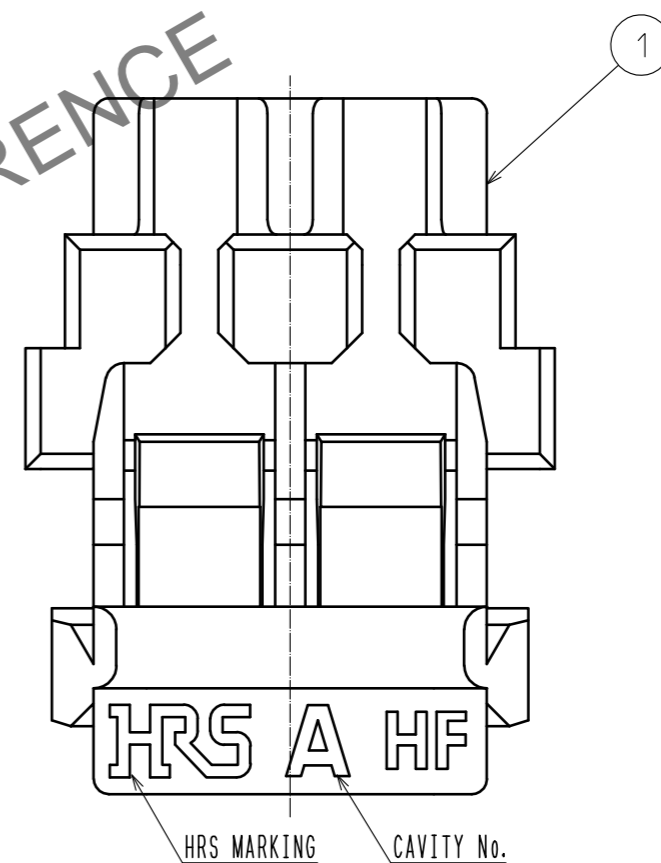
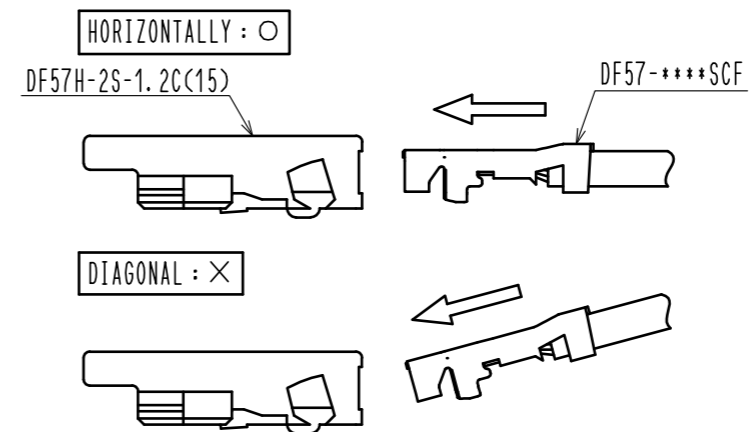

Note 1 Avoid angled insertion of crimp contact(DF57-\*\*\*\*SCF) to maintain performance reliability.

NO.	MATERIAL	FINISH . REMARKS	NO.	MATERIAL	FINISH . REMARKS			
			1	LCP	UL94V-0. BLACK			
UNITS	SCALE	COUNT	DESCRIPTION OF REVISIONS			DESIGNED	CHECKED	DATE
mm	20:1	△						
HIROSE ELECTRIC CO., LTD.			APPROVED	: SJ. OKAMURA	20210727	DRAWING NO. EDC-343900-15-01		
			CHECKED	: SZ. ONO	20210727	PART NO. DF57H-2S-1.2C(15)		
			DESIGNED	: HK. HAYASHI	20210727	CODE NO. CL0666-0100-6-15		
			DRAWN	: NK. OOSHIMA	20210727	1/2		

# DF57 Series Mating / Unmating Operation Instruction

## Mating

①By positioning the convexity of the socket sides to the header concavity, align the centers of the socket and the header in pitch direction.

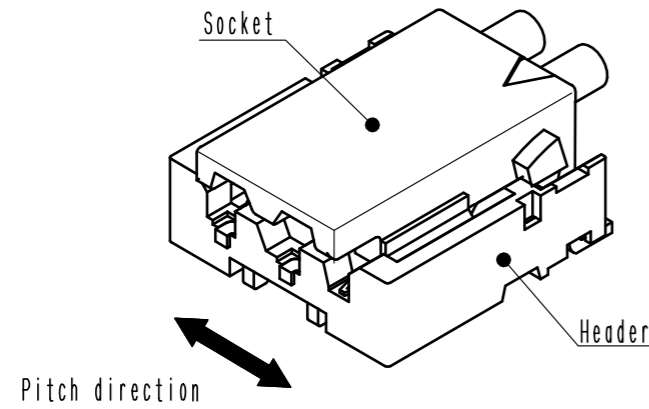

②Slightly press the socket down at cable side to tilted angle.

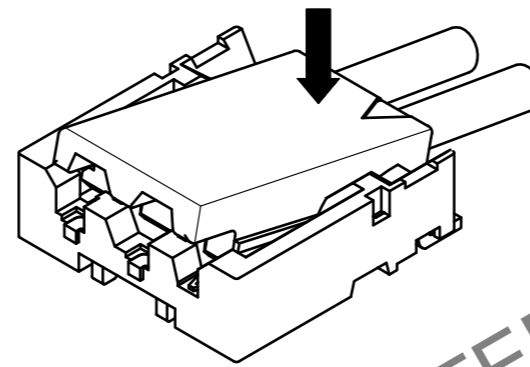

③Press down at the lever side with stabilizing the cable side to insert. Mating completes.

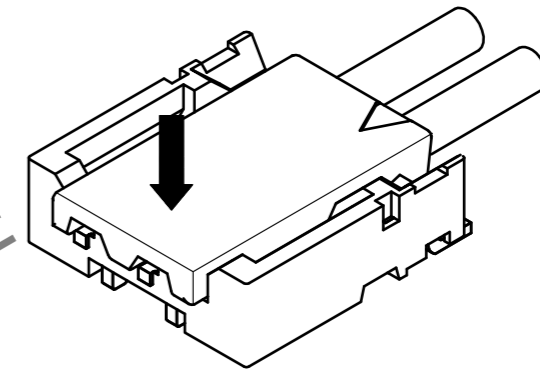

## Unmating

①Hook the lever with finger nail.

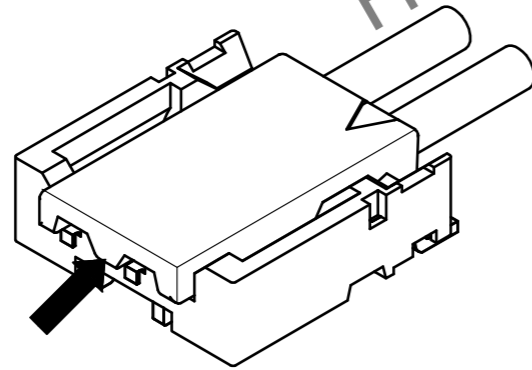

②Lift up to the upper direction and friction lock is released.

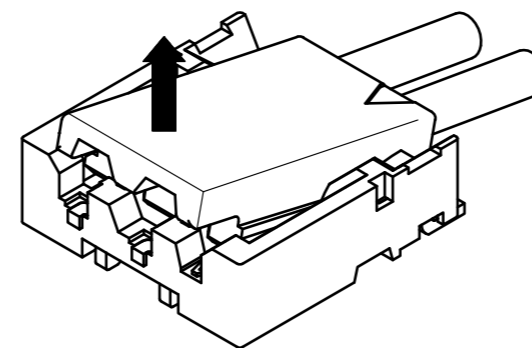

③Lift up to the upper direction and positive lock is released. Removal completes.

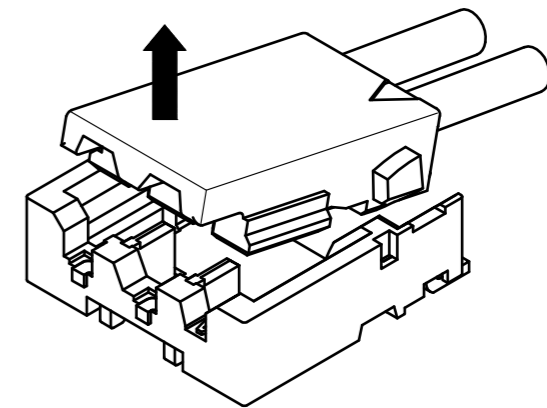

HRS DRAWING FOR REFERENCE

<b>HRS</b>	DRAWING NO.	EDC-343900-15-01
	PART NO.	DF57H-2S-1.2C<15>
	CODE NO.	CL0666-0100-6-15

2/2

Jun.1.2024 Copyright 2024 HIROSE ELECTRIC CO., LTD. All Rights Reserved. In case of consideration for using Automotive equipment / device which demand high reliability, kindly contact our sales window correspondents.