

Dec.1.2024 Copyright 2024 HIROSE ELECTRIC CO., LTD. All Rights Reserved.
In case of consideration for using Automotive equipment / device which demand high reliability, kindly contact our sales window correspondents.

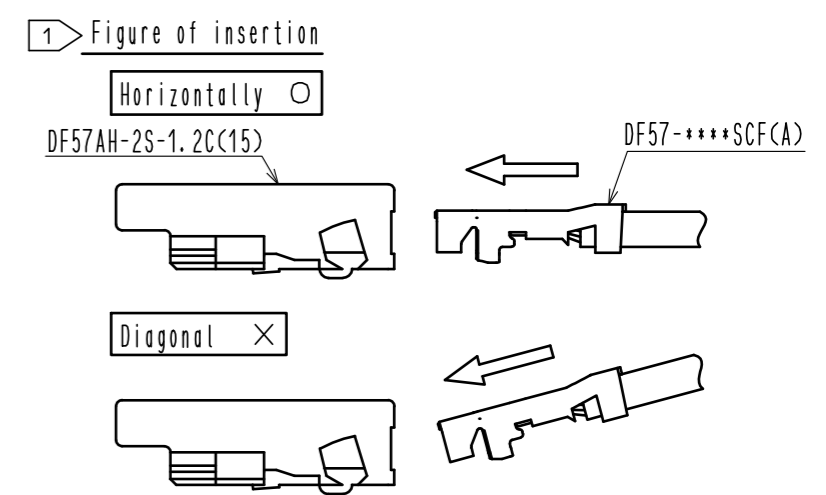

- Note 1 Avoid angled insertion of crimp contact(DF57-****SCF(A)) to maintain performance reliability.
 2. 1000 pieces per pack.
 3. UL recognized (File No. E52653)
 cUL recognized (File No. E52653)

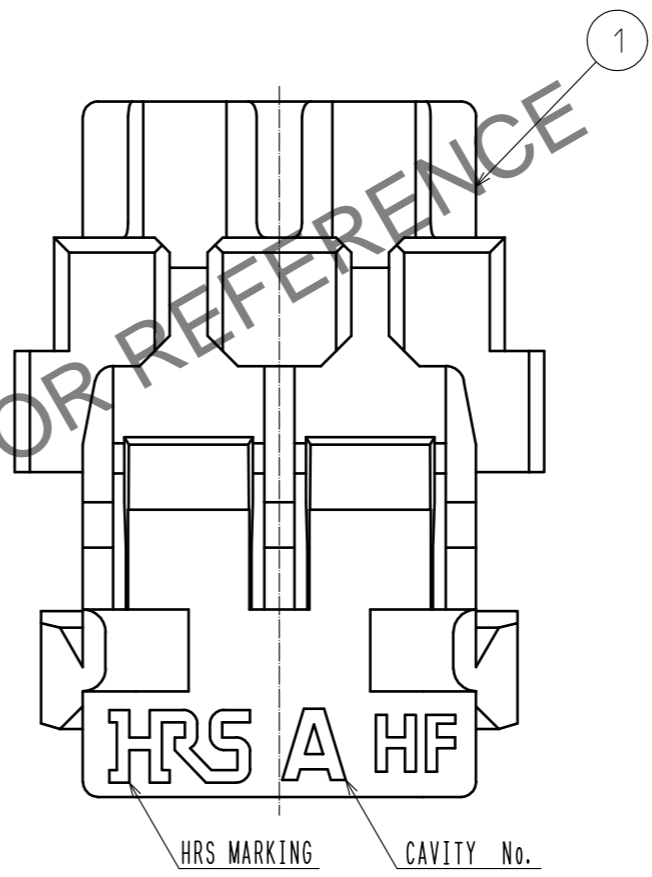
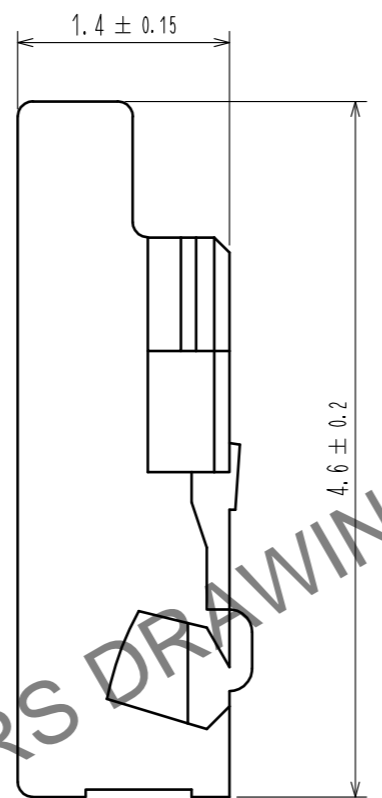
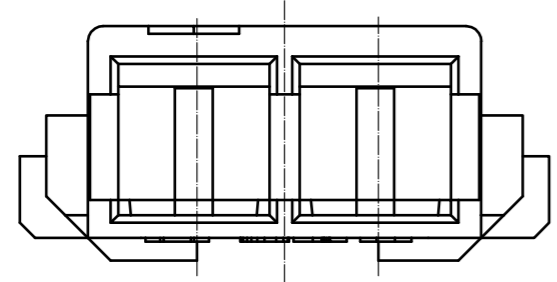
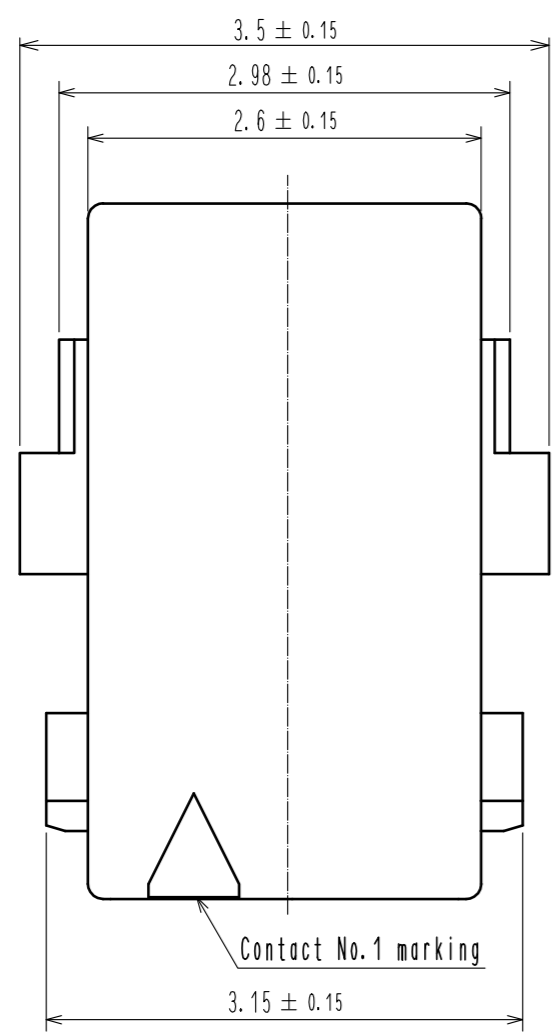
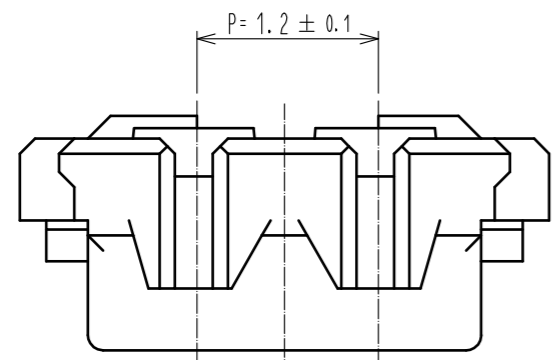

NO.	MATERIAL	FINISH . REMARKS	NO.	MATERIAL	FINISH . REMARKS
			1	LCP	UL94V-0. BLACK
UNITS	mm	SCALE	20 : 1	COUNT	DESCRIPTION OF REVISIONS
					DESIGNED
					CHECKED
					DATE
APPROVED : HS. OKAWA			17.01.23		
CHECED : TS. FUKUSHIMA			17.01.23		
DESIGNED : TS. MIYAKI			17.01.23		
DRAWN : TS. MIYAKI			17.01.23		
DRAWING NO.			EDC-362936-15-00		
PART NO.			DF57AH-2S-1.2C(15)		
CODE NO.			CL666-0112-0-15		

DF57 Series Mating / Unmating Operation Instruction (For DF57 series)

Mating

① By positioning the convexity of the socket sides to the header concavity, align the centers of the socket and the header in pitch direction.

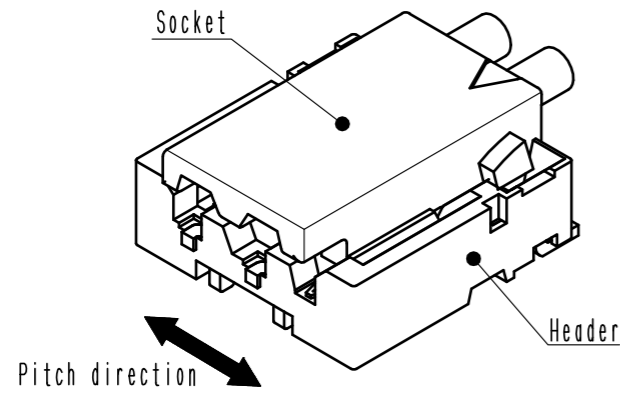

② Slightly press the socket down at cable side to tilted angle.

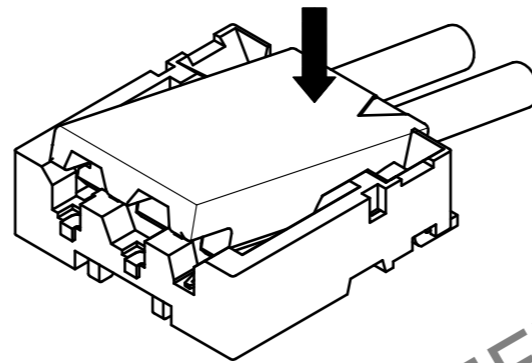

③ Press down at the lever side with stabilizing the cable side to insert. Mating completes.

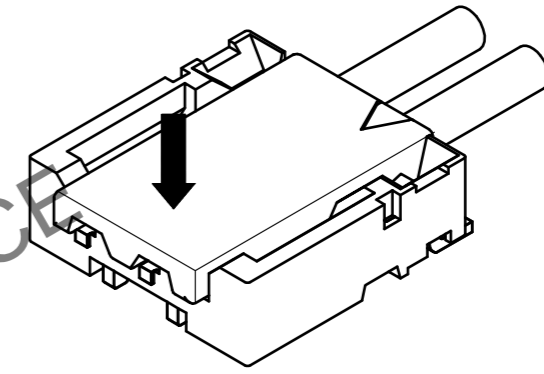

Unmating

① Hook the lever with finger nail.

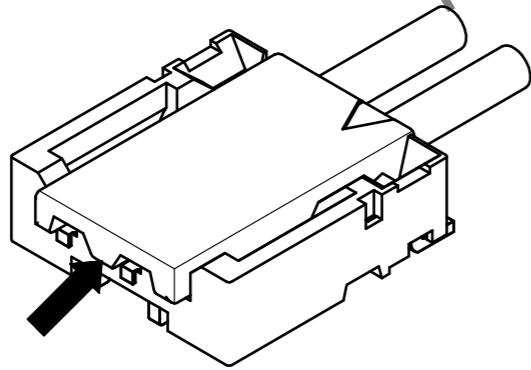

② Lift up to the upper direction and friction lock is released.

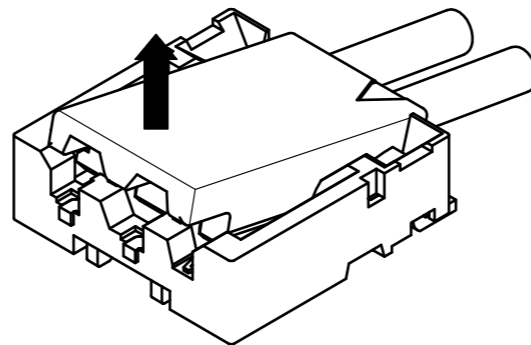

③ Lift up to the upper direction and positive lock is released. Removal completes.

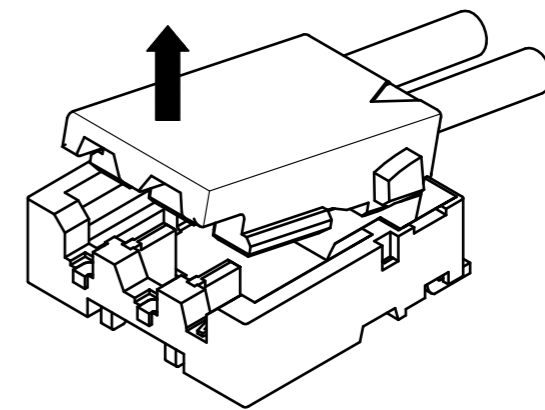

HRS	DRAWING NO.	EDC-362936-15-00
	PART NO.	DF57AH-2S-1. 2C(15)
	CODE NO.	CL666-0112-0-15
		2/2

Dec.1.2024 Copyright 2024 HIROSE ELECTRIC CO., LTD. All Rights Reserved. In case of consideration for using Automotive equipment / device which demand high reliability, kindly contact our sales window correspondents.