

B-B(2:1)

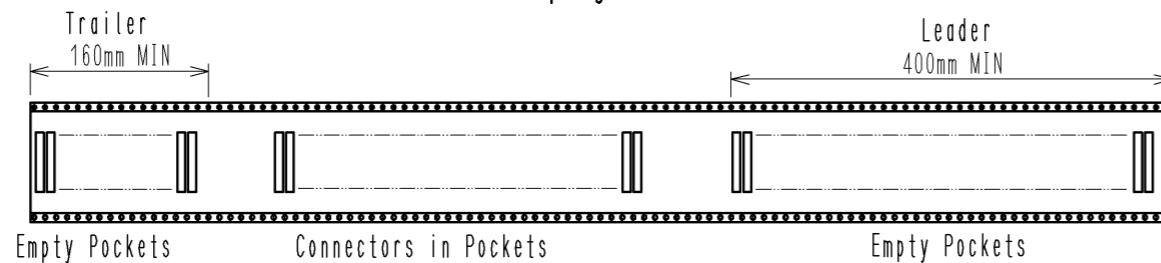

Taping(Free)



NOTE2. 1Reel:10000 Connectors.  
3. The dimensions in parentheses are for reference.

Reel style and Dimensions (Free)

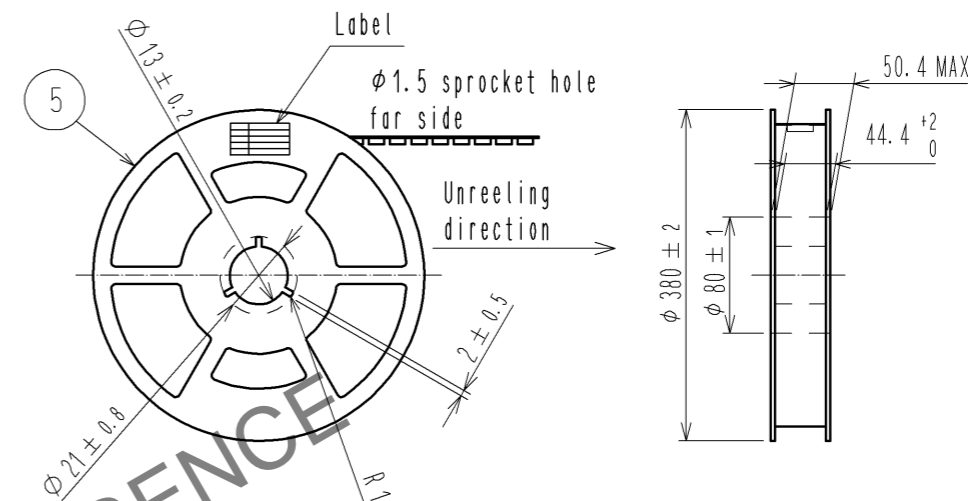

Detail of Part no. Label

|      |                  |
|------|------------------|
| 生産月日 | 年 月 日            |
| 図 番  | CL667-0028-7-21  |
| 品 名  | DF59SN-1P-FC(21) |
| 納入数量 | 10000 K0         |
| 納入者  | ヒロセ電機(株)         |

HRS

|             |                  |
|-------------|------------------|
| DRAWING NO. | EDC3-348352-01   |
| PART NO.    | DF59SN-1P-FC(21) |
| CODE NO.    | CL667-0028-7-21  |

△ 2/5

May.1.2024 Copyright 2024 HIROSE ELECTRIC CO., LTD. All Rights Reserved.  
In case of consideration for using Automotive equipment / device which demand high reliability, kindly contact our sales window correspondents.

# DF59S Operation Procedures for Floating Socket

## 《Mating》

### <How to pick up the socket>

Pick up the socket from a reel pocket with the insertion tool (DF59SN-1P-FC/IN-T00L).

1. Align the insertion tool to the pocket by using positioning guides.

2. Press down the insertion tool to the socket in the pocket vertically and lift it up, then the socket is captured into the insertion tool.

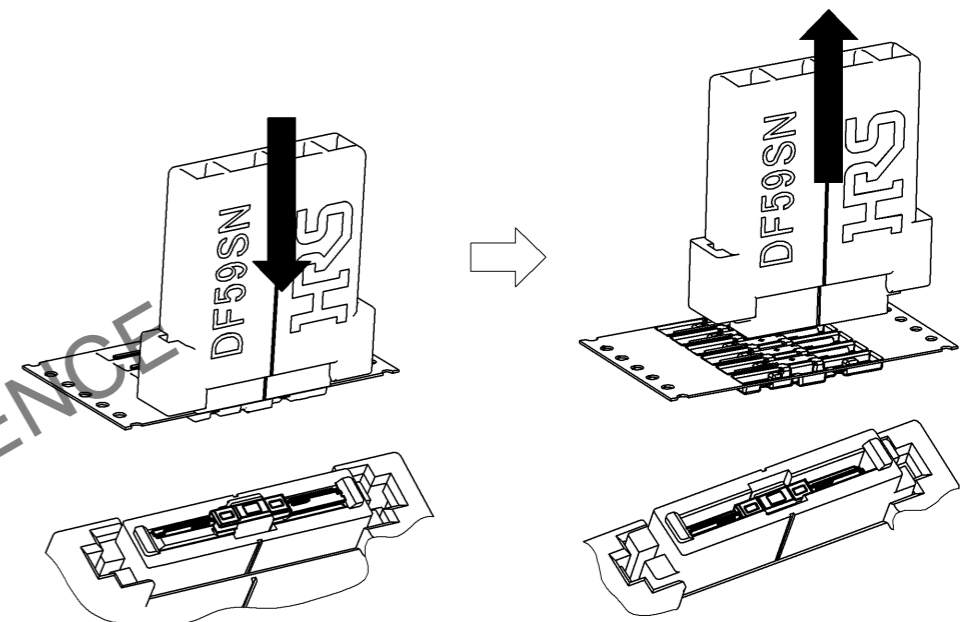
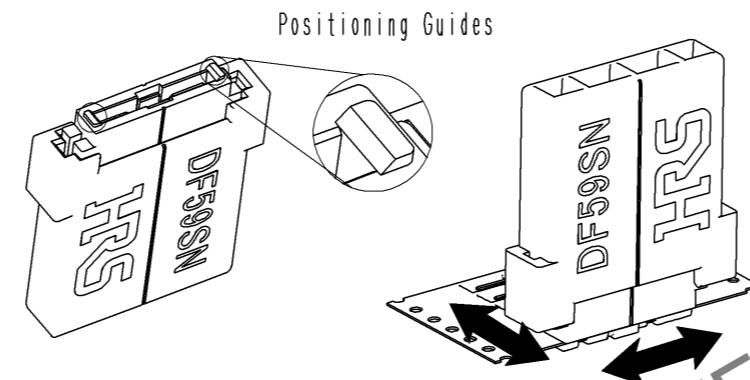
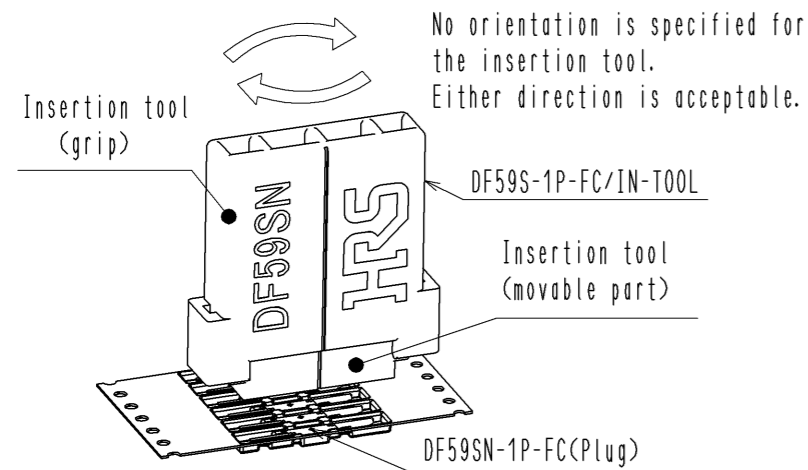

### <How to mate the socket to the receptacle>

Mate the socket captured by the insertion tool to the receptacles.

3. Align the insertion tool to receptacles by using positioning guides.

※Align the center line of insertion tool to the center between PCBs.

4. Press straight down the insertion tool to the receptacles (PCBs), and lift it up.

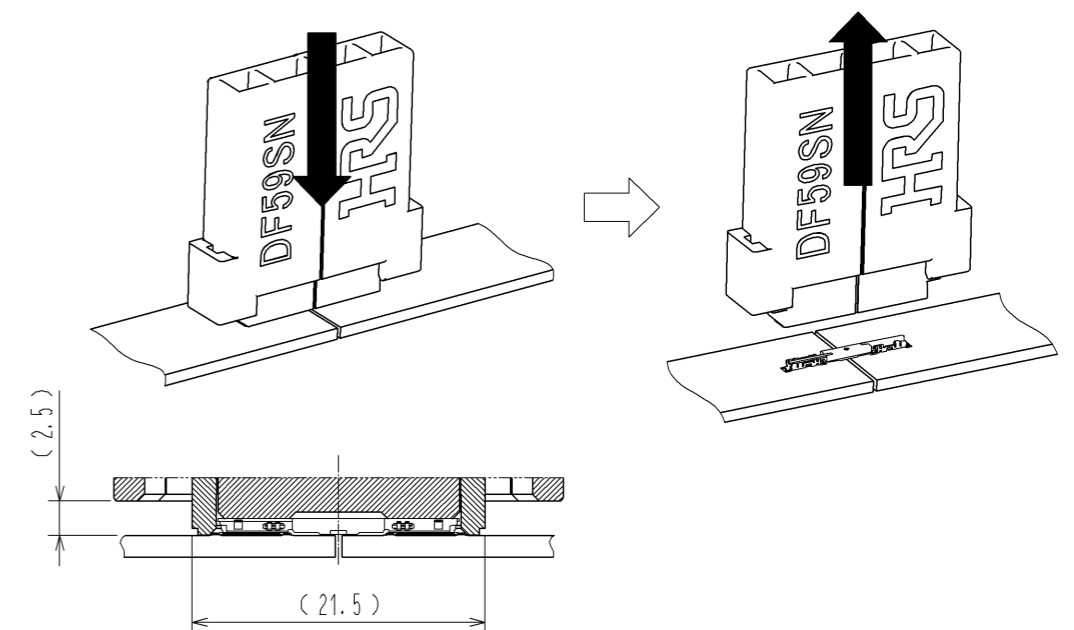
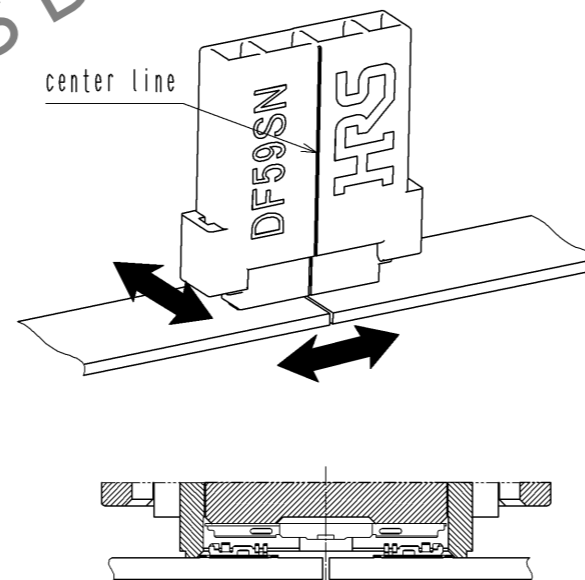
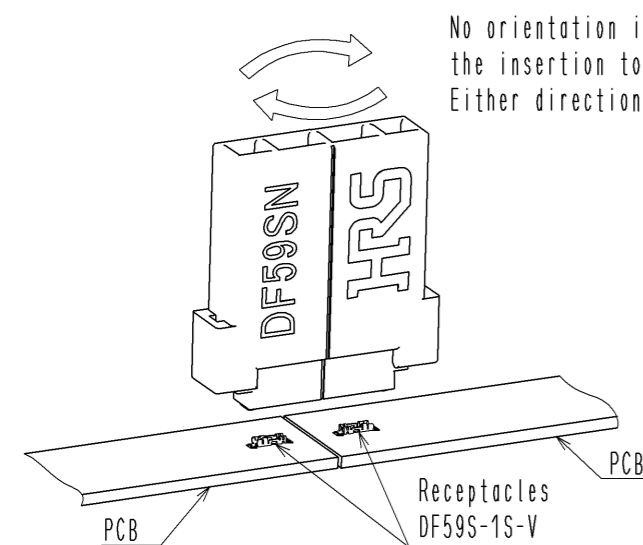

**HRS**

|             |                  |
|-------------|------------------|
| DRAWING NO. | EDC3-348352-01   |
| PART NO.    | DF59SN-1P-FC(21) |
| CODE NO.    | CL667-0028-7-21  |

3/5

May.1.2024 Copyright 2024 HIROSE ELECTRIC CO., LTD. All Rights Reserved.  
In case of consideration for using Automotive equipment / device which demand high reliability, kindly contact our sales window correspondents.

## 《Unmating》

1. Hook the lever on either sides of floating socket with finger and lift up to the upper direction for unlock.  
(Lift up until friction lock is released.)

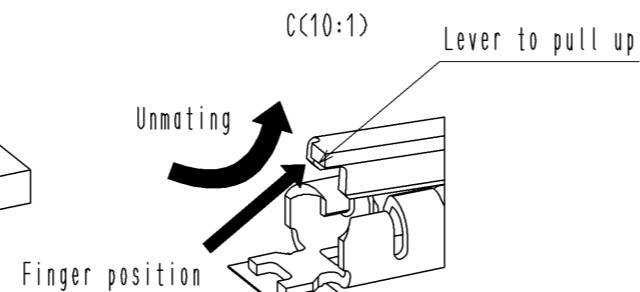
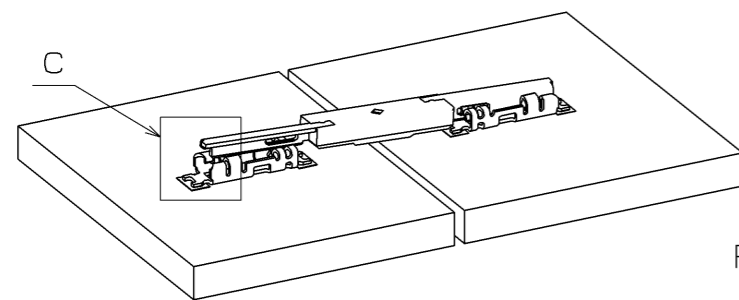

2. After releasing either side, hook the lever on the other side with a finger and lift up to the upper direction, too.

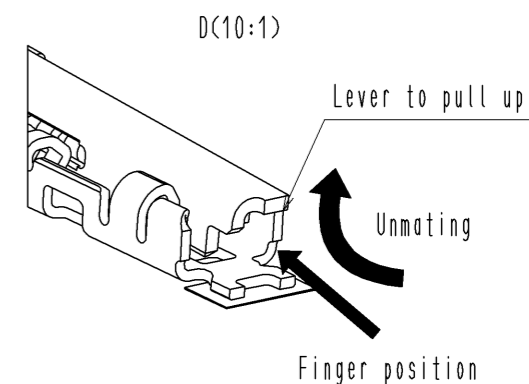
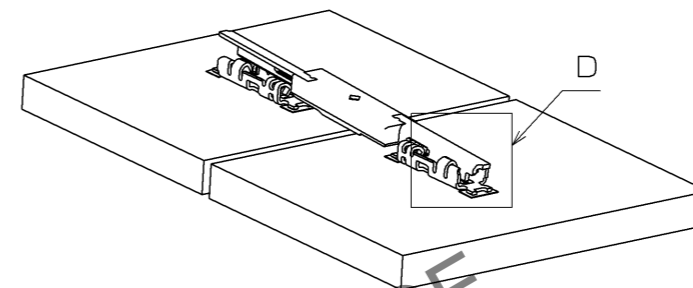

Withdrawal tool is also available, and its operation is the same as in case of using finger.

1. Hook the lever on either sides of the socket with the hook portion of the withdrawal tool, and lift it up straight to the upper direction for unlock.  
(Lift up until friction lock is released.)

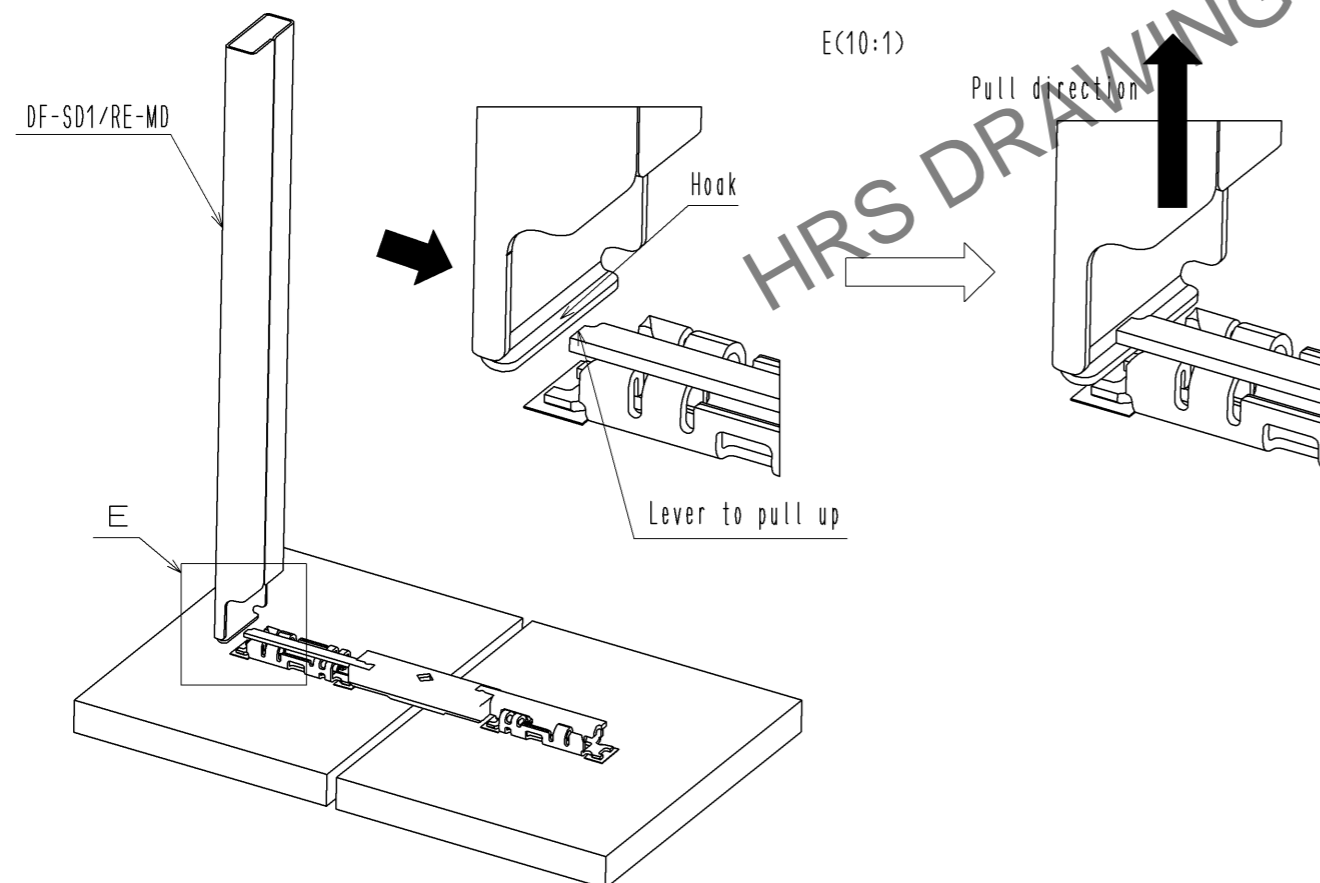

2. After releasing either side, hook the lever on the other side with the withdrawal tool and lift up to the upper direction, too.

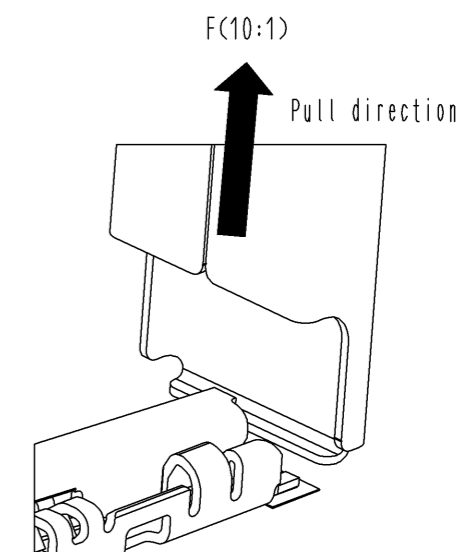
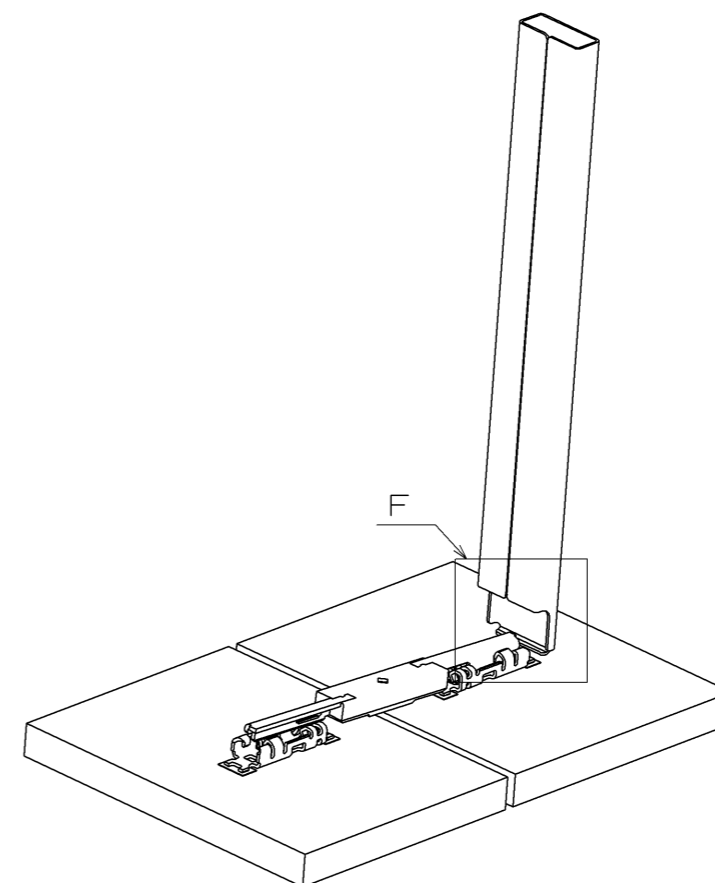

**HRS**

|             |                  |
|-------------|------------------|
| DRAWING NO. | EDC3-348352-01   |
| PART NO.    | DF59SN-1P-FC(21) |
| CODE NO.    | CL667-0028-7-21  |

May.1.2024 Copyright 2024 HIROSE ELECTRIC CO., LTD. All Rights Reserved.  
In case of consideration for using Automotive equipment / device which demand high reliability, kindly contact our sales window correspondents.

# Floating Range of DF59SN

Follow the specified floating range as shown below.

## 《Direction of X axis》

Floating range in X direction

■ Floating in X direction :  $+0.5\text{mm}$

■ Standard Position

■ Direction of X axis floating :  $-0.5\text{mm}$

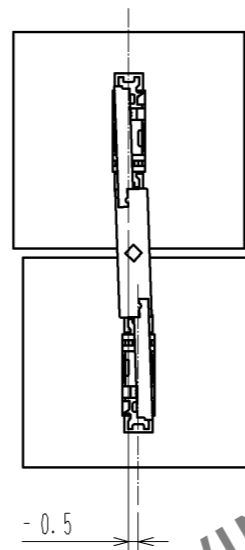
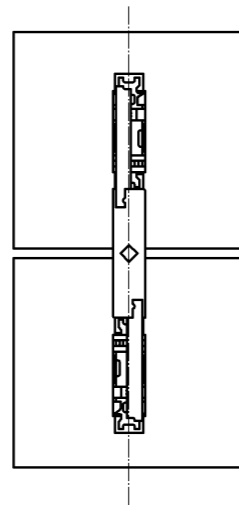
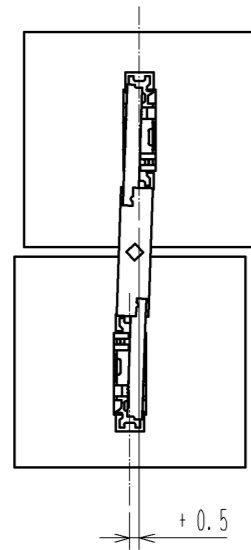

## 《Direction of Y axis》

Floating range in Y direction

■ Floating in Y direction :  $+0.5\text{mm}$

■ Standard Position

■ Direction of Y axis floating :  $-0.5\text{mm}$

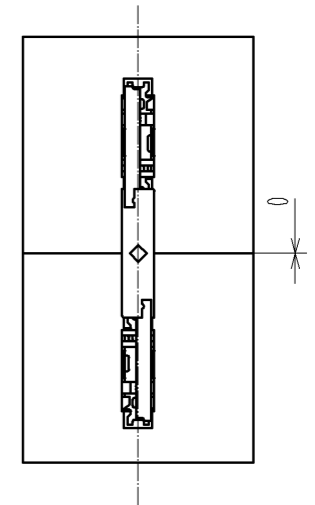
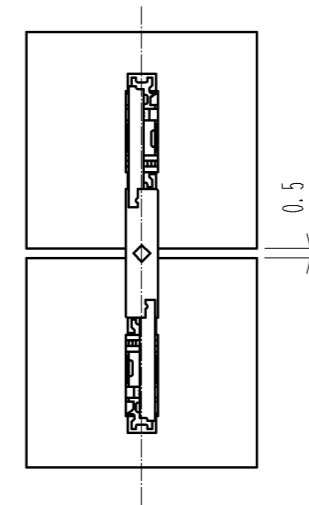
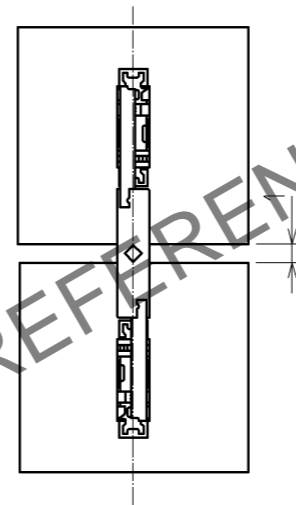

## 《Direction of Z axis》

Floating range in Z direction

■ Floating in Z direction :  $+0.2\text{mm}$

■ Standard Position

■ Direction of Z axis floating :  $-0.2\text{mm}$

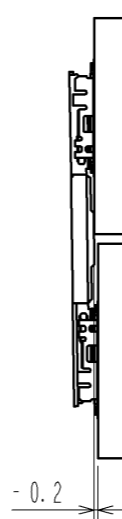
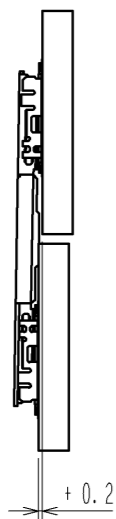

**HRS**

|             |                  |
|-------------|------------------|
| DRAWING NO. | EDC3-348352-01   |
| PART NO.    | DF59SN-1P-FC(21) |
| CODE NO.    | CL667-0028-7-21  |

5/5