

Mar.1.2021 Copyright 2021 HIROSE ELECTRIC CO., LTD. All Rights Reserved.  
In case of consideration for using Automotive equipment / device which demand high reliability, kindly contact our sales window correspondents.

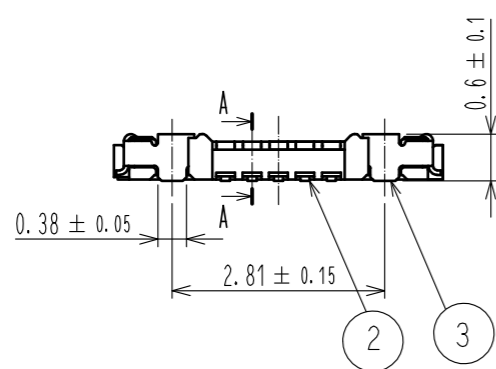

- NOTE 1 . ALL LEAD CO-PLANARITY SHALL BE 0.08mm MAX.  
 2 CONTACT PLATING SPECIFICATIONS  
 CONTACT AREA : GOLD 0.05 μm MIN  
 SMT LEAD : GOLD 0.05 μm MIN  
 UNDER PLATING : NICKEL 1 μm MIN  
 ( SURFACE : SEALING )  
 3 CAV NO. AND HRS MARK EXIST IN THE INDICATED POSITION.

◆RECOMMENDED PCB LAYOUT

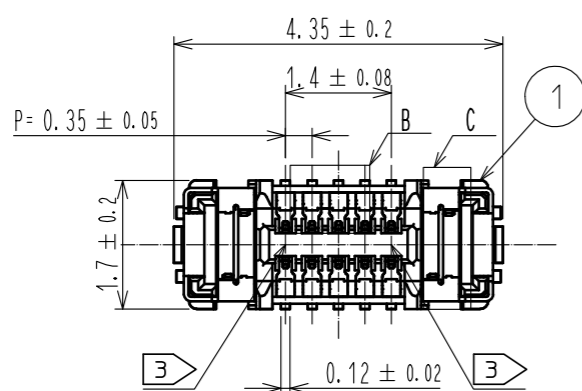
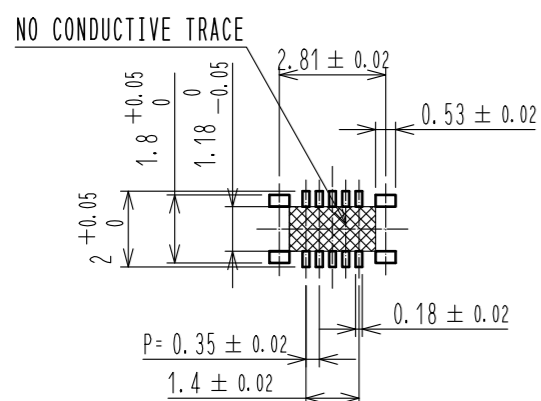

◆RECOMMENDED METAL MASK DIMENSIONS

METAL MASK THICKNESS : 80 μm

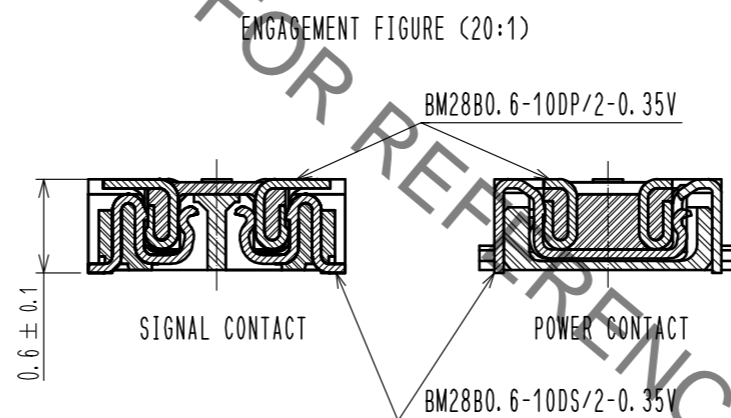
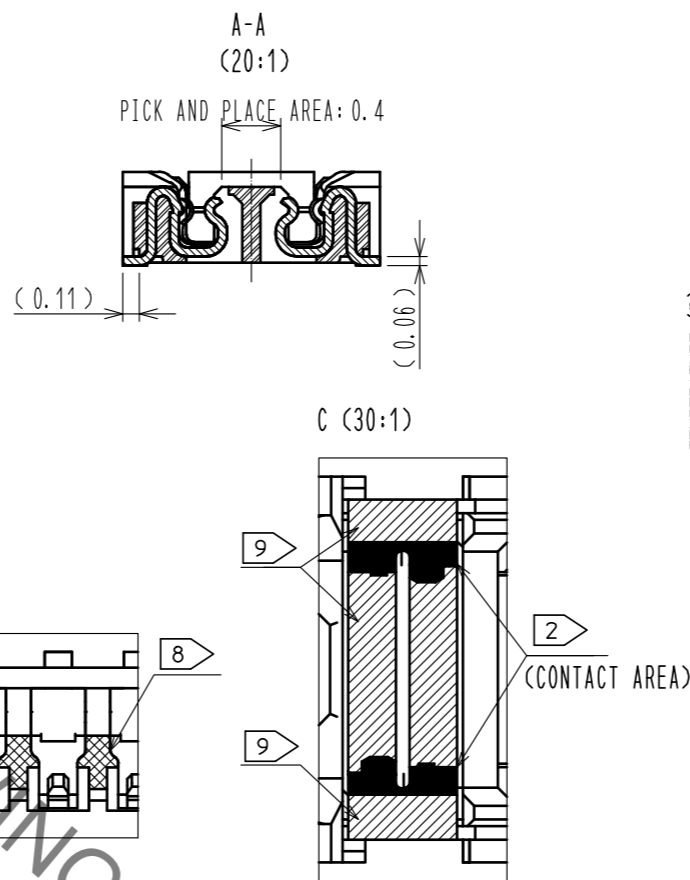
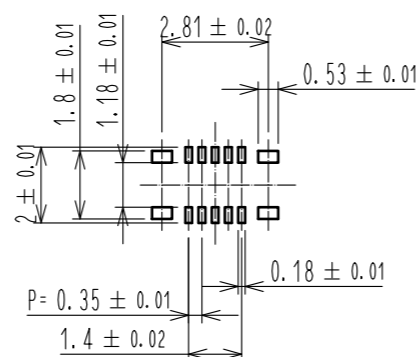

4 RECOMMENDED REFLOW TEMPERATURE PROFILE USING LEAD-FREE SOLDER PASTE.

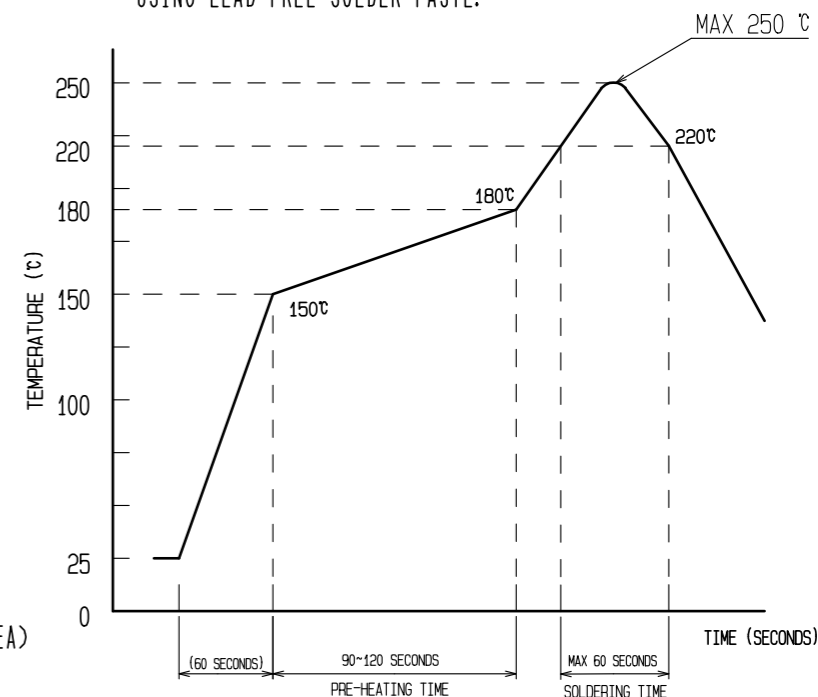

- REFLOW METHOD:IR REFLOW  
 NUMBER OF REFLOW CYCLES:2 CYCLES MAX.  
 1)REFLOW TIME  
 DURATION ABOVE 220°C, 60 SEC MAX.  
 (PEAK TEMPERATURE:250°C MAX)  
 2)PRE-HEAT TIME  
 PRE-HEAT TEMPERATURE(MIN):150°C  
 PRE-HEAT TEMPERATURE(MAX):180°C  
 PRE-HEAT TIME:90-120 SEC.

- 4 THIS TEMPERATURE PROFILE IS PER THE CONDITIONS SHOWN ABOVE. ADDITIONAL FACTORS, SUCH AS SOLDER PASTE TYPE, PCB SIZE AND OTHER MOUNTED COMPONENTS COULD AFFECT THE PROFILE. THEREFORE, A THOROUGH EVALUATION OF MOUNTING COONDITION IS REQUIRED PRIOR TO PRODUCTION. TEPERATURE IS MEASURED AT CONTACT LEAD.  
 5. PLEASE CONTACT US IN CASE YOU WILL MAKE DIFFERENT SETTINGS FROM OUR RECOMMENDATION.  
 6. THIS PRODUCT SATISFIES HALOGEN FREE REQUIREMENTS DEFINED AS 900ppm MAXIMUM CHLORINE, 900ppm MAXIMUM BROMINE, AND 1500ppm MAXIMUM TOTAL OF CHLORINE AND BROMINE.  
 7. THIS PRODUCT COMPLY WITH RoHS.  
 8 WELD LINE APPEARS IN THE INDICATED POSITION.  
 9 NO GOLD PLATING IS ACCEPTABLE FOR AREA.

| 4                         | PS           | CLEAR(EMBOSSED CARRIER TAPE) |            |                                      |                              |
|---------------------------|--------------|------------------------------|------------|--------------------------------------|------------------------------|
| 3                         | COPPER ALLOY | 2                            | 7          | PS                                   | CLEAR (REINFORCEMENT COLLAR) |
| 2                         | COPPER ALLOY | 2                            | 6          | PS                                   | BLACK (PLASTIC REEL)         |
| 1                         | LCP          | UL94 V-0, BLACK              | 5          | POLYESTER                            | CLEAR (COVER TAPE)           |
| NO.                       | MATERIAL     | FINISH . REMARKS             | NO.        | MATERIAL                             | FINISH . REMARKS             |
| UNITS                     |              | SCALE                        | COUNT      | DESCRIPTION OF REVISIONS             |                              |
| mm                        |              | 10 : 1                       | △          | DESIGNED                             | CHECKED                      |
| HRS                       |              | APPROVED : MO. ISHIDA        | 17. 01. 30 | DRAWING NO. EDC-365298-61-00         |                              |
| HIROSE ELECTRIC CO., LTD. |              | CHECED : TS. MIYAZAKI        | 17. 01. 30 | PART NO. BM28B0. 6-10DS/2-0. 35V<61> |                              |
|                           |              | DESIGNED : RT. SHIMIZU       | 17. 01. 27 | CODE NO. CL673-5044-0-61             |                              |
|                           |              | DRAWN : SN. NUMAZAKI         | 17. 01. 23 | 1/2                                  |                              |

Mar.1.2021 Copyright 2021 HIROSE ELECTRIC CO., LTD. All Rights Reserved.  
In case of consideration for using Automotive equipment / device which demand high reliability, kindly contact our sales window correspondents.

# EMBOSED CARRIER TAPE PACKAGING (5:1)

E-E (5:1)

# STYLE AND DIMENSION OF REEL (FREE)

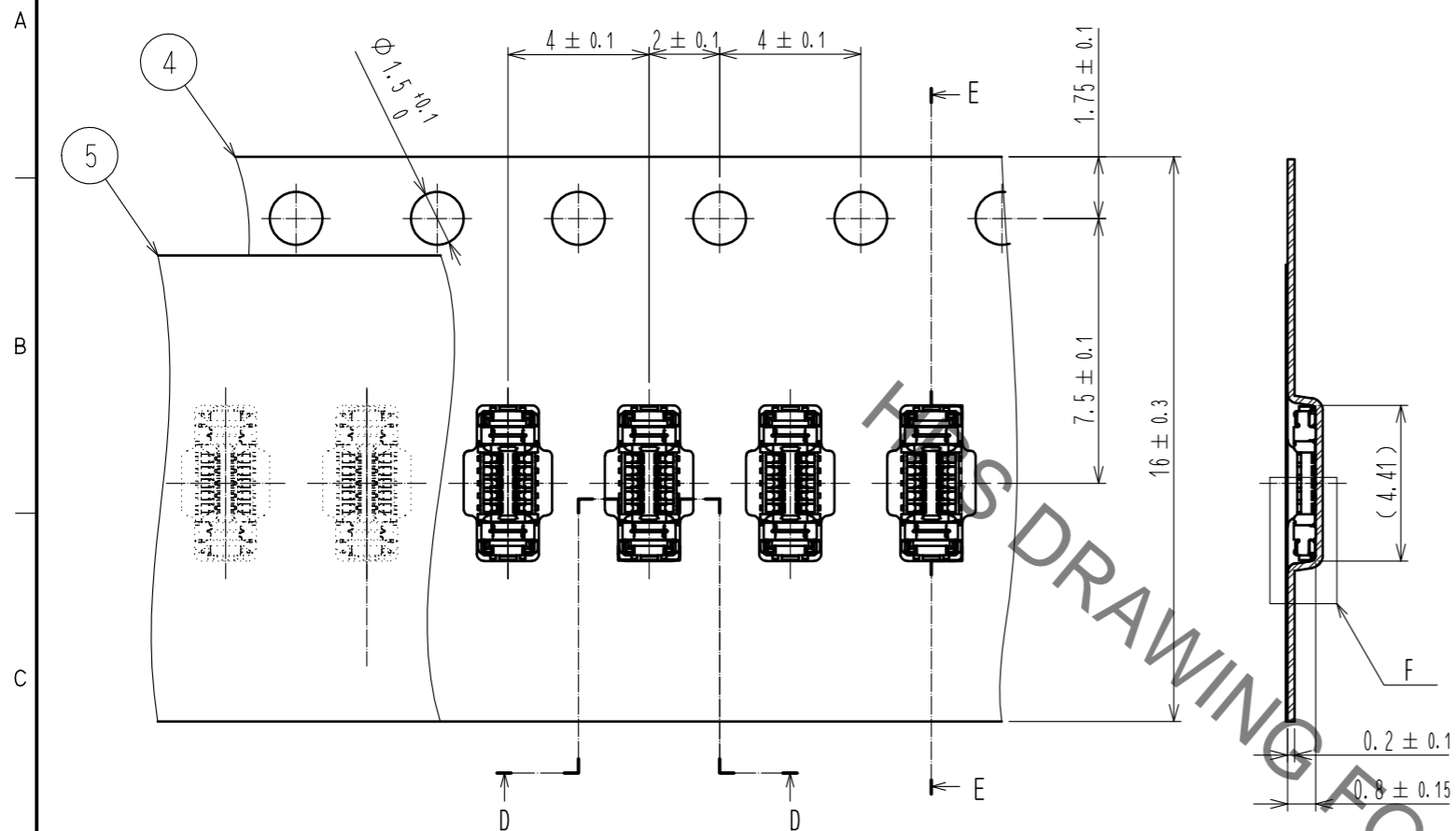

DIRECTION OF UNREELING

D-D (5:1)

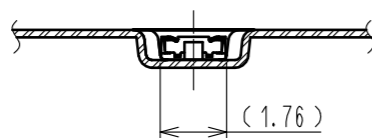

F (10:1)

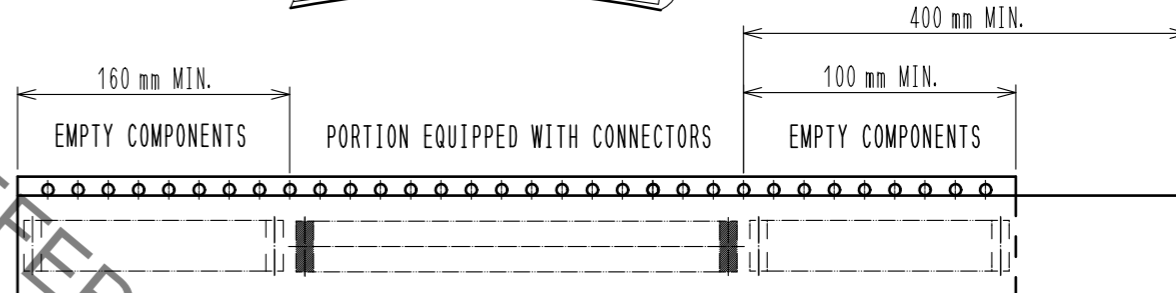
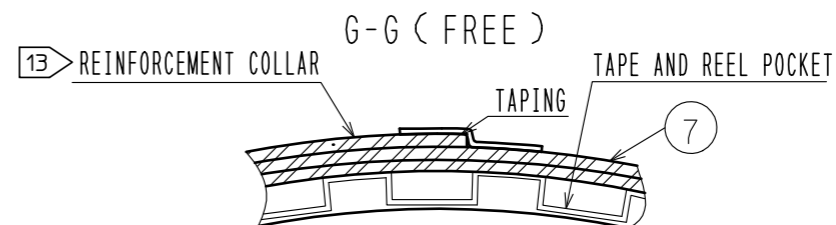
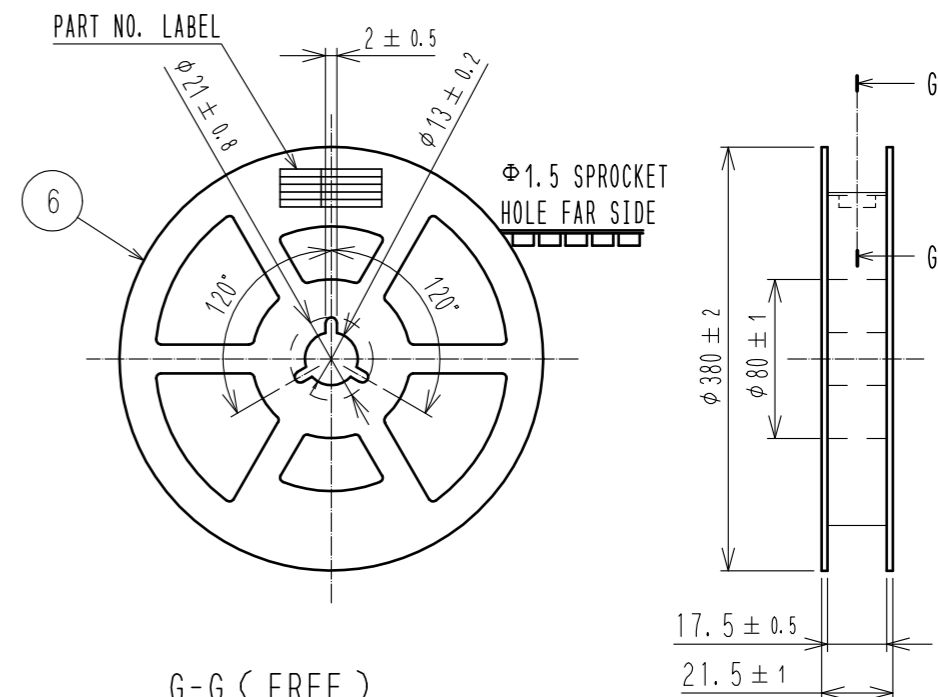
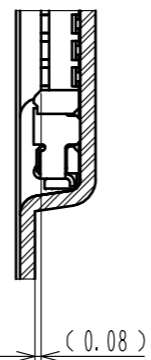

## DETAIL OF PART NO. LABEL

|       |                |
|-------|----------------|
| 製造年月日 | ** ** *        |
| 製品コード | CL0673-****-** |
| 製品名   | BM28B0.6-**    |
| 数量    | 20,000         |
| 納入者   | ヒロセ電機(株)       |

DATA OF MANUFACTURED  
CODE NO.  
PART NO.  
QUANTITY  
SUPPLIER

- 10 . PER REEL 20,000 CONNECTORS.
- 11 . THE DIMENSIONS IN PARENTHESES ARE FOR REFERENCE.
- 12 . REFER TO JIS C 0806, IEC 60286-3(PACKAGING OF COMPONENTS FOR AUTOMATIC HANDLING)
- 13 . AFTER PACKAGING, ROLL 2 METERS OF THE REINFORCEMENT COLLAR TO OUTER CIRCUMFERENCE OF TAPE AND REEL POCKET. AND TAPE DOWN AT THE END THE COLLAR.

|            |             |                           |
|------------|-------------|---------------------------|
| <b>HRS</b> | DRAWING NO. | EDC-365298-61-00          |
|            | PART NO.    | BM28B0.6-10DS/2-0.35V<61> |
|            | CODE NO.    | CL673-5044-0-61           |
|            |             | 2/2                       |