

Nov.1.2024 Copyright 2024 HIROSE ELECTRIC CO., LTD. All Rights Reserved.
In case of consideration for using Automotive equipment / device which demand high reliability, kindly contact our sales window correspondents.

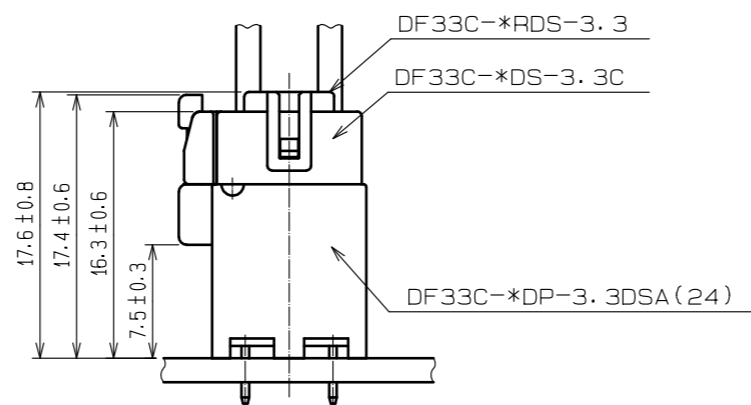

RECOMMENDED PATTERN(5:1)
(RECOMMENDED BOARD THICKNESS t=1.6mm)

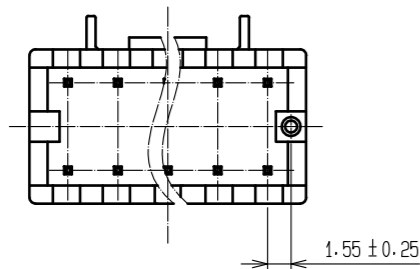
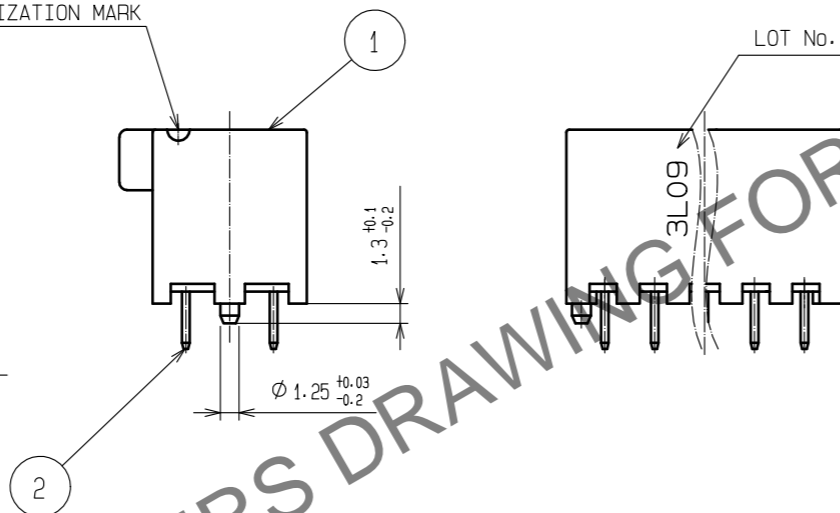
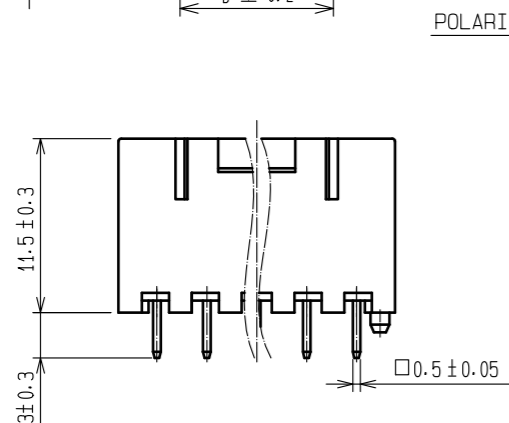
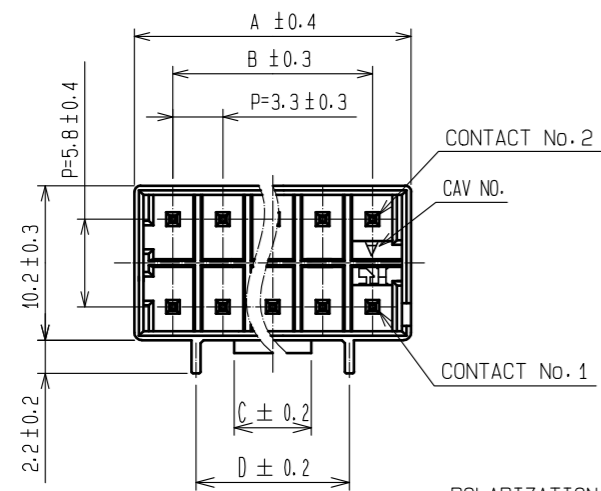
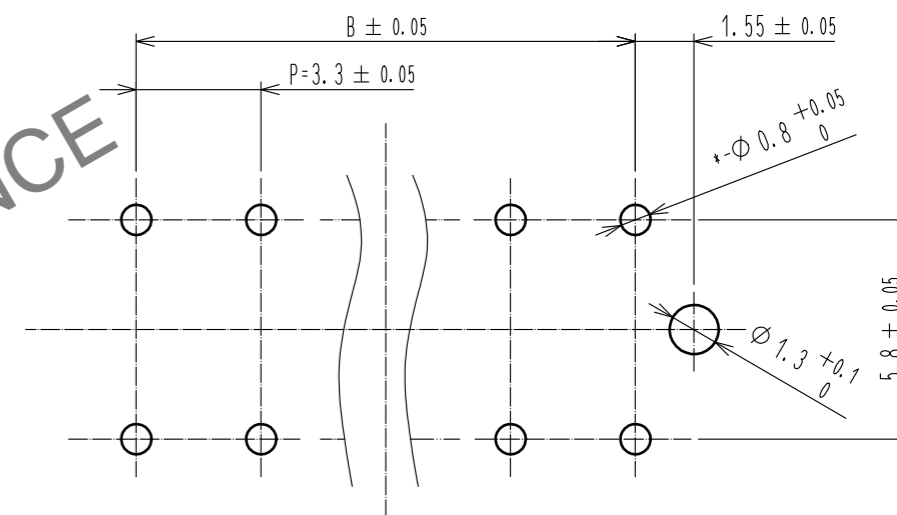

| PART No. | CODE No. | THE NUMBER OF CONTACT | A | B | C | D |
|-----------------------|-----------------|-----------------------|------|------|-----|-------|
| DF33C-4DP-3.3DSA(24) | CL676-1113-0-24 | 4 | 8.4 | - | 2.5 | 6.8 |
| DF33C-6DP-3.3DSA(24) | CL676-1114-3-24 | 6 | 11.7 | 6.6 | 2.5 | 6.8 |
| DF33C-8DP-3.3DSA(24) | CL676-1115-6-24 | 8 | 15.0 | 9.9 | 5.1 | 10.15 |
| DF33C-10DP-3.3DSA(24) | CL676-1116-9-24 | 10 | 18.3 | 13.2 | 5.1 | 10.15 |
| DF33C-12DP-3.3DSA(24) | CL676-1117-1-24 | 12 | 21.6 | 16.5 | 5.1 | 10.15 |

NOTES 1 :IMMERSION DEPTH INTO POTTING SOLUTION:6.5mm

| | | | | | |
|-------------|----------|------------------|--------------|--|---|
| 1 | △PBT | △WHITE UL94V-0 | 3 | HIPS | TRAY |
| 2 | | | 2 | BRASS | SURFACE:TIN PLATED 1µm min UNDER PLATING:NICKEL PLATED 0.5µm min |
| NO. | MATERIAL | FINISH . REMARKS | NO. | MATERIAL | FINISH . REMARKS |
| UNITS mm | ⊙ | SCALE 2 : 1 | COUNT △ 2 | DESCRIPTION OF REVISIONS DIS-H-00012938 | DESIGNED SS. YAMASAKI |
| | | | | CHECKED SZ. ONO | DATE 20220323 |
| | | | | APPROVED :KI. AKIYAMA 20131217 | DRAWING NO. EDC3-354790-01 |
| | | | | CHECKED :HK. UMEHARA 20131217 | PART NO. DF33C-*DP-3.3DSA(24) |
| | | | | DESIGNED :HT. SATO 20131217 | CODE NO. CL676- |
| | | | | DRAWN :MI. SAKIMURA 20131217 | 1/2 |

Nov.1.2024 Copyright 2024 HIROSE ELECTRIC CO., LTD. All Rights Reserved.
 In case of consideration for using Automotive equipment / device which demand high reliability, kindly contact our sales window correspondents.

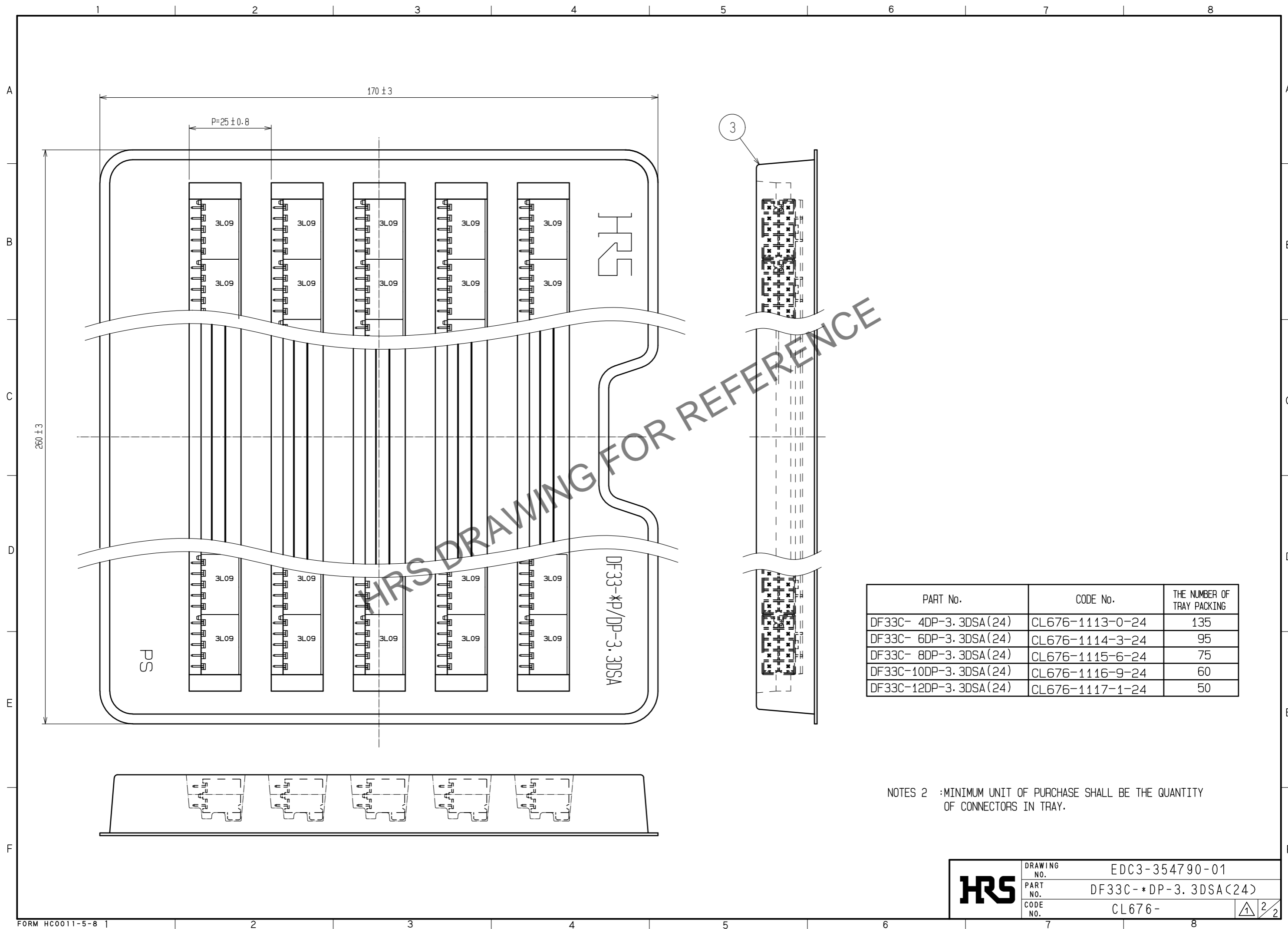

| PART No. | CODE No. | THE NUMBER OF TRAY PACKING |
|-------------------------|-----------------|----------------------------|
| DF33C- 4DP-3. 3DSA (24) | CL676-1113-0-24 | 135 |
| DF33C- 6DP-3. 3DSA (24) | CL676-1114-3-24 | 95 |
| DF33C- 8DP-3. 3DSA (24) | CL676-1115-6-24 | 75 |
| DF33C-10DP-3. 3DSA (24) | CL676-1116-9-24 | 60 |
| DF33C-12DP-3. 3DSA (24) | CL676-1117-1-24 | 50 |

NOTES 2 :MINIMUM UNIT OF PURCHASE SHALL BE THE QUANTITY OF CONNECTORS IN TRAY.

| | | | |
|---------------|-------------|-----------------------|-----|
| HIROSE | DRAWING NO. | EDC3-354790-01 | |
| | PART NO. | DF33C-*DP-3. 3DSA(24) | |
| | CODE NO. | CL676- | 2/2 |