

Jun.1.2024 Copyright 2024 HIROSE ELECTRIC CO., LTD. All Rights Reserved.
In case of consideration for using Automotive equipment / device which demand high reliability, kindly contact our sales window correspondents.

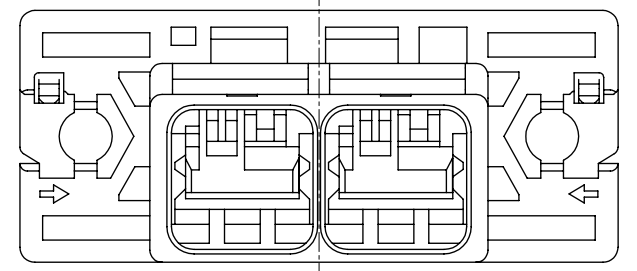

- Note 1. 100 Pieces / Pack
 2. Refer to the technical specification (ETAP-H1021-00) for the packaging type.
 3. Refer to the technical specification (ETAD-H0654-00, ETAD-H0653-00) in handling this product.
 △ 4. UL (File No. E52653)
 C-UL (File No. E52653)
 TÜV (Certificate No. R50400864) authorization article.

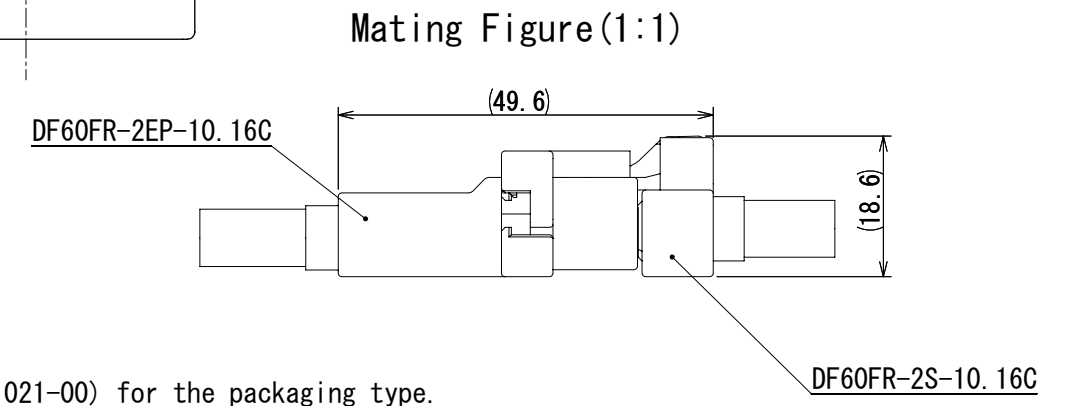
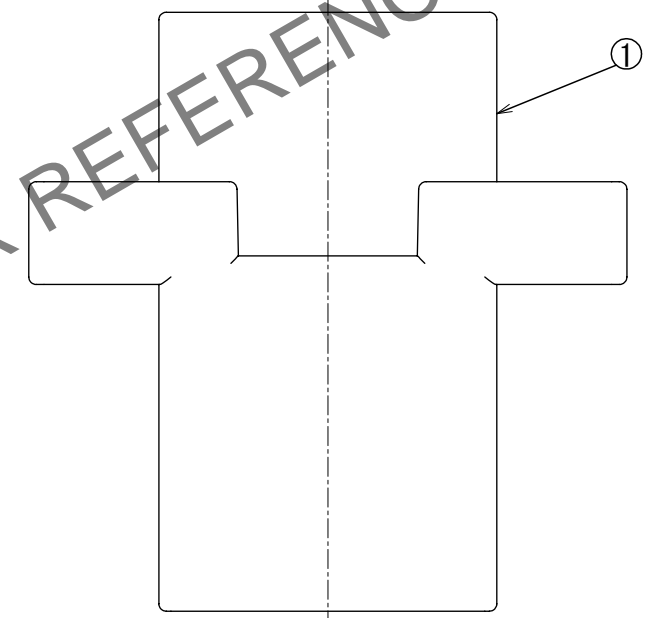
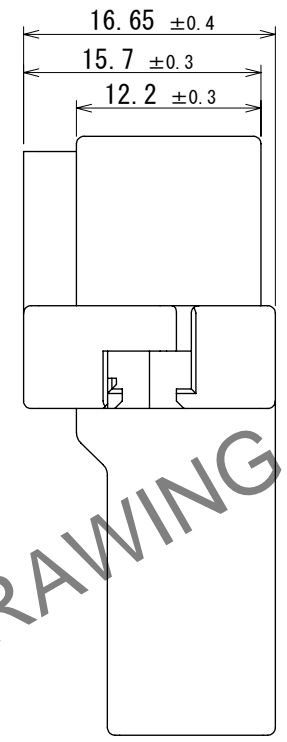
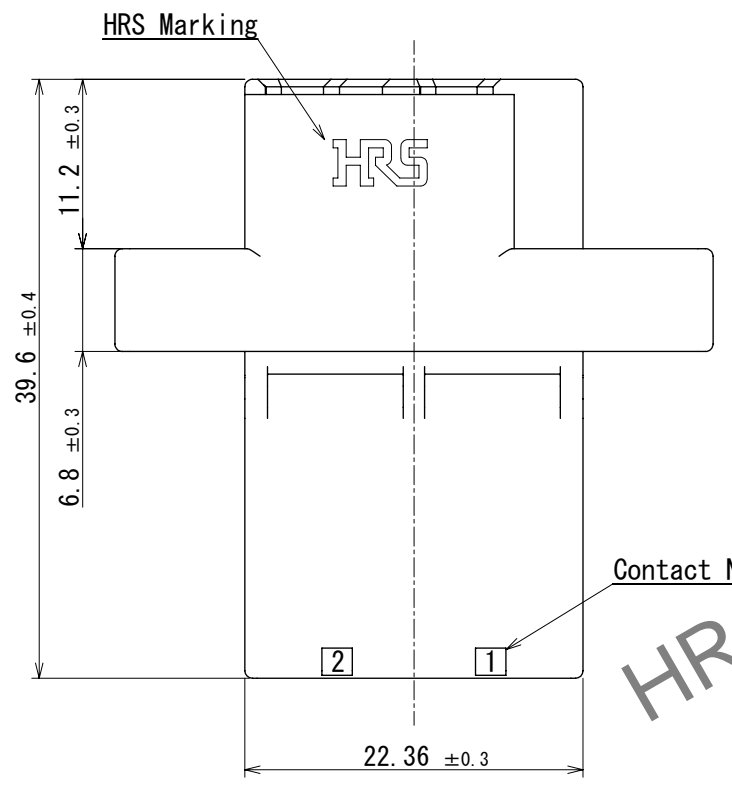
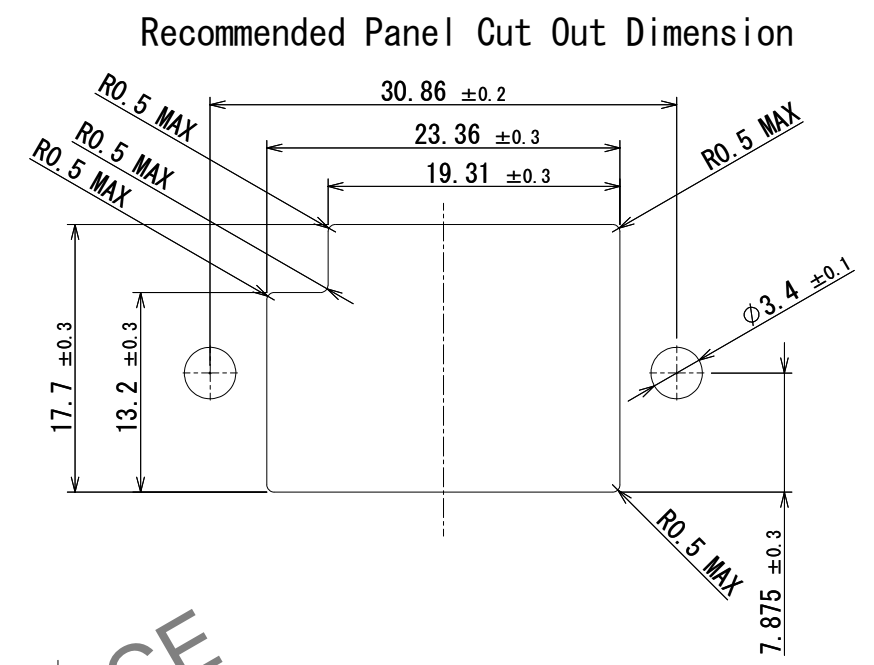
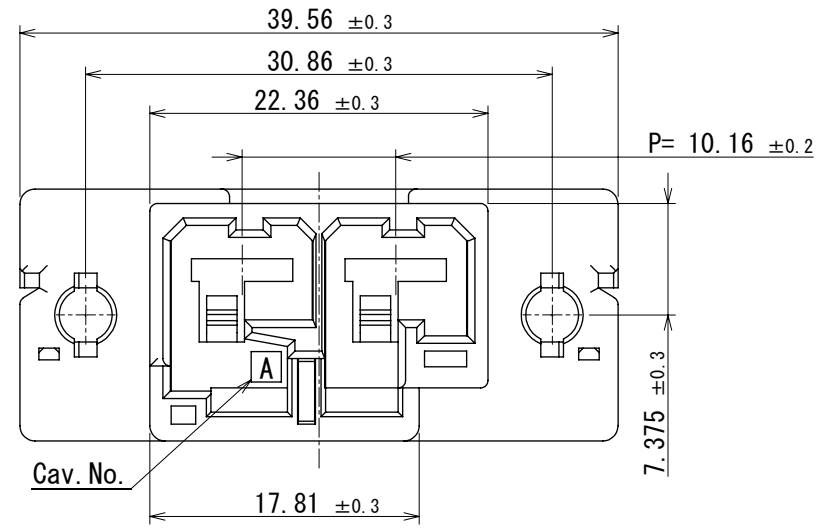

NO.	MATERIAL	FINISH	REMARKS
1	PBT	RED, UL94-V0	

UNITS	SCALE	COUNT	DESCRIPTION OF REVISIONS	DESIGNED	CHECKED	DATE
mm	2:1	1	DIS-H-00018505	TS. KUMAZAWA	SZ. ONO	2023. 06. 16

APPROVED	DATE	DRAWING NO.
SJ. OKAMURA	2022. 08. 04	EDC-386591-00-00
CHECKED	DATE	PART NO.
TT. OHSAKO	2022. 08. 04	DF60FR-2EP-10. 16C
DESIGNED	DATE	CODE NO.
SN. MIWA	2022. 08. 02	CL0680-4012-0-00
DRAWN	DATE	
SN. MIWA	2022. 08. 02	



DF60F In-Line Type Recommended Panel Mounting Manual in Using Nuts

Nut insertion process

1. Slide the nut (size:M3) to the nut fix part.

2. Press down the nut until it clicks.
Then, this sound means that the nut has inserted into the nut holder.

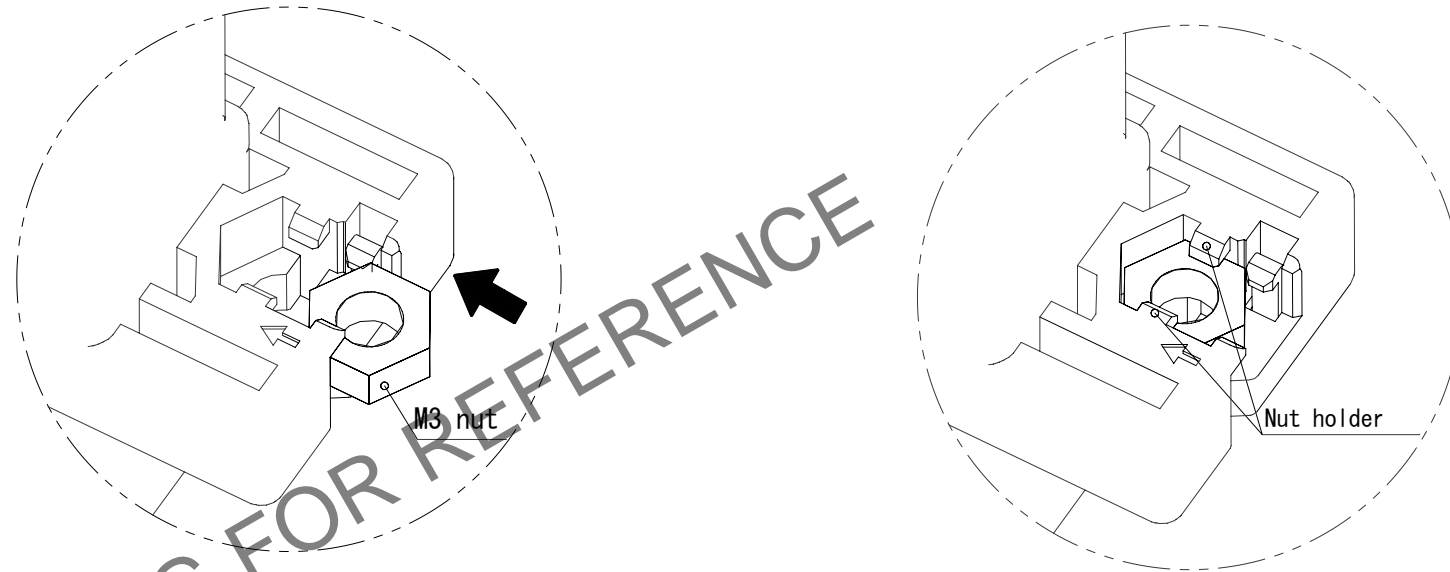
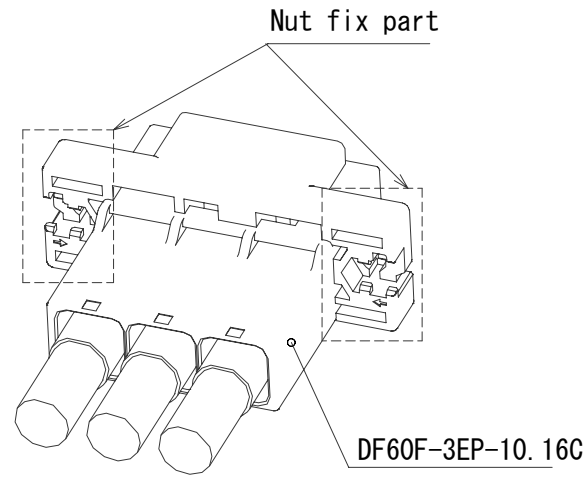

Panel mounting process

1. Insert connector into the panel cut out part.

2. Tighten a screw (size:M3) to fix with panel.
Recommended torque : Less than $0.49\text{N} \cdot \text{m}$

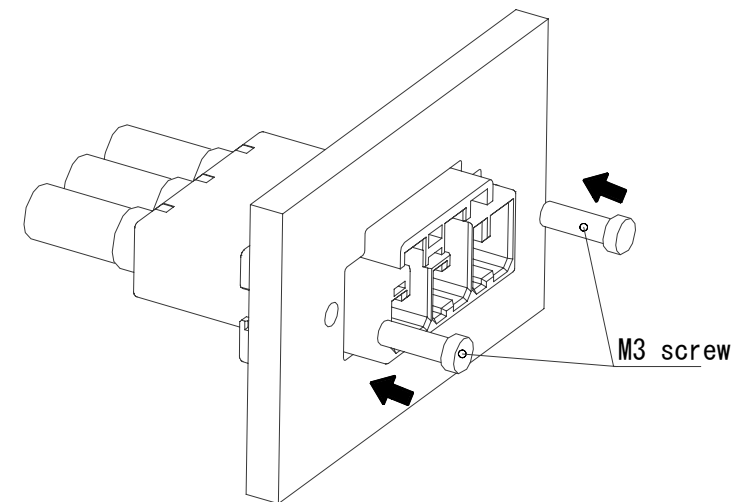
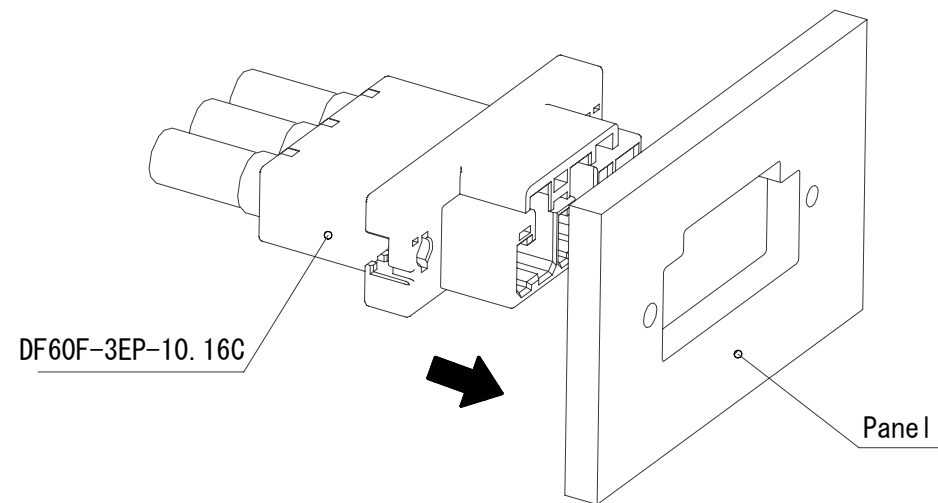

HRS	DRAWING NO.	EDC-386591-00-00	2/2
	PART NO.	DF60FR-2EP-10.16C	
	CODE NO.	CL0680-4012-0-00	
	NO.		