

FJ Series

Compact Optical Fiber In-Line Connector for Internal Connection (FJ-L)



Fiber Optics



Slim In-Line



Bayonet

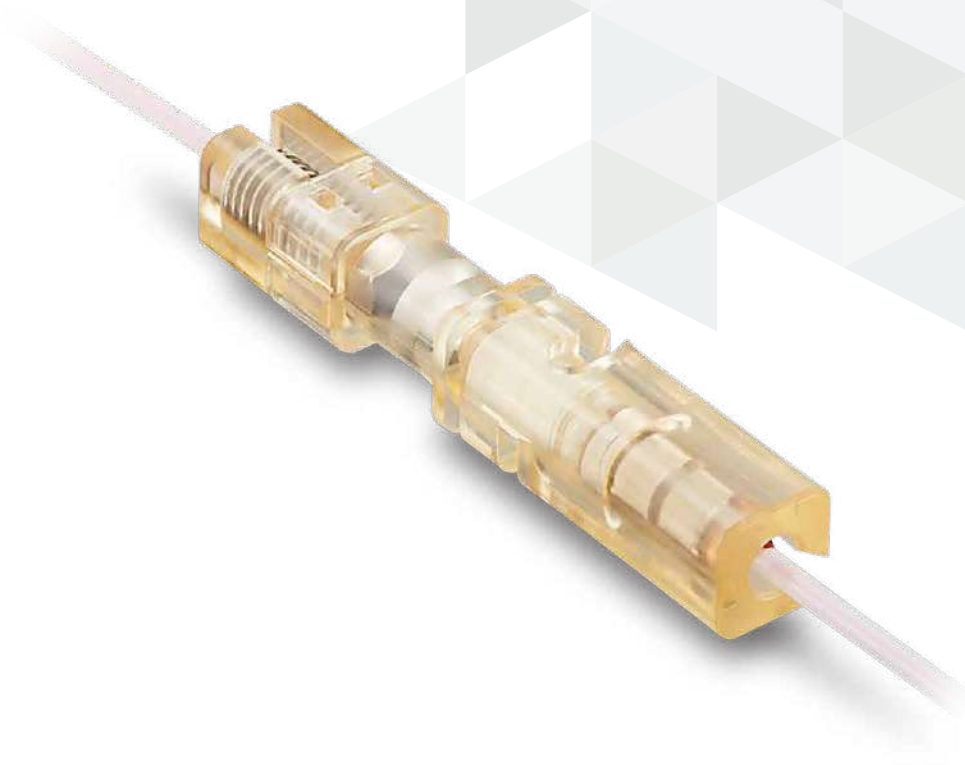

Overview

The FJ-L offers a compact optical connection using standard LC parts, ensuring more stable connectivity compared to traditional fusion methods.

Features

1. Space-Saving

Plug diameter: $\phi 5.5\text{mm}$.

Jack diameter: $\phi 3.5\text{mm}$.

Accommodates ferrules within these dimensions.

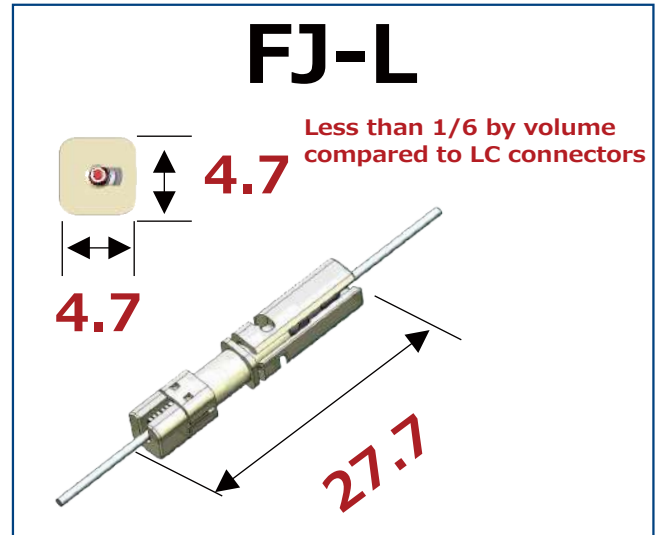

2. Can tie with wires.

The connector can be tied alongside the wire using a binding band.

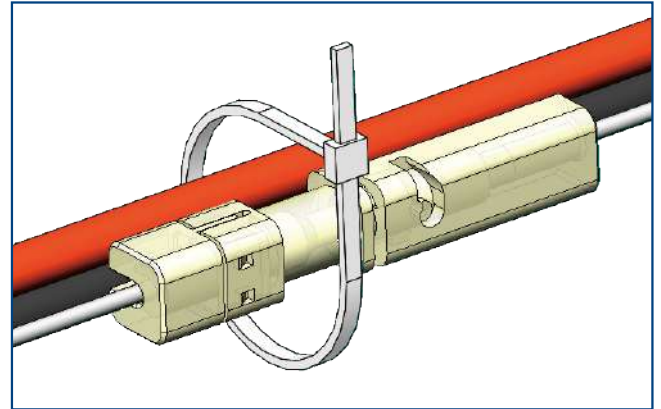

3. Easy Mating with Bayonet Lock Design

The bayonet lock design ensures easy and secure mating.

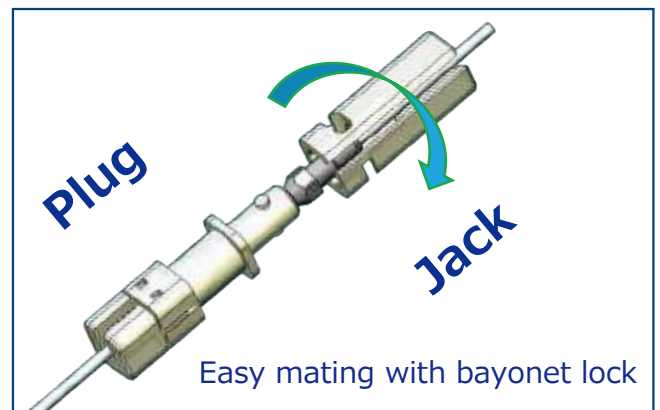

4. Standard LC Connector Ferrules

Utilizes standard LC connector ferrules, offering flexibility in choosing distributors and cable assembly manufacturers.

(Note: Only Multimode Fiber (MMF) is applicable.)

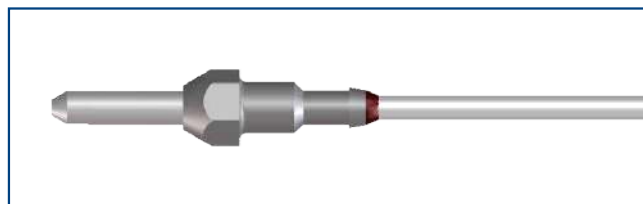

5. Easy Assembly

Assembly is straightforward and more stable than fusion splicing due to the utilization of standard optical connector cabling processes.

Additionally, manual assembly is simplified.

Plug Design

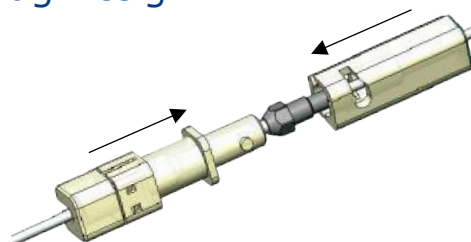

Insert the ferrule into the plug tip, place the jack over it, and insert the plug projection into the jack hole.

Jack Design

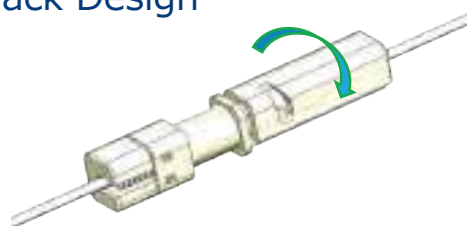

Rotate the jack right to lock, left to release.

Product Specifications

Used Cable	φ 0.5 Bending Resistant Fiber (GI50/80)	Operating Temperature Range (Operating)	-10 to +85°C (85% RH Max.) Operating in conditions without freezing and moisture condensation.
Storage Temperature Range (When packing)	-10 to +60°C (5 to 85% RH) Operating in conditions without freezing and moisture condensation.	Storage Temperature Range (Non-operating after mounting)	-40 to +85°C (85% RH Max.) Operating in conditions without freezing and moisture condensation.
Compatible Connector	FJ-L Plug Cable Assembly		

Item	Specifications	Conditions
Insertion Loss (Note)	0.5dB Max. (Per terminal)	Use a 850nmLED stabilized light source. Measure the insertion loss at both ends (LC ferrule).
Mating Durability	No damage affecting function or operating performance (Check appearance and signal transmission) Post-test insertion loss variation: 0.5dB Max. No damage, cracks or part dislocation	50 times
Vibration Resistance		Frequency 10-55Hz, Half amplitude 0.75mm, 3 directions, 10cycle each.
Impact Resistance		Acceleration 490m/s ² , Pulse duration 11ms, Half-Sin wave, 3directions, three times each
Temperature Cycle		Temperature -40°C ⇔ +85°C, Time 10min. ⇔ 10min. in 100cycles
Heat Resistance		Test conducted at temperature of +85°C for 1,000hours
Cold Resistance		Test conducted at temperature of -40°C for 1,000hours
Temperature and Humidity Cycle		Test conducted at a temperature -10 to +65°C, 24hours each for 10cycles

(Note) Insertion loss measurement uses the master cable assembly.

Handling Precautions

Clean the end face of the ferrule after each mating.
(Use a pen-type cleaner on the plug side.)

Materials / Finish

Component	Material
Optical Fiber	Fiber: Silica Glass Coating: UV Curable Resin/Fluorinated Resin
Hytrek Tubing	Tubing: Polyester Thermoplastic Elastomer
FJ-L Plug	LC Ferrule: Zirconia/Brass Spring: Stainless Steel Split Sleeve: Zirconia LC Coupling P1: Polyether Sulfone LC Coupling P2: Polyether Sulfone
Plug Cap	Cap: Styrenic Elastomer
FJ-L Jack	LC Coupling J: Polyether Sulfone
LC Ferrule Cap 1.25	Cap: Polyester Thermoplastic Elastomer

Product Number Structure

Refer to the chart below when determining the product specifications from the product number.

■ Cable Assembly

FJ L N - LN - M08 01 - 1M

① ② ③ ④ ⑤ ⑥ ⑦

① Series Name	FJ Series	⑤ Cable Specification	M08: Outer Dia. ϕ 0.5, Red
② Ferrule Type	L: LC Ferrule	⑥ Serial Number	Different Series
③ Connector Type	FJ-L P: Plug (Assembled) N: Ferrule only	⑦ Length	##M: 1m Min. ##MM: 1m or less.
④ Reverse End Connector	SC FC FCAPC LC LP: FJ-L Plug LN: FJ-L Ferrule only UP: FJ-U Ferrule+Spring UN: FJ-U Ferrule only BL: Detach		

(Note) We also have a combination cable assembly with our BF4 series.
For more information, please contact Hirose representative.

■ Plug Kit

FJ - L - P - KT 1

① ② ③ ④ ⑤

① Series Name	FJ Series	④ Packaging Style	Kit
② Ferrule Type	L: LC Ferrule	⑤ Serial Number	Different Series
③ Connector Type	P: Plug		

■ Jack

FJ - L - J - 1

① ② ③ ④

① Series Name	FJ Series	③ Connector Type	J: Jack
② Ferrule Type	L: LC Ferrule	④ Serial Number	Different Series

Cable Assembly

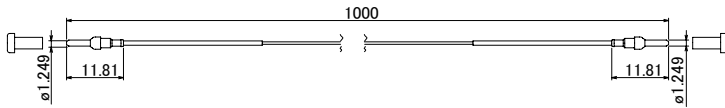

Part No.	HRS No.	Purchase Unit
FJLN-LN-M0801-1M	CL0719-1500-0-00	1pc per bag

Plug Kit

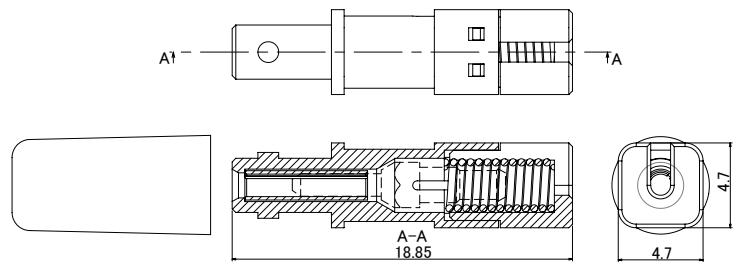

Part No.	HRS No.	Purchase Unit
FJ-L-P-KT1	CL0719-1100-0-00	200 sets per bag

Note 1: Ferrules are not included.

Note 2: The actual kit has not been assembled.

Jack

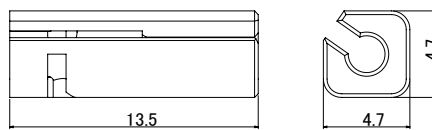

Part No.	HRS No.	Purchase Unit
FJ-L-J-1	CL0719-1101-0-00	100pcs per bag

Precautions

Precautions for Handling Products

(Changes in Content)

- The contents of this document, including information on connectors (Hereinafter, this product), are subject to change without prior notice.

(Prohibition on Reproduction)

- Reprinting and reproduction of this document without the written consent of Hirose Electric Co., Ltd. (Hereinafter, Hirose) is prohibited. Even if the written consent of Hirose is obtained, it is prohibited to change the contents of this document and reproduce it. Hirose assumes no obligation or responsibility for such changed information or reproduction.

(Design Safety Responsibility:)

- Hirose is not liable for the application of this product or your product design. Responsibility for the safety and compliance of products and applications using these connectors rests with you. Adequate safety measures should be taken.

(Design Responsibility:)

- It is your responsibility to design and use this product safely, ensuring that it does not endanger life, body, or property. Consult and adhere to product documentation (catalogs, specifications, design notes) when using this product. Evaluate and use product data and technical details at your own risk.

(Use in Specific Applications:)

- If you are considering use for applications that require extremely high quality or reliability (Nuclear equipment, aerospace equipment, transport equipment, various safety-related equipment, etc.), please contact your sales representative in advance.

(Restrictions on Modification:)

- Disassembling, reverse engineering, modifying, analyzing, or copying this product is prohibited.

(Prohibited Uses:)

- This product must not be used in the manufacture, use, or sale of items prohibited by national or international laws and regulations.

(Intellectual Property and Warranties:)

- The technical information contained in this product documentation is for the purpose of explaining typical and applied operations of this product, and does not guarantee or license any intellectual property or other rights of our company or any third party in the use thereof.

(Warranty Exclusions:)

- Hirose disclaims all warranties (Guarantee of function and operation, guarantee of merchantability, guarantee of conformity to specific use and purpose, guarantee of accuracy of information, etc.) with respect to the products and technical information unless otherwise agreed upon in writing or in writing (specifications, etc.).

(Export Precautions:)

- When exporting this product outside Japan, the exporter is required to make the determination in accordance with the Foreign Exchange and Foreign Trade Law. If you would like the determination issued by our company, please contact your sales representative. In the export arrangement, you are the exporter and responsible for complying with the relevant laws, regulations and our company terms and conditions.

While Taking into Consideration

Specifications mentioned in this catalog are reference values.

When considering to order or use this product, please review the Drawing and Product Specifications sheets.

Use an appropriate cable when using the connector in combination with cables.

If considering usage of a non-specified cable, please contact your sales representative.

If assembly process is done by jigs & tools which are not identified by Hirose, the warranty of the product may be affected.

If considering usage for below mentioned applications, please contact your sales representative.

In cases where the application will demand a high level of reliability, such as automotive, medical instruments, public infrastructure, aerospace/defense etc. Hirose must review before assurance of reliability can be given.