

ELV, RoHS COMPLIANT

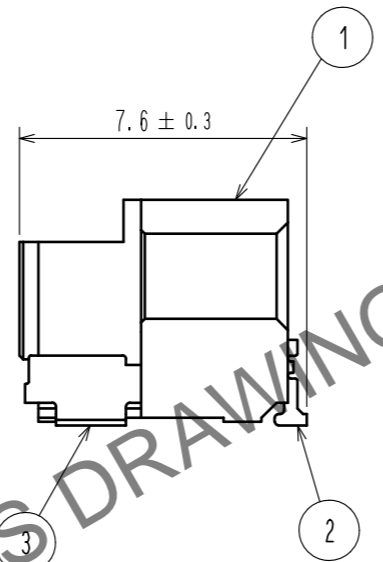

MATED CONNECTORS (FREE)

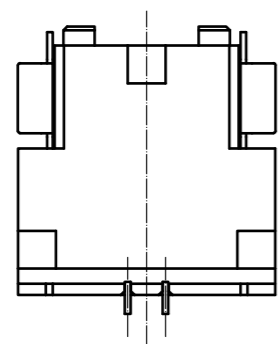
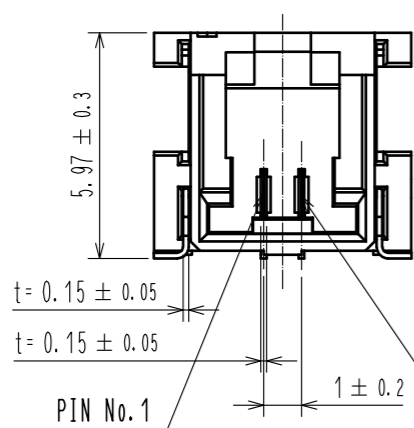
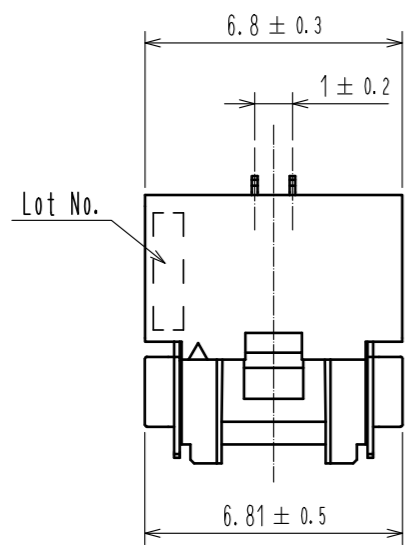
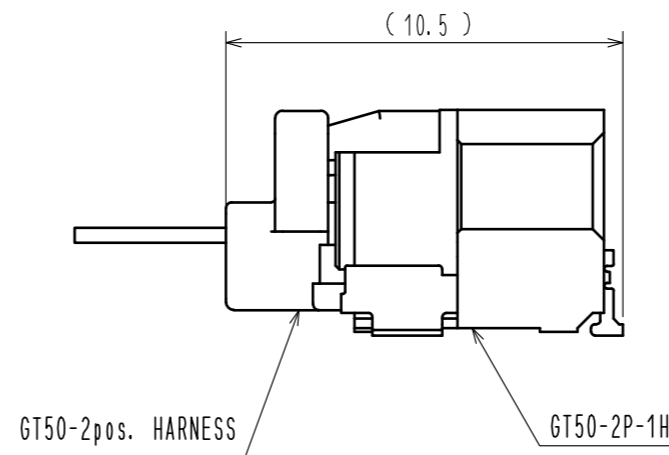

RECOMMENDED PCB PATTERN (FREE)

OPEN AREA RATIO : 100%

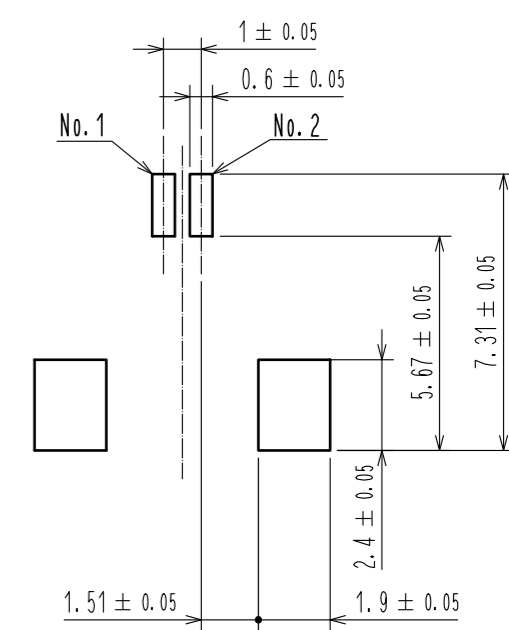

- NOTE 1. RECOMMENDED TEMPERATURE PROFILE FOR REFLOW (REFER TO RIGHT FIG.)
 USED REFLOW SYSTEM : IR IN THE AIR OR NITROGEN
 NO. OF CYCLES : 2 MAX
 PEAK : 250°C
 OVER 230°C : 20~40s
 PREHEAT : 150~180°C
 90~120s
 2. TEMPERATURE FOR SOLDERING IRON : 280~300°C WITHIN 2s
 3. CO-PLANARITY : 0.1mm MAX
 4. RECOMMENDED SOLDER THICKNESS : 0.10mm

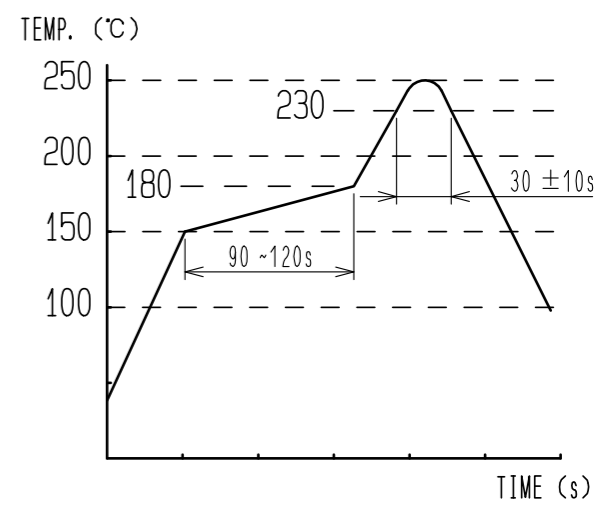

3	BRASS	TIN PLATING	6	PS			
2	BRASS	Au PLATING	5	POLYESTER			
1	LCP	BLACK	4	POLYSTYRENE			
NO.	MATERIAL	FINISH . REMARKS	NO.	MATERIAL	FINISH . REMARKS		
UNITS mm		SCALE 5 : 1	COUNT 1	DESCRIPTION OF REVISIONS DIS-T-00017887	DESIGNED YT. TAKANASHI	CHECKED TY. MOGI	DATE 20230525
HRS HIROSE ELECTRIC CO., LTD.		APPROVED : HK. UMEHARA 20201224	DRAWING NO. EDC-392585-00-00				
		CHECKED : OM. MIYAMOTO 20201224	PART NO. GT50-2P-1H				
		DESIGNED : YT. TAKANASHI 20201222	CODE NO. CL0760-1002-0-00				
		DRAWN : YT. TAKANASHI 20201222					

Sep.1.2023 Copyright 2023 HIROSE ELECTRIC CO., LTD. All Rights Reserved. In case of consideration for using Automotive equipment / device which demand high reliability, kindly contact our sales window correspondents.

Sep.1.2023 Copyright 2023 HIROSE ELECTRIC CO., LTD. All Rights Reserved.
 In case of consideration for using Automotive equipment / device which demand high reliability, kindly contact our sales window correspondents.

PACKING STYLE (FREE)

REEL DIMENSION

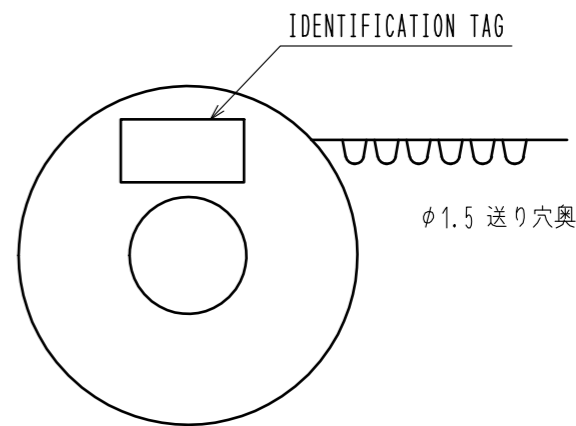

PACKING STYLE DRAWING

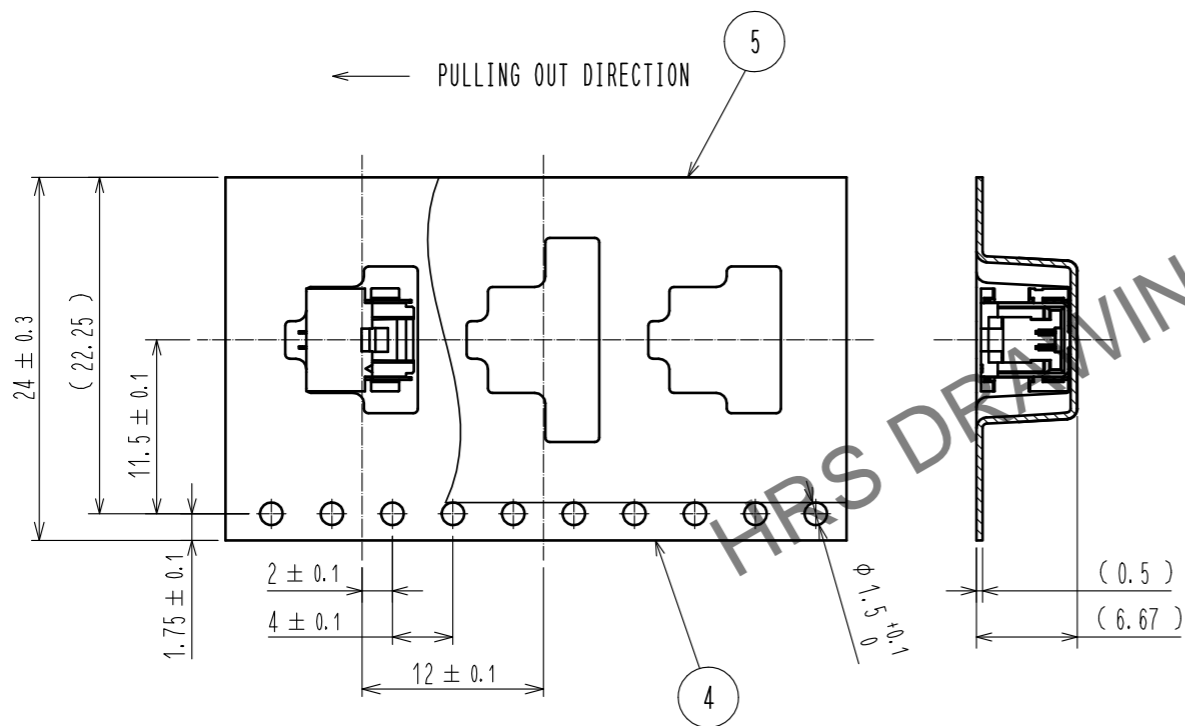

PRODUCTS DIRECTION

FIXING EMBOSSED CARRIER TAPE



φ1.5 CARRIER HOLES AT FRONT

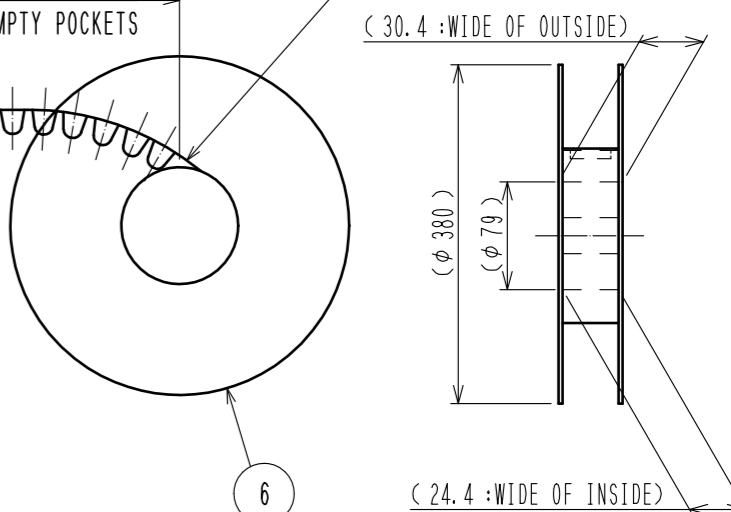

1000 PCS/REEL

CARDBOARD DIMENSION

W=(405) (mm)
 D=(405) (mm)
 H=(31) (mm)

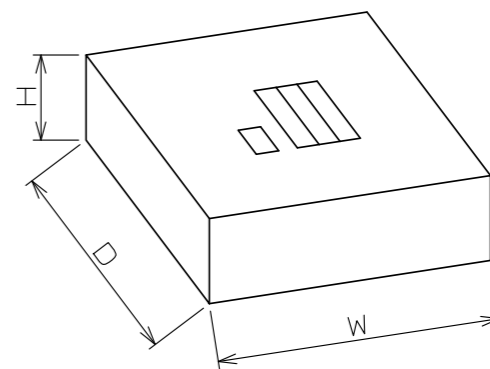

※ Embossed pocket has a different shape to prevent overlapping, and the drawing shows a representative shape.

HRS	DRAWING NO.	EDC-392585-00-00
	PART NO.	GT50-2P-1H
	CODE NO.	CL0760-1002-0-00
		2/2