

△ HVH-280-2/2S-HU
Instruction Sheet

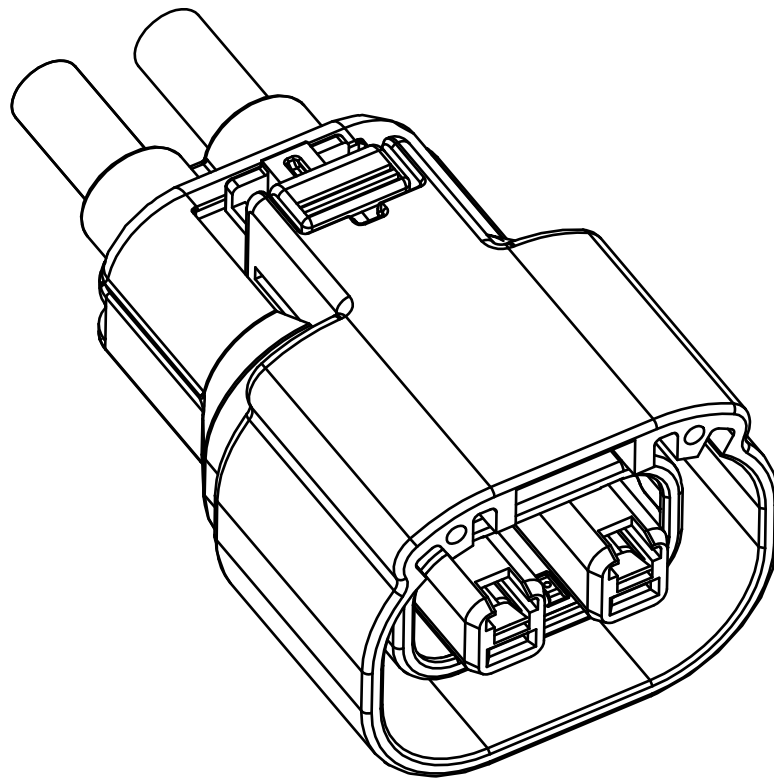

	COUNT	DESCRIPTION OF REVISIONS	DESIGNED	CHECKED	DATE
△	17	DIS-T-00013969	TY. MOGI	HH. TSUKUMO	20220601
TITLE HVH-280-2/2S-HU Assembly Procedure				HRS HIROSE ELECTRIC CO., LTD.	
				APPROVED	HK. UMEHARA 20170811
				CHECKED	HK. UMEHARA 20170811
				CHARGED	KO. NAKAMURA 20170810
				WRITTEN	MN. SATOH 20170810
TECHNICAL SPECIFICATION				ETAD-T0574-00	△ 1 / 11

△ TABLE OF CONTENTS

1. NAME OF EACH PART

2. HARNESS ASSEMBLY

3. HOW TO REPAIR TERMINAL

4. OTHERS / NOTES

△ 1. Name of each part

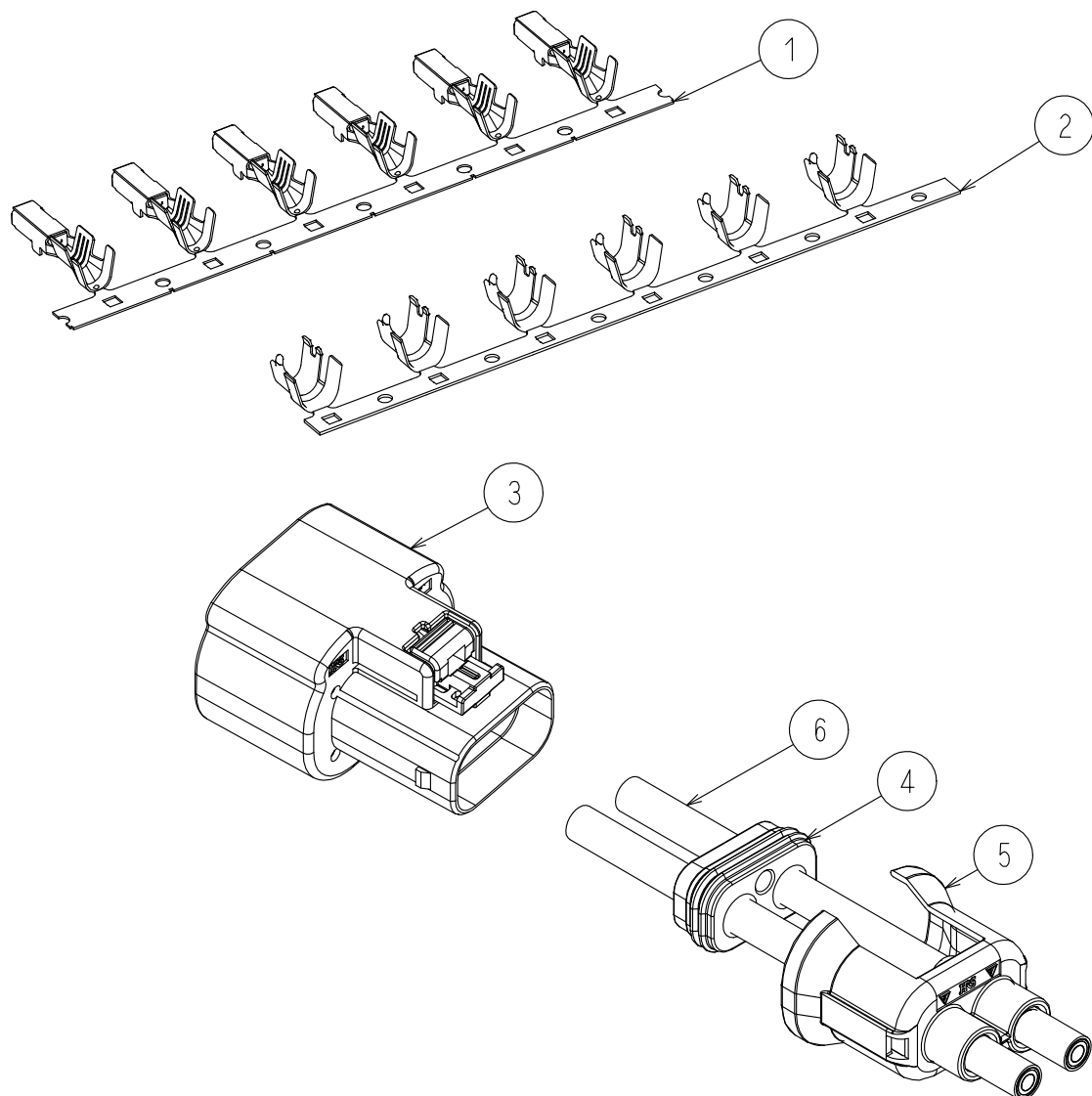

Part List Used in Cable Assembly

PART NO.	Name of Item	Part Name	Cl No.	No. of Parts
1	Female terminal for power supply	HVH-280-1214SCF	CL0778-0502-0-00	2
2	Shield terminal	HVH-280-4.2CF	CL0778-0503-0-00	2
3	Female housing (standard key)	HVH-280-2/2S-HU	CL0778-0504-0-00	1
	Female housing (A key)	HVH-280-2/2S-HU(A)	CL0778-0508-0-00	
4	Wire seal	HVH-280-2/2S-WS	CL0778-0505-0-00	1
5	Female holder	HVH-280-2/2S-HO	CL0778-0507-0-00	1
6	Shielded cable	—	—	2

Female Holder HVH-280-2/2S-HO Terminal number



Aperture (One side only)

HRS Mark

Cavity 2

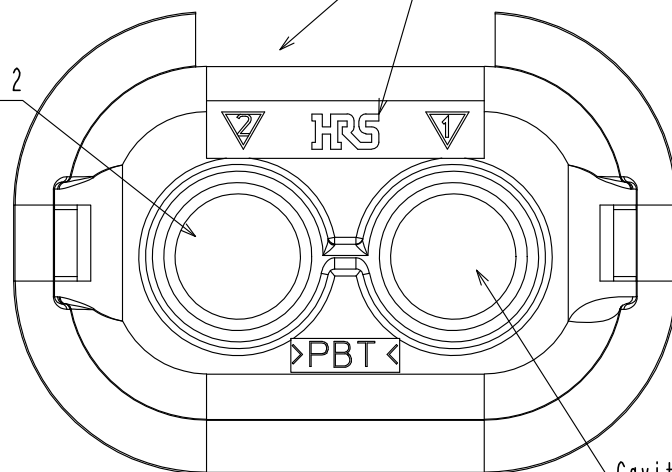

Cavity 1

Wire seal HVH-280-2/2S-WS Terminal number



Hole of Recess (One side only)

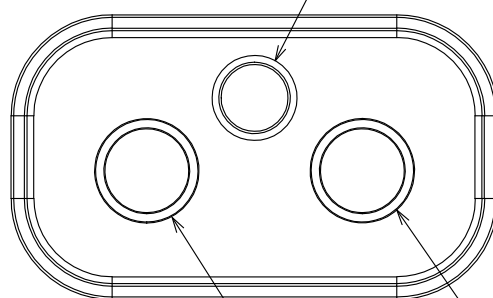

Cavity 1

Cavity 2

Terminal number in assembled state



Cavity 2
(Cable 2)

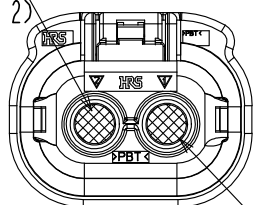

Cavity 1
(Cable 1)

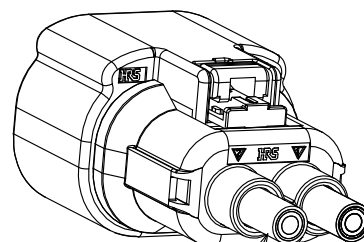

Cable 2

Cable 1

2. Harness assembly

△ (1) Cut the cable.

Please set the cut length referring to the following dimensions.

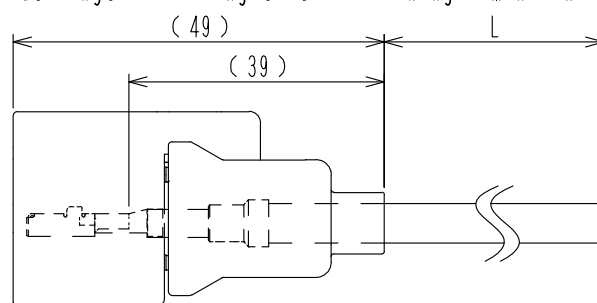

Estimated cut length: $L+39\text{mm}$

△ (2) Insert HVH-280-2/2S-HO and HVH-280-2/2S-WS into the cable in the orientation shown below.

Note: It is recommended to use a finger with a finger cot to avoid damaging HVH-280-2/2S-WS.

Note: To minimize the load on HVH-280-2/2S-WS, insert from the side where the wire passage distance is short.

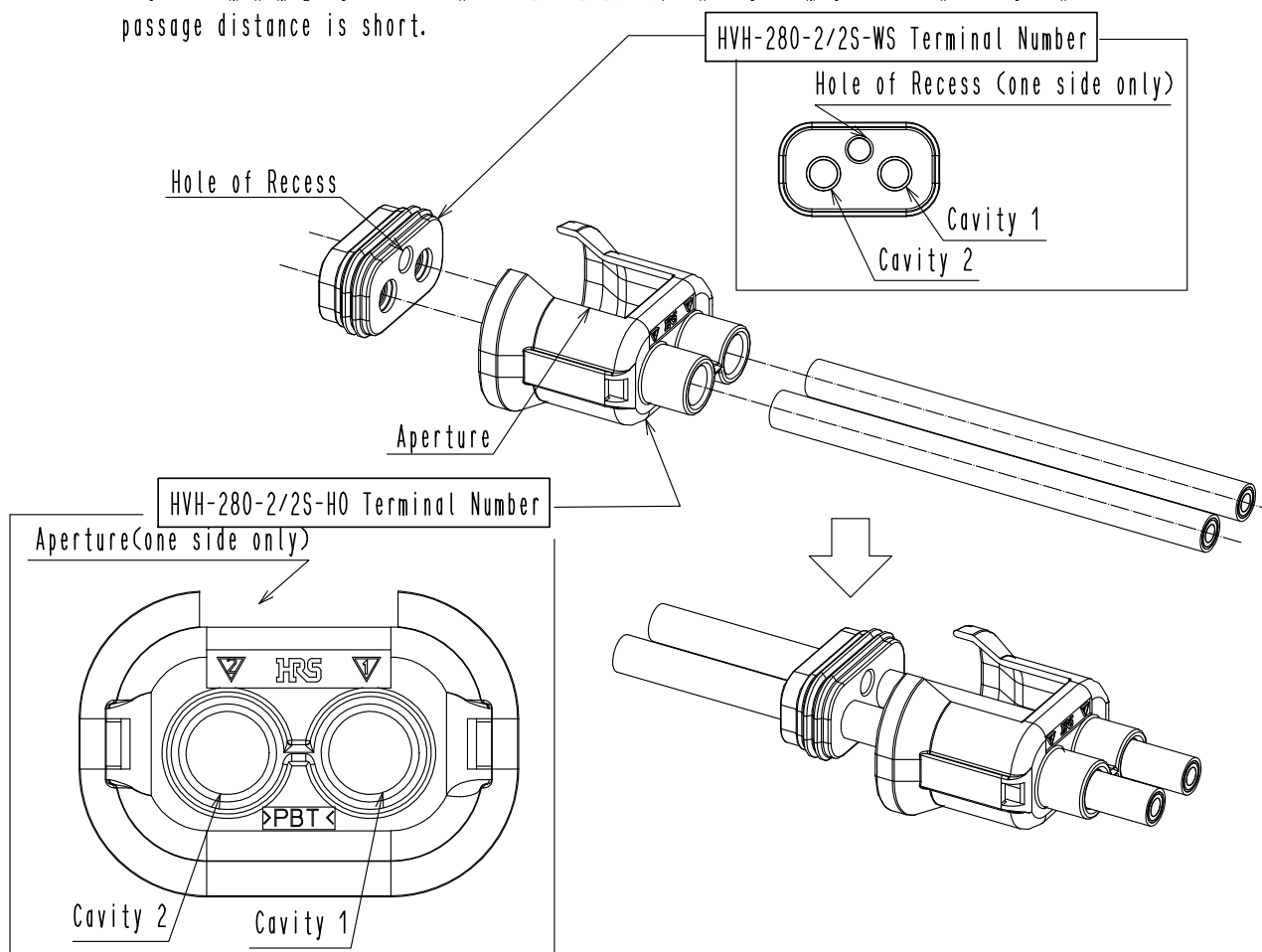

△ (3) Strip the cable.

Note: Refer to Technical Specification No. ATAD-T0662 (HVH-280-1214SCF Crimping Quality Standards) for strip length.

Note: Be sure to complete step (2) before stripping.

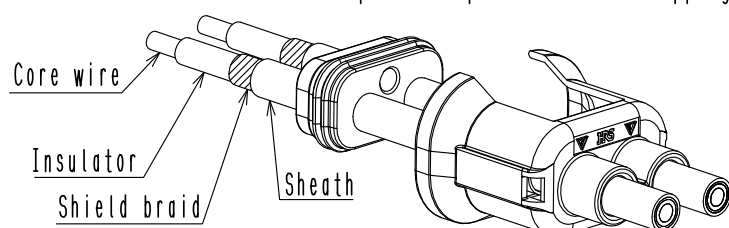

- ⚠ (4) Crimp the female power supply terminal HVH-280-1214SCF to the core wire.
 Note: Please use our dedicated crimping tool.
 Note: For the crimping condition, refer to Technical Specification No. ATAD-T0662
 (HVH-280-1214SCF Crimping Quality Standard).

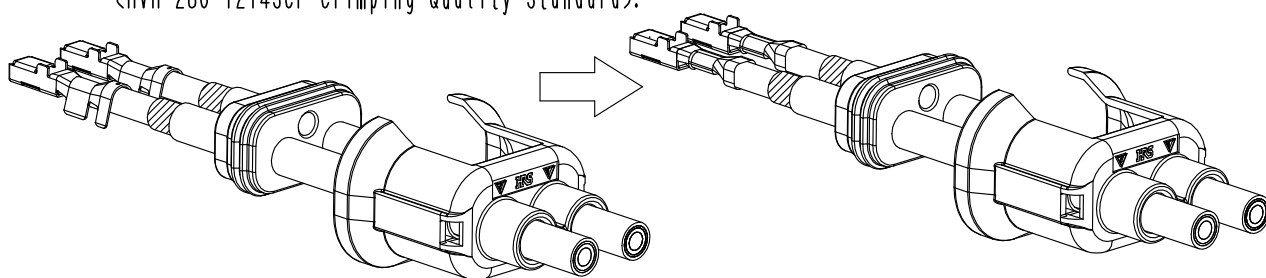

If the crimping direction is adjusted as shown in the figure below,
 the terminal can be smoothly inserted into the housing.

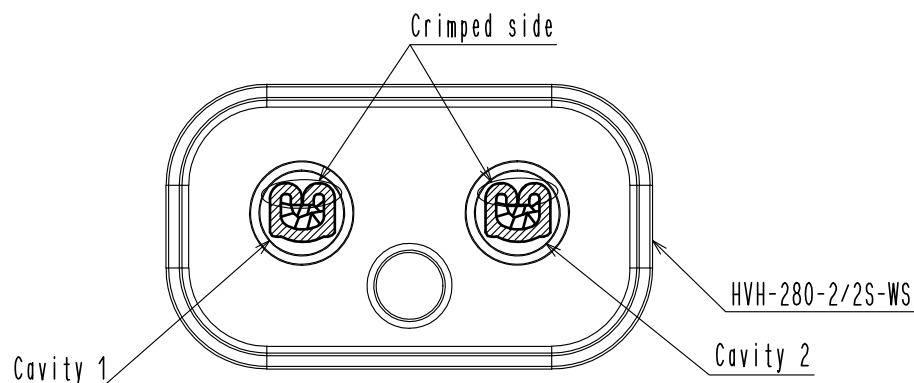
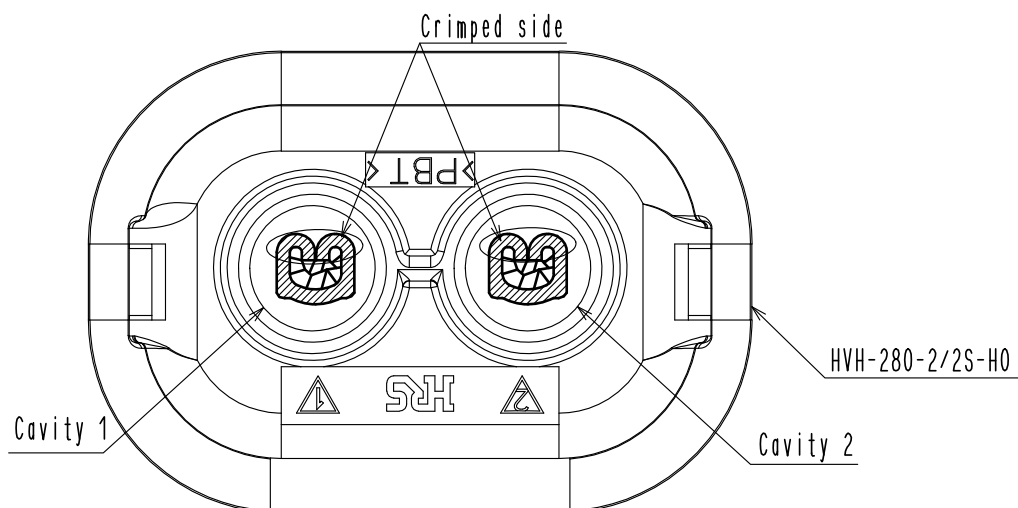

- ⚠ (5) Crimp the shield terminal HVH-280-4.2CF to the shield braid of the wire.
 Note: Please use our dedicated crimping tool.
 Note: For the crimping condition, refer to Technical Specification No. ATAD-T0661
 (HVH-280-4.2CF Crimping Quality Standard).

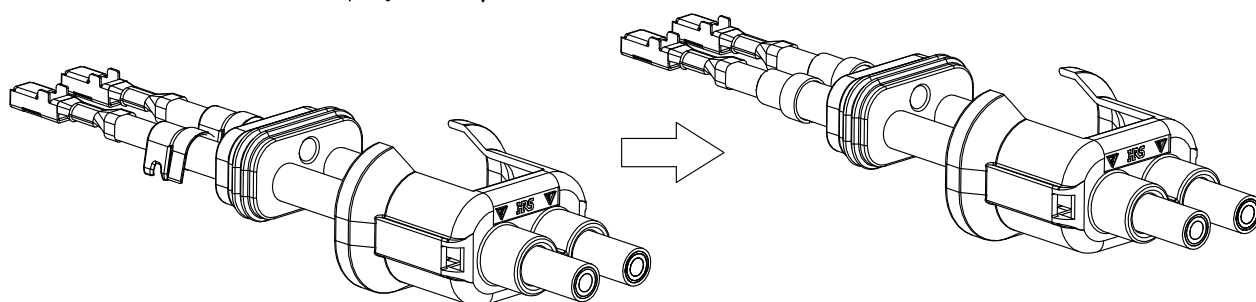

※The direction of crimping is not
 specified for this terminal.

- ⚠ (6) Insert HVH-280-1214SCF into the female housing HVH-280-2/2S-HU in the orientation shown below. Push it in until you hear click sound. If it is difficult to insert, rotate the head of the terminal a little and insert it.

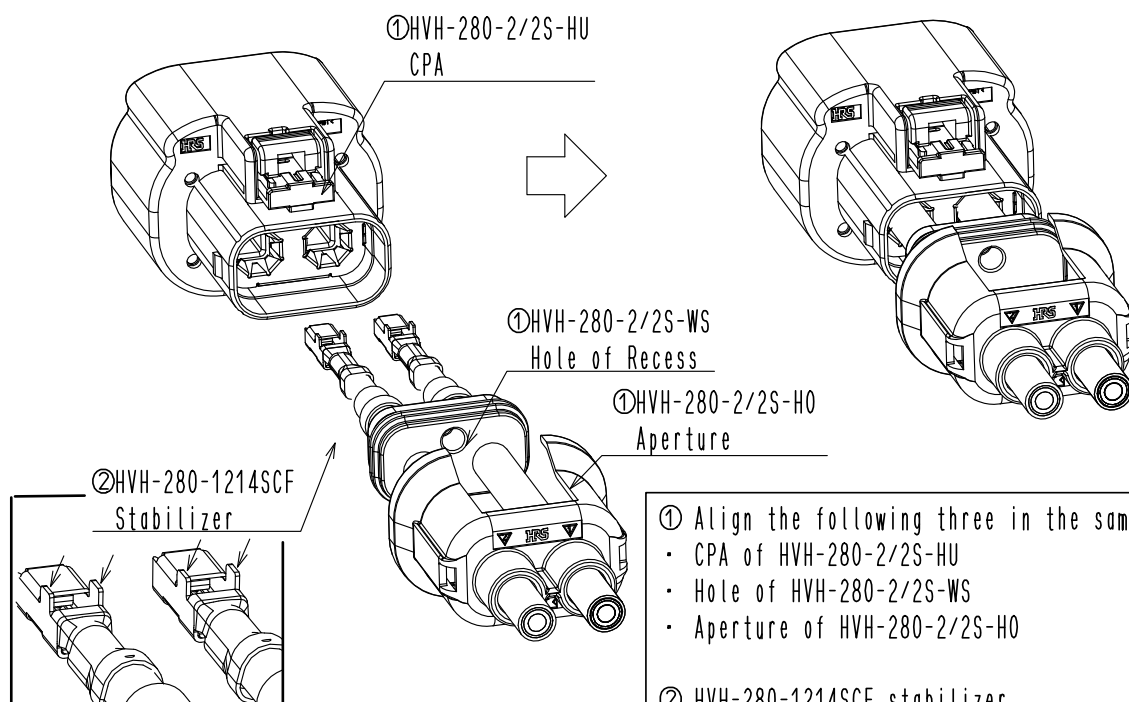

When difficult to insert HVH-280-1214SCF

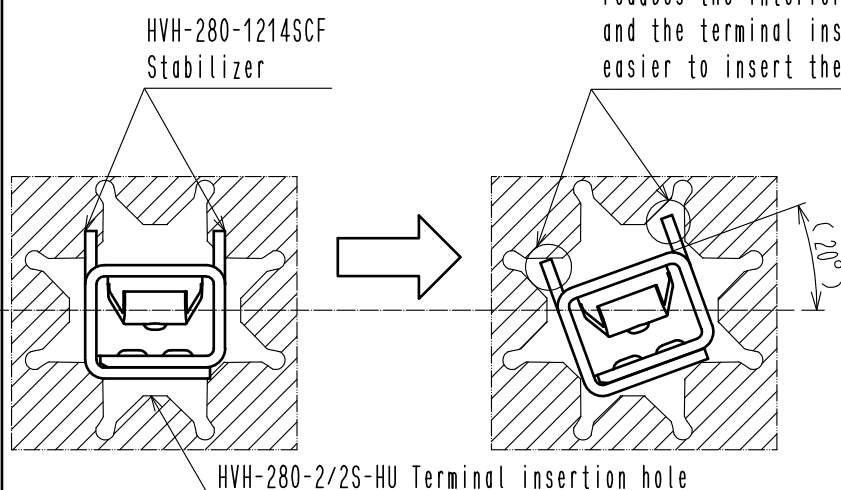

Rotating the HVH-280-1214SCF about 20 degrees, reduces the interference between the stabilizer and the terminal insertion holes, making it easier to insert the terminals.

- ⚠ (7) Push the HVH-280-2/2S-WS all the way into the HVH-280-2/2S-HU.

Note: It is recommended to use a finger with a finger cot to avoid damaging the HVH-280-2/2S-WS.

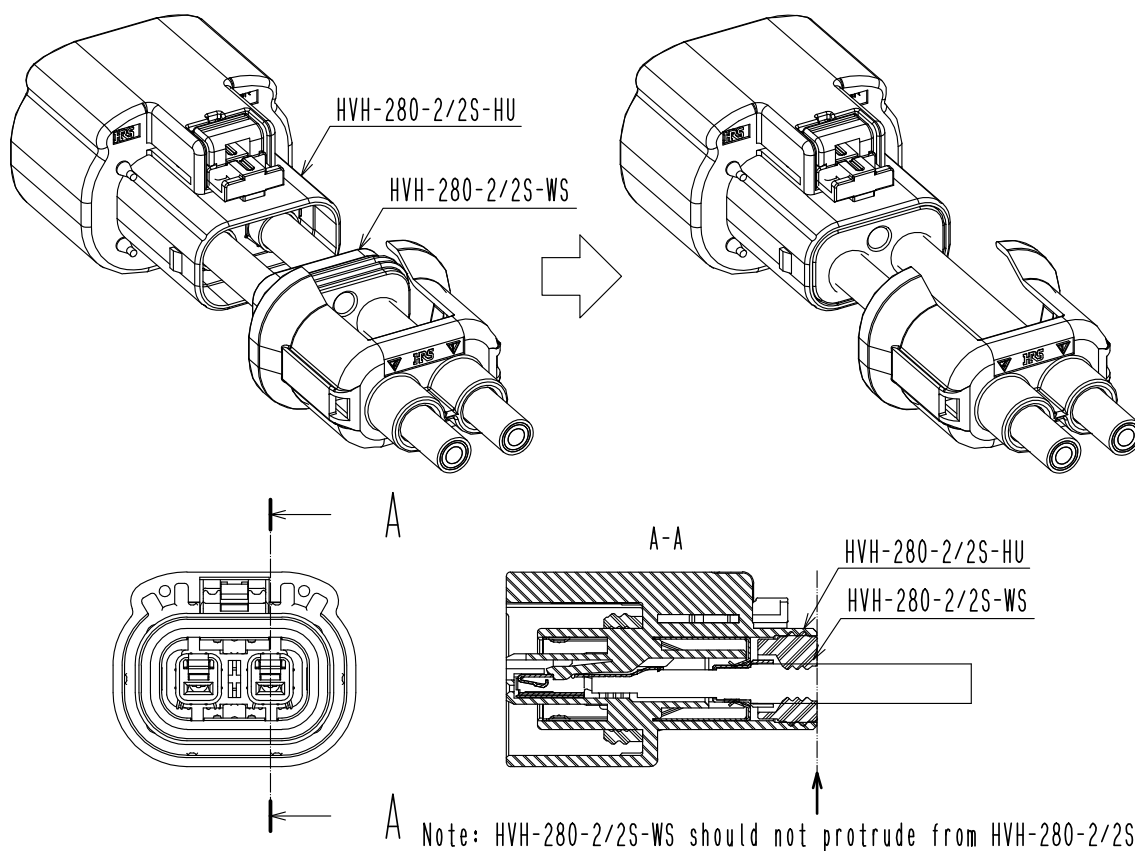

- ⚠ (8) Push the HVH-280-2/2S-HO into the HVH-280-2/2S-HU until you hear click sound.

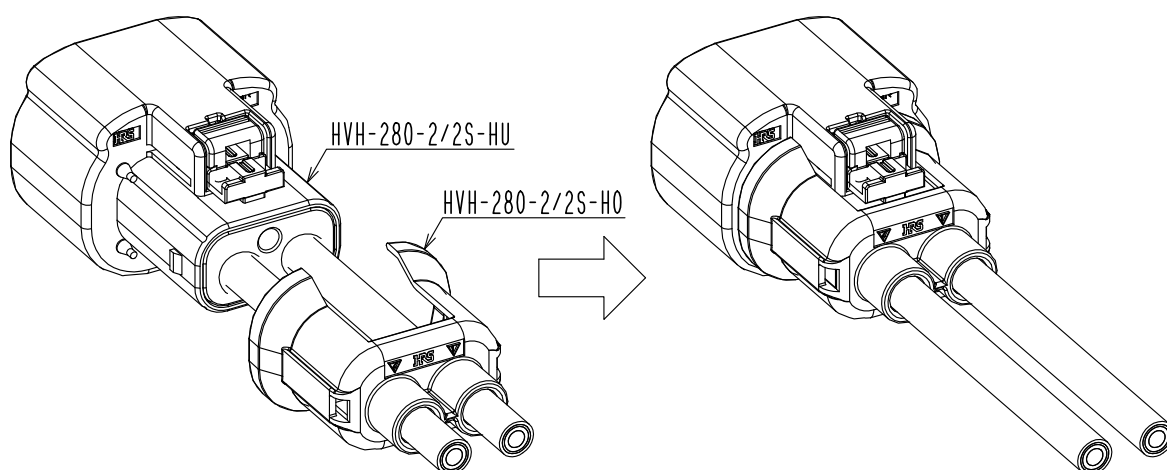

3. Terminal repair method

- ⚠ (1) When HVH-280-2/2S-H0 is installed, use a flathead screwdriver to release the two locking parts shown in the figure below, and remove it.

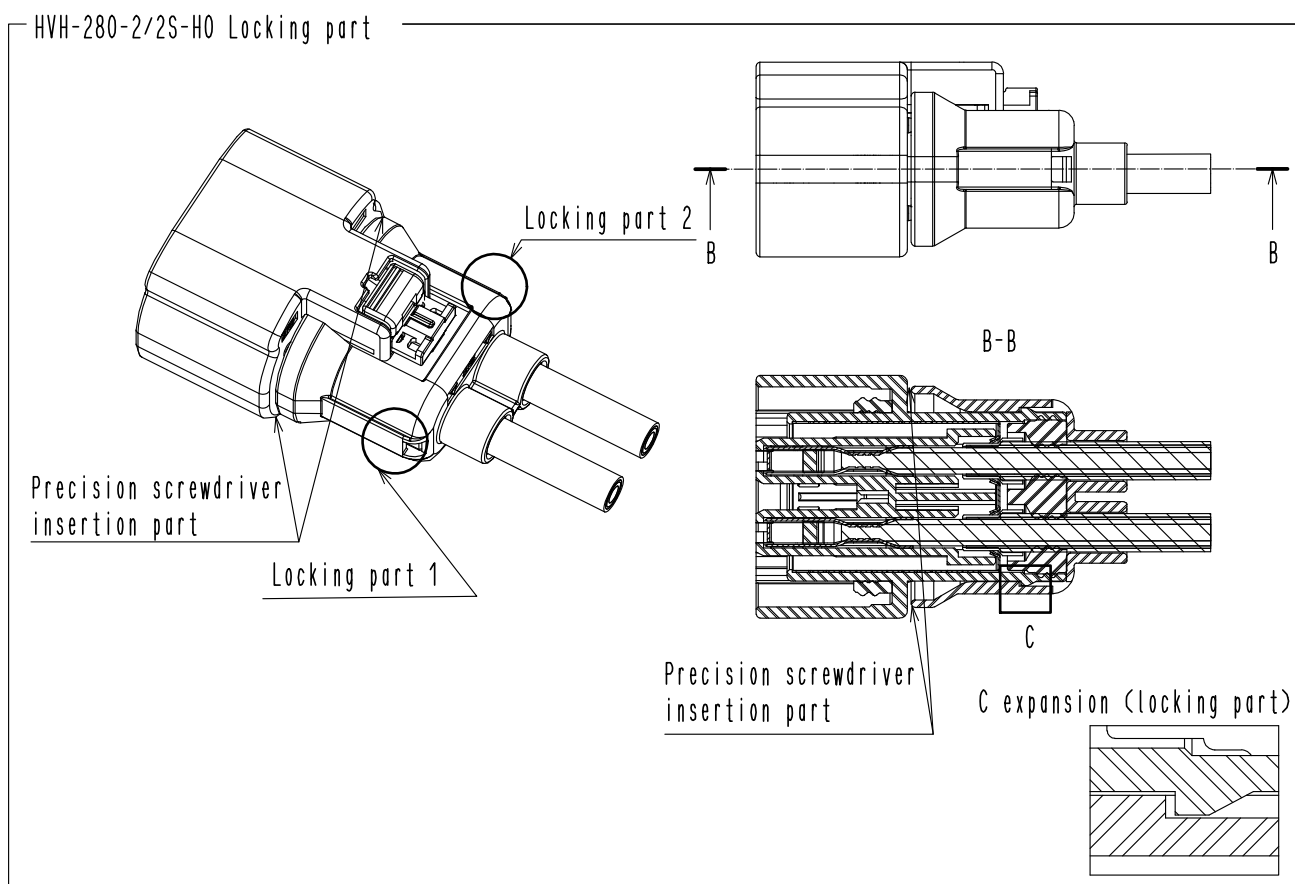

- ⚠ (2) Remove the HVH-280-2/2S-WS with a flathead screwdriver.

HVH-280-2/2S-WS External

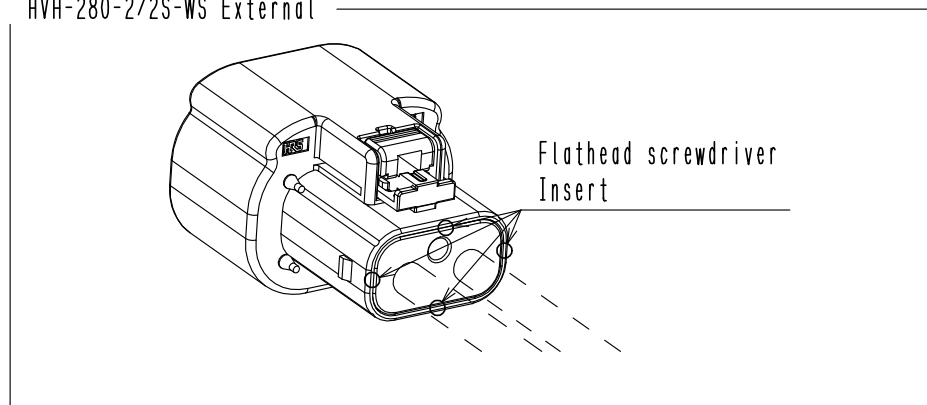

- ⚠ (3) Use a flathead screwdriver to push the mold lance of HVH-280-2/2S-HU in the direction shown in the figure below and pull out the terminal. At this time, be careful not to deform the terminal locking part or contact part.
 Note: Do not press the terminal locking part or contact part.
 Note: Once attached and removed, HVH-280-2/2S-HU, HVH-280-2/2S-WS, and HVH-280-2/2S-HO may be deformed or scratched, so replace them with new ones.

HVH-280-2/2S-HU

How to release the mold lance

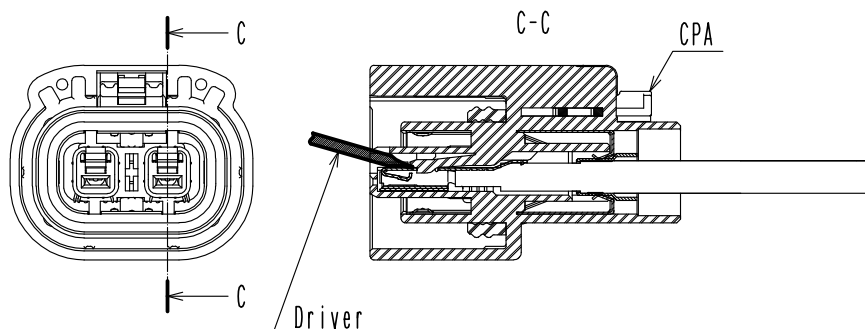

C-C Enlarged cross section

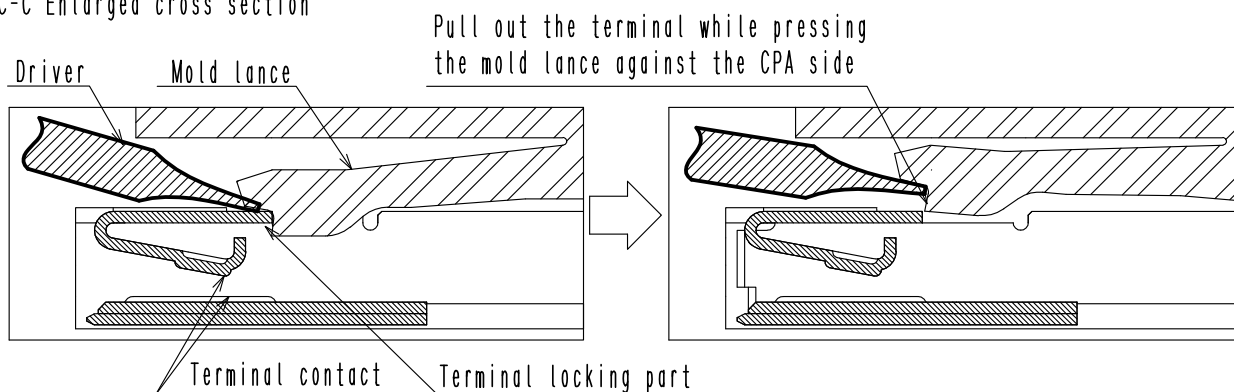

When HVH-280-1214SCF is difficult to remove

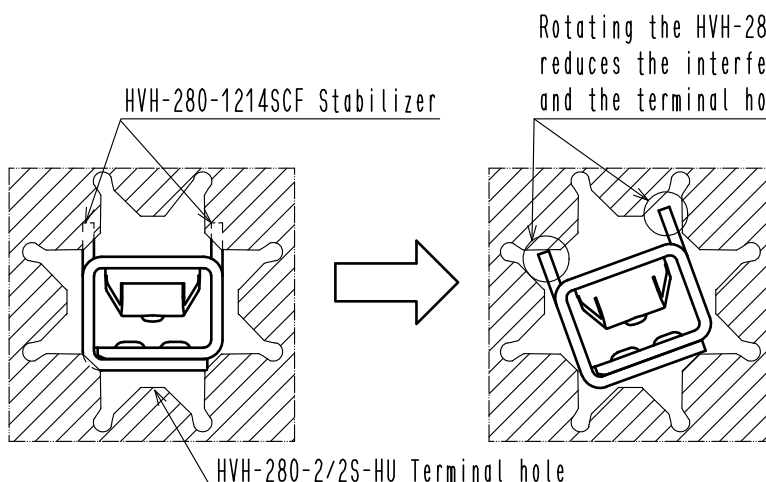

Rotating the HVH-280-1214SCF about 20 degrees, reduces the interference between the stablizer and the terminal holes, making it easier to pull out.

★ Others / Notes

- 1) Do not touch the terminal contact points or the interior of the barrel.
- 2) In the event that the terminal must be handled, please wear gloves in order to prevent corrosion.
- 3) Placing items on top of a terminal or dropping a terminal may result in shape deformities or contamination. Please handle terminals with care.
- 4) In the event of terminals becoming tangled, please do not forcibly pull or bend them apart, but disentangle them carefully.
- 5) Use caution when handling terminals so as to avoid deformation.
- 6) Make sure that the terminals of crimped cables do not become entangled.
When bundling or stacking cables, please prevent the terminals from being subjected to any external force.
- 7) Use caution to ensure that the part is not subjected to any large impacts.
- 8) Avoid storing in dusty areas.
- 9) Do not place wire harnesses on the floor.
- 10) Refrain from any handling that may result in terminal damage or deformation.