

Mar.1.2026 Copyright 2026 HIROSE ELECTRIC CO., LTD. All Rights Reserved.  
In case of consideration for using Automotive equipment / device which demand high reliability, kindly contact our sales window correspondents.

RoHS, ELV COMPLIANT

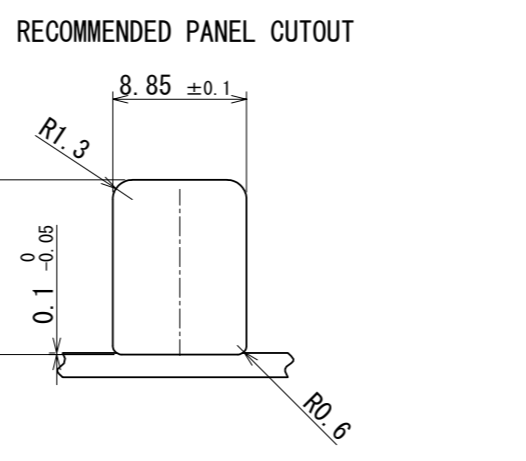
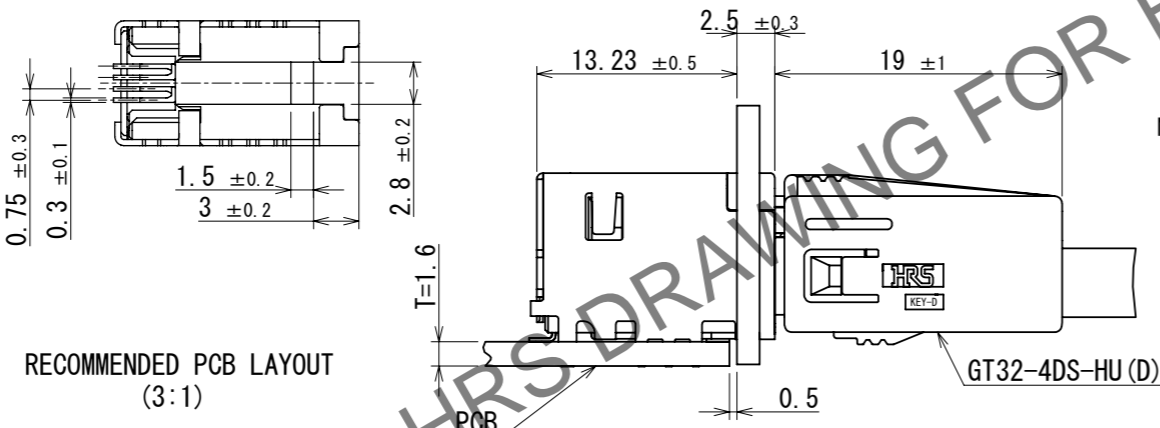
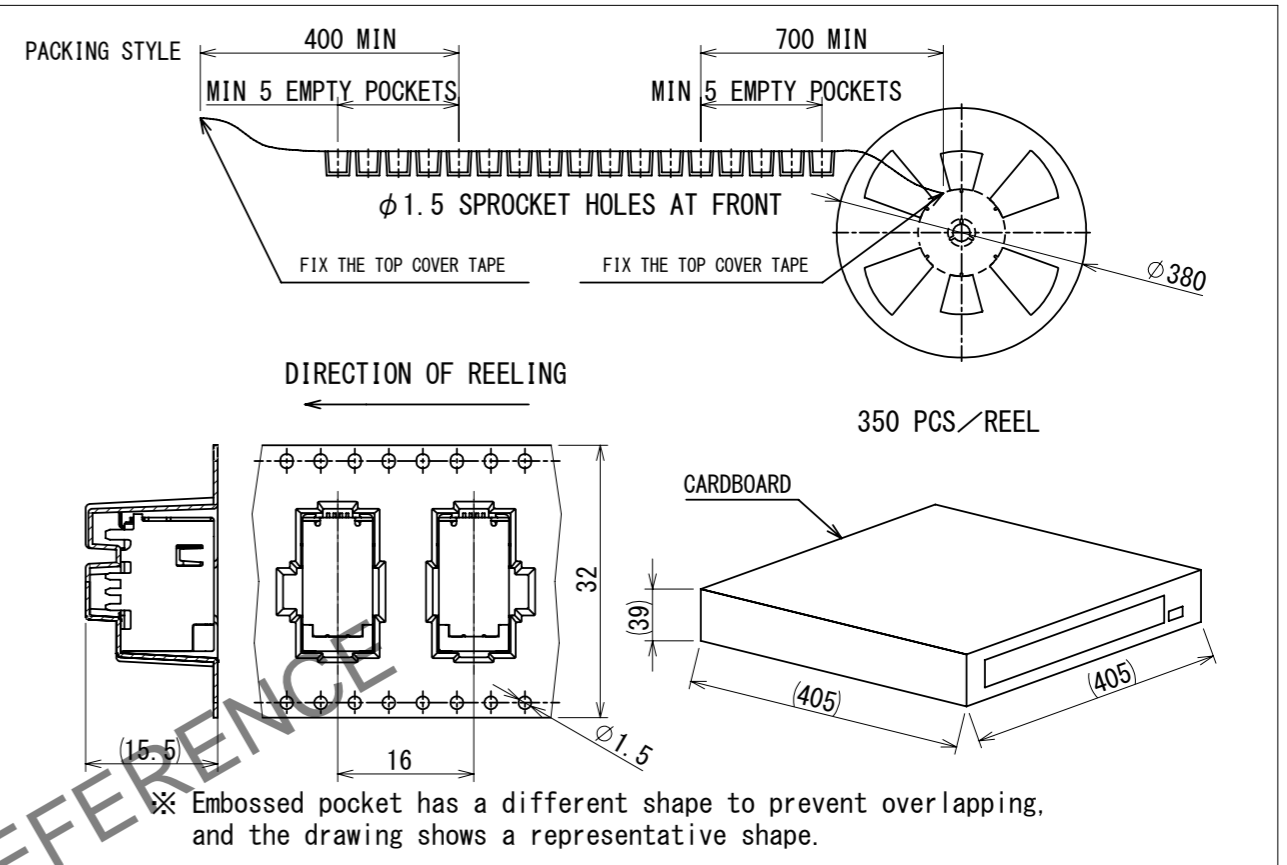
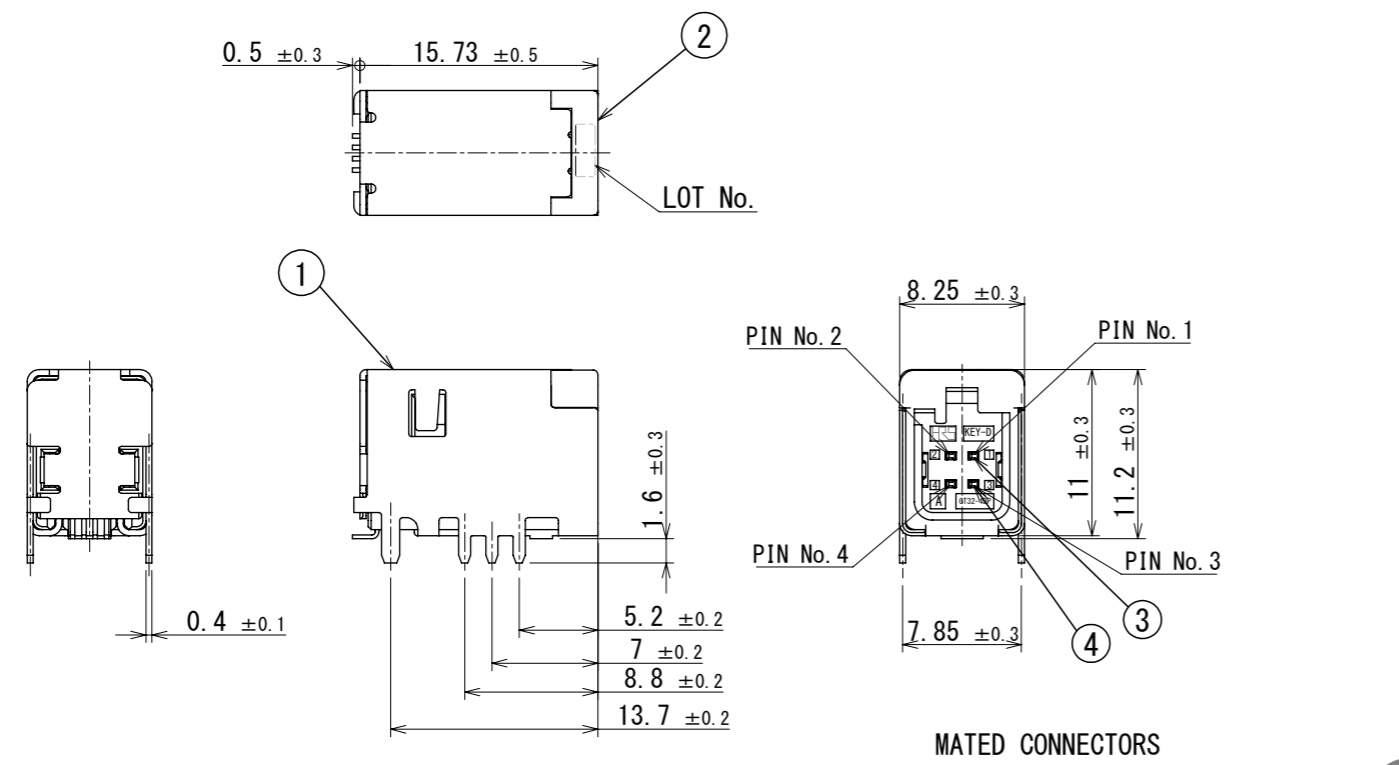

NOTES

- RECOMMENDED REFLOW PROFILE (SEE RIGHT GRAPH)  
CYCLE TIME: UP TO 2 CYCLES OF REFLOW SOLDERING ARE POSSIBLE UNDER THE CONDITIONS, PROVIDED THAT THERE IS A RETURN TO NORMAL TEMPERATURE BETWEEN THE FIRST AND SECOND CYCLE.  
PEAK TEMPERATURE: 250°C  
230°C MIN, FOR 20 TO 40 SECONDS.  
PREHEATING AREA 150~180°C FOR 60 TO 120 SECONDS.
- HAND SOLDERING: 280~300°C, 2SECONDS MAX.
- CONTACT COPLANARITY: 0.1mm MAX.
- RECOMMENDED THICKNESS OF PCB: 1.6mm
- RECOMMENDED THICKNESS OF SOLDERING PASTE: 0.12mm

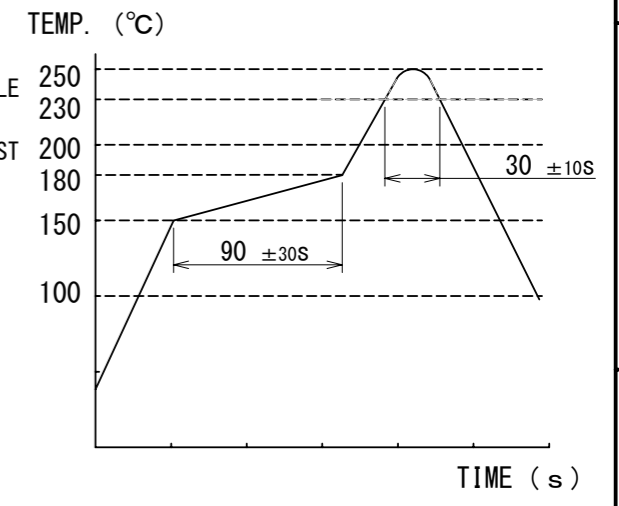

|                         |              |             |         |                |             |                          |          |               |      |            |  |
|-------------------------|--------------|-------------|---------|----------------|-------------|--------------------------|----------|---------------|------|------------|--|
| 2                       | PA           | BLACK       | 4       | BRASS          | TIN PLATING |                          |          |               |      |            |  |
| 1                       | COPPER ALLOY | TIN PLATING | 3       | BRASS          | TIN PLATING |                          |          |               |      |            |  |
| NO.                     | MATERIAL     | FINISH      | REMARKS | NO.            | MATERIAL    | FINISH                   | REMARKS  |               |      |            |  |
| UNITS                   | mm           | SCALE       | 2:1     | COUNT          | 0           | DESCRIPTION OF REVISIONS | DESIGNED | CHECKED       | DATE |            |  |
|                         |              |             |         | DIS-T-00018463 |             | KN. YANAGIMOTO           |          | EJ. WAKATSUKI |      | 2023.07.04 |  |
| APPROVED : AR. SHIRAI   |              | 2019.01.11  |         | DRAWING NO.    |             | EDC-361830-12-01         |          |               |      |            |  |
| CHECKED : TH. MIZUGUCHI |              | 2019.01.10  |         | PART NO.       |             | GT32-4DP-1.5H(D) (12)    |          |               |      |            |  |
| DESIGNED : TS. KUBOTA   |              | 2019.01.10  |         | CODE NO.       |             | CL0782-0064-1-12         |          |               |      |            |  |
| DRAWN : TS. KUBOTA      |              | 2019.01.10  |         |                |             |                          |          |               |      | 1/1        |  |