

May.1.2024 Copyright 2024 HIROSE ELECTRIC CO., LTD. All Rights Reserved.  
In case of consideration for using Automotive equipment / device which demand high reliability, kindly contact our sales window correspondents.

A  
B  
C  
D  
E  
F

1 2 3 4 5 6 7 8

Notes. 1. Recommended cable condition is shown below.  
⚠ A list of compatible cables is available on the Hirose website.  
When using a non-recommended cable, please contact a Hirose sales representative.  
Refer to the technical specification (ETAD-E3222) for wiring and assembly procedures.

Items	Recommended Condition
Conductor size	AWG # 28-22
Insulation O.D.	φ 1.55 mm MAX.
Braid Shield	Tin plating
Sheath O.D.	φ 6.3 -7.2 mm

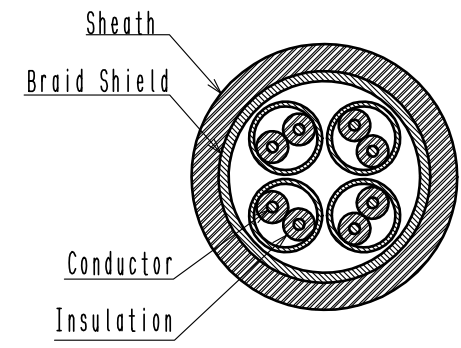

2. This product (Type B) is used for non Ethernet applications like signaling, serial or other industrial bus communication systems.  
Please use Type A for 10/100 Mbit/s and 1/10 Gbit/s Ethernet communication.

⚠ Mating Key

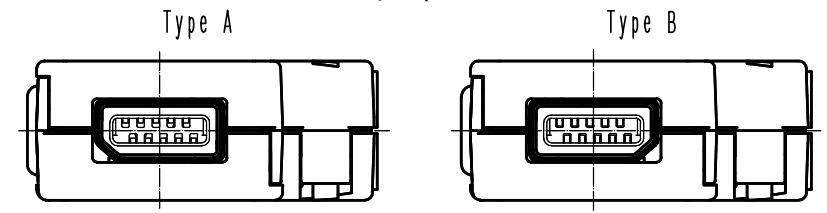

⚠ ③ Excluding the plug unit, this product is packaged separately by the type of parts.  
The shield shell is packaged prior to bending. (See next page.)  
Refer to the technical specification (ETAP-E3224) for packing.

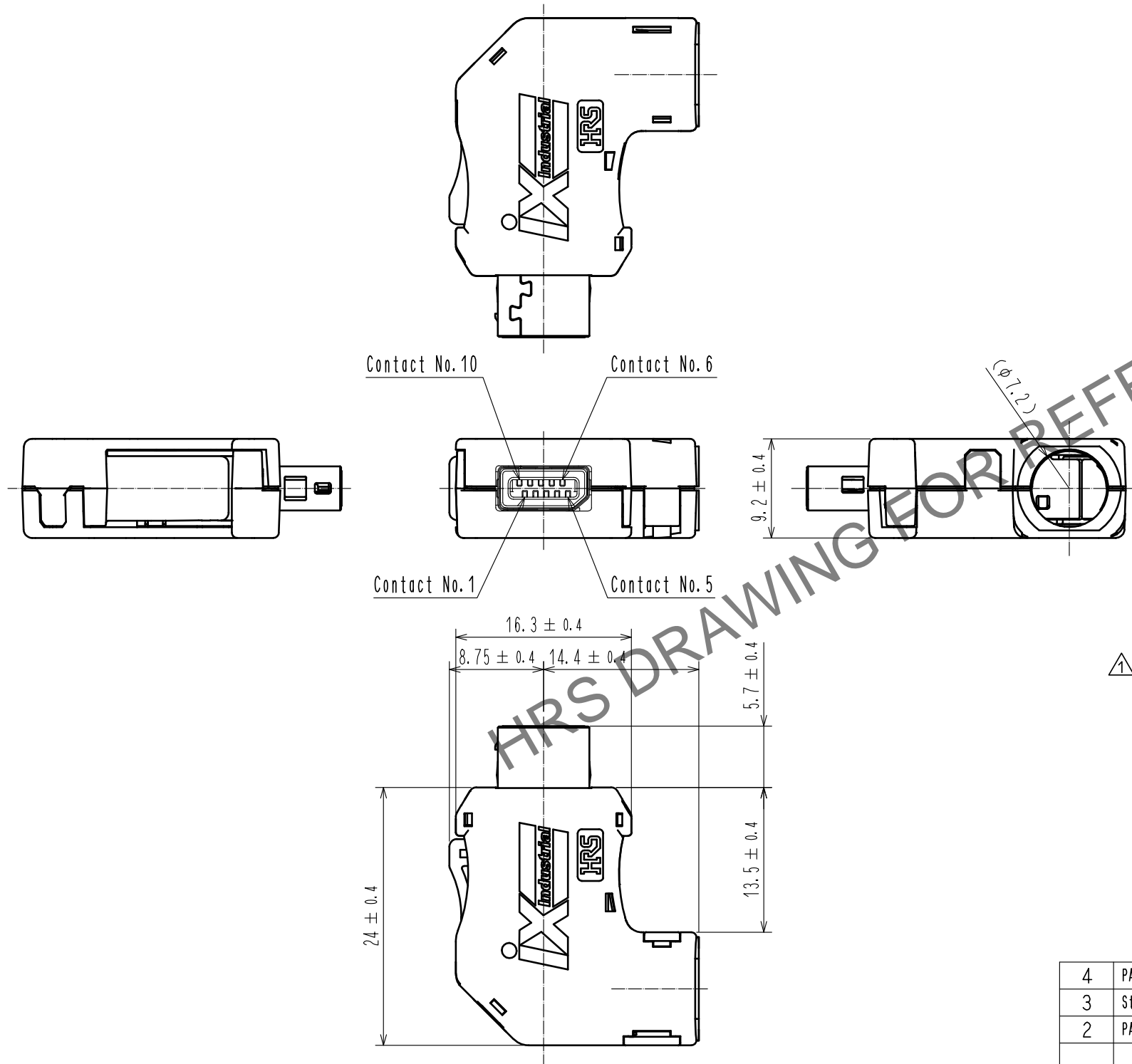

4	PA	Black, UL94V-0			
3	Stainless Steel		8	PC	Dark gray, UL94V-0
2	PA	Black, UL94V-0	7	PC	Dark gray, UL94V-0
1	Copper Alloy	Contact area : Gold 0.2 μm min Wiring area : Gold 0.03 μm min Under plating : Nickel 2 μm min	6	Stainless Steel	Nickel 0.2 μm min
			5	Stainless Steel	Nickel 1 μm min
NO.	MATERIAL	FINISH . REMARKS	NO.	MATERIAL	FINISH . REMARKS
UNITS mm		SCALE 2 : 1	COUNT ⚠ 6	DESCRIPTION OF REVISIONS DIS-E-00006884	DESIGNED MT. YASUDA
		APPROVED : MN. KENJO 20200601	DRAWING NO. EDC-129990-00-00		
HIROSE ELECTRIC CO., LTD.		CHECKED : KI. NAGANUMA 20200601	PART NO. IX40G-B-10S-CVL2(7.0)		
		DESIGNED : MT. YASUDA 20200601	CODE NO. CL0251-0078-0-00		
		DRAWN : MY. KOMUKAI 20200601	⚠ 1/2		

May.1.2024 Copyright 2024 HIROSE ELECTRIC CO., LTD. All Rights Reserved.  
In case of consideration for using Automotive equipment / device which demand high reliability, kindly contact our sales window correspondents.

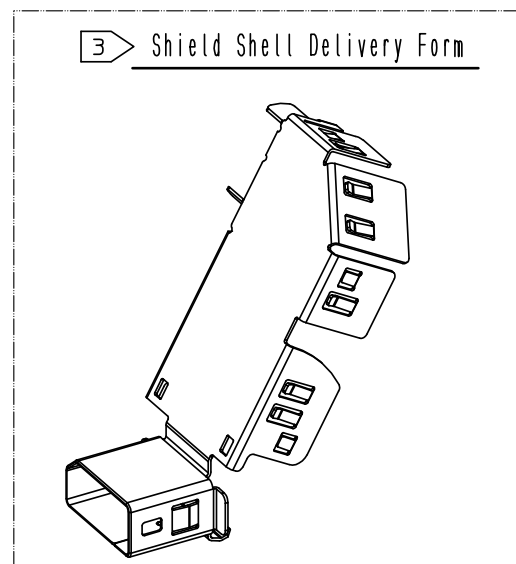

3 Product Structure

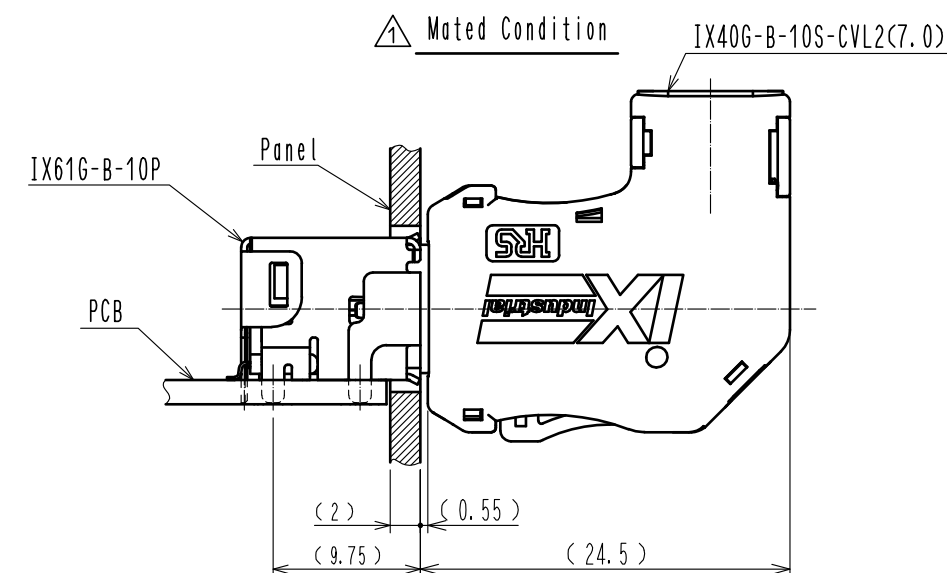
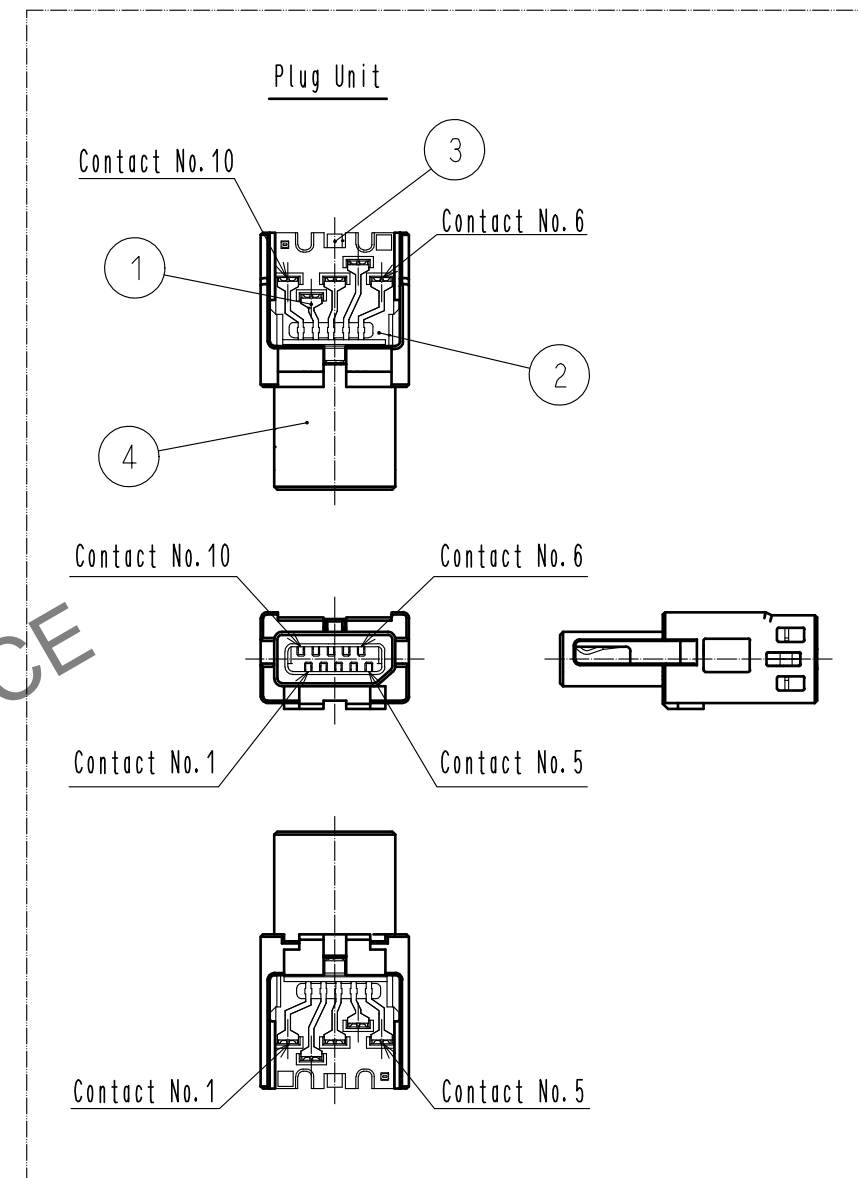
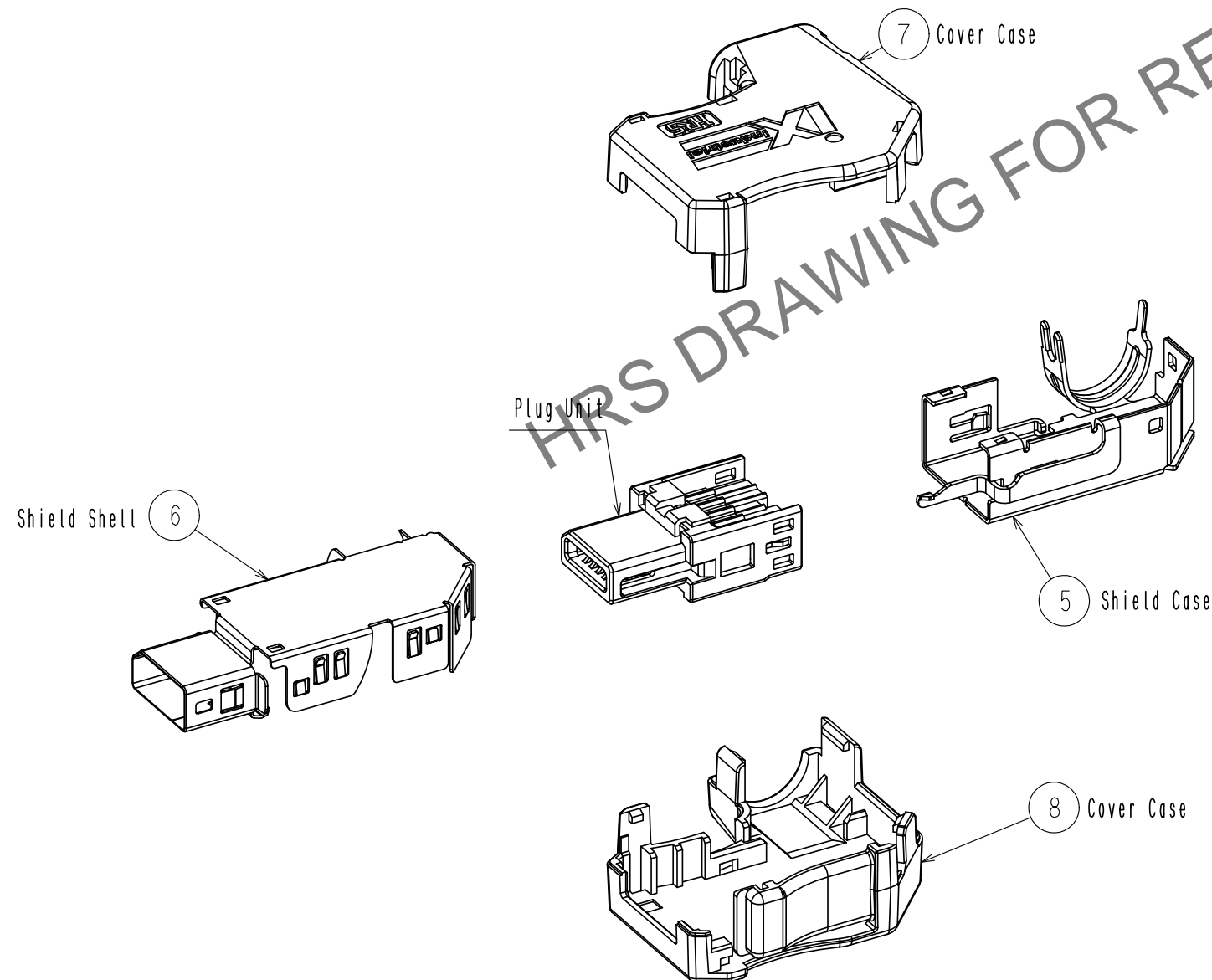

<b>HRS</b>	DRAWING NO.	EDC-129990-00-00
	PART NO.	IX40G-B-10S-CVL2<7.0>
	CODE NO.	CL0251-0078-0-00
		1/2