

REV.	DATE	DESCRIPTION OF REVISIONS	BY (CHKD)	DATE	COUNT	REVISIONS	BY (CHKD)	DATE	COUNT
A	1	[RE-2-0831]	LCE	15. 12. 10	1				1

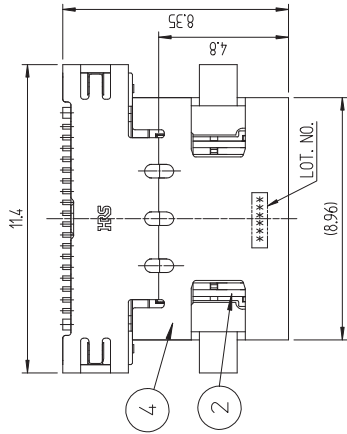

A-A

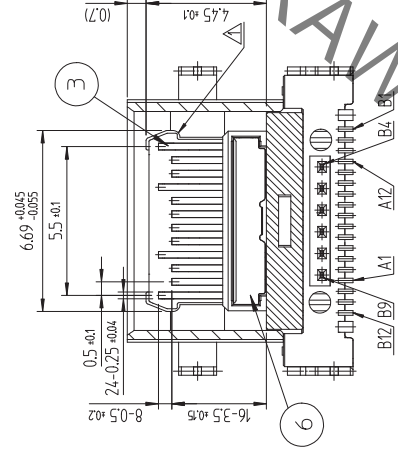

RECOMMENDED PCB LAY OUT
(General Tolerance : ±0.05)

HRS DRAWING FOR REFERENCE

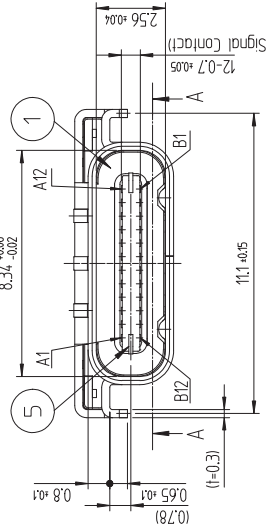

Detail C

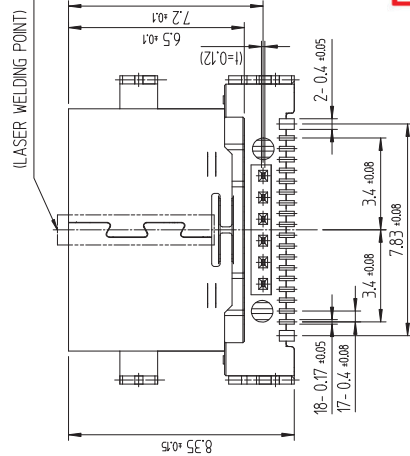

(LASER WELDING POINT)

PCB MOUNTING POSITION (FREE)

ISO-VIEW

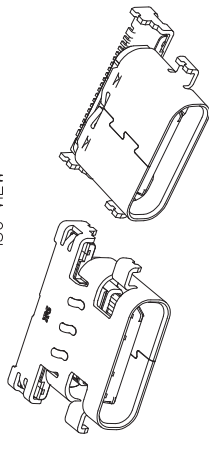

- NOTE 1. LEAD CO-PLANARITY SHALL BE 0.08MAX.
- 2. PER REEL : 1500 CONNECTORS.
- 3. GENERAL TOLERANCE : ±0.15

NO.	MATERIAL	FINISHREMARKS	NO.	MATERIAL	FINISHREMARKS
4	STAINLESS STEEL	Ni-5	8	PS	COVER TAPE
3	COPPER ALLOY	Contact : Ni-5+Pd-Ni0.75%Min+Au0.05%Min Lead : Ni-5+Au0.05%Min	7	PS	EMBOSS CARRIER TAPE
2	COPPER ALLOY	Contact : Ni-5+Pd-Ni0.75%Min+Au0.05%Min Lead : Ni-5+Au0.05%Min	6	STAINLESS STEEL	Ni-5
1	LCP	UL94V-0,COLOR BLACK	5	STAINLESS STEEL	Other Ni-5 / LEAD Ni-5+Au 0.03%Min

REMARK	DRAWN	CHECKED	APPROVED	RELEASED
	CELIM 15.09.04	H.J.LEE 15.09.04	T.S.KANG 15.09.04	ENG 15.12.11 DEPT

DRAWING NO.	EDC3-611479	PART NO.	CX70M-24P1
SCALE	5:1	CODE NO	CL 6240-0002-1
UNITS	mm		

DRAWING FOR REFERENCE
This is subject to change without notice

Sep. 1. 2022 Copyright 2022 HIROSE ELECTRIC CO., LTD. All Rights Reserved.

In case of consideration for using Automotive equipment / device which demand high reliability, kindly contact our sales window correspondents. 自動車用部品 高信頼性を要する装置に採用される場合は、必ず当社の営業窓口へお問い合わせください。

REV. NO.	DESCRIPTION OF REVISIONS	DATE	COUNT	DESIGNER	CHECKER	DATE	DATE
△							
△							
△							
△							

REV. NO.	DESCRIPTION OF REVISIONS	DATE	COUNT	DESIGNER	CHECKER	DATE	DATE
△							
△							
△							
△							

A

1

2

3

4

5

6

7

8

9

10

11

12

13

14

15

16

17

18

19

20

21

22

23

24

25

26

27

28

29

30

31

32

33

34

35

36

37

38

39

40

41

42

43

44

45

46

47

48

49

50

51

52

53

54

55

56

57

58

59

60

61

62

63

64

65

66

67

68

69

70

71

72

73

74

75

76

77

78

79

80

81

82

83

84

85

86

87

88

89

90

91

92

93

94

95

96

97

98

99

100

101

102

103

104

105

106

107

108

109

110

111

112

113

114

115

116

117

118

119

120

121

122

123

124

125

126

127

128

129

130

131

132

133

134

135

136

137

138

139

140

141

142

143

144

145

146

147

148

149

150

151

152

153

154

155

156

157

158

159

160

161

162

163

164

165

166

167

168

169

170

171

172

173

174

175

176

177

178

179

180

181

182

183

184

185

186

187

188

189

190

191

192

193

194

195

196

197

198

199

200

201

202

203

204

205

206

207

208

209

210

211

212

213

214

215

216

217

218

219

220

221

222

223

224

225

226

227

228

229

230

231

232

233

234

235

236

237

238

239

240

241

242

243

244

245

246

247

248

249

250

251

252

253

254

255

256

257

258

259

260

261

262

263

264

265

266

267

268

269

270

271

272

273

274

275

276

277