

May.1.2024 Copyright 2024 HIROSE ELECTRIC CO., LTD. All Rights Reserved.  
In case of consideration for using Automotive equipment / device which demand high reliability, kindly contact our sales window correspondents.

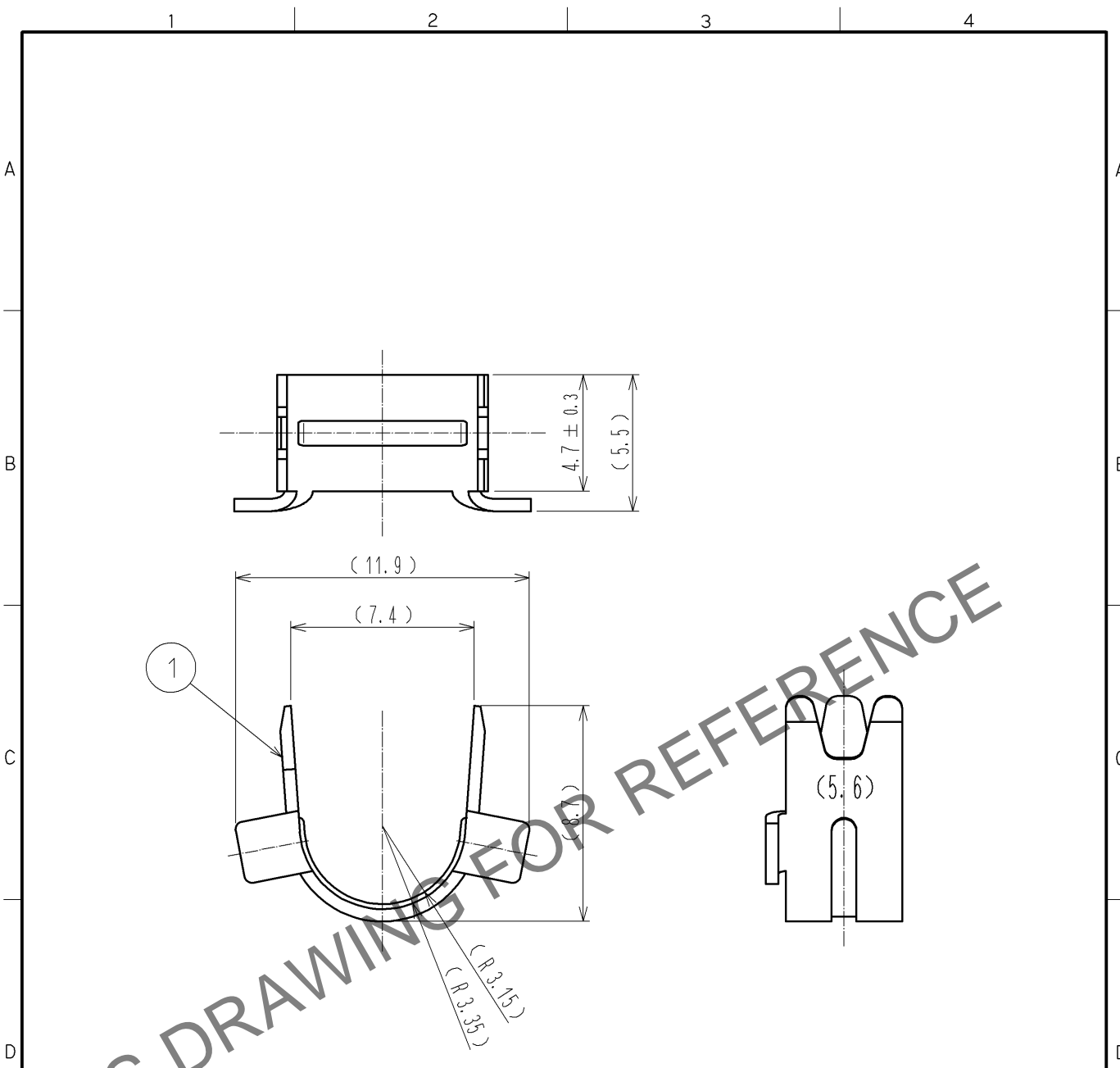

- NOTE 1. THIS PRODUCT IS A CLAMP FOR A COVER CASE 'DH-17-C\*\*B'.  
2. THE APPLICABLE CABLE DIAMETER IS  $\phi 5.6$ .  
3. THIS PRODUCT IS PACKED IN A BAG.  
(QUANTITY PER BAG MAY VARY DUE TO THE AMOUNT OF EACH ORDER.)

NO.		MATERIAL		FINISH . REMARKS		1		BRASS		FINISH . REMARKS					
UNITS mm				SCALE 4 : 1		COUNT 		DESCRIPTION OF REVISIONS		DESIGNED		CHECKED		DATE	
HIROSE ELECTRIC CO., LTD.		APPROVED :RI. TAKAYASU		11. 09. 13		DRAWING NO.		EDC4-127675-00							
		CHECKED :YH. ENAMI		11. 09. 13		PART NO.		DH-17-CMB<5. 6>							
		DESIGNED :YH. MAMADA		11. 09. 09		CODE NO.		CL244-0064-4-00							
		DRAWN :YH. MAMADA		11. 09. 09											