

Jun.1.2024 Copyright 2024 HIROSE ELECTRIC CO., LTD. All Rights Reserved.
In case of consideration for using Automotive equipment / device which demand high reliability, kindly contact our sales window correspondents.

A
B
C
D
E
F

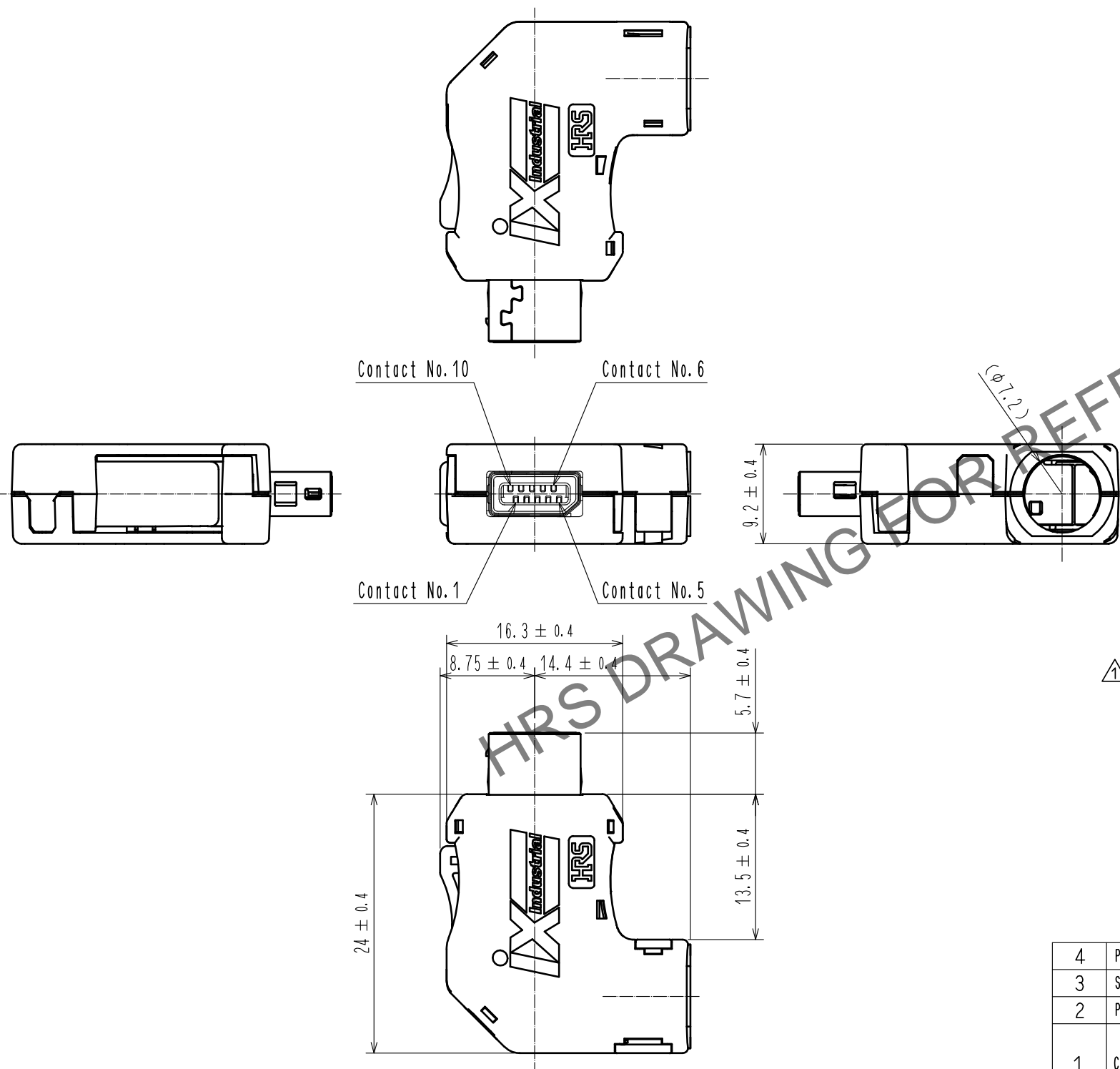

Notes. 1. Recommended cable condition is shown below.
⚠ A list of compatible cables is available on the Hirose website.
When using a non-recommended cable, please contact a Hirose sales representative.
Refer to the technical specification (ETAD-E3213) for wiring and assembly procedures.

⚠ Recommended Cable

| Items | | ⚠ Recommended Condition |
|-----------------|-------------|-------------------------|
| Conductor | Size | AWG#22 |
| | Composition | 7 stranded |
| | Material | Annealed copper wire |
| Insulation O.D. | | φ1.4 to 1.6mm |
| Braid Shield | | Tin plating |
| Sheath O.D. | | φ6.3 to 7.2mm |

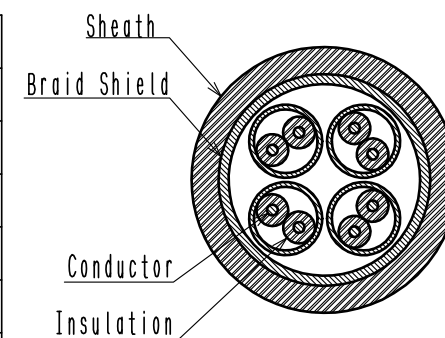

2. This product (Type B) is used for non Ethernet applications like signaling, serial or other industrial bus communication systems.
Please use Type A for 10/100 Mbit/s and 1/10 Gbit/s Ethernet communication.

⚠ Mating Key

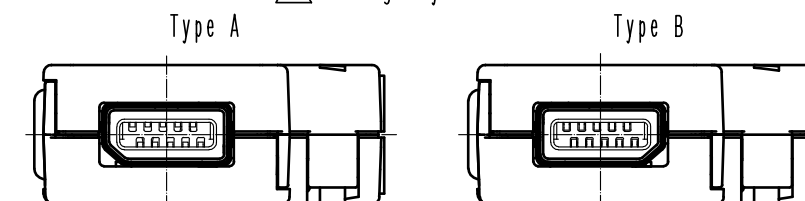

⚠ ③ Excluding the plug unit, this product is packaged separately by the type of parts.
The shield shell is packaged prior to bending. (See next page.)
Refer to the technical specification (ETAP-E3224) for packing.

| | | | | | |
|---------------------------|-----------------|---|--------------|--|---------------------|
| 4 | PA | Black, UL94V-0 | 9 | PC | Dark gray, UL94V-0 |
| 3 | Stainless Steel | | 8 | PC | Dark gray, UL94V-0 |
| 2 | PA | Dark gray, UL94V-0 | 7 | Stainless Steel | Nickel 0.2 μm min |
| 1 | Copper Alloy | Contact area : Palladium-Nickel 0.75 μm min + Gold 0.05 μm min | 6 | Stainless Steel | Nickel 1 μm min |
| | | Wiring area : Gold 0.03 μm min | 5 | PC | Clear blue, UL94V-0 |
| | | Under plating : Nickel 2 μm min | | | |
| NO. | MATERIAL | FINISH . REMARKS | NO. | MATERIAL | FINISH . REMARKS |
| UNITS mm | | SCALE 2 : 1 | COUNT ⚠ 6 | DESCRIPTION OF REVISIONS DIS-E-00006883 | |
| HIROSE ELECTRIC CO., LTD. | | APPROVED : MN. KENJO | 20200519 | DRAWING NO. EDC-129986-01-00 | |
| | | CHECKED : KI. NAGANUMA | 20200519 | PART NO. IX32G-B-8S-CVL2(7.0)(01) | |
| | | DESIGNED : MT. YASUDA | 20200519 | CODE NO. CL0251-0074-0-01 | |
| | | DRAWN : MY. KOMUKAI | 20200519 | | |
| | | | | MT. YASUDA | KI. KAGOTANI |
| | | | | DATE 20211025 | |

Jun.1.2024 Copyright 2024 HIROSE ELECTRIC CO., LTD. All Rights Reserved.
In case of consideration for using Automotive equipment / device which demand high reliability, kindly contact our sales window correspondents.

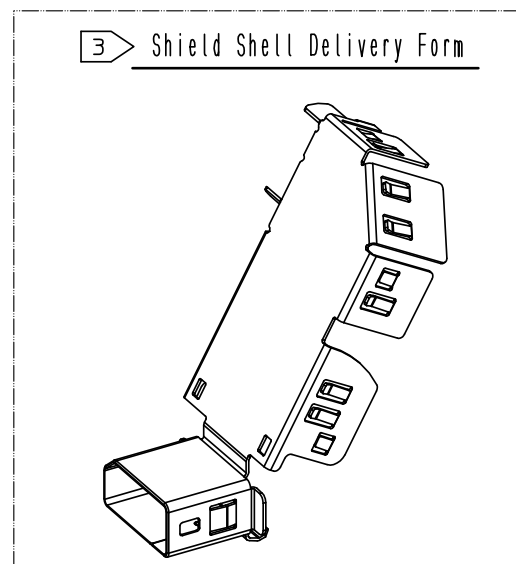

3 Product Structure

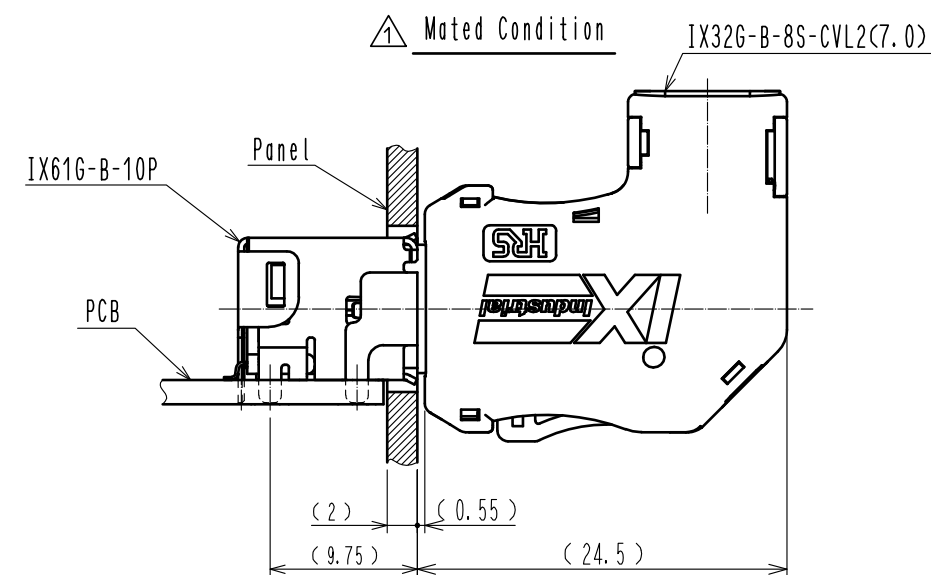
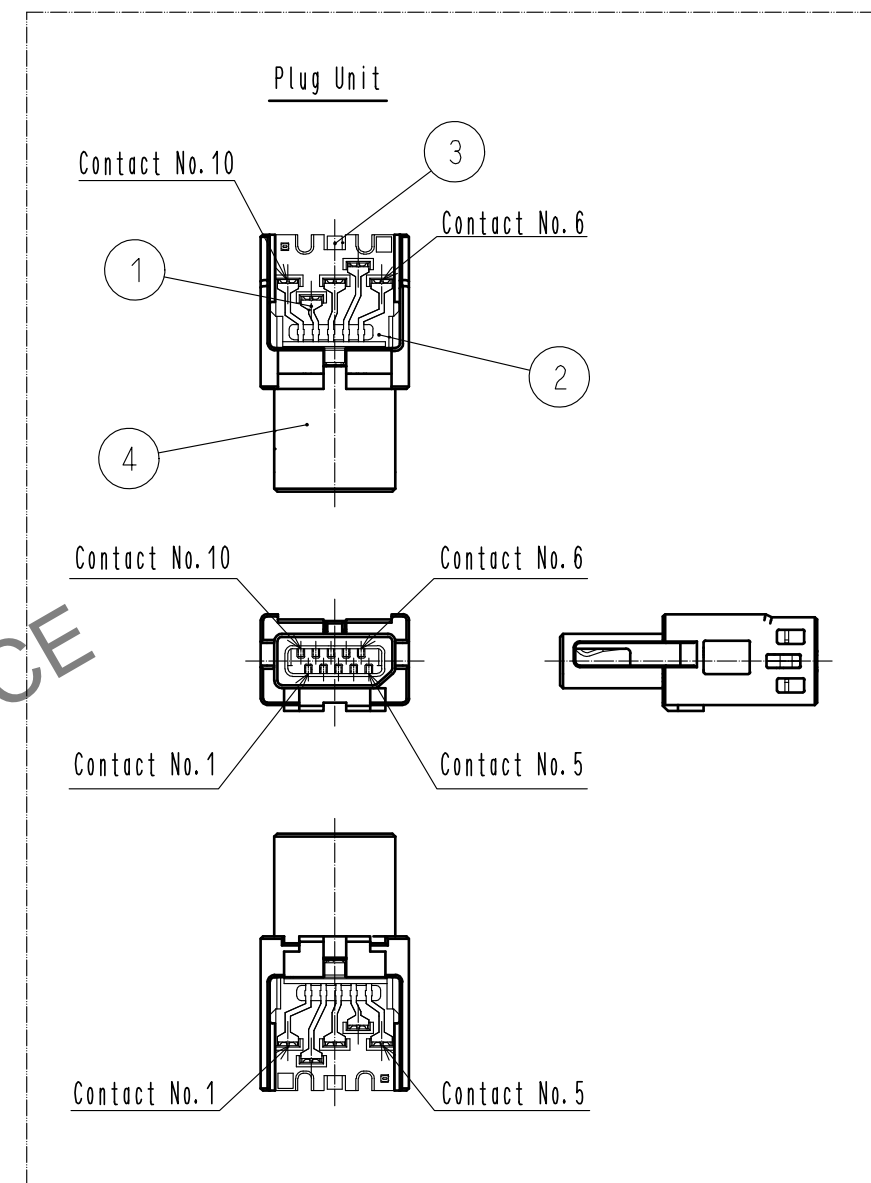
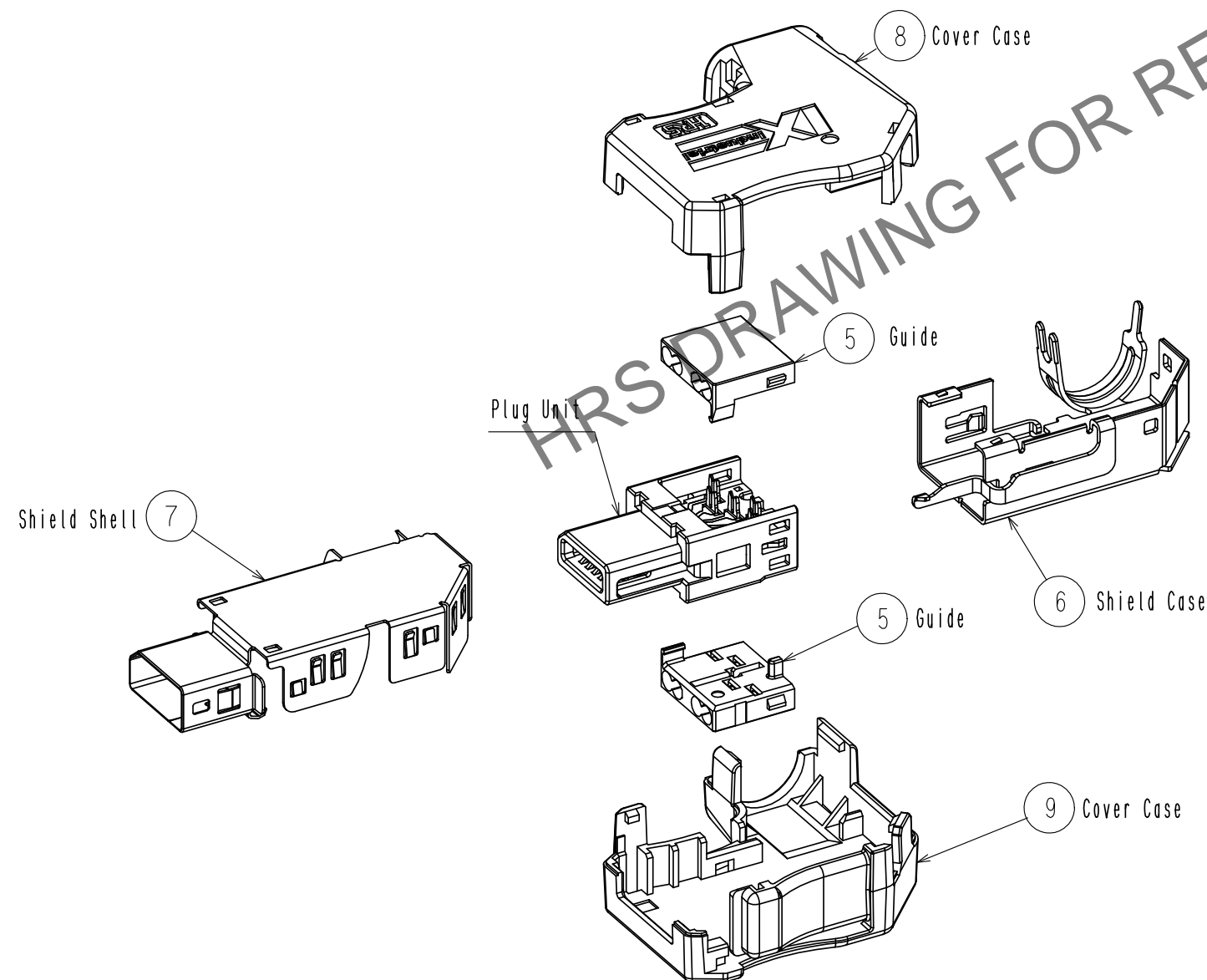

| | | |
|-----|-------------|--------------------------|
| HRS | DRAWING NO. | EDC-129986-01-00 |
| | PART NO. | IX32G-B-8S-CVL2(7.0)(01) |
| | CODE NO. | CL0251-0074-0-01 |
| | | 1/2 |