

Aug.1.2021 Copyright 2021 HIROSE ELECTRIC CO., LTD. All Rights Reserved.
In case of consideration for using Automotive equipment / device which demand high reliability, kindly contact our sales window correspondents.

1 2 3 4

A
B

A
B

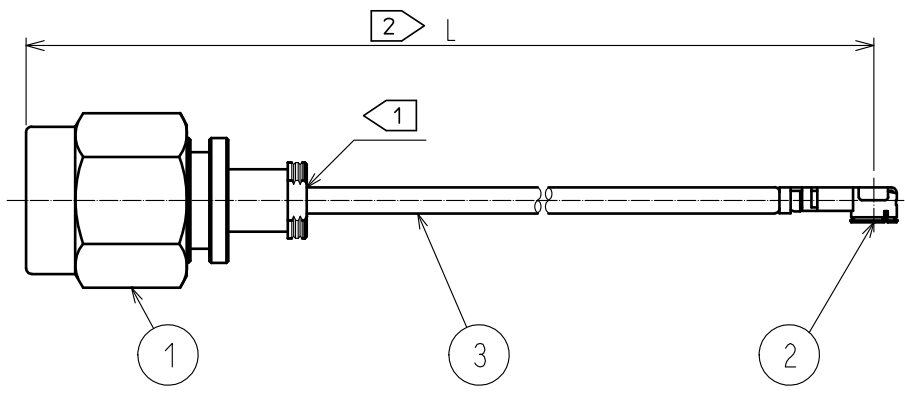

- NOTE
- ① Do not apply any excessive stress to the cable assembly position.
 - ② We indicate the length of the harness on the last of product name. 'L' part.

Part No.	Cable color
~088N1T~	GRAY
~088N2T~	BLACK
~088N3T~	WHITE

Tolerance for [L]

Length L [mm]	Tolerance [mm]
$\triangle 50 \leqq L \leqq 200$	± 4
$200 < L \leqq 500$	± 8
$500 < L \leqq 1000$	± 12
$1000 < L$	$\pm 1.5\%$

3. Specifications are subject to change without notice.

【 PRECAUTIONS FOR HANDLING 】

- ◆ Connector insertion and extraction
 - a. Connector shall be extracted vertically by specialised extraction JIG.
Part No.: U.FL-LP-N-2 (CL Code: CL331-0494-5)
Never hold the cable when extracting the cable because it damages the connector.
 - b. Insert the connector as perpendicularly to the mating surface as possible by aligning the mating axes of both connectors. Do not excessively slant the connectors when inserting.
- ◆ Allowable loads on the cable after the connectors are mated.
The figures below shot the maximum allowable loads on the cable. Do not apply loads exceeding these values to the cable.

【 DIMENSIONS OF CONNECTOR 】

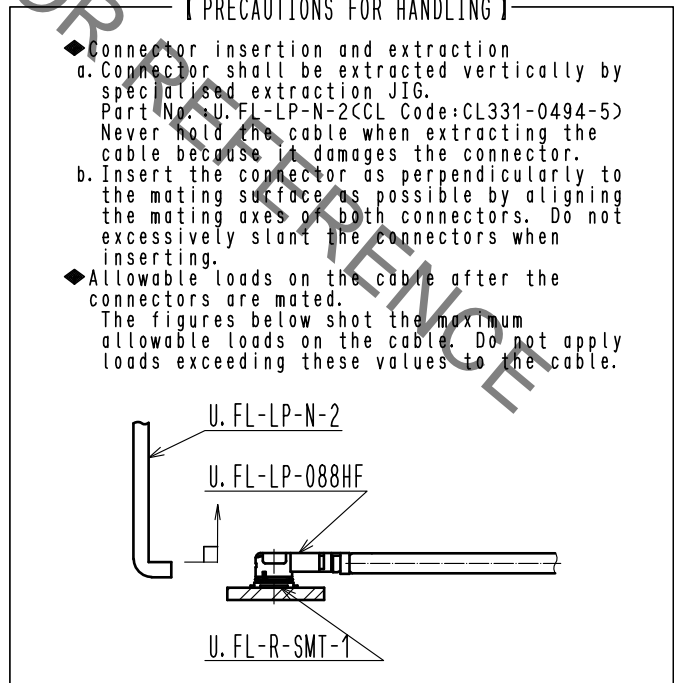
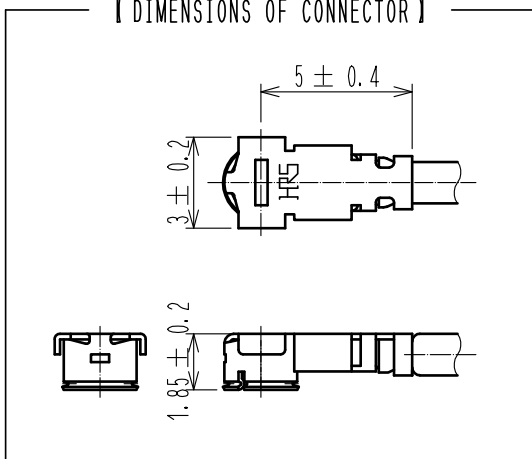

D
E

D
E

2	U.FL-LP-088HF(06)	CL331-0560-8-06					
1	HRM-200-088PBN(40)	CL323-0800-5-40	3	RF-MF50141	NISSEI ELECTRIC CO., LTD.		
N o.	PART NO.	CODE NO.	N o.	PART NO.	MANUFACTURER		
UNITS mm		SCALE FREE	COUNT \triangle 1	DESCRIPTION OF REVISIONS DIS-D-00003732	DESIGNED NK. OOSAWA	CHECKED TO. KATAYAMA	DATE 20181206
HIROSE ELECTRIC CO., LTD.		APPROVED : TO. KATAYAMA	20180627	DRAWING NO.			
		CHECKED : TO. KATAYAMA	20180627	PART NO.			
		DESIGNED : YI. FUNADA	20180627	CODE NO.			
		DRAWN : YI. FUNADA	20180627	HRMP-UFLHF6-088N*T-ALRS 1/1			

F

F