

Feb.1.2025 Copyright 2025 HIROSE ELECTRIC CO., LTD. All Rights Reserved.  
In case of consideration for using Automotive equipment / device which demand high reliability, kindly contact our sales window correspondents.

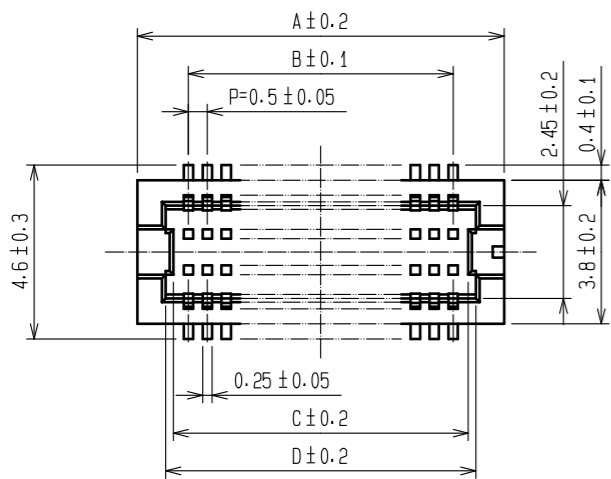

F-F (10:1)

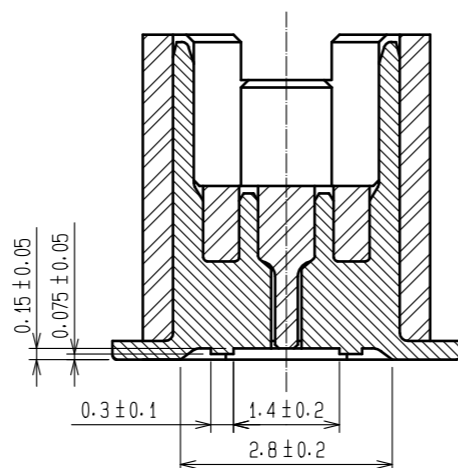

| CODE No.        | CONTACT | A    | B    | C    | D    | E    |
|-----------------|---------|------|------|------|------|------|
| CL537-0883-0-51 | 20      | 7.2  | 4.5  | 5.3  | 5.7  | 5.3  |
| CL537-0884-0-51 | 30      | 9.7  | 7.0  | 7.8  | 8.2  | 7.8  |
| CL537-0885-0-51 | 36      | 11.2 | 8.5  | 9.3  | 9.7  | 9.3  |
| CL537-0886-0-51 | 40      | 12.2 | 9.5  | 10.3 | 10.7 | 10.3 |
| CL537-0887-0-51 | 50      | 14.7 | 12.0 | 12.8 | 13.2 | 12.8 |
| CL537-0888-0-51 | 60      | 17.2 | 14.5 | 15.3 | 15.7 | 15.3 |

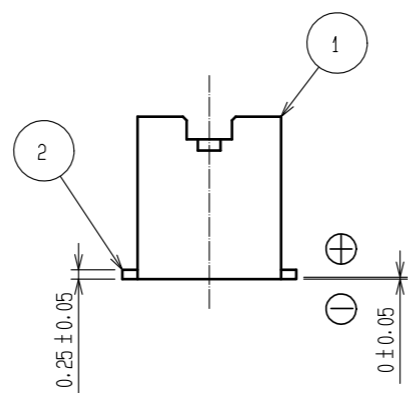
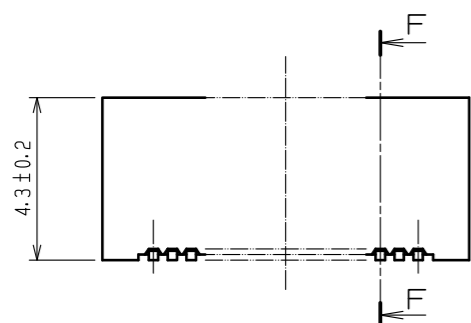

RECOMMEND METAL MASK PATTERN (10:1)

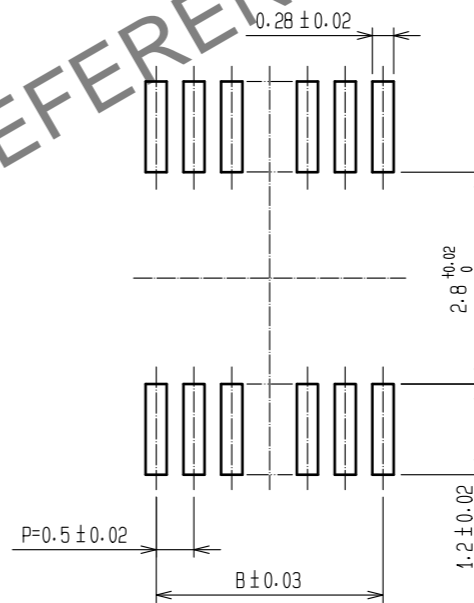

RECOMMENDED LAND PATTERN (10:1)

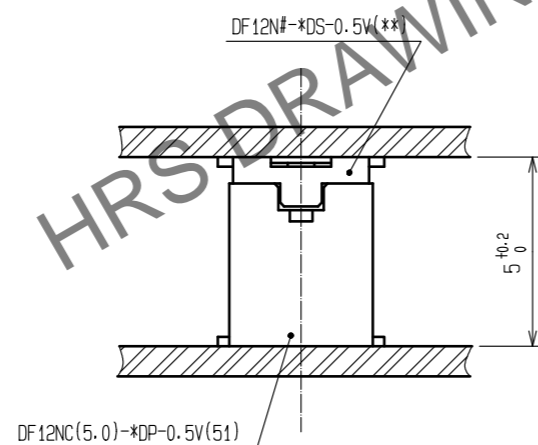
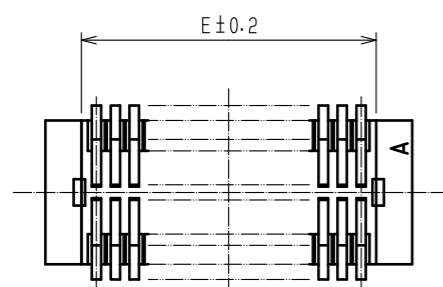
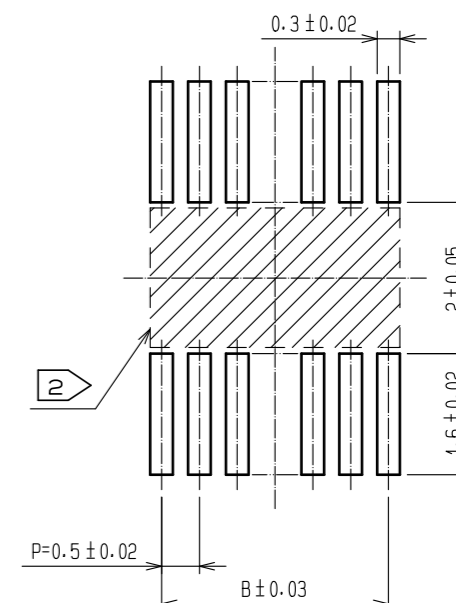

METAL MASK THICKNESS : 120 μm

NOTES 1 LEAD CO-PLANARITY SHALL BE 0.08 mm MAX.  
2 IF THERE IS PATTERN ON PART, THERE IS A POSSIBILITY THAT IT WILL MAKE CONTACT WITH THE LEADS.

| NO. | MATERIAL        | FINISH . REMARKS   | NO. | MATERIAL  | FINISH . REMARKS              |
|-----|-----------------|--|-----|-----------|-------------------------------|
| 2   | PHOSPHOR BRONZE | CONTACT AREA:GOLD PLATED 0.2μm min<br>LEAD AREA:GOLD PLATED 0.015μm min<br>OTHERS(UNDER PLATING):NICKEL PLATED 2μm min | 6   | PS        | CLEAR (REINFORCEMENT COLLAR)  |
|     |                 |  | 5   | PS        | BLACK (PLASTIC REEL)          |
|     |                 |  | 4   | POLYESTER | CLEAR (COVER TAPE)            |
| 1   | POLYAMIDE       | UL94V-0.BLACK  | 3   | PS        | CLEAR (EMBOSSED CARRIER TAPE) |

  

| UNITS | SCALE | COUNT | DESCRIPTION OF REVISIONS | DESIGNED | CHECKED | DATE |
|-------|-------|-------|--------------------------|----------|---------|------|
| mm    | 5 : 1 | 0     |                          |          |         |      |

  

|                        |          |             |                          |
|------------------------|----------|-------------|--------------------------|
| APPROVED : WR. FUKUCHI | 20200702 | DRAWING NO. | EDC-390692-51-77         |
| CHECED : TS. MIYAZAKI  | 20200702 | PART NO.    | DF12NC(5.0)-*DP-0.5V(51) |
| DESIGNED : RN. IIDA    | 20200702 | CODE NO.    | CL537                    |
| DRAWN : RN. IIDA       | 20200702 |             |                          |

Feb.1.2025 Copyright 2025 HIROSE ELECTRIC CO., LTD. All Rights Reserved.  
 In case of consideration for using Automotive equipment / device which demand high reliability, kindly contact our sales window correspondents.

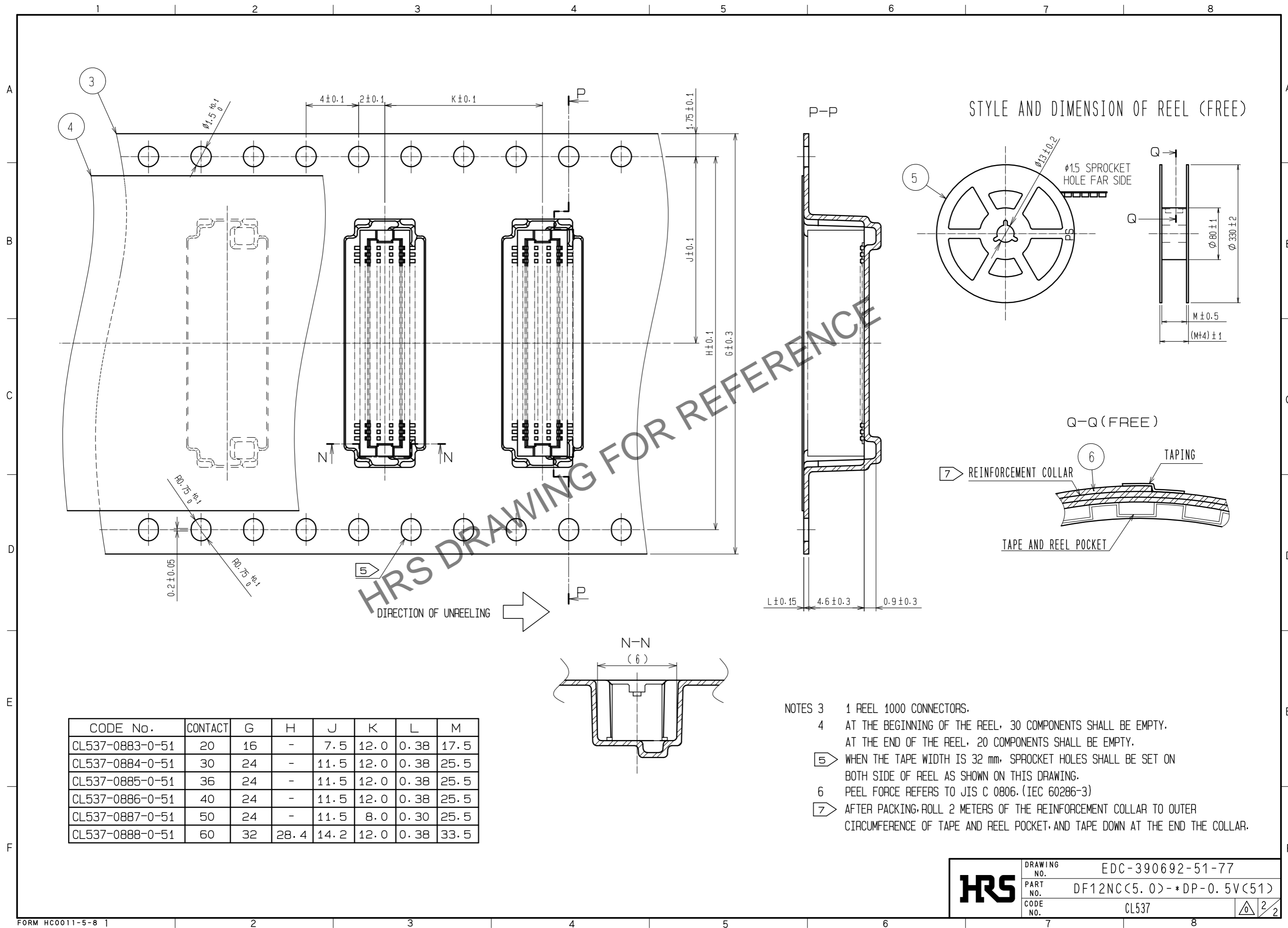

STYLE AND DIMENSION OF REEL (FREE)

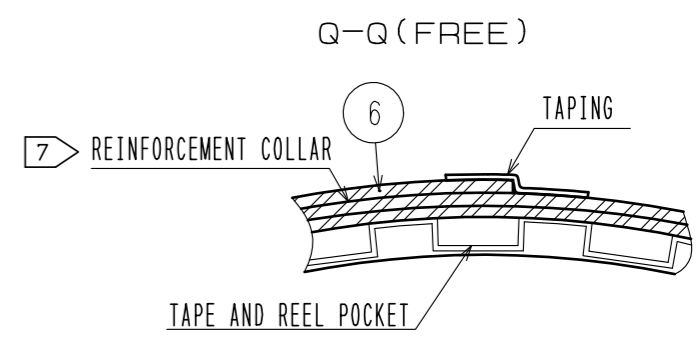
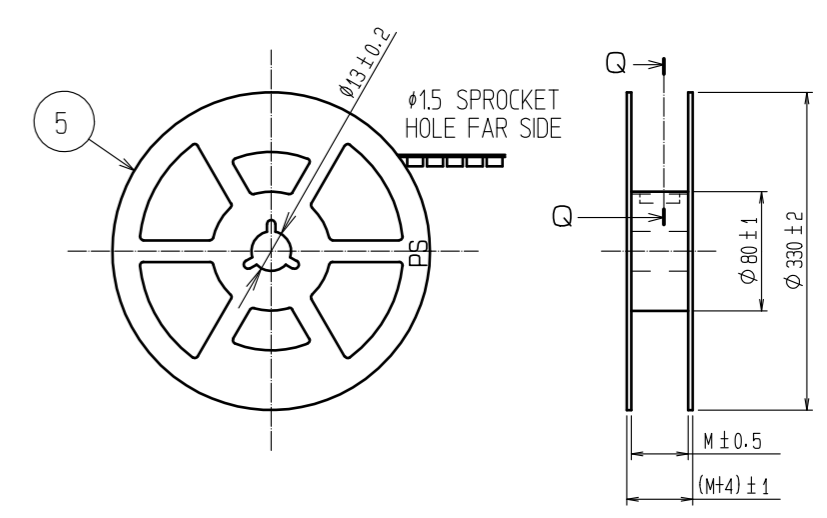

HRS DRAWING FOR REFERENCE

| CODE No.        | CONTACT | G  | H    | J    | K    | L    | M    |
|-----------------|---------|----|------|------|------|------|------|
| CL537-0883-0-51 | 20      | 16 | -    | 7.5  | 12.0 | 0.38 | 17.5 |
| CL537-0884-0-51 | 30      | 24 | -    | 11.5 | 12.0 | 0.38 | 25.5 |
| CL537-0885-0-51 | 36      | 24 | -    | 11.5 | 12.0 | 0.38 | 25.5 |
| CL537-0886-0-51 | 40      | 24 | -    | 11.5 | 12.0 | 0.38 | 25.5 |
| CL537-0887-0-51 | 50      | 24 | -    | 11.5 | 8.0  | 0.30 | 25.5 |
| CL537-0888-0-51 | 60      | 32 | 28.4 | 14.2 | 12.0 | 0.38 | 33.5 |

- NOTES 3 1 REEL 1000 CONNECTORS.  
 4 AT THE BEGINNING OF THE REEL, 30 COMPONENTS SHALL BE EMPTY.  
 AT THE END OF THE REEL, 20 COMPONENTS SHALL BE EMPTY.  
 5 WHEN THE TAPE WIDTH IS 32 mm, SPROCKET HOLES SHALL BE SET ON BOTH SIDE OF REEL AS SHOWN ON THIS DRAWING.  
 6 PEEL FORCE REFERS TO JIS C 0806. (IEC 60286-3)  
 7 AFTER PACKING, ROLL 2 METERS OF THE REINFORCEMENT COLLAR TO OUTER CIRCUMFERENCE OF TAPE AND REEL POCKET, AND TAPE DOWN AT THE END THE COLLAR.

|            |             |                          |
|------------|-------------|--------------------------|
| <b>HRS</b> | DRAWING NO. | EDC-390692-51-77         |
|            | PART NO.    | DF12NC(5.0)-*DP-0.5V(51) |
|            | CODE NO.    | CL537                    |