

Sep.1.2024 Copyright 2024 HIROSE ELECTRIC CO., LTD. All Rights Reserved.
 In case of consideration for using Automotive equipment / device which demand high reliability, kindly contact our sales window correspondents.

ELV, RoHS COMPLIANT

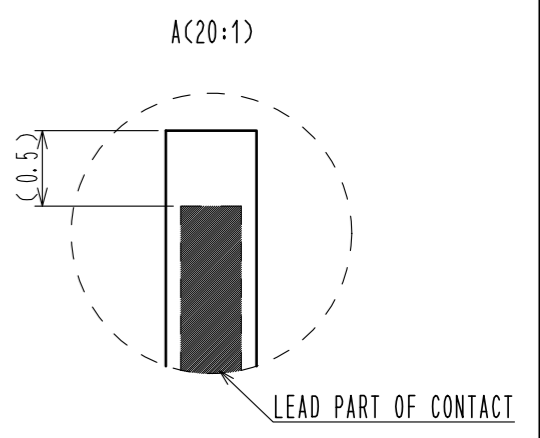

- NOTE 1. RECOMMENDED TEMPERATURE PROFILE FOR REFLOW (REFER TO RIGHT FIG.)
 USED REFLOW SYSTEM : IR IN THE AIR OR NITROGEN
 NO. OF CYCLES : 2 MAX
 PEAK : 250°C
 OVER 230°C : 20~40s
 PREHEAT : 150~180°C
 90~120s
 2. TEMPERATURE FOR SOLDERING IRON : 280~300°C WITHIN 2s
 3. CO-PLANARITY SHALL BE 0.1mm MAX.
 4. RECOMMENDED PCB THICKNESS IS 1.6mm.
 5. RECOMMENDED SOLDER THICKNESS IS 0.15mm.
 6. [Pattern symbol] : Pattern prohibited area

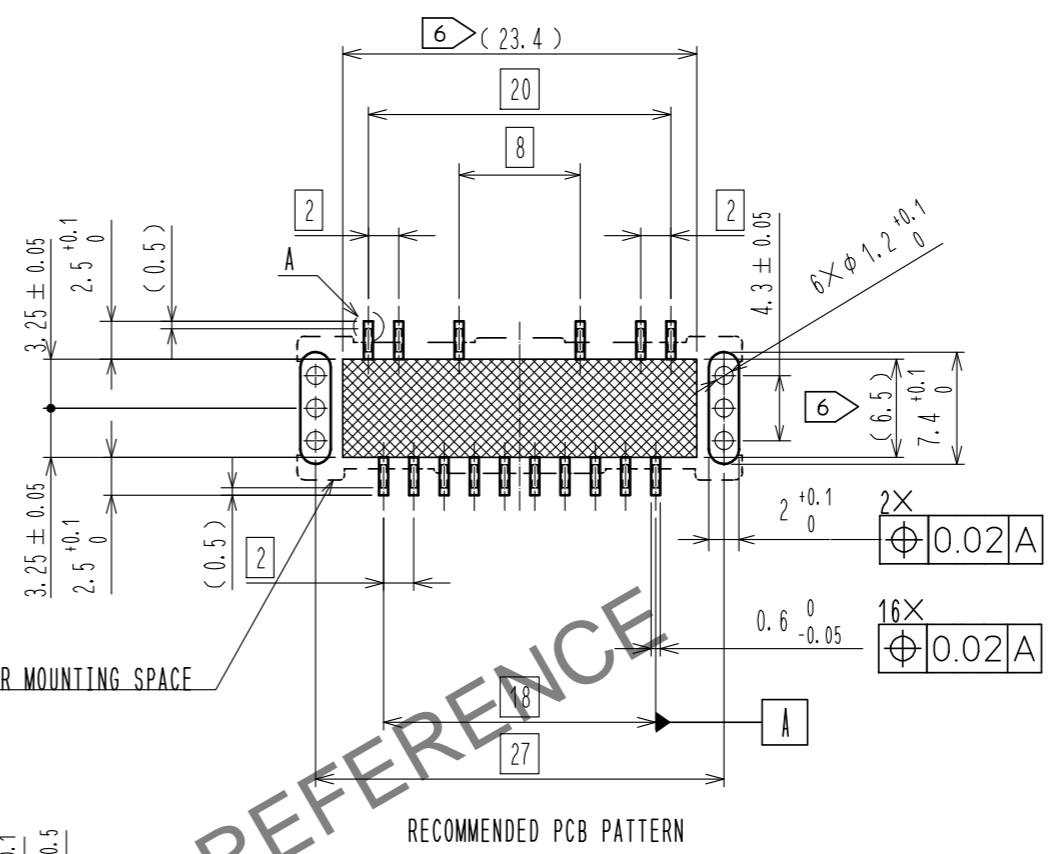
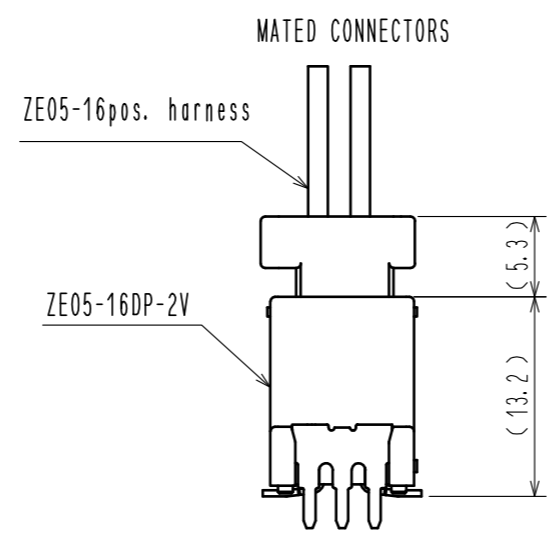
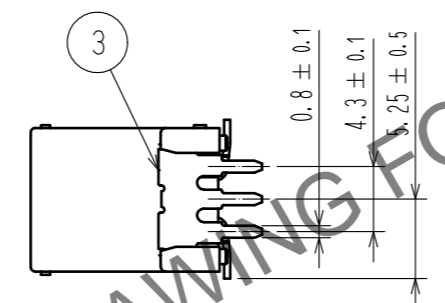
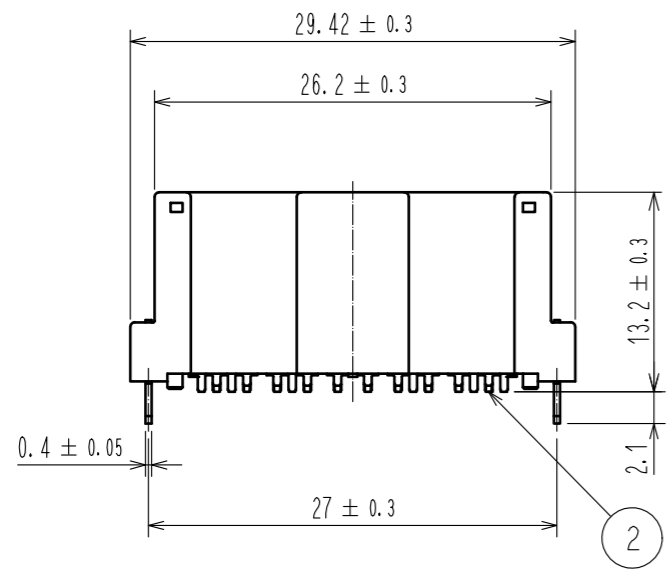
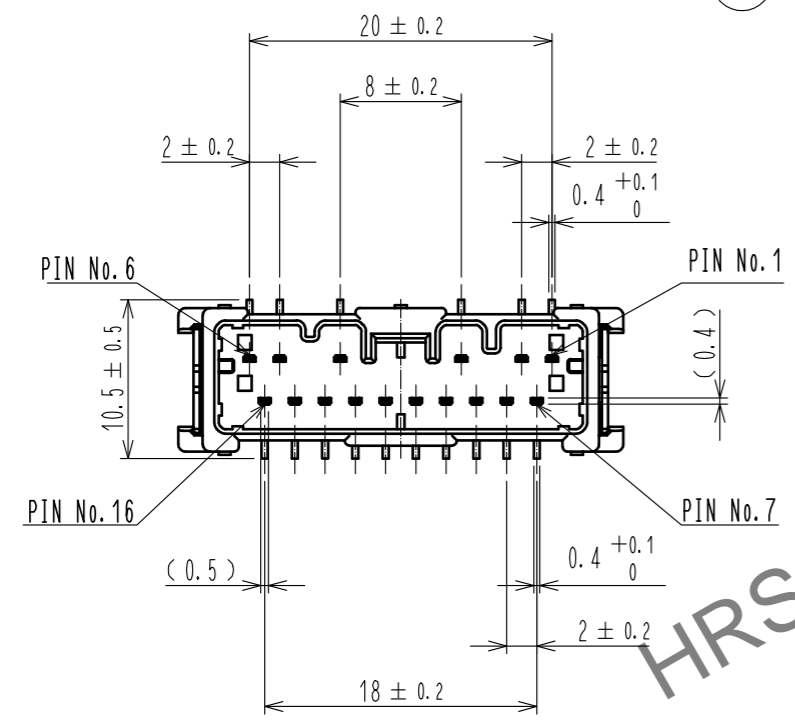
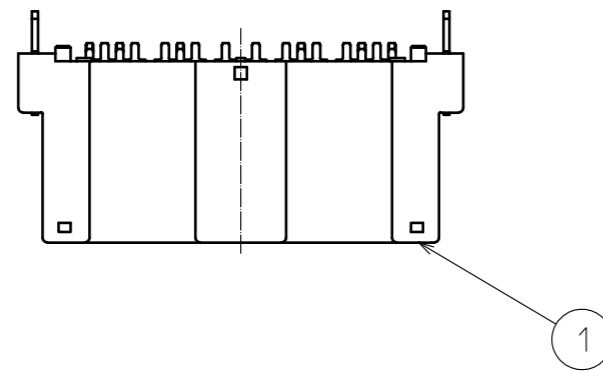
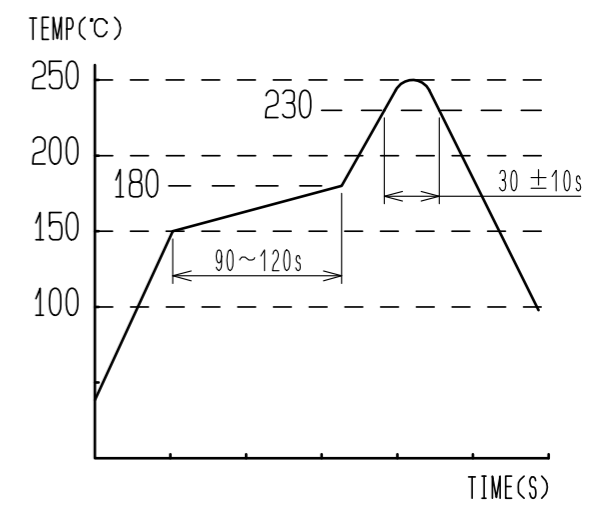

2	BRASS	SURFACE PLATING : TIN PLATING 1μm min UNDER PLATING : NICKEL 1μm min	6	POLYESTER	
1	PA	BLACK	5	POLYSTYRENE	
			4	POLYIMIDE	PICK & PLACE TAPE
			3	BRASS	SURFACE PLATING : TIN PLATING 1μm min UNDER PLATING : NICKEL 1μm min
NO.	MATERIAL	FINISH . REMARKS	NO.	MATERIAL	FINISH . REMARKS
UNITS	mm	SCALE 2 : 1	COUNT	1	DESCRIPTION OF REVISIONS
					DESIGNED TY. IKEDA
					CHECKED TY. MOGI
					DATE 20240911
APPROVED : HH. TSUKUMO		20200804	DRAWING NO. EDC-368649-00-00		
CHECKED : HH. TSUKUMO		20200804	PART NO. ZE05-16DP-2V		
DESIGNED : YH. MAMADA		20200804	CODE NO. CL0752-2305-0-00		
DRAWN : YH. MAMADA		20200804	1/2		

Sep.1.2024 Copyright 2024 HIROSE ELECTRIC CO., LTD. All Rights Reserved.
In case of consideration for using Automotive equipment / device which demand high reliability, kindly contact our sales window correspondents.

PACKING STYLE

PACKING STYLE DRAWING

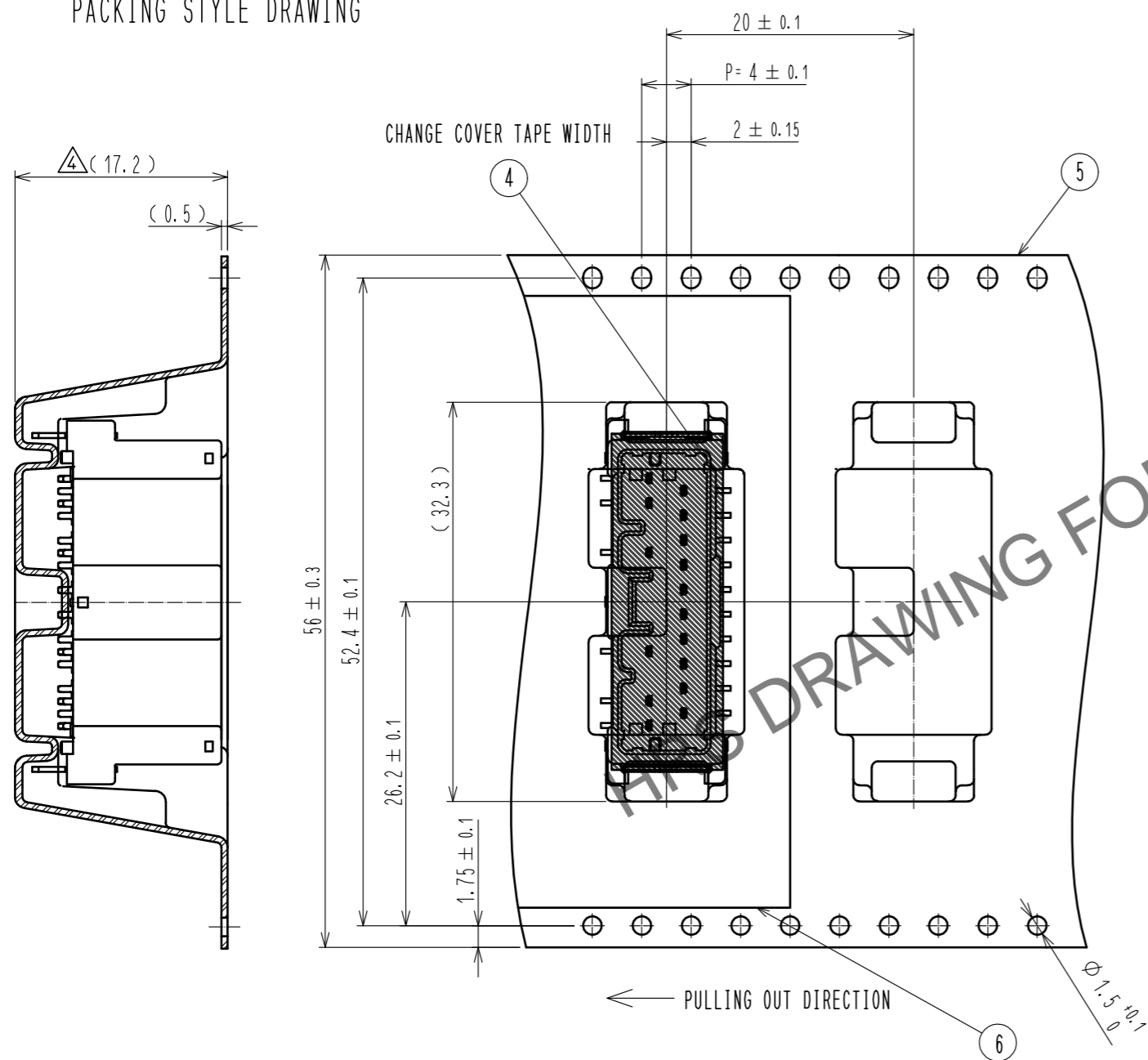

REEL DIMENSION(FREE)

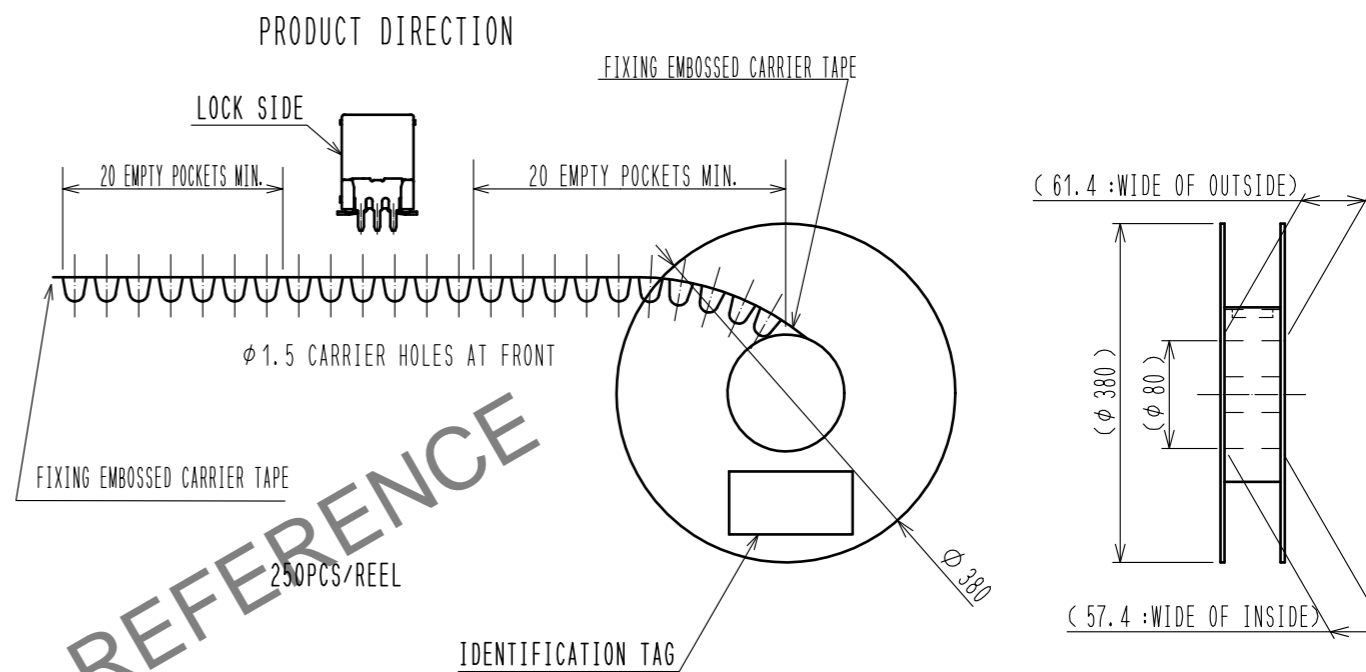

CARDBOARD DIMENSION(FREE)

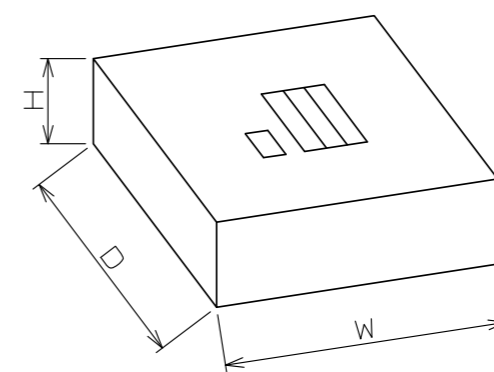

BOX SIZE
 W=(405) (mm)
 D=(405) (mm)
 H=(63) (mm)

HRS	DRAWING NO.	EDC-368649-00-00	Δ 2/2
	PART NO.	ZE05-16DP-2V	
	CODE NO.	CL0752-2305-0-00	