

May.1.2024 Copyright 2024 HIROSE ELECTRIC CO., LTD. All Rights Reserved.  
In case of consideration for using Automotive equipment / device which demand high reliability, kindly contact our sales window correspondents.

ELV, RoHS COMPLIANT

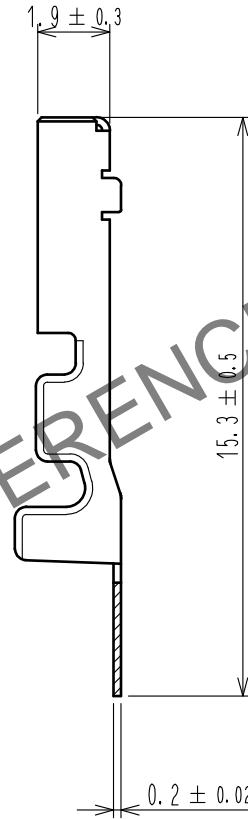

△ PACKING STYLE

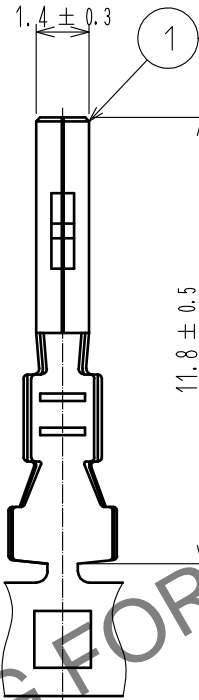
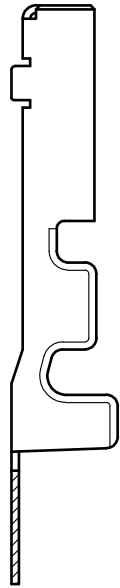
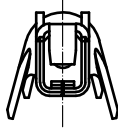
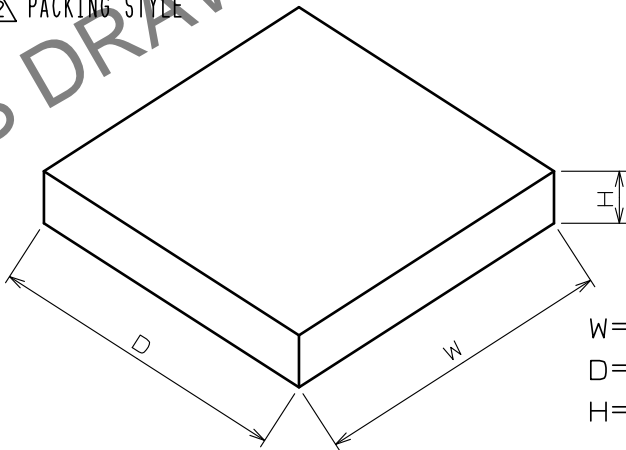

W=570 mm  
D=570 mm  
H= 55 mm

Note1. 10000PCS/RL

2. REGARDING HOW TO HANDLE THE PACKAGED PRODUCTS, PLEASE REFER TO  
THE ATAD-T0946-00「INSTRUCTION MANUAL FOR HANDLING OF REEL PACKAGING CONTAINING CRIMP TERMINALS」

1	COPPER ALLOY	SELECTIVE GOLD PLATING						
NO.	MATERIAL	FINISH .	REMARKS	NO.	MATERIAL	FINISH .	REMARKS	
UNITS mm		SCALE 5 : 1	COUNT 1	DESCRIPTION OF REVISIONS DIS-T-00019894	DESIGNED TY. IKEDA	CHECKED TY. MOGI	DATE 20240110	
HIROSE ELECTRIC CO., LTD.		APPROVED	HS. OZAWA	20150330	DRAWING NO.	EDC-168756-02-00		
		CHECKED	HS. OZAWA	20150330	PART NO.	GT25H-2024SCF<02>		
		DESIGNED	YT. HAYAKAWA	20150330	CODE NO.	CL0775-0039-6-02		
		DRAWN	YT. HAYAKAWA	20150330				1/1