

Apr.1.2026 Copyright 2026 HIROSE ELECTRIC CO., LTD. All Rights Reserved.  
In case of consideration for using Automotive equipment / device which demand high reliability, kindly contact our sales window correspondents.

ELV. RoHS COMPLIANT

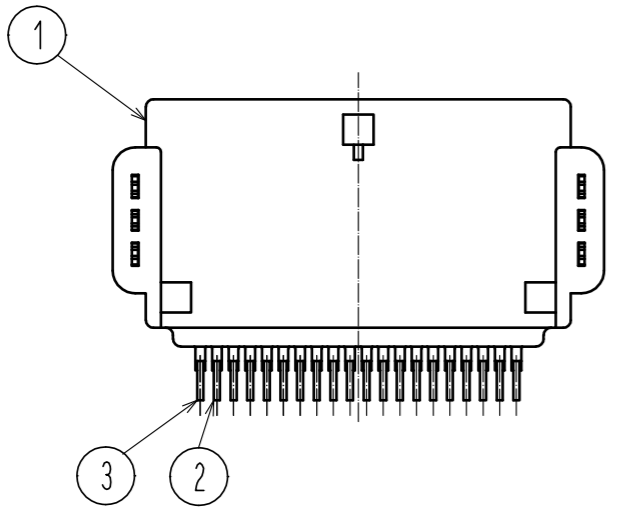

PIN ASSIGNMENT  
10 20 9 19 8 18 7 17 6 16 5 15 4 14 3 13 2 12 1 11

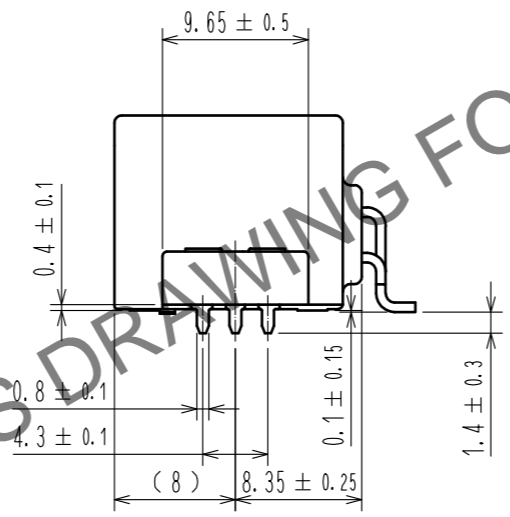
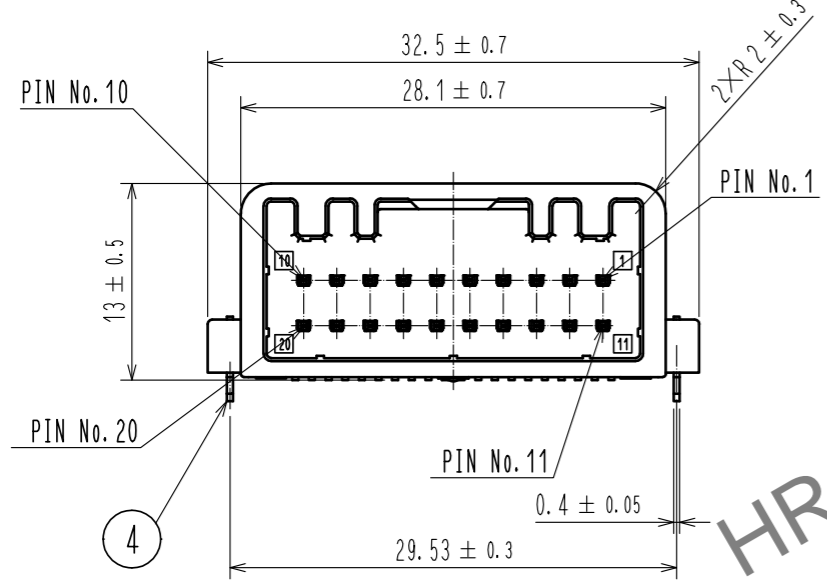
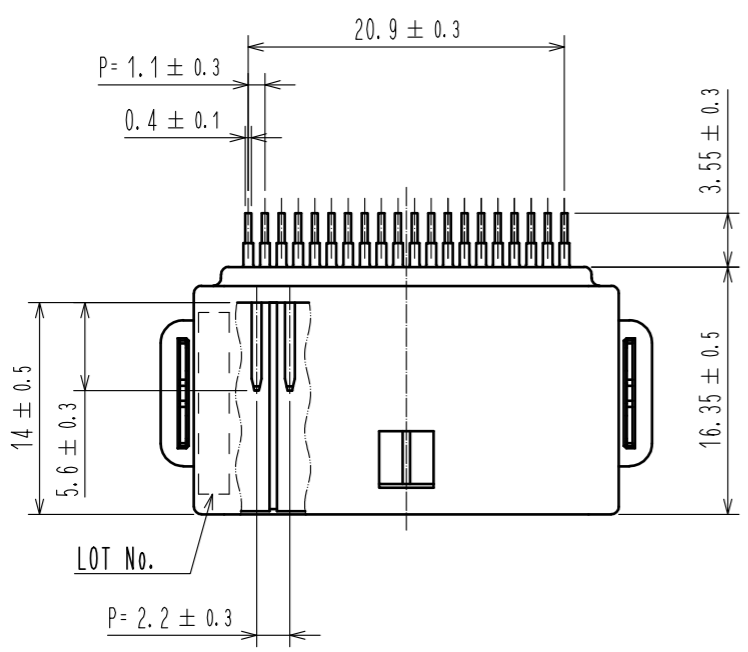
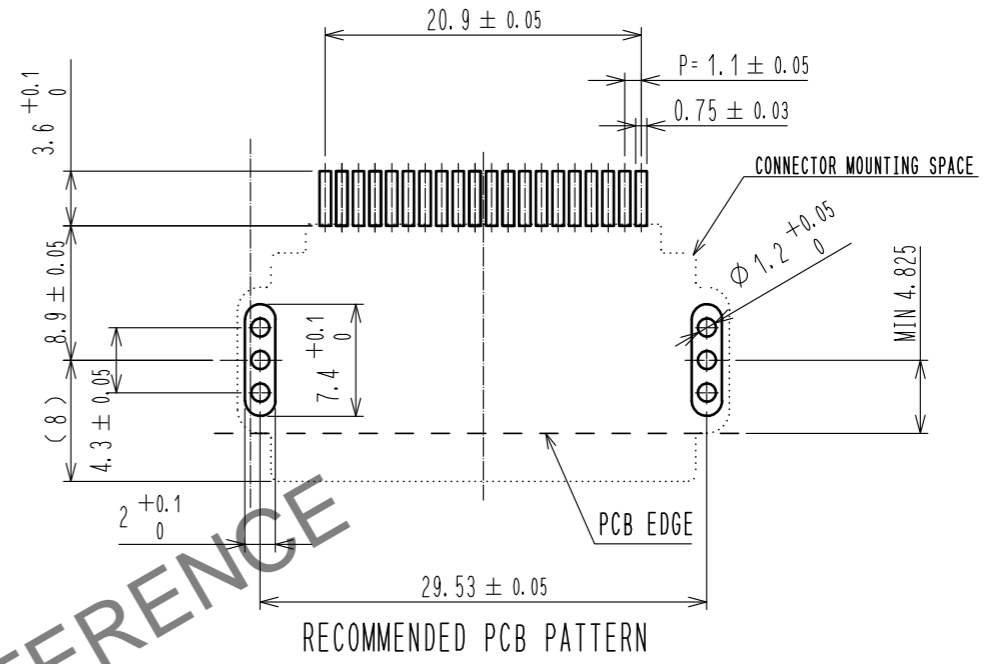

NOTE1. RECOMMENDED TEMPERATURE PROFILE FOR REFLOW (REFER TO RIGHT FIG.)  
USED REFLOW SYSTEM : IR IN THE AIR OR NITROGEN  
NO. OF CYCLES : 2 MAX  
PEAK : 250°C  
OVER 230°C : 20~40s  
PREHEAT : 150~180°C 60~120s

2. LEAD CO-PLANARITY SHALL BE 0.1mm MAX.  
3. RECOMMENDED PCB THICKNESS IS 1.6mm  
4. RECOMMENDED SOLDER THICKNESS IS 0.15mm.  
5. REFER TO JIS C 0806 (PACKAGING OF COMPONENTS FOR AUTOMATIC HANDLING) FOR EMBOSSED REEL PACKAGING.

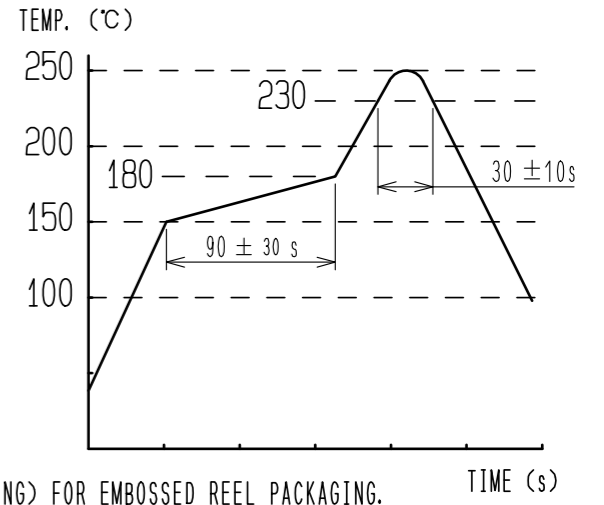

3	BRASS	CONTACT AREA, LEAD AREA: TIN PLATING 0.5µm min	7	PS	
		UNDER PLATING: NICKEL 0.5µm min	6	POLYESTER	
2	BRASS	CONTACT AREA, LEAD AREA: TIN PLATING 0.5µm min	5	PS	
		UNDER PLATING: NICKEL 0.5µm min	4	BRASS	LEAD AREA: TIN PLATING 0.5µm min
1	PA	BLACK			UNDER PLATING: NICKEL 0.5µm min
NO.	MATERIAL	FINISH . REMARKS	NO.	MATERIAL	FINISH . REMARKS
UNITS	mm	SCALE	2 : 1	COUNT	2
DESCRIPTION OF REVISIONS			DESIGNED	YI. OGAWA	CHECKED
DIS-T-00025828			DATE	TY. MOGI	20251216
APPROVED : AH. EDASHIGE 20250826			DRAWING NO. EDC-358751-31-00		
CHECKED : TY. MOGI 20250826			PART NO. GT25H2-20DP-2. 2H(31)		
DESIGNED : YI. OGAWA 20250825			CODE NO. CL0775-0080-0-31		
DRAWN : AN. SAIKI 20250825			1/2		

Apr.1.2026 Copyright 2026 HIROSE ELECTRIC CO., LTD. All Rights Reserved.  
 In case of consideration for using Automotive equipment / device which demand high reliability, kindly contact our sales window correspondents.

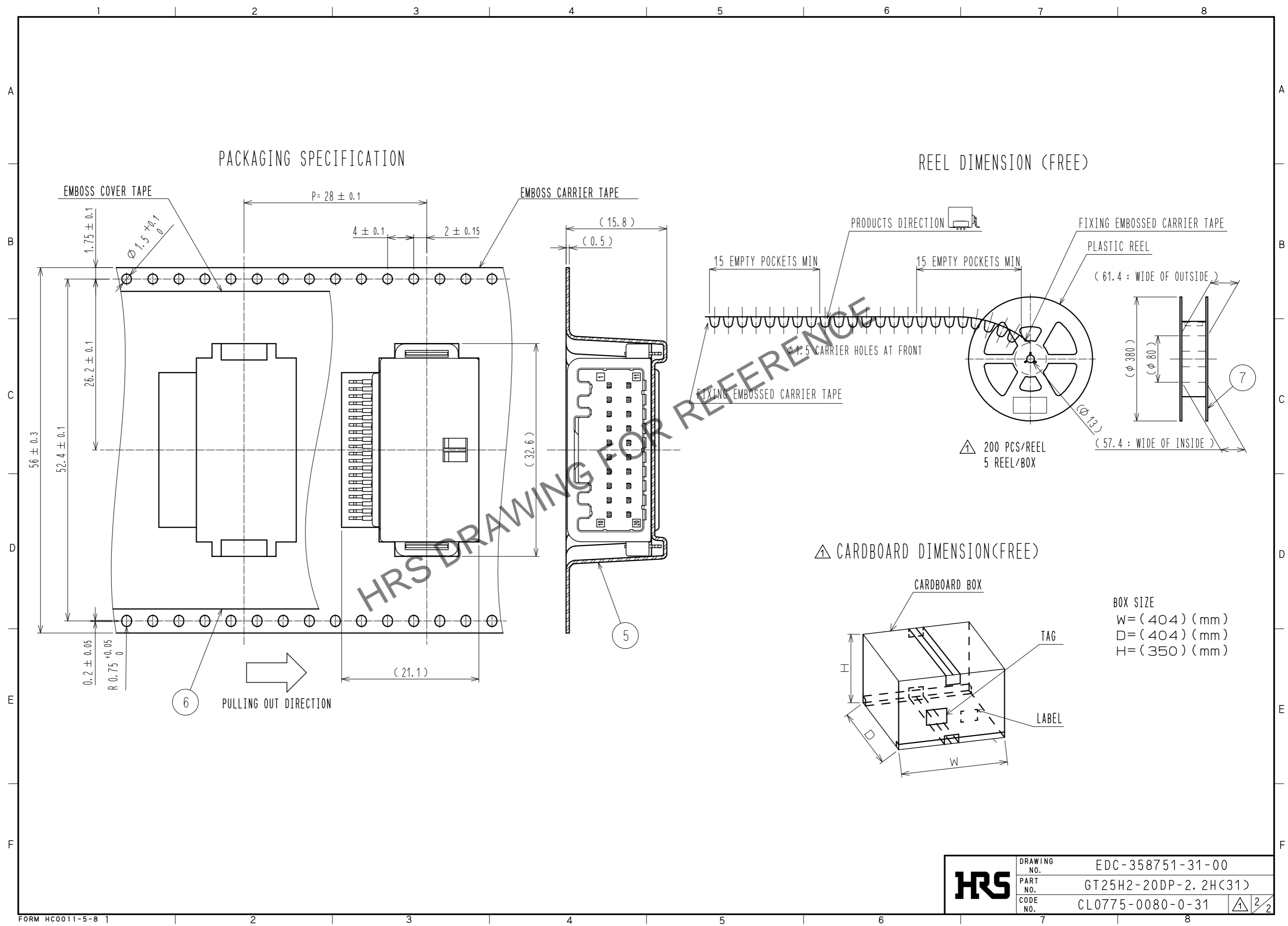

<b>HRS</b>	DRAWING NO.	EDC-358751-31-00
	PART NO.	GT25H2-20DP-2.2H(31)
	CODE NO.	CL0775-0080-0-31
		∆ 2/2