

Apr.1.2025 Copyright 2025 HIROSE ELECTRIC CO., LTD. All Rights Reserved.
 In case of consideration for using Automotive equipment / device which demand high reliability, kindly contact our sales window correspondents.

RoHS, ELV COMPLIANT

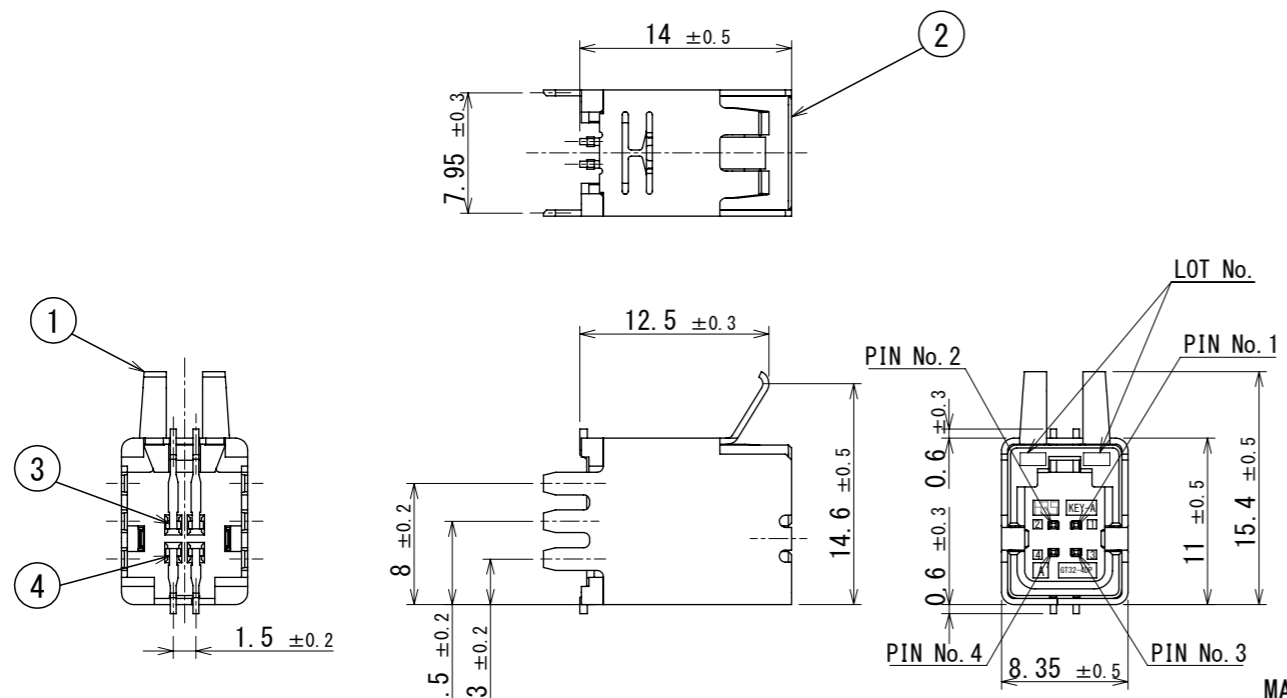

MATED CONNECTORS

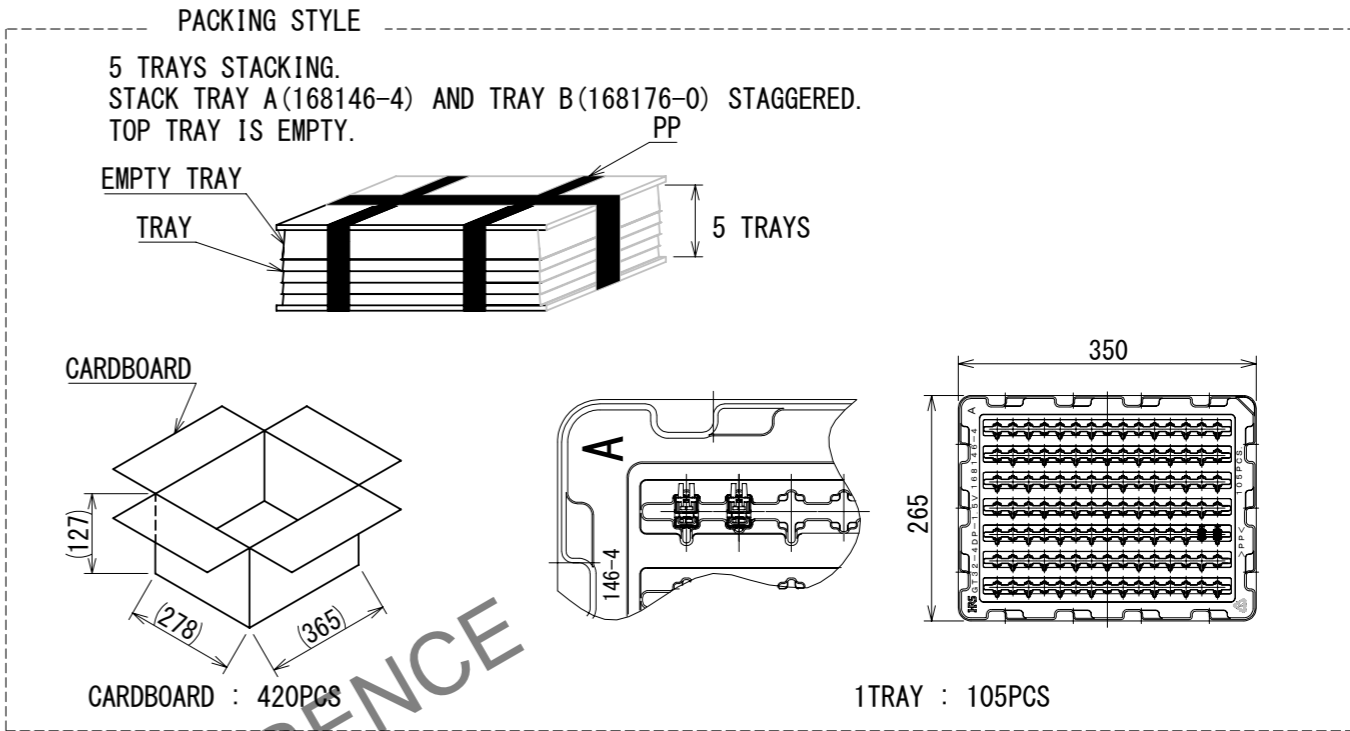
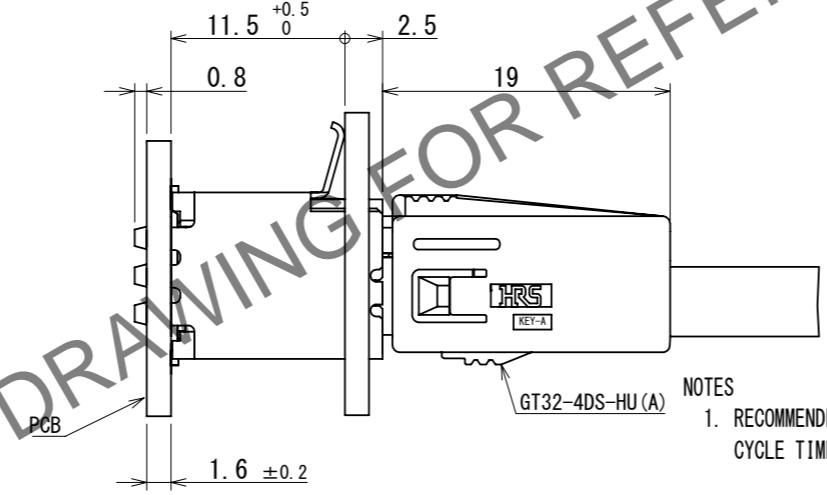
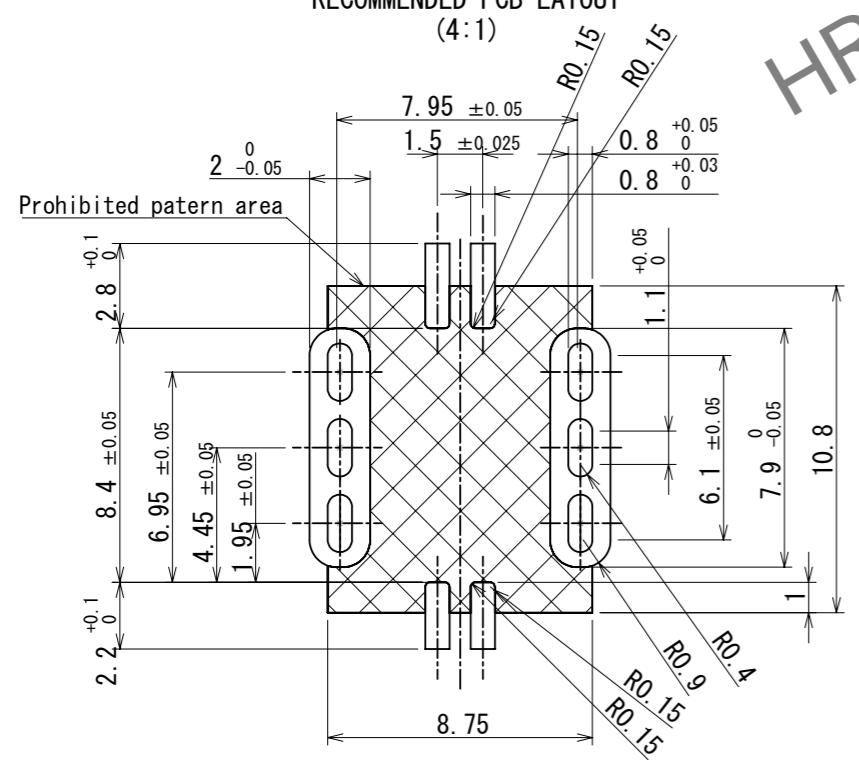

Fig. ADDED A PICK & PLACE TAPE



RECOMMENDED PCB LAYOUT (4:1)



RECOMMENDED PANEL CUTOUT

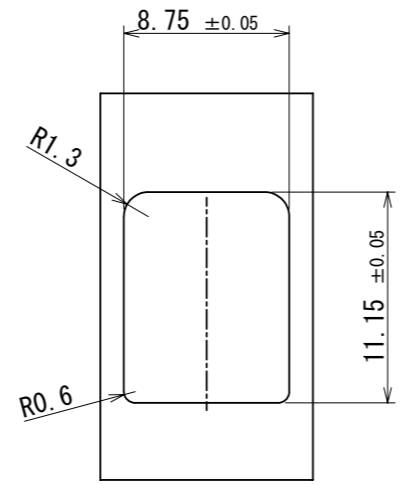

- NOTES
- RECOMMENDED REFLOW PROFILE (SEE RIGHT GRAPH)
 CYCLE TIME: UP TO 2 CYCLES OF REFLOW SOLDERING ARE POSSIBLE UNDER THE CONDITIONS, PROVIDED THAT THERE IS A RETURN TO NORMAL TEMPERATURE BETWEEN THE FIRST AND SECOND CYCLE.
 PEAK TEMPERATURE: 250°C
 230°C MIN. FOR 20 TO 40 SECONDS.
 PREHEATING AREA 150~180°C FOR 60 TO 120 SECONDS.
 - HAND SOLDERING: 280~300°C, 2SECONDS MAX.
 - CONTACT COPLANARITY: 0.1mm MAX.
 - RECOMMENDED THICKNESS OF PCB: 1.6mm
 - RECOMMENDED THICKNESS OF SOLDERING PASTE: 0.12mm

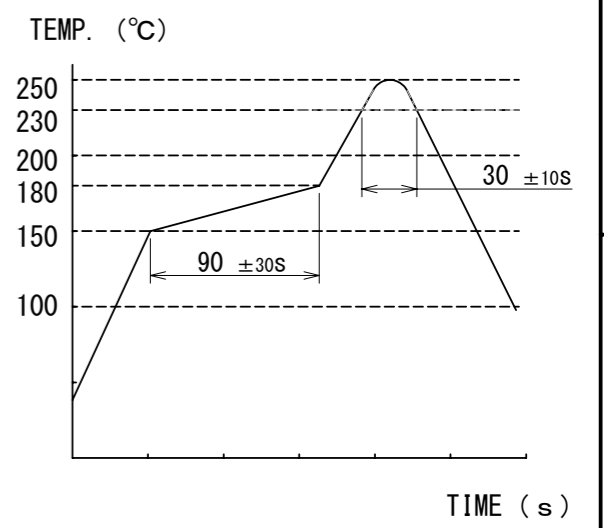

3	BRASS	TIN PLATING							
2	PA	BROWN	5	POLYIMIDE	PICK & PLACE TAPE				
1	COPPER ALLOY	TIN PLATING	4	BRASS	TIN PLATING				
NO.	MATERIAL	FINISH	REMARKS	NO.	MATERIAL	FINISH	REMARKS		
UNITS	mm	SCALE	2:1	COUNT	0	DESCRIPTION OF REVISIONS	DESIGNED	CHECKED	DATE
HRS				HIROSE ELECTRIC CO., LTD.		APPROVED : AR. SHIRAI	2017. 07. 19	DRAWING NO. EDC-362123-00-00	
						CHECKED : TH. MIZUGUCHI	2017. 07. 19	PART NO. GT32-4DP-1. 5V (A)	
						DESIGNED : TS. KUBOTA	2017. 07. 19	CODE NO. CL0782-0065-4-00	
						DRAWN : TS. KUBOTA	2017. 07. 19	DATE 2023. 07. 03	