

Mar.1.2025 Copyright 2025 HIROSE ELECTRIC CO., LTD. All Rights Reserved.
 In case of consideration for using Automotive equipment / device which demand high reliability, kindly contact our sales window correspondents.

RoHS, ELV COMPLIANT

PACKING STYLE

5 TRAYS STACKING.
 STACK TRAY A(168146-4) AND TRAY B(168176-0) STAGGERED.
 TOP TRAY IS EMPTY.

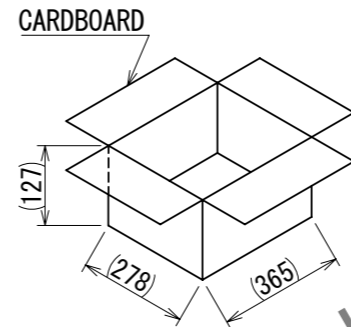
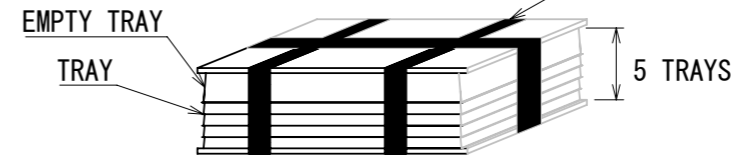

CARDBOARD : 420PCS

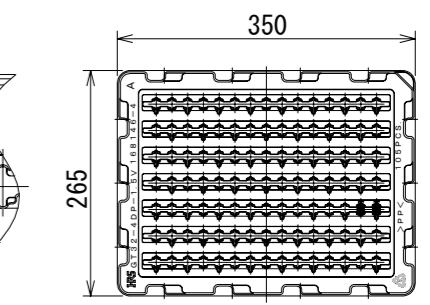
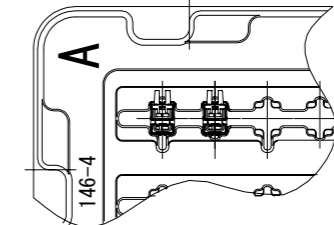

1TRAY : 105PCS

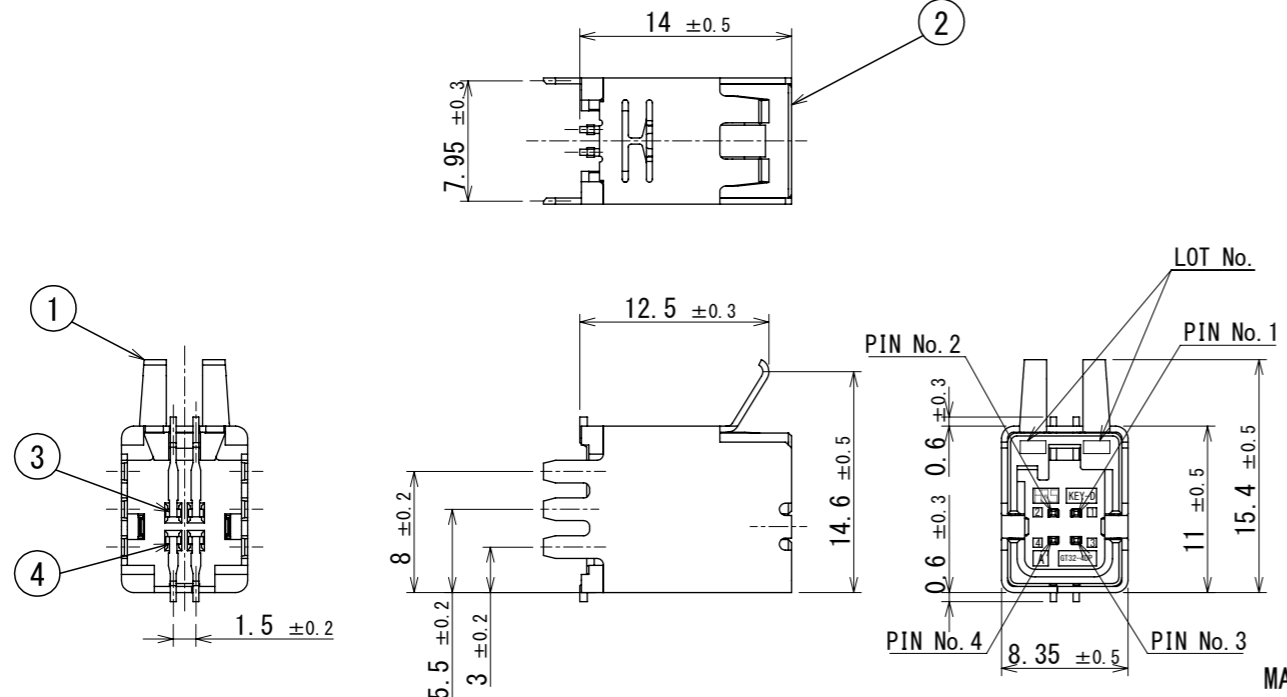

MATED CONNECTORS

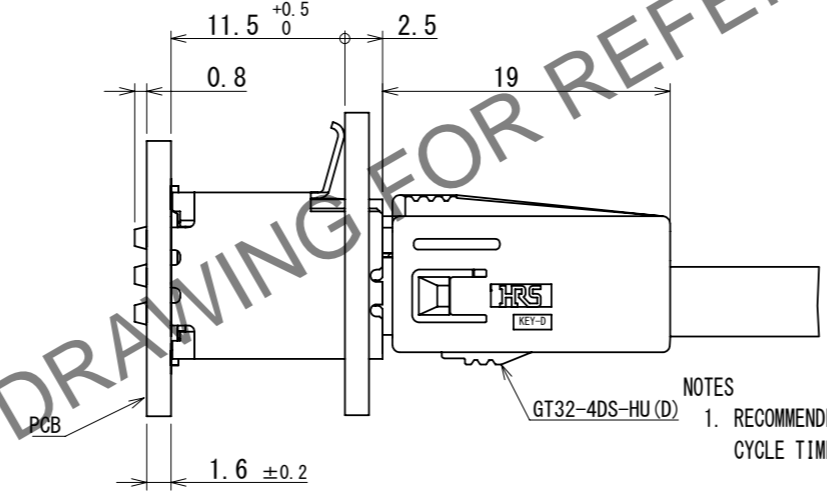

- NOTES
- RECOMMENDED REFLOW PROFILE (SEE RIGHT GRAPH)
 CYCLE TIME: UP TO 2 CYCLES OF REFLOW SOLDERING ARE POSSIBLE UNDER THE CONDITIONS, PROVIDED THAT THERE IS A RETURN TO NORMAL TEMPERATURE BETWEEN THE FIRST AND SECOND CYCLE.
 PEAK TEMPERATURE: 250°C
 230°C MIN. FOR 20 TO 40 SECONDS.
 PREHEATING AREA 150~180°C FOR 60 TO 120 SECONDS.
 - HAND SOLDERING: 280~300°C, 2SECONDS MAX.
 - CONTACT COPLANARITY: 0.1mm MAX.
 - RECOMMENDED THICKNESS OF PCB: 1.6mm
 - RECOMMENDED THICKNESS OF SOLDERING PASTE: 0.12mm

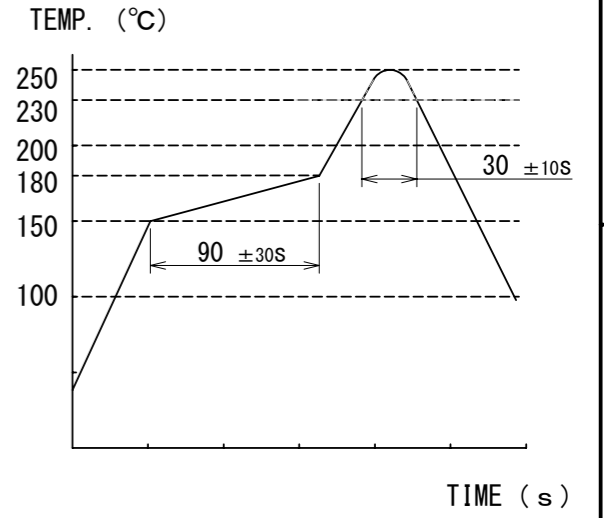
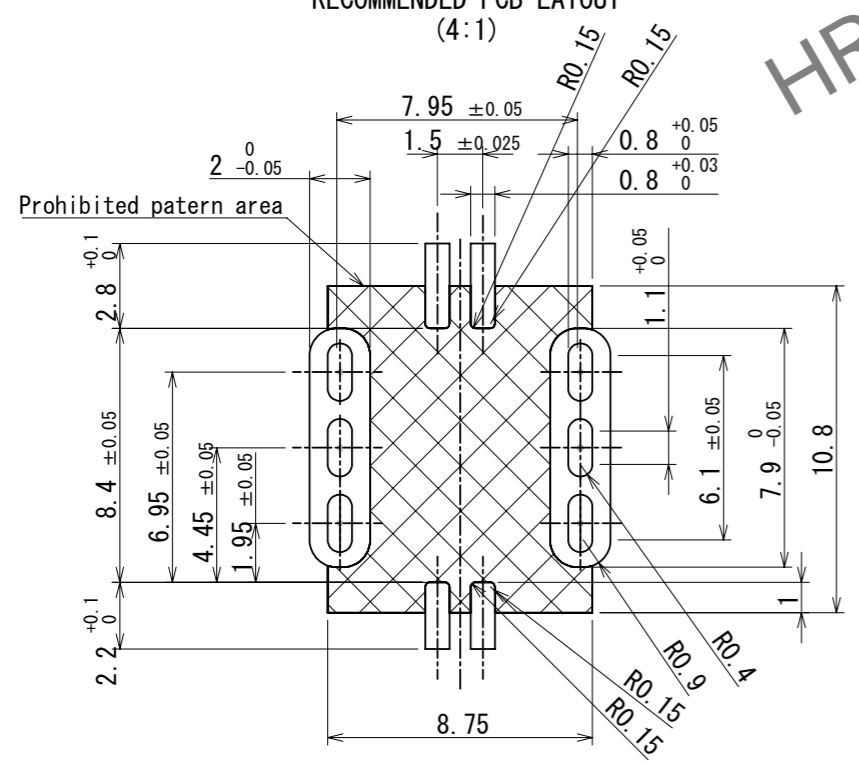

Fig. ADDED A PICK & PLACE TAPE



RECOMMENDED PCB LAYOUT (4:1)



RECOMMENDED PANEL CUTOUT

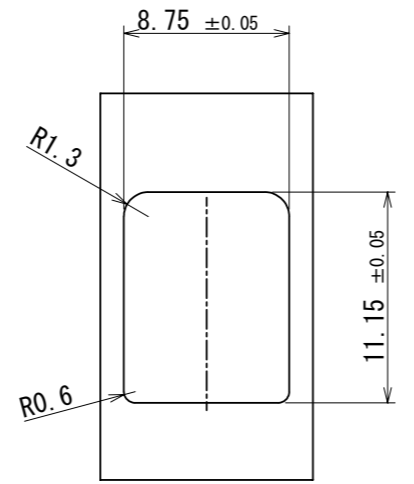

3	BRASS	TIN PLATING	5	POLYIMIDE	PICK & PLACE TAPE		
2	PA	BLACK	4	BRASS	TIN PLATING		
1	COPPER ALLOY	TIN PLATING					
NO.	MATERIAL	FINISH	REMARKS	NO.	MATERIAL	FINISH	REMARKS

UNITS	mm	SCALE	2:1	COUNT	0	DESCRIPTION OF REVISIONS	DESIGNED	CHECKED	DATE
						DIS-T-00018480	KN. YANAGIMOTO	EJ. WAKATSUKI	2023. 07. 03
APPROVED : AR. SHIRAI		2017. 07. 19		DRAWING NO.		EDC-362126-00-00			
CHECKED : TH. MIZUGUCHI		2017. 07. 19		PART NO.		GT32-4DP-1. 5V(D)			
DESIGNED : TS. KUBOTA		2017. 07. 19		CODE NO.		CL0782-0068-2-00			
DRAWN : TS. KUBOTA		2017. 07. 19							



HIROSE ELECTRIC CO., LTD.