

Jan.1.2021 Copyright 2021 HIROSE ELECTRIC CO., LTD. All Rights Reserved.  
In case of consideration for using Automotive equipment / device which demand high reliability, kindly contact our sales window correspondents.

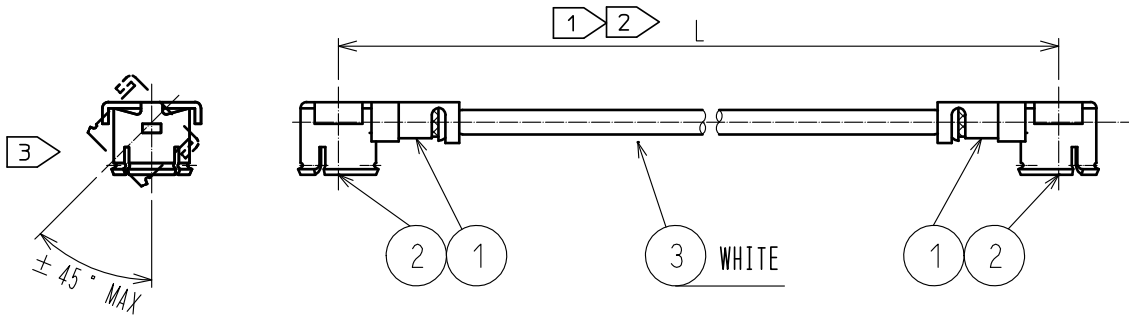

NOTE ① We indicate the length of the harness on the last of product name, 'L' part.

② Tolerance for [L]

Length L [mm]	Tolerance [mm]
$35 \leq L \leq 200$	$\pm 4$
$200 < L \leq 500$	$\pm 8$
$500 < L \leq 1000$	$\pm 12$
$1000 < L$	$\pm 1.5\%$

③ Connector rotation angle is within  $\pm 45$  degree from the above image.  
For long length in the case of  $L > 500$ , the angle is optional.

4. Specifications are subject to change without notice.

[ DIMENSIONS OF CONNECTOR ]

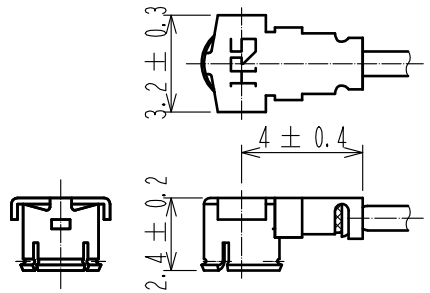

For stable supply of this series, material supplier of piece part#1 will be changed during 2019-2022. Please note this change in advance. There will be no difference in product performance and quality.

2	E. FL CONTACT	CL331-0411-8-11		
1	E. FL-LP-040(01)	CL331-0401-4-01	3	0.81Dia. coaxial cable
NO.	PART NO.	CODE NO.	NO.	PART NO.
UNITS mm		SCALE FREE	COUNT 1	DESCRIPTION OF REVISIONS DIS-D-00004640
HIROSE ELECTRIC CO., LTD.		APPROVED : NK. NINOMIYA 20180608	DRAWING NO.	
		CHECKED : MT. KANEKO 20180608	PART NO. E. FL-2LP-04-A-L	
		DESIGNED : MS. MATSUMOTO 20180608	CODE NO.	
		DRAWN : MS. MATSUMOTO 20180608	①/1/1	