

Sep.1.2019 Copyright 2019 HIROSE ELECTRIC CO., LTD. All Rights Reserved.
In case of consideration for using Automotive equipment / device which demand high reliability, kindly contact our sales window correspondents.

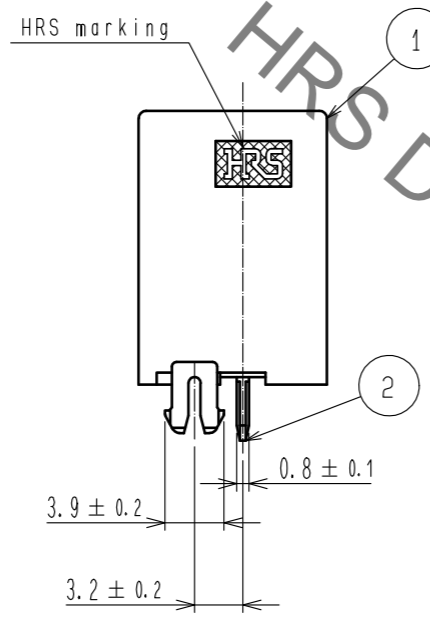

Recommended PCB layout

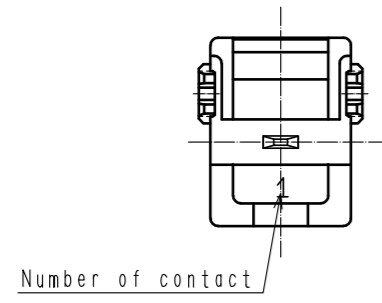
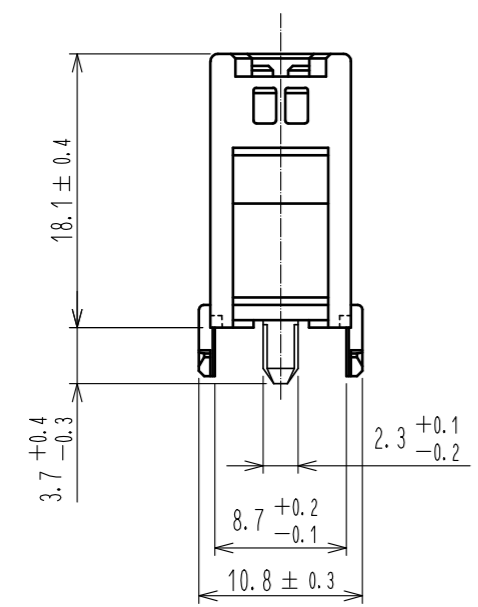
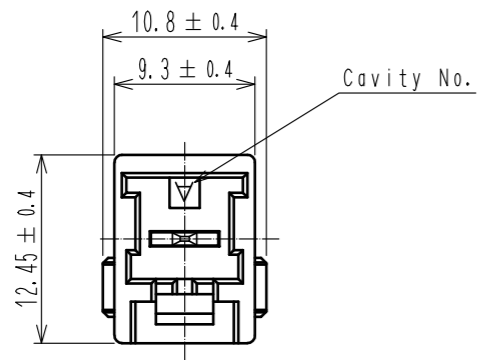
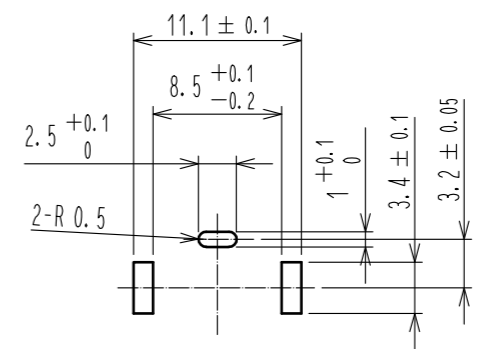

Application diagram

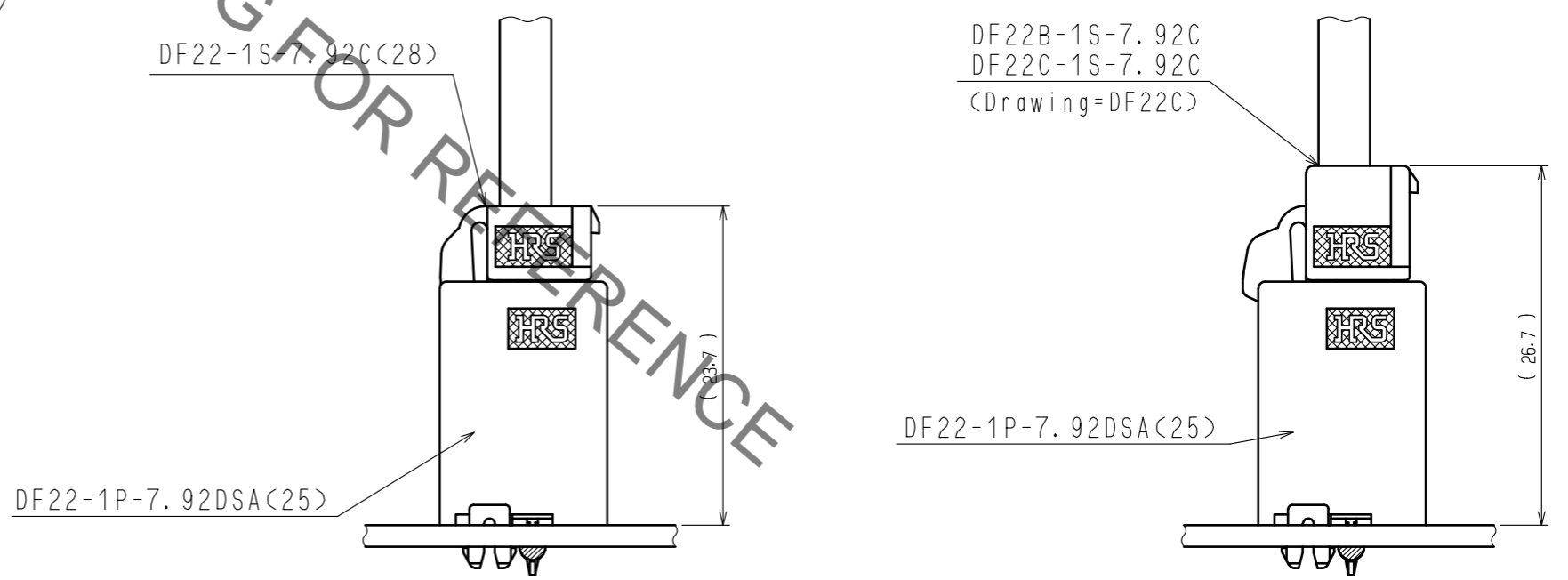

NOTE 1. UL(File No. E52653)
C-UL(File No. E52653)
TÜV(File No. R9950703) authorization article.



1	Polyamide	Natural(Beige). UL94V-0	3	PS	Tray. White
2	Copper alloy		2	Copper alloy	Lead area: Tin-Copper plating 1μm min Under plating: Nickel plating 0.5μm min
NO.	MATERIAL	FINISH . REMARKS	NO.	MATERIAL	FINISH . REMARKS
UNITS	mm	SCALE	2 : 1	COUNT	1
DESCRIPTION OF REVISIONS			DESIGNED	CHECKED	DATE
DIS-H-00003575			TS. KUMAZAWA	TS. FUKUSHIMA	18. 03. 29
APPROVED : HS. OKAWA 17. 08. 22			DRAWING NO. EDC-163202-25-00		
CHECKED : TS. FUKUSHIMA 17. 08. 22			PART NO. DF22-1P-7. 92DSA(25)		
DESIGNED : MI. SAKIMURA 17. 08. 22			CODE NO. CL680-1013-5-25		
DRAWN : MI. SAKIMURA 17. 08. 22			1/3		

Sep.1.2019 Copyright 2019 HIROSE ELECTRIC CO., LTD. All Rights Reserved.
In case of consideration for using Automotive equipment / device which demand high reliability, kindly contact our sales window correspondents.

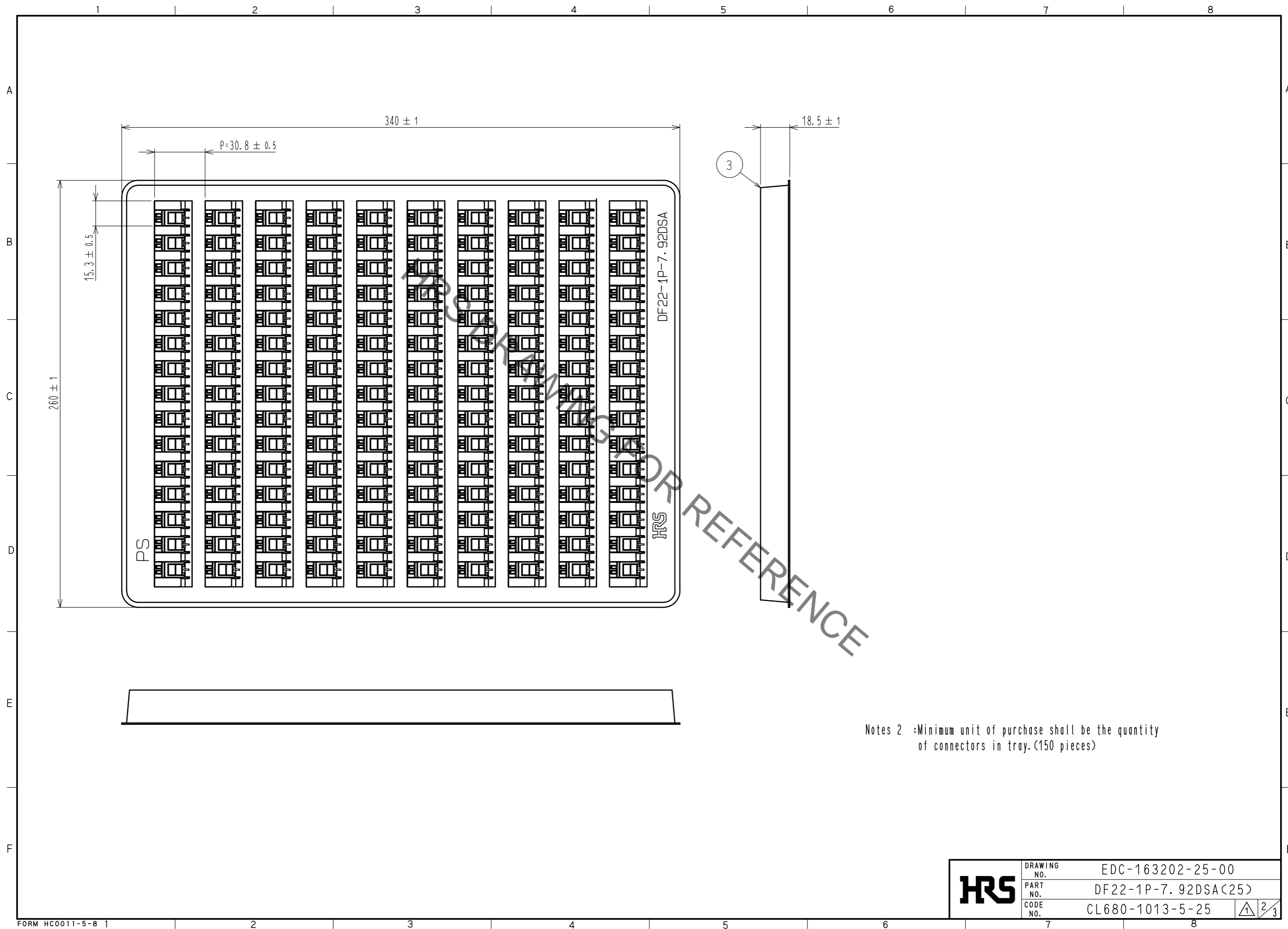

Notes 2 :Minimum unit of purchase shall be the quantity of connectors in tray.(150 pieces)

HRS	DRAWING NO.	EDC-163202-25-00
	PART NO.	DF22-1P-7.92DSA(25)
	CODE NO.	CL680-1013-5-25

2/3

Sep.1.2019 Copyright 2019 HIROSE ELECTRIC CO., LTD. All Rights Reserved.
In case of consideration for using Automotive equipment / device which demand high reliability, kindly contact our sales window correspondents.



Precautions

Notification for Insertion Extraction

1) Please insert(extract) the crimping socket straight to the mating connector.
Insertion(extraction) at tilted angles applies load concentration to the connector end and may cause deformation (at connection area, socket and header case, etc). There is firing risk using this kind of deformed connector.

Insertion(Extraction)

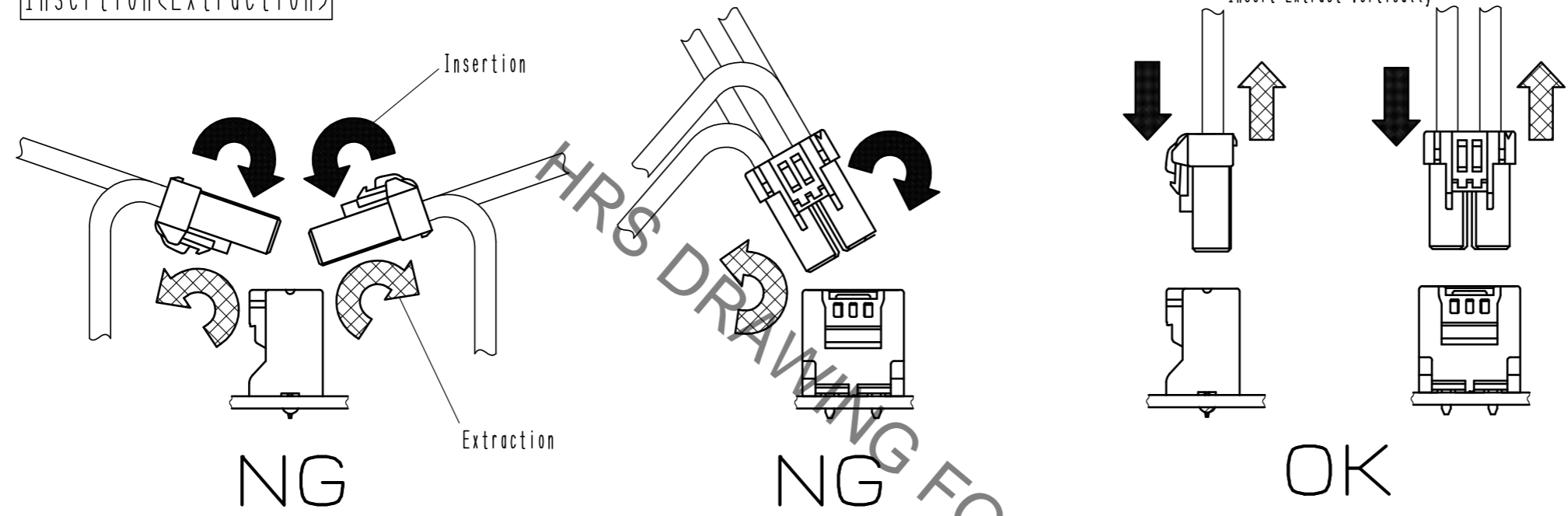

2) When it is hard to extract, please lightly insert the connector beforehand and then pull it with releasing the lock.
Forced extraction has a risk of connector breakage.

Notification of wiring

1) When using a thick cable, short cable length and bending close to the connector end, these load concentration may cause deformation.
Please note that there is firing risk using deformed connector.
When installing, please refrain from stress concentration such as cable bending close to the connector end or cable twisting.

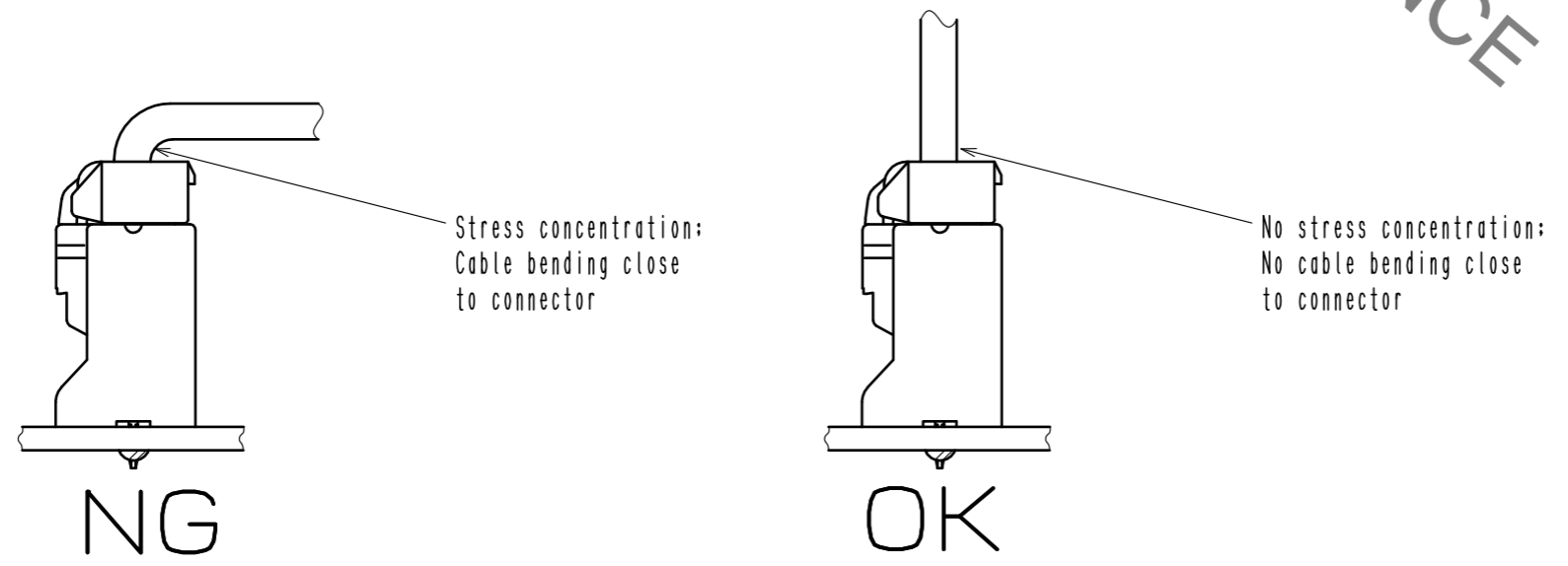

2) When applying load to connector end, please use the retainer for reducing the stress affection on the connector.
Retainer shall be installed after inserted crimping contact completely. It might be impossible to insert it when terminal installation is incompletd.

HRS	DRAWING NO.	EDC-163202-25-00	3/3
	PART NO.	DF22-1P-7.92DSA(25)	
	CODE NO.	CL680-1013-5-25	