

ELV, RoHS COMPLIANT

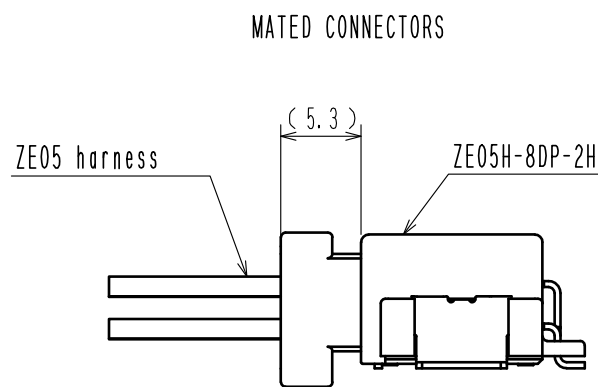

RECOMMENDED PCB PATTERN

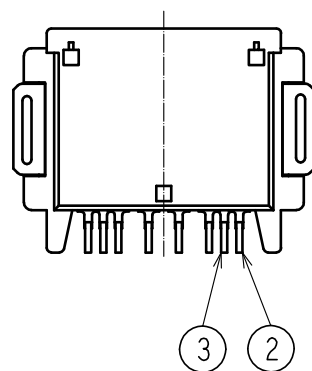
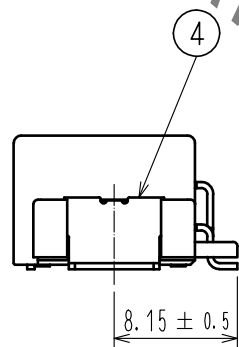
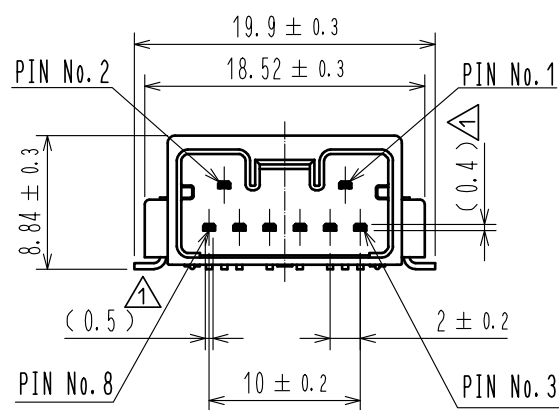
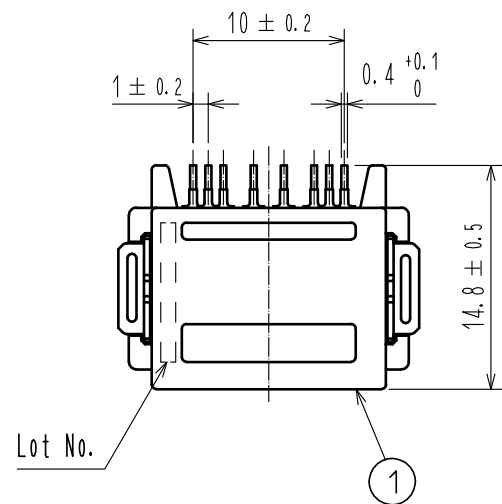
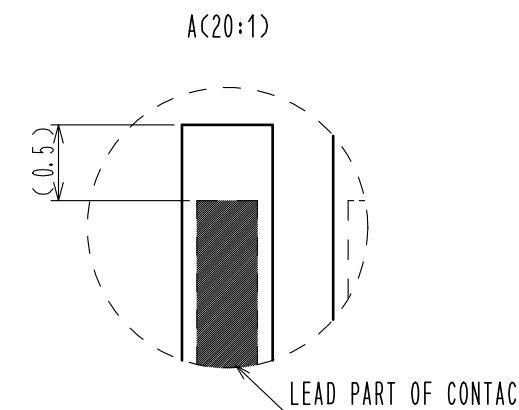
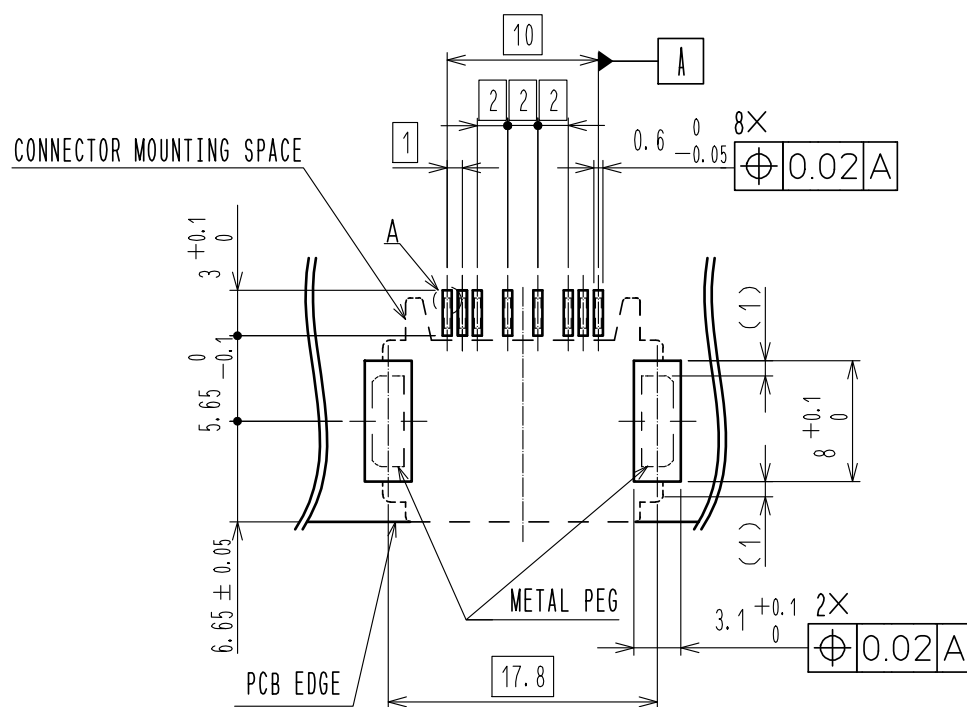

HRS DRAWING FOR REFERENCE

- NOTE 1. RECOMMENDED TEMPERATURE PROFILE FOR REFLOW (REFER TO RIGHT FIG.) USED REFLOW SYSTEM
- : IR IN THE AIR OR NITROGEN
  - NO. OF CYCLES : 2 MAX
  - PEAK : 250°C
  - OVER 230°C : 20~40s
  - PREHEAT : 150~180°C
  - 90~120s
2. TEMPERATURE FOR SOLDERING IRON : 280~300°C WITHIN 2s
3. CO-PLANARITY SHALL BE 0.1mm MAX.
4. RECOMMENDED PCB THICKNESS IS 1.6mm.
5. RECOMMENDED SOLDER THICKNESS IS 0.15mm.

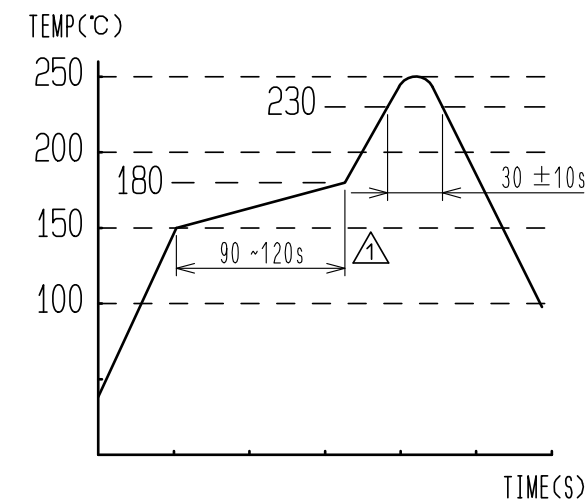

3	BRASS	SURFACE PLATING : TIN PLATING 1μm min					
		UNDER PLATING : NICKEL 1μm min	6	POLYESTER			
2	BRASS	SURFACE PLATING : TIN PLATING 1μm min	5	POLYSTYRENE			
		UNDER PLATING : NICKEL 1μm min			SURFACE PLATING : TIN PLATING 1μm min		
1	PA	BLACK UL94V-0	4	BRASS	UNDER PLATING : NICKEL 1μm min		
NO.	MATERIAL	FINISH . REMARKS	NO.	MATERIAL	FINISH . REMARKS		
UNITS mm		SCALE 2 : 1	COUNT 6	DESCRIPTION OF REVISIONS DIS-T-00003979	DESIGNED YONGMUN LEE	CHECKED HH. TSUKUMO	DATE 20181119
<b>HRS</b> HIROSE ELECTRIC CO., LTD.		APPROVED : HK. UMEHARA	20170906	DRAWING NO. EDC-373531-00-00			
		CHECKED : HK. UMEHARA	20170906	PART NO. ZE05H-8DP-2H			
		DESIGNED : AH. EDASHIGE	20170906	CODE NO. CL752-2112-0-00			
		DRAWN : MN. SATOH	20170906				

Apr.1.2019 Copyright 2019 HIROSE ELECTRIC CO., LTD. All Rights Reserved. In case of consideration for using Automotive equipment / device which demand high reliability, kindly contact our sales window correspondents.

Apr.1.2019 Copyright 2019 HIROSE ELECTRIC CO., LTD. All Rights Reserved.  
 In case of consideration for using Automotive equipment / device which demand high reliability, kindly contact our sales window correspondents.

PACKING STYLE

REEL DIMENSION (FREE)

PACKING STYLE DRAWING

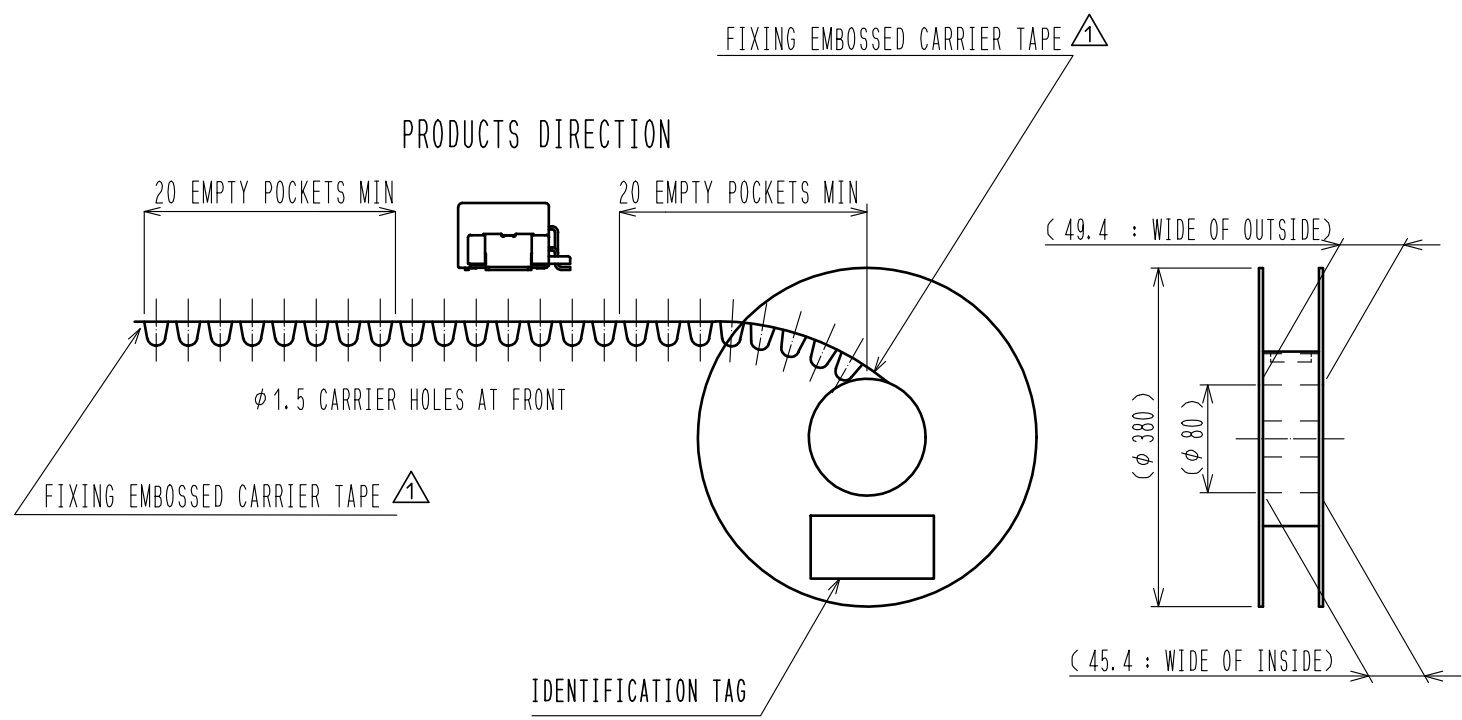
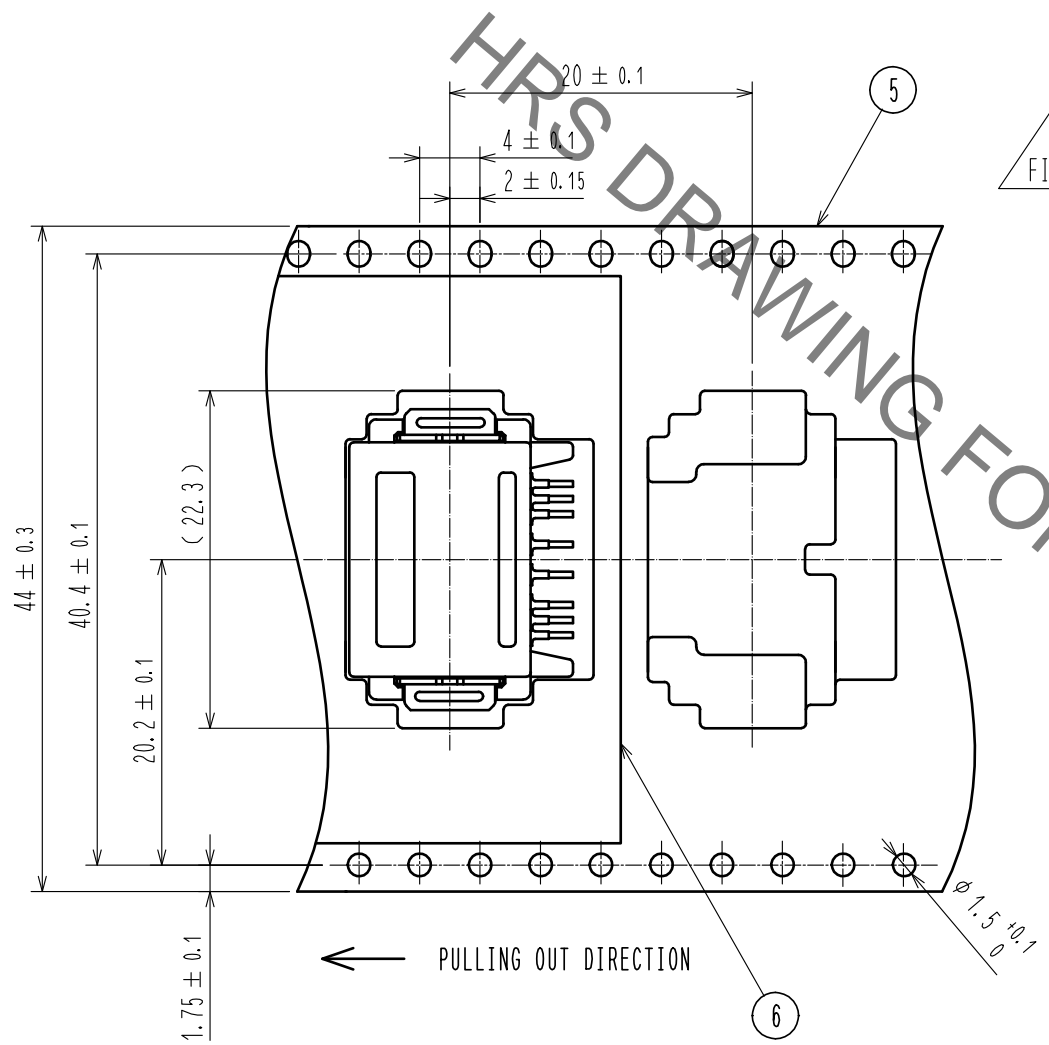
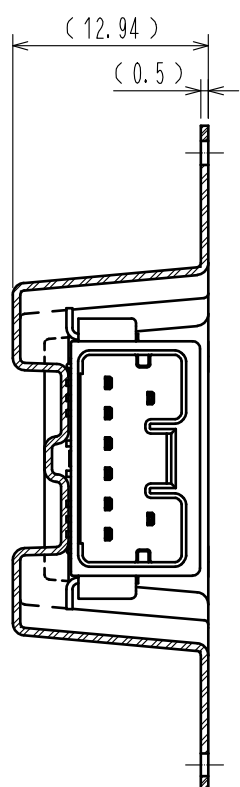

CARDBOARD DIMENSION (FREE)

W=(405) (mm)  
 D=(405) (mm)  
 H=(51) (mm)

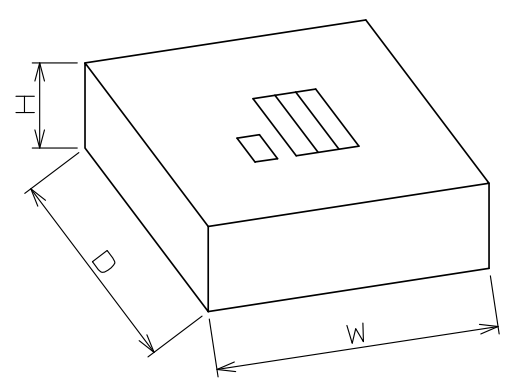

HRS DRAWING FOR REFERENCE

<b>HRS</b>	DRAWING NO.	EDC-373531-00-00	2/2
	PART NO.	ZE05H-8DP-2H	
	CODE NO.	CL752-2112-0-00	