

In case of consideration for using Hirose Electric Co., Ltd. All Rights Reserved. Jul.1.2019 Copyright 2019 HIROSE ELECTRIC CO., LTD. All Rights Reserved. In case of consideration for using Automotive equipment / device which demand high reliability, kindly contact our sales window correspondents.

| COUNT | DESCRIPTION OF REVISIONS | BY | CHKD | DATE | COUNT | DESCRIPTION OF REVISIONS | BY | CHKD | DATE |
|-------|--------------------------|----|------|------|-------|--------------------------|----|------|------|
| △ | | | | | △ | | | | |
| △ | | | | | △ | | | | |
| △ | | | | | △ | | | | |

NOTE1. THIS CONNECTOR SHALL BE USED WITH A RETAINER
(CL755-0006-2).

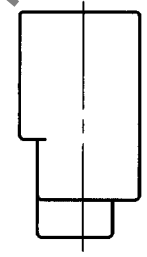
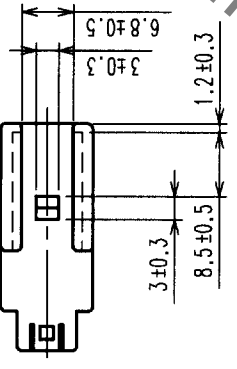
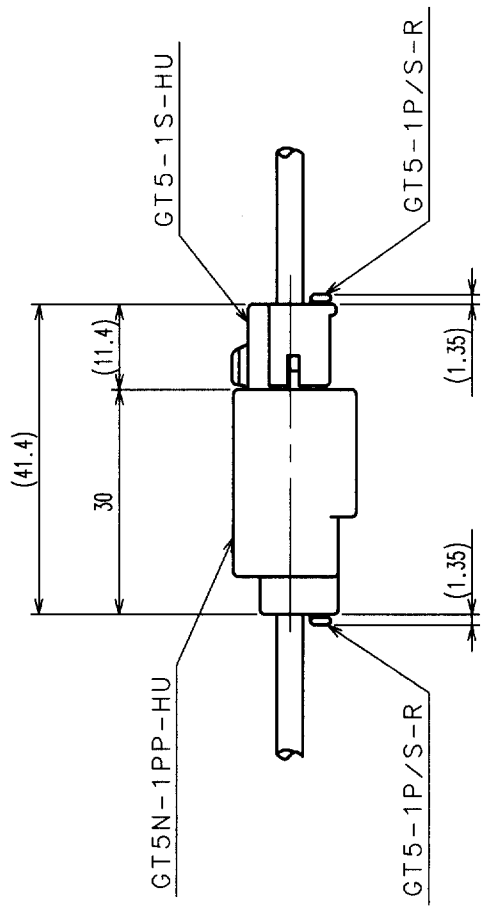
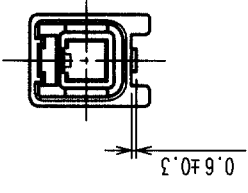
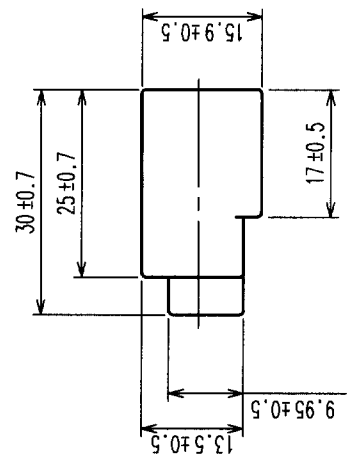
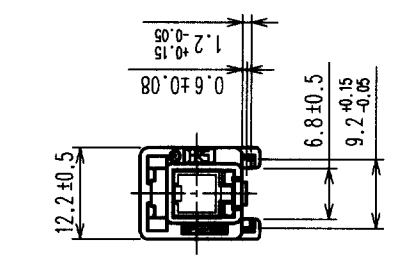
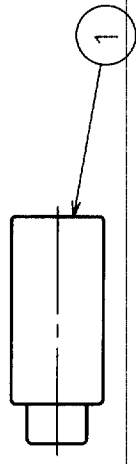

MATED CONNECTORS

HRS DRAWING FOR REFERENCE

| 1 | | UL94HB, LIGHT GRAY | | FINISH, REMARKS | | MATERIAL | | FINISH, REMARKS | |
|-------------|----------------|--------------------|-----------------|-----------------|-----------|--------------------------|----------------|-----------------|--|
| NO. | CODE NO. (OLD) | MATERIAL | FINISH, REMARKS | NO. | DESIGNED | CHECKED | APPROVED | RELEASED | |
| | | | | | T. IKEDA | <i>M. Shoda</i> | <i>K. Aoto</i> | | |
| | | | | | '01 12 03 | '01 12 11 | '02 12 25 | | |
| DRAWING NO. | | EDC3-165658 | | PART NO. | | GT5N-1PP-HU | | | |
| SCALE | | 1 : 1 | | CODE NO. | | CL755-0090-9 | | | |
| UNITS | | mm | | DRAWING NO. | | EDC3-165658 | | | |
| | | | | UNITS | | HIROSE ELECTRIC CO., LTD | | | |

| | | | |
|----|--|--|--|
| TO | | | |
|----|--|--|--|