

May.1.2024 Copyright 2024 HIROSE ELECTRIC CO., LTD. All Rights Reserved.  
In case of consideration for using Automotive equipment / device which demand high reliability, kindly contact our sales window correspondents.

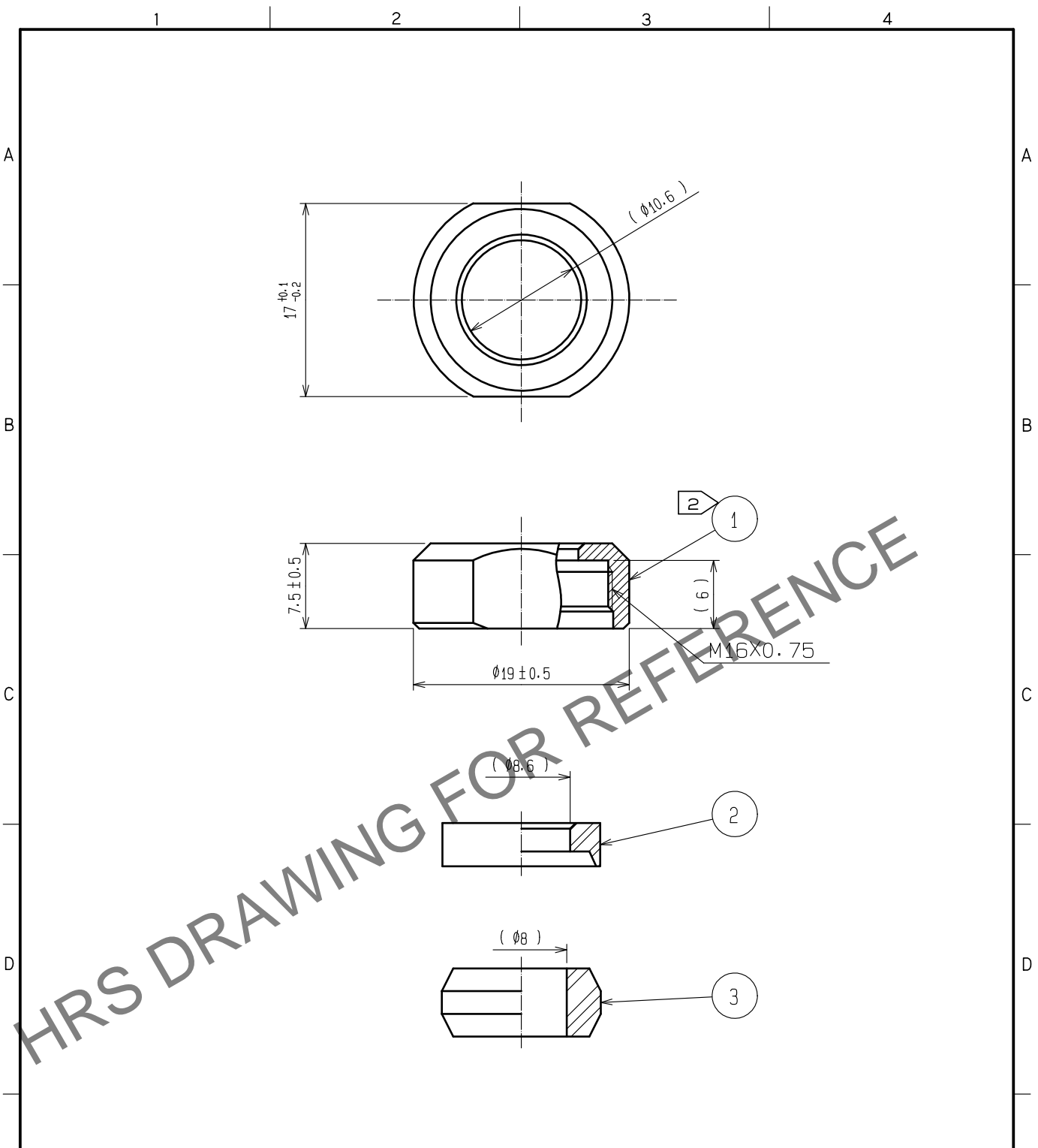

NOTES 1 THIS PRODUCT IS DELIVERED DISASSEMBLED.  
2 THE RECOMMENDED CLAMP TORQUE OF REF. ① TO BE 2 TO 2.5N·m  
LOCTITE 263, HENKEL JAPAN OR EQUIVALENT IS RECOMMENDED TO PREVENT  
REF. NO. ① FROM LOOSENING.

2	PPS	(BLACK) UL94V-0						
1	BRASS	BLACK CHROME PLATING	3	NBR	(GRAY)			
NO.	MATERIAL	FINISH . REMARKS	NO.	MATERIAL	FINISH . REMARKS			
UNITS mm		SCALE 2 : 1	COUNT 	DESCRIPTION OF REVISIONS	DESIGNED	CHECKED	DATE	
HIROSE ELECTRIC CO., LTD.		APPROVED	HY. KOBAYASHI	18.03.12	DRAWING NO.	EDC-110622-31-00		
		CHECKED	HY. KOBAYASHI	18.03.12	PART NO.	JR13WCCA-8(31)		
		DESIGNED	TH. KAMEYA	18.03.09	CODE NO.	CL114-2073-6-31		
		DRAWN	TH. KAMEYA	18.03.09				1/1