

May.1.2024 Copyright 2024 HIROSE ELECTRIC CO., LTD. All Rights Reserved.  
In case of consideration for using Automotive equipment / device which demand high reliability, kindly contact our sales window correspondents.

1					2					3					4				
COUNT	DESCRIPTION OF REVISIONS				BY	CHKD	DATE			COUNT	DESCRIPTION OF REVISIONS				BY	CHKD	DATE		
△							. .			△							. .		
△										△							. .		
△										△							. .		

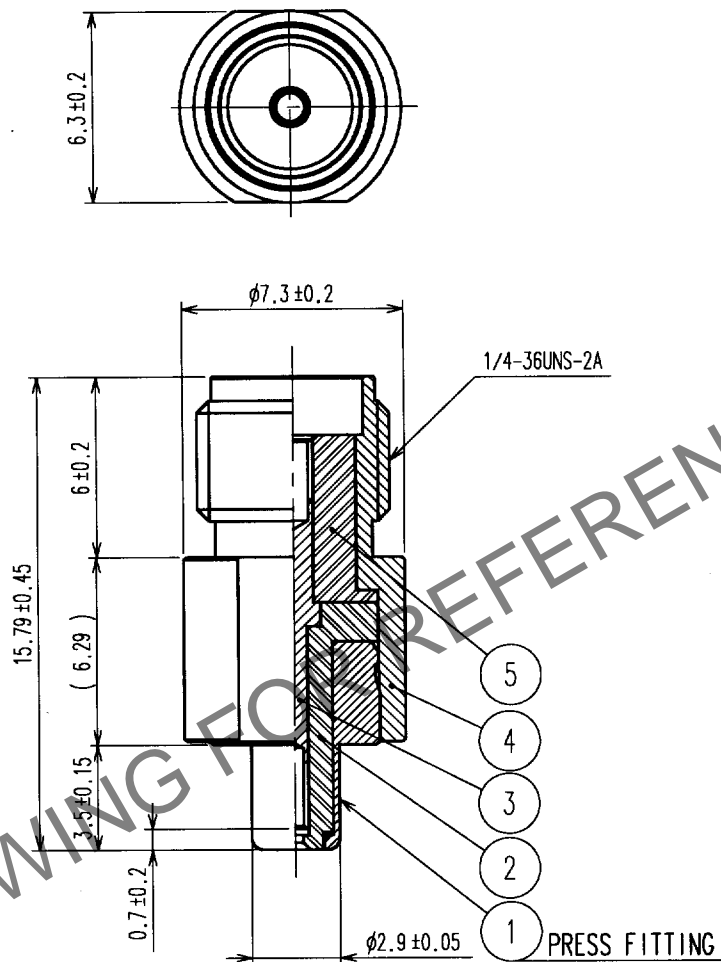

NOTE  
1. PLEASE USE THIS AS A INSPECTION PLUG, MATING WITH MS-151-C(LP).

3	BERYLLIUM COPPER	GOLD PLATING	5	PTFE	
2	PTFE		4	STAINLESS STEEL	PASSIVATE
1	PHOSPHOR BRONZE	NICKEL PLATING			
NO.	MATERIAL	FINISH, REMARKS	NO.	MATERIAL	FINISH, REMARKS
CODE NO. (OLD) CL			DRAWN Yamashita 04.8.24		
			DESIGNED Yamashita 04.8.24		
			CHECKED R. Kato 04.8.26		
			APPROVED K. Yamashita 04.8.26		
			RELEASED		
DRAWING NO. EDC4-180214			PART NO. MS151J-HRMJ		
UNITS mm			CODE NO. CL355-0088-4		
HRS HIROSE ELECTRIC CO., LTD.					

TO
RFD