

Jan.1.2019 Copyright 2019 HIROSE ELECTRIC CO., LTD. All Rights Reserved.
 In case that the application demands a high level of reliability, such as automotive,
 please contact a company representative for further information.

【 ASSEMBLE TOOL 】

- Jig for soldering outer conductor: SMP-J-SF/SO-MD1
- Jig for soldering center conductor: SMP-J-SF/SO-MD2
- Jig for inspection of dimension for mating area: SMP-J-SF/CV-MC

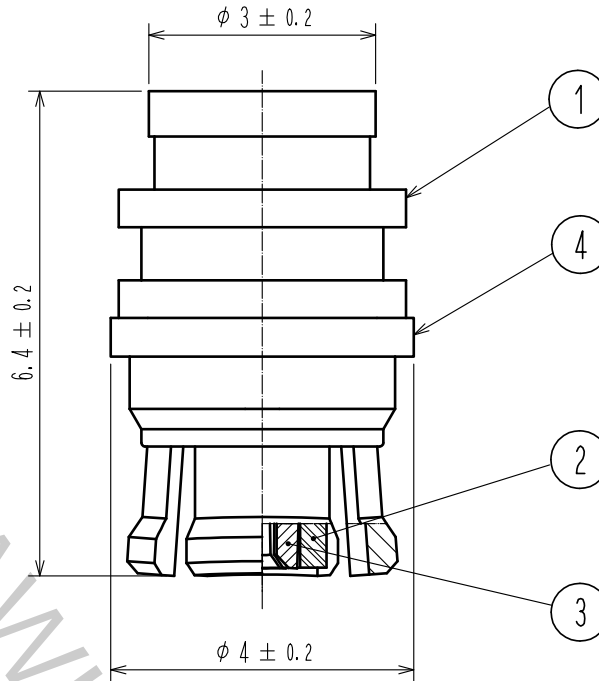

【 USAGE PRECAUTIONS 】

1. Please insert or extract a SMP jack as perpendicularly as possible to a receptacle. If aligned insertion or extraction is not performed, it could damage or deform an outer conductor part of the jack. Recommend using an extraction jig for the jack

2 Semi-flexible cable is made solder connection with a connector. If excess load on the soldered section is applied, it could damage or deform the section. Please handle it with care.

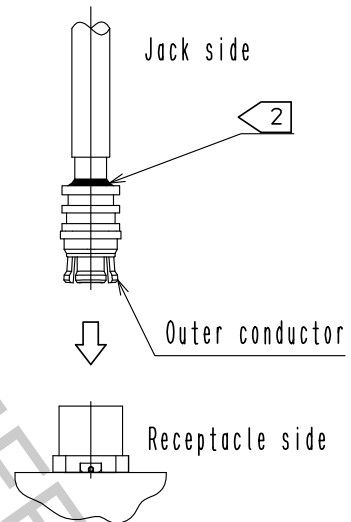

RoHS COMPLIANT

2	PTFE		4	BRASS	GOLD PLATING			
1	BERYLIUM COPPER	GOLD PLATING	3	BERYLIUM COPPER	GOLD PLATING			
NO.	MATERIAL	FINISH	REMARKS	NO.	MATERIAL	FINISH	REMARKS	
UNITS mm		SCALE 10:1	COUNT 	DESCRIPTION OF REVISIONS		DESIGNED	CHECKED	DATE
HIROSE ELECTRIC CO., LTD.		APPROVED	•TO. KATAYAMA	17.11.01	DRAWING NO. EDC-373427-00-00			
		CHECKED	•KY. SHIMIZU	17.11.01	PART NO. SMP-J-SF085			
		DESIGNED	•TM. YOSHIDA	17.11.01	CODE NO. CL338-1100-0-00			
		DRAWN	•TM. YOSHIDA	17.11.01	1/1			