

Part No.	Cable color
~062*1D~	GRAY
~062*2D~	BLACK

NOTE 1 We indicate the length of the harness on the last of product name, 'L' part.

2 Tolerance for [ L ]

Length L [mm]	Tolerance [mm]
$35 \leq L \leq 200$	$\pm 4$
$200 < L \leq 500$	$\pm 8$
$500 < L \leq 1000$	$\pm 12$
$1000 < L$	$\pm 1.5\%$

3 Connector rotation angle is within  $\pm 45$  degree from the above image.  
For long length in the case of  $L > 500$ , the angle is optional.

4. Specifications are subject to change without notice.

#### 【 DIMENSIONS OF CONNECTOR 】

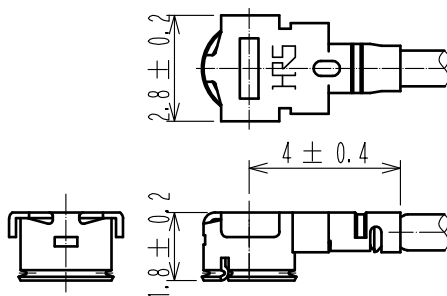

1	U. FL-LP-062HF(06)	CL331-0561-0-06	2	0.95 Dia. coaxial cable
NO.	PART NO.	CODE NO.	NO.	PART NO.

HALOGEN FREE

UNITS mm	SCALE FREE	COUNT	DESCRIPTION OF REVISIONS	DESIGNED	CHECKED	DATE

**HRS** HIROSE  
ELECTRIC  
CO., LTD.

APPROVED	・NK. NINOMIYA	18.06.22
CHECKED	・MT. KANEKO	18.06.22
DESIGNED	・MS. MATSUMOTO	18.06.22
DRAWN	・MS. MATSUMOTO	18.06.22

DRAWING NO.	
PART NO.	UFL-2LPHF6-062**D-AC-L
CODE NO.	