

Jul.1.2024 Copyright 2024 HIROSE ELECTRIC CO., LTD. All Rights Reserved.  
 In case of consideration for using Automotive equipment / device which demand high reliability, kindly contact our sales window correspondents.

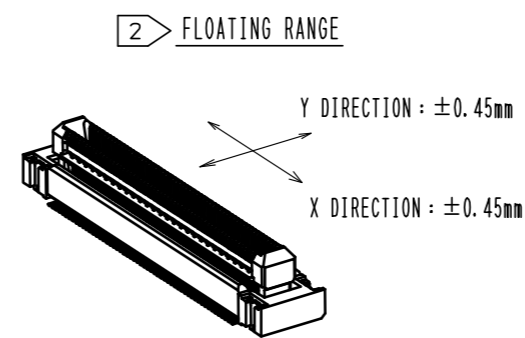

RECOMMENDED LAND PATTERN DIMENSION OF PCB

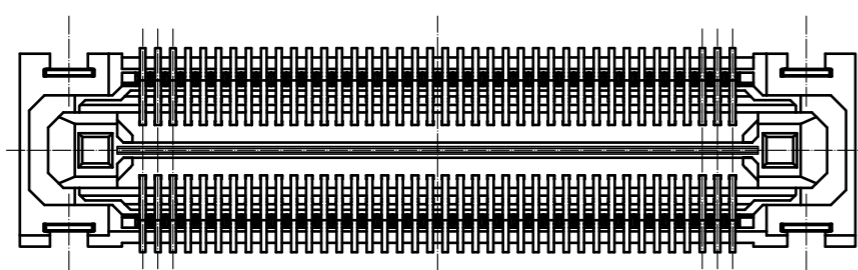
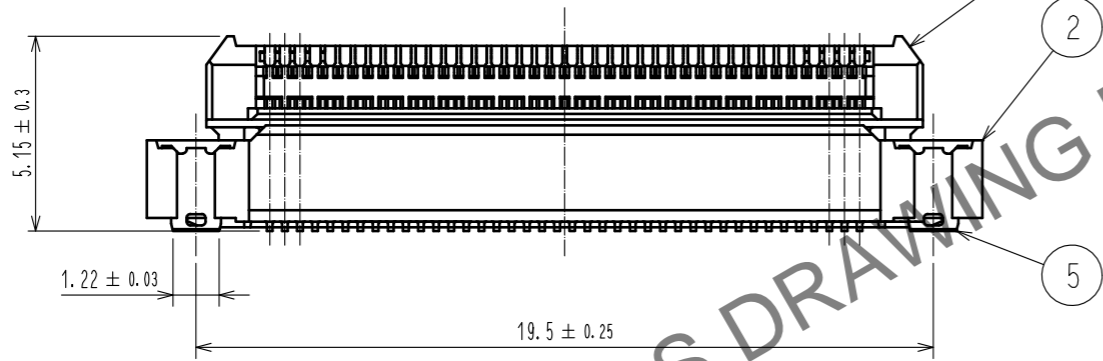
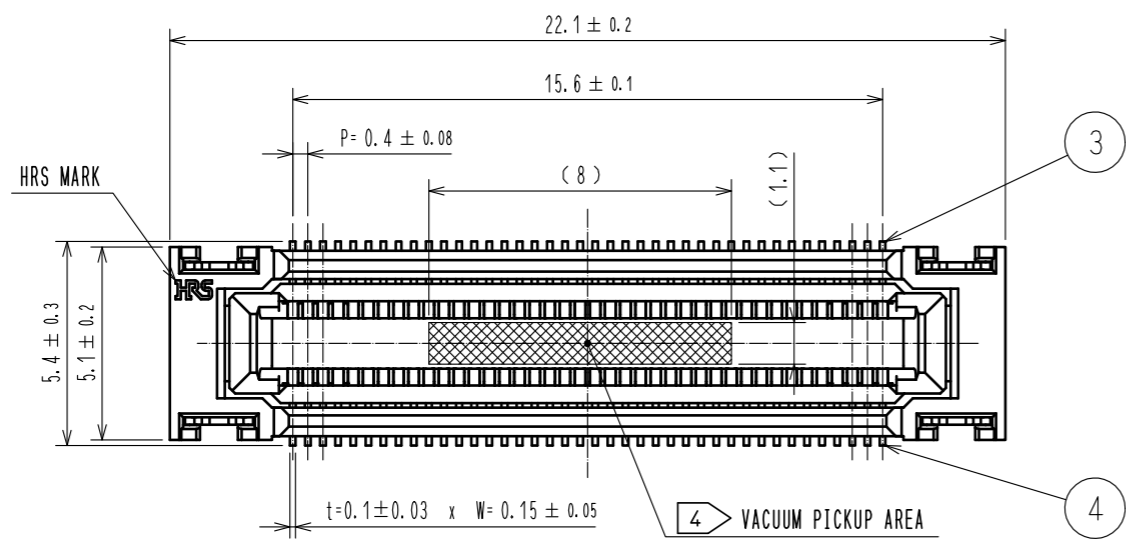
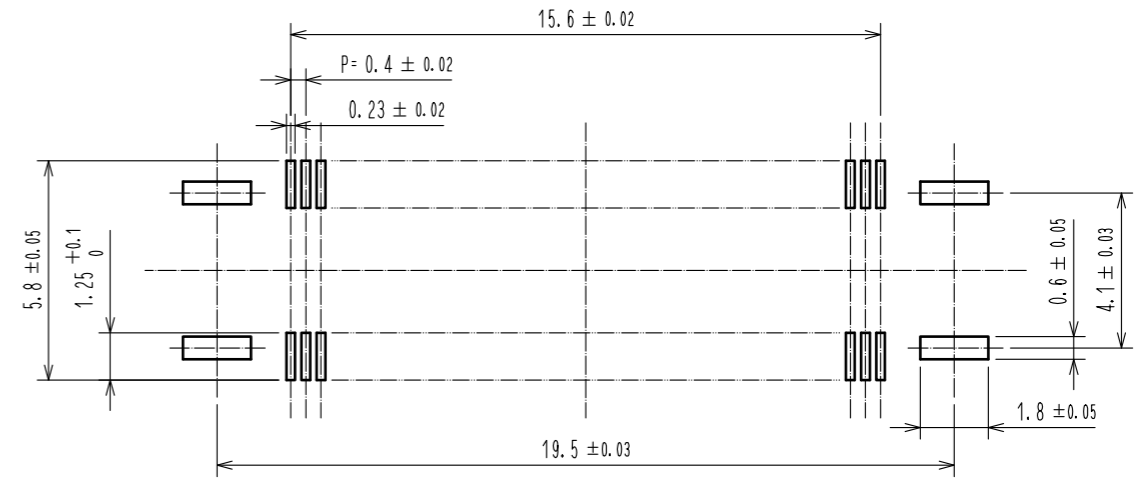

PCB DISTANCE

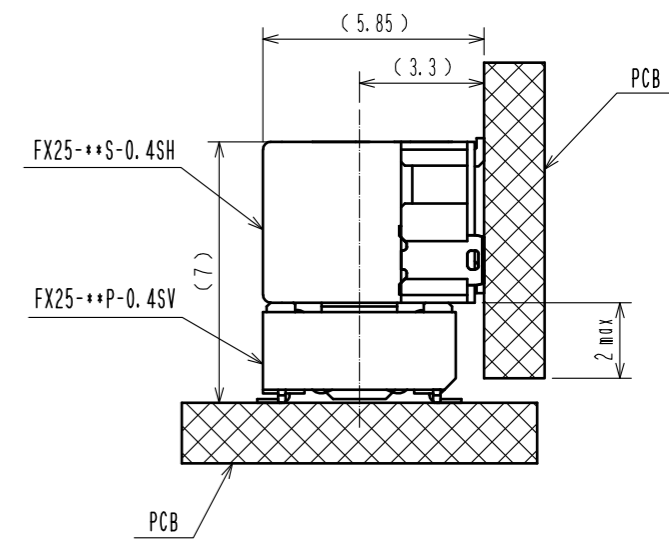

- Notes
- 1 Lead CO-Planarity is 0.1mm MAX.
  - 2 Floating range of this connector is ±0.45MAX.  
The maximum cycle time of the floating operation is in accordance with the mating cycle of the connector.
  - 3 This is packaged in embossed carrier tape packing. (1000pcs/RL)
  - 4 It shows the vacuum pickup area.
  - 5 Blemish and hit mark can be occurred through out the manufacturing process which doesn't affect quality level.
  - 6 The dimensions in parentheses are for reference.

NO.	MATERIAL	FINISH . REMARKS
1	LCP	BLACK - UL94V-0
2	POLYIMIDE	BLACK - UL94V-0
3, 4	COPPER ALLOY	CONTACT : UNDER NCKEL PLATING 1μm / GOLD 0.05μm LEAD AREA : UNDER NCKEL PLATING 0.5μm / GOLD 0.03μm
5	BRASS	OVERALL : TIN 1μm UNDER PLATEING : NICKEL 1μm
6	POLYSTYRENE	(EMBOSSD CARRIER TAPE)
7	POLYESTER	(EMBOSSD COVER TAPE)

UNITS	SCALE	COUNT	DESCRIPTION OF REVISIONS	DESIGNED	CHECKED	DATE
mm	5 : 1	△	APPROVED : MK. NAGATA 20221227			
HIROSE ELECTRIC CO., LTD.			CHECKED : HT. YAMAGUCHI 20221227	DRAWING NO. EDC-369481-00-00		
			DESIGNED : SY. KUDO 20221227	PART NO. FX25-80P-0.4SV		
			DRAWN : YK. MITSUISHI 20221222	CODE NO. CL0575-4002-0-00		
				1/2		

Jul.1.2024 Copyright 2024 HIROSE ELECTRIC CO., LTD. All Rights Reserved.  
 In case of consideration for using Automotive equipment / device which demand high reliability, kindly contact our sales window correspondents.

3 DRAWING FOR PACKING

The direct of pulling out →

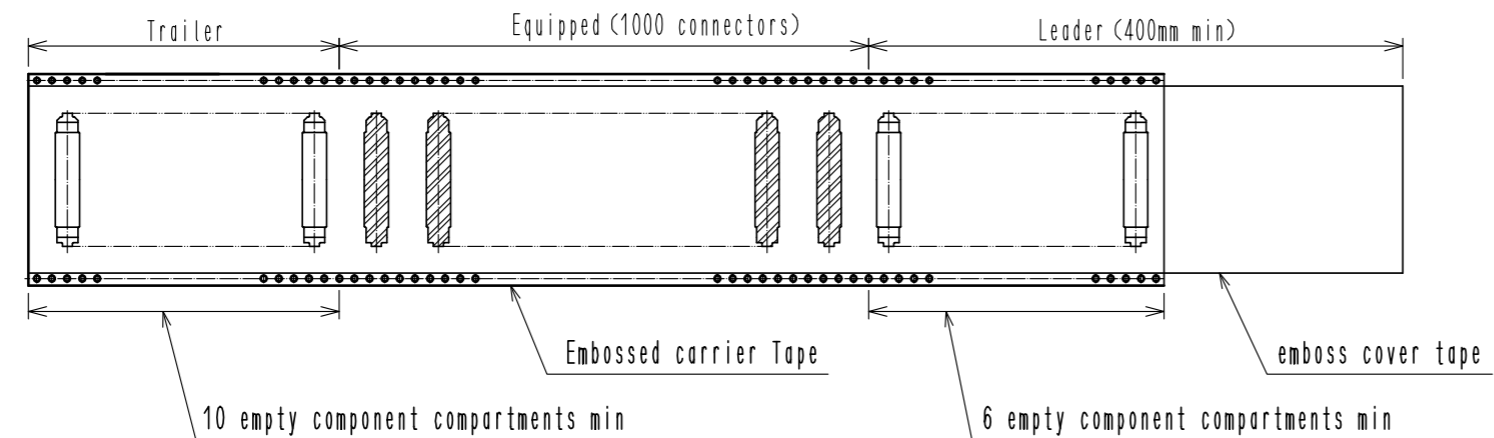
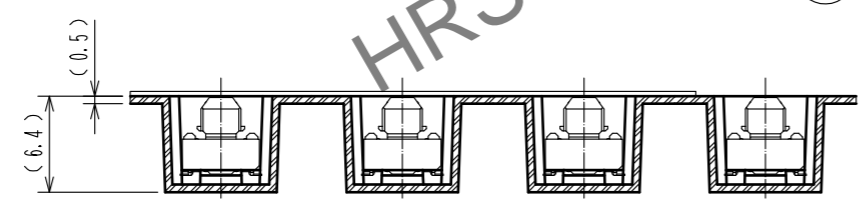
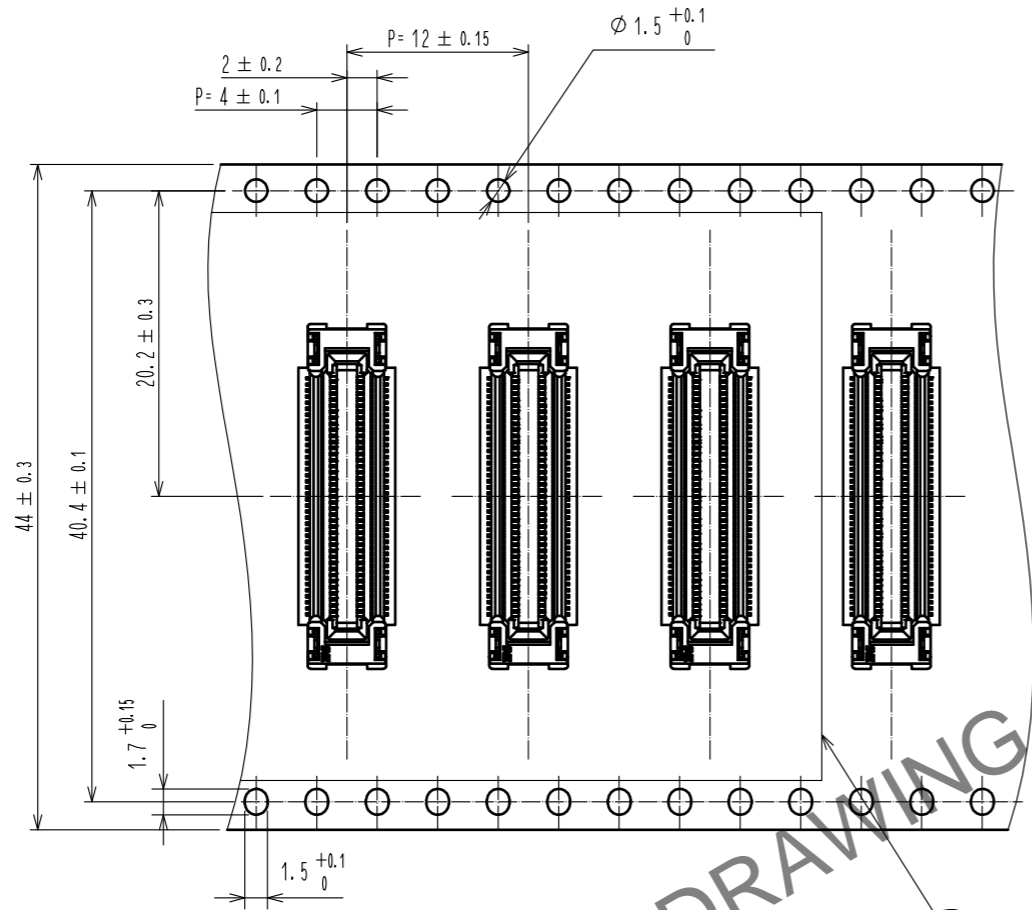

REELING DIMENSION

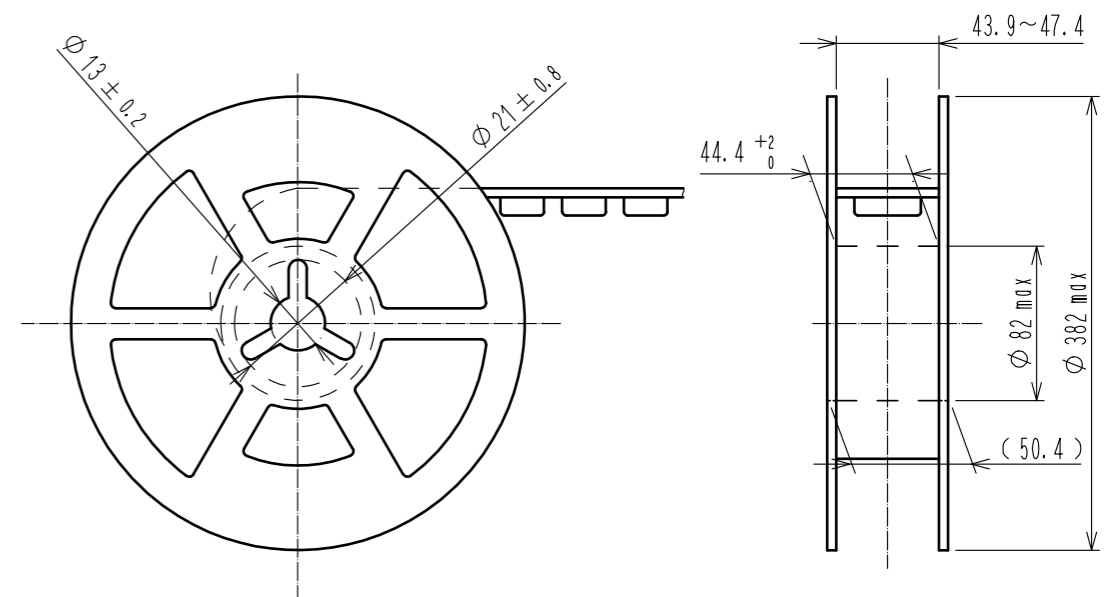

<b>HRS</b>	DRAWING NO.	EDC-369481-00-00	2/2
	PART NO.	FX25-80P-0.4SV	
	CODE NO.	CL0575-4002-0-00	