

Mar.1.2026 Copyright 2026 HIROSE ELECTRIC CO., LTD. All Rights Reserved.  
In case of consideration for using Automotive equipment / device which demand high reliability, kindly contact our sales window correspondents.

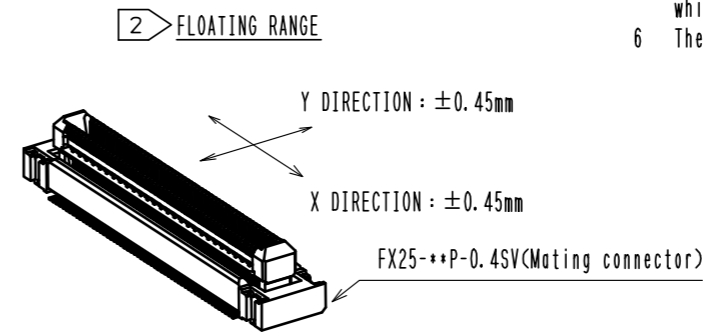
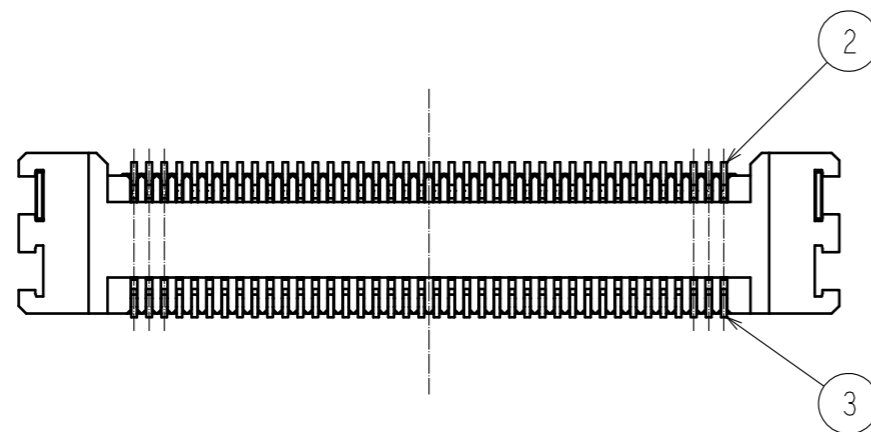
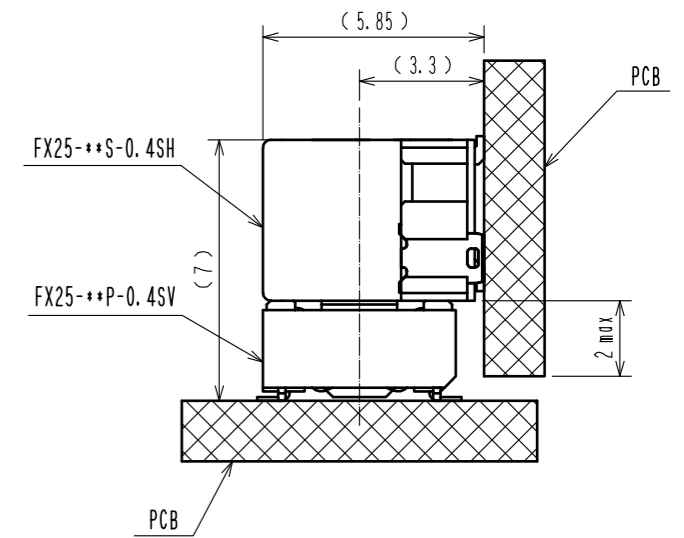
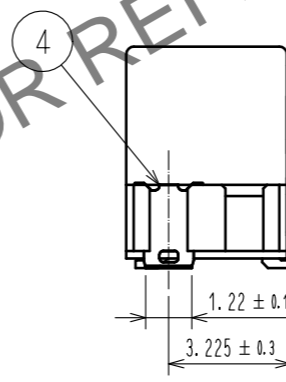
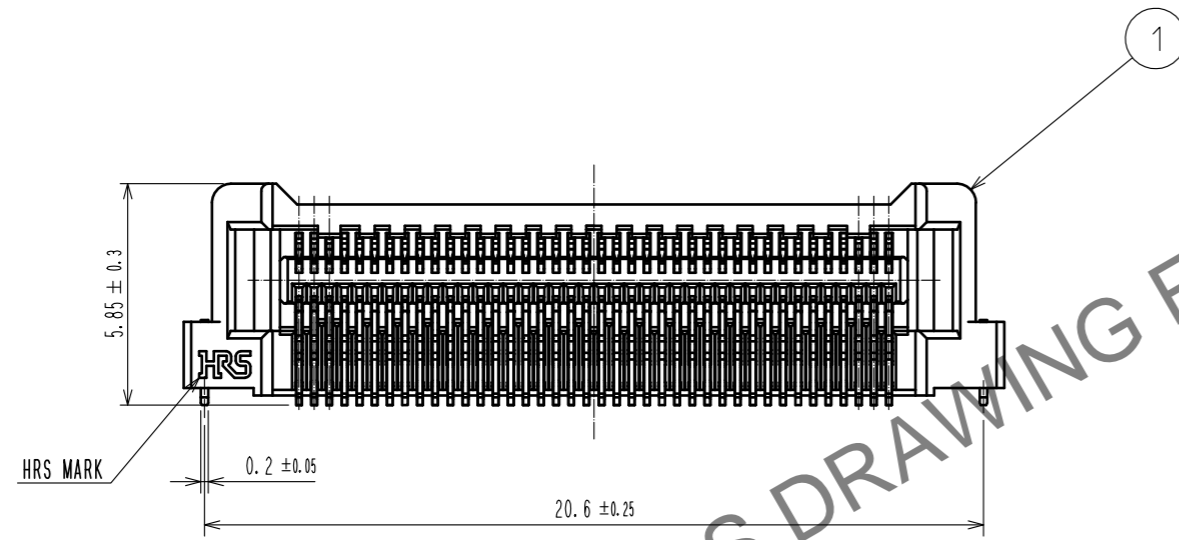
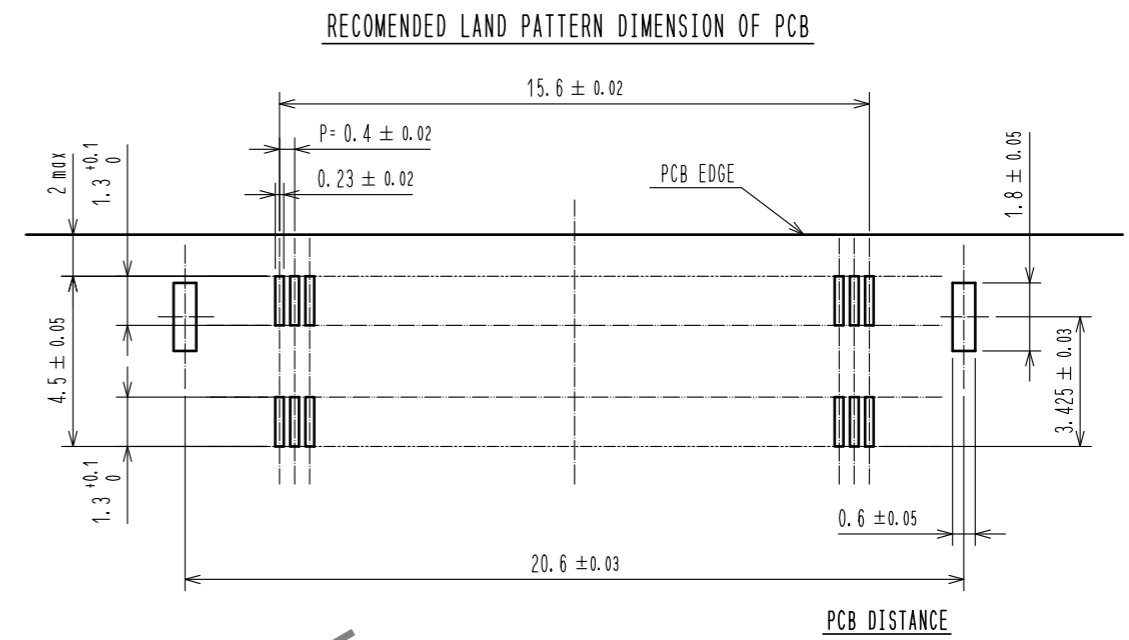
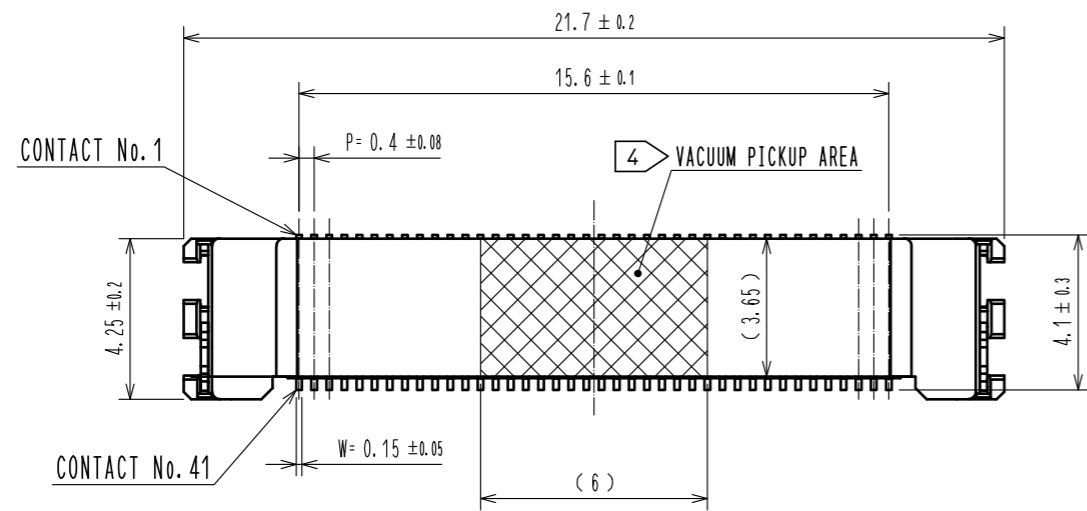

- Notes
- 1 Lead co-planarity is 0.1mm MAX.
  - 2 Floating range of this connector is ±0.45mm MAX.  
The maximum cycle time of the floating operation is in accordance with the mating cycle of the connector.
  - 3 This is packaged in embossed carrier tape. (1000pcs/RL)
  - 4 It shows the vacuum pickup area.
  - 5 Blemish and hit mark can be occurred through out the manufacturing process which doesn't affect quality level.
  - 6 The dimensions in parentheses are for references.

NO.	MATERIAL	FINISH . REMARKS
1	LCP	BLACK . UL94V-0
2, 3	COPPER ALLOY	CONTACT AREA : GOLD 0.05μm LEAD AREA : GOLD 0.03μm UNDER PLATING : NICKEL 1μm
4	BRASS	OVERALL : TIN-PLATING 1μm UNDER PLATING : NICKEL 1μm
5	POLYSTYRENE	(EMBOSSED CARRIER TAPE)
6	POLYESTER	(EMBOSSED COVER TAPE)

UNITS	SCALE	COUNT	DESCRIPTION OF REVISIONS	DESIGNED	CHECKED	DATE
mm	5 : 1	△				
			APPROVED : MK. NAGATA 20221227	DRAWING NO. EDC-369482-00-00		
			CHECKED : HT. YAMAGUCHI 20221227	PART NO. FX25-80S-0.4SH		
			DESIGNED : SY. KUDO 20221227	CODE NO. CL0575-4102-0-00		
			DRAWN : YK. MITSUISHI 20221222	1/2		

Mar.1.2026 Copyright 2026 HIROSE ELECTRIC CO., LTD. All Rights Reserved.  
 In case of consideration for using Automotive equipment / device which demand high reliability, kindly contact our sales window correspondents.

3 DRAWING FOR PACKING(No scale)

Direction of pulling out →

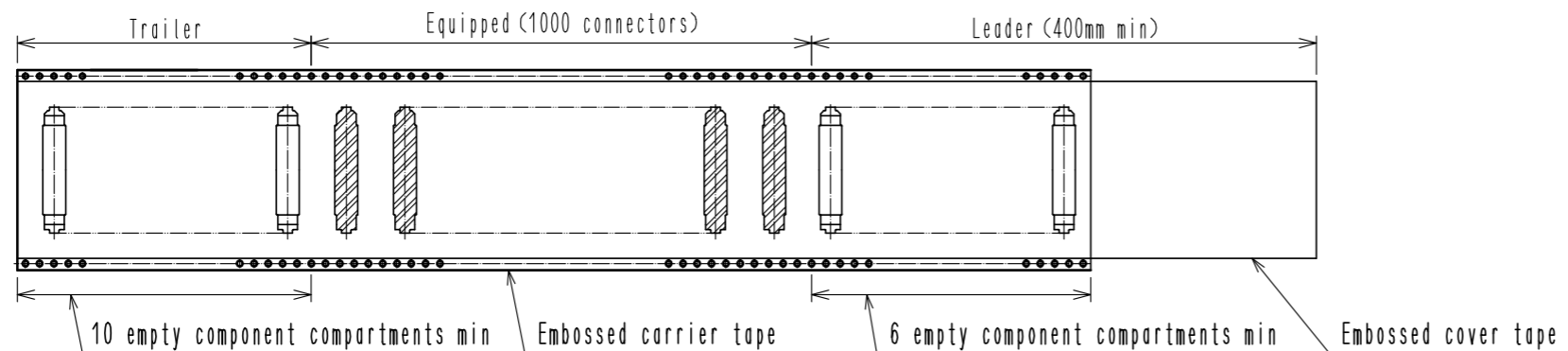
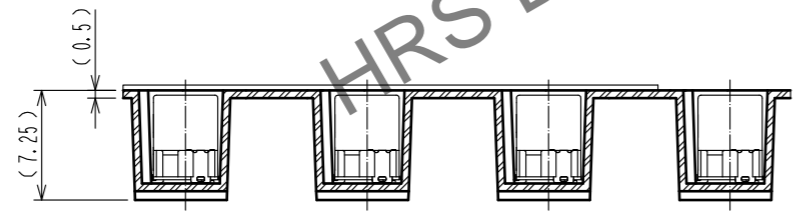
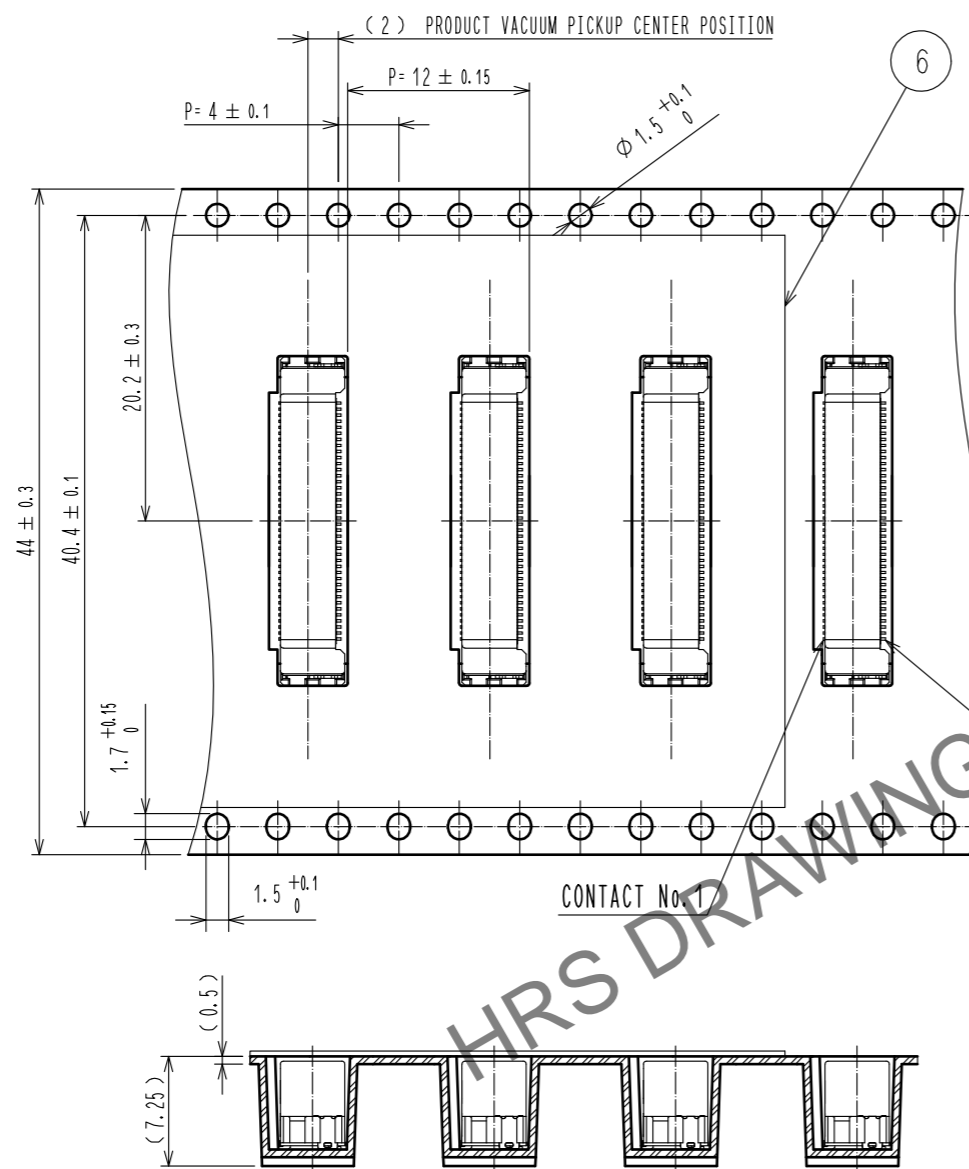

REEL DIMENSION(No scale)

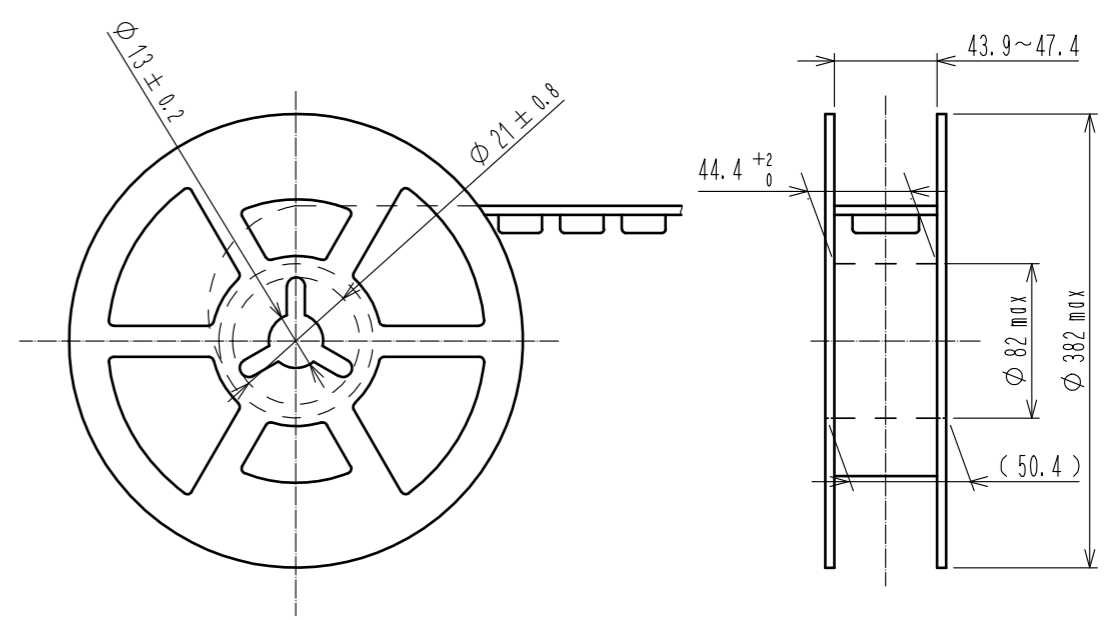

HRS DRAWING FOR REFERENCE

<b>HRS</b>	DRAWING NO.	EDC-369482-00-00	2/2
	PART NO.	FX25-80S-0.4SH	
	CODE NO.	CL0575-4102-0-00	