

Apr.1.2024 Copyright 2024 HIROSE ELECTRIC CO., LTD. All Rights Reserved.
In case of consideration for using Automotive equipment / device which demand high reliability, kindly contact our sales window correspondents.

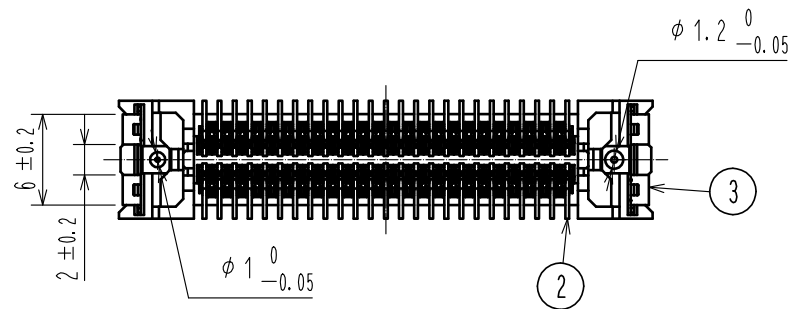
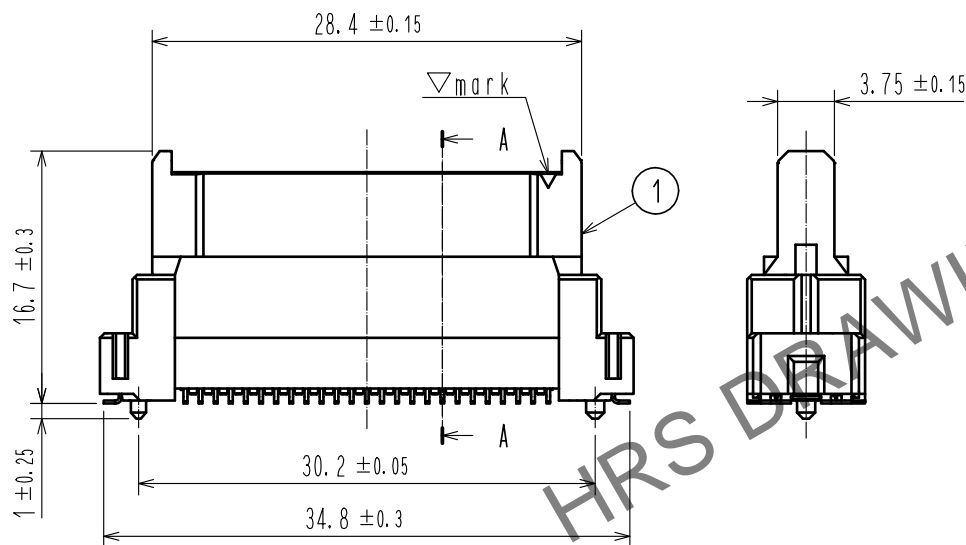
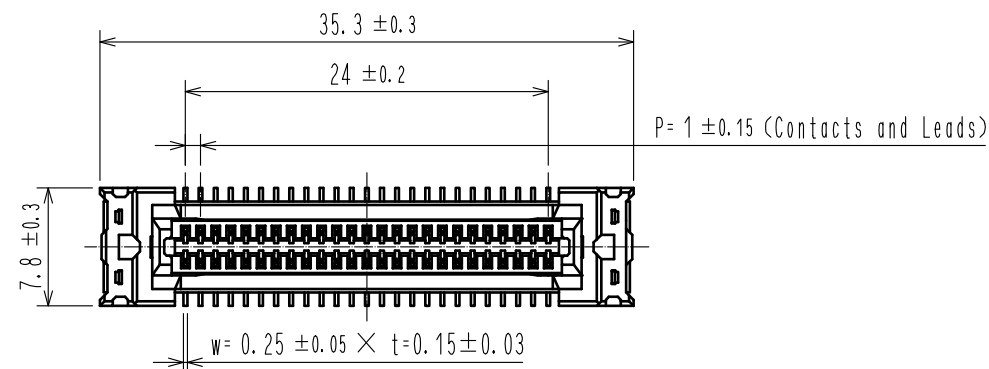

RECOMMENDED LAND PATTERN DIMENSION OF PCB

RECOMMENDED METAL MASK

Aperture ratio 100% : t=0.15

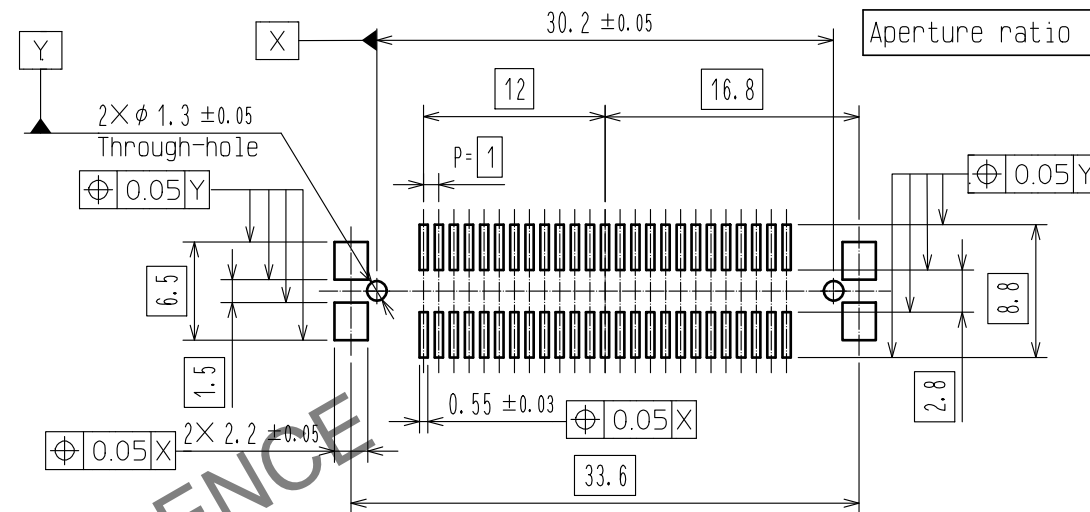

3 PCB DISTANCE

2 FX26-50P-1SV
(Mating connector)

FX26-50S-1SV20

20 ± 0.75

Note

- Lead CO-Planarity is 0.1mm MAX.
- Floating range of the mating connector is ±0.7mm MAX.
The maximum cycle time of the floating operation is in accordance with the mating cycle of the connector.
Please use the connectors within the specified PCB distance.
- Blemish and hit mark can be occurred through out the manufacturing process which doesn't affect quality level.
- The dimensions in parentheses are for references.
- This is packaged in embossed carrier tape. (200pcs/RL)
- It shows the vacuum pickup area.
Remove the pickup cap before mating connectors.
- This connector has no polarity with the mating connector.

1	POLYAMIDE	BLACK UL94V-0	6	POLYAMIDE	(CAP FOR VACUUM PICKUP)
NO.	MATERIAL	FINISH . REMARKS	5	POLYESTER	(EMBOSSD COVER TAPE)
UNITS mm			4	POLYSTYRENE	(EMBOSSD CARRIER TAPE)
			3	PHOSPHOR BRONZE	OVER PLATING : TIN-PLATING 1μm UNDER PLATING: NICKEL 0.5μm
			2	COPPER ALLOY	CONTACT AREA : GOLD 0.1μm LEAD AREA : GOLD 0.03μm UNDER PLATING: NICKEL 1μm
			NO.	MATERIAL	FINISH . REMARKS
SCALE 2 : 1	COUNT △	DESCRIPTION OF REVISIONS	DESIGNED	CHECKED	DATE
APPROVED : HH. SHINDO	20201008	DRAWING NO.	EDC-376651-00-00		
CHECKED : HH. SHINDO	20201008	PART NO.	FX26-50S-1SV20		
DESIGNED : KI. YAMAZAKI	20201008	CODE NO.	CL576-1305-0-00		
DRAWN : KI. YAMAZAKI	20201008				

Apr.1.2024 Copyright 2024 HIROSE ELECTRIC CO., LTD. All Rights Reserved.
In case of consideration for using Automotive equipment / device which demand high reliability, kindly contact our sales window correspondents.

6 DRAWING FOR PACKING(2:1)

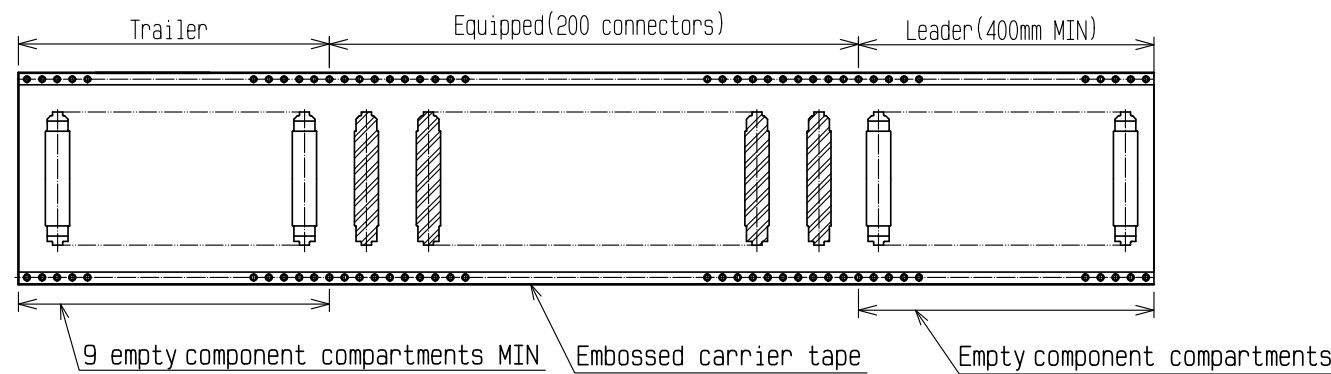
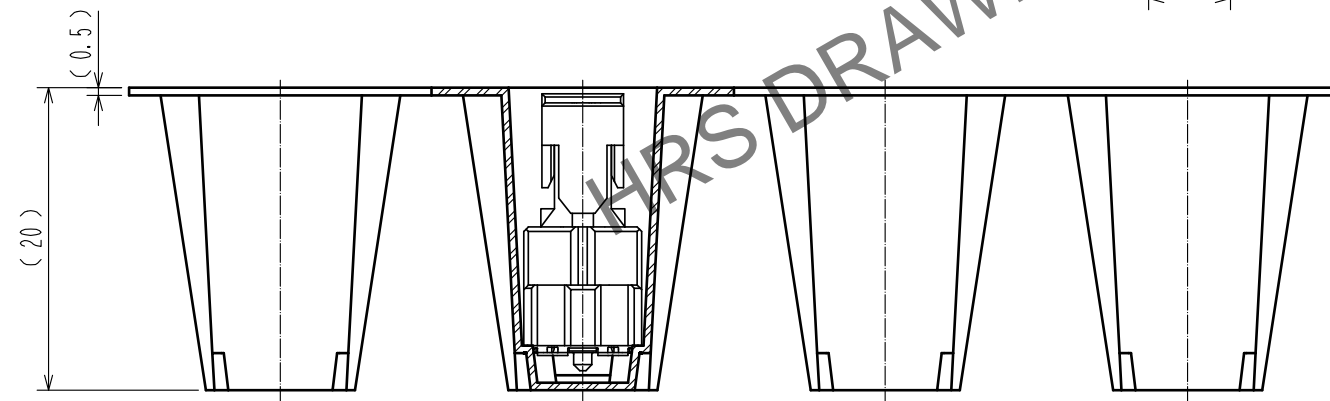
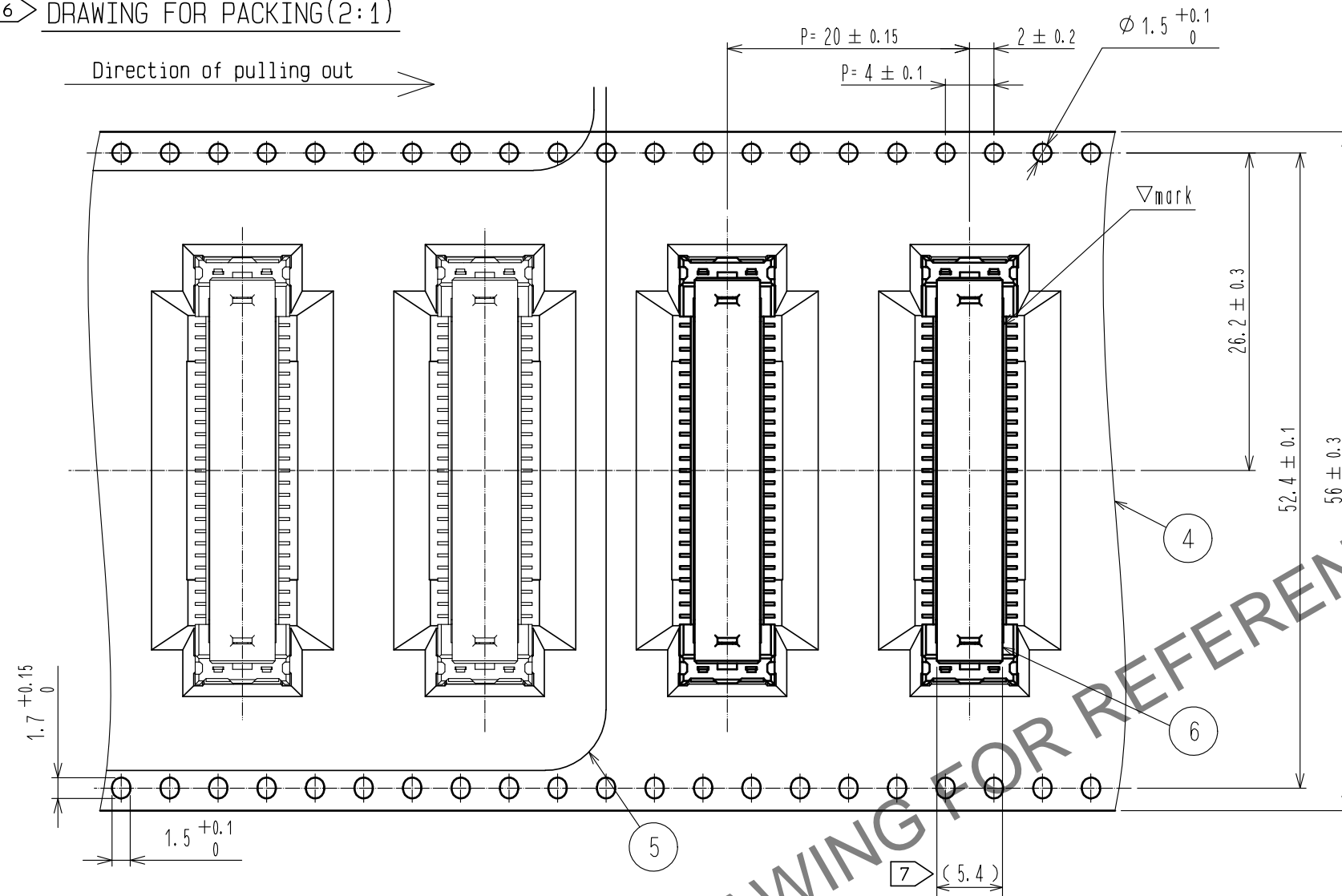

REEL DIMENSION(No scale)

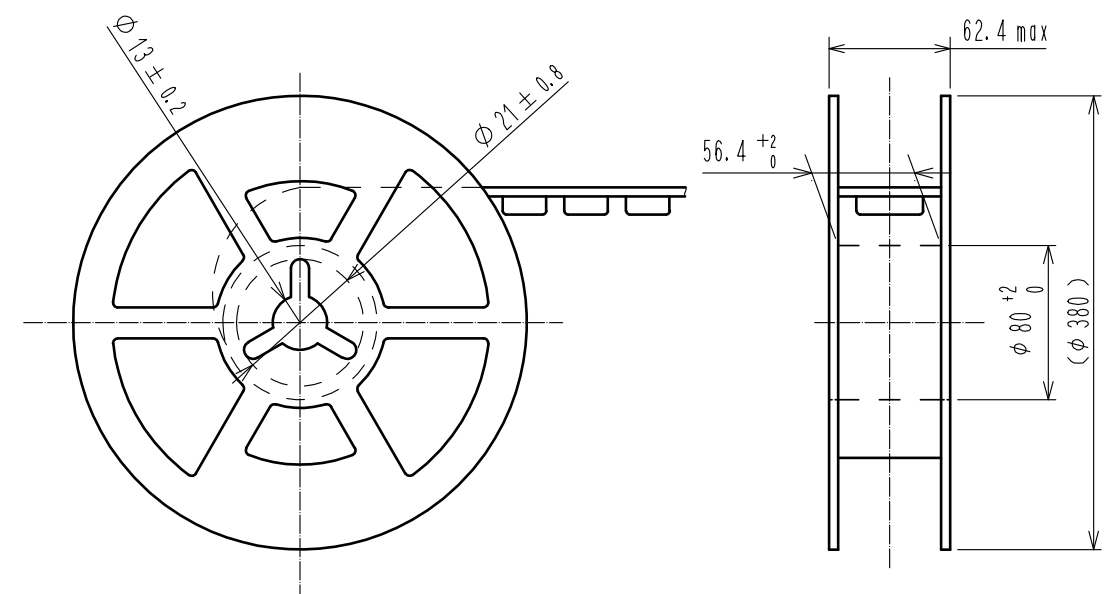

HRS

DRAWING NO.	EDC-376651-00-00
PART NO.	FX26-50S-1SV20
CODE NO.	CL576-1305-0-00

2/2